

STATE CORPORATION COMMISSION OF KANSAS  
OIL & GAS CONSERVATION DIVISION  
WELL COMPLETION OR RECOMPLETION FORM  
ACO-1 WELL HISTORY  
DESCRIPTION OF WELL AND LEASE

5 API NO. 15-165-21,472-0000  
County RUSH  
NE NE NW Sec. 10 Twp. 18S Rge. 17 East  
X West

Operator: License # 3755  
Name BISON DRILLING INC.  
Address 531 PETROLEUM BUILDING  
ROSEWELL, NEW MEXICO 88201  
City/State/Zip

4950 Ft North from Southeast Corner of Section  
2970 Ft West from Southeast Corner of Section  
(Note: Locate well in section plat below)

Purchaser CLEAR CREEK, INC.  
MC PHERSON, KANSAS

Lease Name HARDY "B" Well # 1

Operator Contact Person D.C. MARCHANT  
Phone 1(505)622-6409/1(805)528-7539

Field Name NEW DISCOVERY Reichelt

Producing Formation BASAL PENN. SAND

Contractor: License # 3755  
Name BISON DRILLING, INC.

Elevation: Ground 1990 1997 KB

Wellsite Geologist D.C. MARCHANT  
Phone 1(505)622-6409/1(805)528-7539

RECEIVED  
STATE CORPORATION COMMISSION

Designate Type of Completion  
X New Well Re-Entry Workover

JUL 31 1989

X Oil SWD Temp Abd  
Gas Inj Delayed Comp.  
Dry Other (Core, Water Supply etc.)

CONSERVATION DIVISION  
Wichita, Kansas

If OMNO: old well info as follows:

Operator  
Well Name  
Comp. Date Old Total Depth

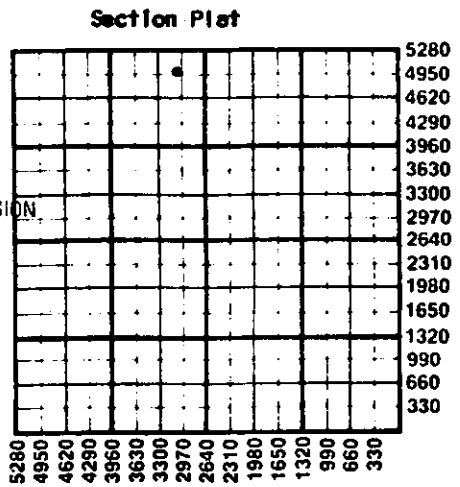

WATER SUPPLY INFORMATION

Disposition of Produced Water: X Disposal  
Docket # Repressuring

Questions on this portion of the ACO-1 call:  
Water Resources Board (913) 296-3717

Source of Water:  
Division of Water Resources Permit #

X Groundwater Ft North from Southeast Corner  
(Well) Ft West from Southeast Corner of  
SW/4 Sec 14 Twp 18 Rge 17 East X West

Surface Water Ft North from Southeast Corner  
(Stream, pond etc) Ft West from Southeast Corner  
Sec Twp Rge East West

Other (explain) EDMUND L. OBORNY  
(purchased from city, R.W.D. #)  
222 FAIRVIEW DRIVE, LA CROSSE, KS 67548

WELL HISTORY

Drilling Method:  
X Mud Rotary Air Rotary Cable  
5/23/89... 6/1/89... 7/12/89...  
Spud Date Date Reached TD Completion Date  
..3622.5' .3614.5'...  
Total Depth PBD

Amount of Surface Pipe Set and Cemented at 1073 feet  
Multiple Stage Cementing Collar Used? Yes X No  
If yes, show depth set feet  
if alternate 2 completion, cement circulated  
from feet depth to w/ SX cmt  
Cement Company Name  
Invoice #

INSTRUCTIONS: This form shall be completed in triplicate and filed with the Kansas Corporation Commission, 200 Colorado Derby Building, Wichita, Kansas 67202, within 120 days of the spud date of any well. Rule 82-3-130, 82-3-107 and 82-3-106 apply. Information on side two of this form will be held confidential for a period of 12 months if requested in writing and submitted with the form. See rule 82-3-107 for confidentiality in excess of 12 months. One copy of all wireline logs and drillers time log shall be attached with this form. Submit CP-4 form with all plugged wells. Submit CP-111 form with all temporarily abandoned wells.

All requirements of the statutes, rules and regulations promulgated to regulate the oil and gas industry have been fully complied with and the statements herein are complete and correct to the best of my knowledge.

Signature [Signature]

Title PRESIDENT, BISON DRILLING INC Date 7/27/89

Subscribed and sworn to before me this 27 day of July 1989

Notary Public [Signature]

Date Commission Expires 12-14-90

K.C.C. OFFICE USE ONLY  
F Letter of Confidentiality Attached  
C Wireline Log Received  
C Drillers Timelog Received  
Distribution  
KCC SWD/Rep NGPA  
KGS Plug Other  
(Specify)

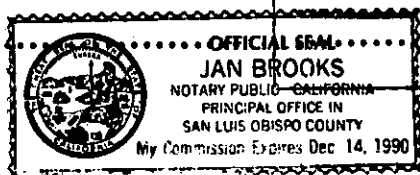

Sec 10 Twp 18 Rge 17

SIDE TWO

Operator Name **BISON DRILLING, INC.** Lease Name **HARDY, B.** Well # **1**

Sec. **10** Twp. **18S** Rge. **17** County **RUSH**

WELL LOG

INSTRUCTIONS: Show important tops and base of formations penetrated. Detail all cores. Report all drill stem tests giving interval tested, time tool open and closed, flowing and shut-in pressures, whether shut-in pressure reached static level, hydrostatic pressures, bottom hole temperature, fluid recovery, and flow rates if gas to surface during test. Attach extra sheet if more space is needed. Attach copy of log.

Drill Stem Tests Taken  Yes  No  
 Samples Sent to Geological Survey  Yes  No  
 Cores Taken  Yes  No

Formation Description  
 Log  Sample

DST#1 3559.5' TO 3599.5'  
 OPEN 15" S.I. 30" OPEN 30" S.I. 60"  
 STRONG BLOW 1ST OPENING STRONG  
 BLOW 2ND OPENING. GAS TO SURFACE IN  
 20" 2ND OPENING.  
 RECOVERED 560' OF FLUID: 90' GASSY  
 SLIGHTLY OIL CUT MUD, 110' HOCM 20%  
 OIL, 120' GM OIL 60% OIL, 230' GASSY OIL  
 AND 10' OF WATER.  
 1 SIP 1028# FSIP 1021# FHH 1906#

Name	Top	Bottom
ANHYDRITE	1074'	(+924)
BASE ANH.	1106'	(+891)
HEEBNER	3246'	(-1249)
TORONTO	3264'	(-1267)
LANSING	3301'	(-1304)
BASE K.C.	3540'	(-1543)
BASAL SAND	3598'	(-1601)
GRANITE WASH	3612'	(-1615)
GRANITE	3622'	(-1622)
TOTAL DEPTH	3622.5'	(-1626.5')

CASING RECORD <input checked="" type="checkbox"/> New <input type="checkbox"/> Used							
Report all strings set-conductor, surface, intermediate, production, etc.							
Purpose of String	Size Hole Drilled	Size Casing Set (In O.D.)	Weight Lbs/Ft.	Setting Depth	Type of Cement	#Sacks Used	Type and Percent Additives
SURFACE.....	10.3/4"	7"	20#	1173'			
PRODUCTION...	6.1/4"	4.1/2"	10.5#	3622'			
PERFORATION RECORD				Acid, Fracture, Shot, Cement Squeeze Record			
Shots Per Foot	Specify Footage of Each Interval Perforated			(Amount and Kind of Material Used)		Depth	
8	3600-3602'			200 GALS. MCA		3600-02'	
TUBING RECORD				Liner Run <input type="checkbox"/> Yes <input checked="" type="checkbox"/> No			
Size		Set At		Packer at			
2 3/8"		3612'		--			
Date of First Production		Producing Method					
7/12/89		<input type="checkbox"/> Flowing <input checked="" type="checkbox"/> Pumping <input type="checkbox"/> Gas Lift <input type="checkbox"/> Other (explain).....					
Estimated Production Per 24 Hours		Oil	Gas	Water	Gas-Oil Ratio	Gravity	
25 Bbls		30 MCF	35 Bbls	CFPB			

METHOD OF COMPLETION

Production Interval

Disposition of gas:  Vented  Open Hole  Perforation  
 Sold  Other (Specify) ..... **3600-02'**  
 Used on Lease  Dually Completed .....  
 Commingled