

SIDE ONE

STATE CORPORATION COMMISSION OF KANSAS
OIL & GAS CONSERVATION DIVISION
WELL COMPLETION FORM
ACO-1 WELL HISTORY
DESCRIPTION OF WELL AND LEASE

API NO. 15- 165-21,550-0000

County Rush

N/2 SW NW Sec. 32 Twp. 18S Rge. 17 East West

3630' Ft. North from Southeast Corner of Section

4620' Ft. West from Southeast Corner of Section
(NOTE: Locate well in section plat below.)

Lease Name Norman Well # 1

Field Name Wildcat

Producing Formation Arbuckle

Elevation: Ground 2039' KB 2044'

Total Depth 3795' PBTD _____

Operator: License # 5393

Name: A. L. Abercrombie, Inc.

Address 150 N. Main, Suite 801

City/State/Zip Wichita, KS 67202

Purchaser: _____

Operator Contact Person: Jerry A. Langrehr

Phone (316) 262-1841

Contractor: Name: Abercrombie RTD, Inc.

License: 30684

Wellsite Geologist: Steve Frankamp

Designate Type of Completion

New Well Re-Entry Workover

Oil SWD Temp. Abd.

Gas Inj Delayed Comp.

Dry Other (Core, Water Supply, etc.)

If OWMO: old well info as follows:

Operator: N/A

Well Name: _____

Comp. Date _____ Old Total Depth _____

Drilling Methods:

Mud Rotary Air Rotary Cable

5-9-91 5-15-91 6-28-91
Spud Date Date Reached TD Completion Date

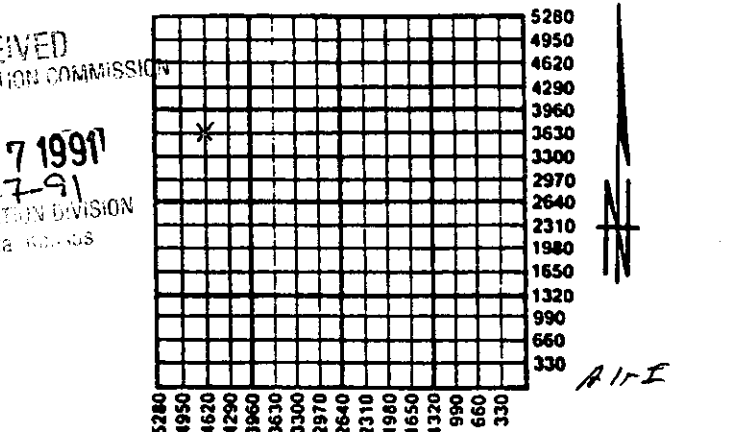

Amount of Surface Pipe Set and Cemented at 1163.16' Feet

Multiple Stage Cementing Collar Used? Yes No

If yes, show depth set _____ Feet

If Alternate II completion, cement circulated from _____

feet depth to _____ w/ _____ sx cmt.

INSTRUCTIONS: This form shall be completed in triplicate and filed with the Kansas Corporation Commission, 200 Colorado Derby Building, Wichita, Kansas 67202, within 120 days of the spud date of any well. Rule 82-3-130, 82-3-107 and 82-3-106 apply. Information on side two of this form will be held confidential for a period of 12 months if requested in writing and submitted with the form. See rule 82-3-107 for confidentiality in excess of 12 months. One copy of all wireline logs and drillers time log shall be attached with this form. ALL CEMENTING TICKETS MUST BE ATTACHED. Submit CP-4 form with all plugged wells. Submit CP-111 form with all temporarily abandoned wells. Any recompletion, workover or conversion of a well requires filing of ACO-2 within 120 days from commencement date of such work.

All requirements of the statutes, rules and regulations promulgated to regulate the oil and gas industry have been fully complied with and the statements herein are complete and correct to the best of my knowledge.

Signature Josh K. Wharton

Title Vice President Date 8-23-1991

Subscribed and sworn to before me this 23rd day of August, 19 91.

Notary Public Angela Woodard

Date Commission Expires March 20, 1993

K.C.C. OFFICE USE ONLY

F Letter of Confidentiality Attached
 C Wireline Log Received
 C Drillers Timelog Received

Distribution

KCC SMD/Rep NGPA
 XGS Plug Other
 (Specify)



SIDE TWO

Operator Name A. L. Abercrombie, Inc. Lease Name Norman Well # 1

Sec. 32 Twp. 18S Rge. 17 East West
 County Rush

INSTRUCTIONS: Show important tops and base of formations penetrated. Detail all cores. Report all drill stem tests giving interval tested, time tool open and closed, flowing and shut-in pressures, whether shut-in pressure reached static level, hydrostatic pressures, bottom hole temperature, fluid recovery, and flow rates if gas to surface during test. Attach extra sheet if more space is needed. Attach copy of log.

Drill Stem Tests Taken <input checked="" type="checkbox"/> Yes <input type="checkbox"/> No (Attach Additional Sheets.) Samples Sent to Geological Survey <input type="checkbox"/> Yes <input type="checkbox"/> No Cores Taken <input type="checkbox"/> Yes <input type="checkbox"/> No Electric Log Run <input checked="" type="checkbox"/> Yes <input type="checkbox"/> No (Submit Copy.) DST #1 3746'-3795' (Arbuckle) 30-45-60-45 Rec. 120' gas in pipe 510' clean gassy oil, 120' muddy oil, (50% oil) IFPs 54-118 ISIP 1142 FFPs 140-259 FSIP 1090	<table border="1" style="width:100%; border-collapse: collapse;"> <tr> <th colspan="3">Formation Description</th> </tr> <tr> <td><input checked="" type="checkbox"/> Log</td> <td><input type="checkbox"/> Sample</td> <td></td> </tr> <tr> <th>Name</th> <th>Top</th> <th>Bottom</th> </tr> <tr> <td>Anhydrite</td> <td>1153'</td> <td>(+891')</td> </tr> <tr> <td>Base Anhydrite</td> <td>1186'</td> <td>(+858')</td> </tr> <tr> <td>Heebner</td> <td>3377'</td> <td>(-1333')</td> </tr> <tr> <td>Toronto</td> <td>3393'</td> <td>(-1349')</td> </tr> <tr> <td>Lansing</td> <td>3430'</td> <td>(-1386')</td> </tr> <tr> <td>BKC</td> <td>3691'</td> <td>(-1647')</td> </tr> <tr> <td>Arbuckle</td> <td>3792'</td> <td>(-1748')</td> </tr> <tr> <td>LTD</td> <td>3794'</td> <td>(-1750')</td> </tr> </table>	Formation Description			<input checked="" type="checkbox"/> Log	<input type="checkbox"/> Sample		Name	Top	Bottom	Anhydrite	1153'	(+891')	Base Anhydrite	1186'	(+858')	Heebner	3377'	(-1333')	Toronto	3393'	(-1349')	Lansing	3430'	(-1386')	BKC	3691'	(-1647')	Arbuckle	3792'	(-1748')	LTD	3794'	(-1750')
Formation Description																																		
<input checked="" type="checkbox"/> Log	<input type="checkbox"/> Sample																																	
Name	Top	Bottom																																
Anhydrite	1153'	(+891')																																
Base Anhydrite	1186'	(+858')																																
Heebner	3377'	(-1333')																																
Toronto	3393'	(-1349')																																
Lansing	3430'	(-1386')																																
BKC	3691'	(-1647')																																
Arbuckle	3792'	(-1748')																																
LTD	3794'	(-1750')																																

CASING RECORD New Used
 Report all strings set-conductor, surface, intermediate, production, etc.

Purpose of String	Size Hole Drilled	Size Casing Set (In O.D.)	Weight Lbs./Ft.	Setting Depth	Type of Cement	# Sacks Used	Type and Percent Additives
Surface	12 1/4"	8 5/8"	28#	1163.16	60-40posmix	400	2% gel 3% cc
Production		5 1/2"	14#	3794	50-50posmix Common	65 100	2%gel 7#gilsinit 18% salt

PERFORATION RECORD		Acid, Fracture, Shot, Cement Squeeze Record	
Shots Per Foot	Specify Footage of Each Interval Perforated	(Amount and Kind of Material Used)	Depth
	Open hole 3794'-3496'	500 gal. 28% INS	3796'

TUBING RECORD

Size	Set At	Packer At	Liner Run <input type="checkbox"/> Yes <input type="checkbox"/> No
------	--------	-----------	--

Date of First Production	Producing Method <input type="checkbox"/> Flowing <input type="checkbox"/> Pumping <input type="checkbox"/> Gas Lift <input type="checkbox"/> Other (Explain)						
Estimated Production Per 24 Hours Test	Oil Bbls.	Gas Mcf	Water Bbls.	Gas-Oil Ratio	Gravity		
8-15-91	6.68		82.68				

Disposition of Gas: Vented Sold Used on Lease (If vented, submit ACO-18.)

METHOD OF COMPLETION

Open Hole Perforation Dually Completed Commingled
 Other (Specify) _____

Production Interval OH 3794'-37%

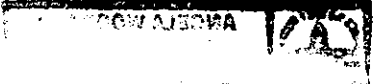

15-165-21550-0000

JUN 1991 ORIGINAL

REPORT OF RUNNING AND CEMENTING CASING

A. L. ABERCROMBIE, INC.

ABERCROMBIE DRILLING, INC.

Date 5-15-91

Lease Name Norman Well No. #1
 Lease Owner/Operator A.L. Abercrombie Inc.
 Drilling Contractor Abercrombie RTD Inc. Rig No. # 8
 Location N-2/SW/NW Sec. 32 Twp 18S Rge 17W County PUSH
 Casing Received From: (Supply) Bovard Inv. No. _____
 Casing Charged To: (Company) A.L. Abercrombie Inc.
 Casing Trucked By: Owl Trucks
 Amount Of Casing Received ~~756~~ 131 Jts. 4162.04 Ft.
 Amount Of Casing Left Over 11 Jts. 343.30 Ft.
 Disposition Of Casing Left Over Return to Bovard

Rotary Bushing T.D. 3795 Ft. Size Of Hole 7 7/8 In.
 Casing Set At: (R.B. To Bottom Of Shoe) 120 Jts. 3794 Ft.
 Size 5 1/4 Weight 14 Thread 8 RD
 Range 2 Grade used Make ✓
 Shoe (Type—Make) Baker Guide Shoe Float Collar (Type—Make) Baker Inset
 Stage Collar (Make—Set At) NO
 Centralizers (Set At) 3770; 3709; 3582; 3498; 3324; 1170; 386

Scratchers (Set At) NO

Cemented With 150 Sacks Of Blended Cement
 Cemented By BJ Titen Plug To: 3769 Ft.
 Plugs (Number—Type) Rubber
 Longstring—R.B. To Top Of Braden Head 7' Ft.
 Surface String—R.B. To Top Of Collar 8' Ft.

Remarks: Run 120 Jts 5 1/2 14* Used Tally 3801 Set 3794 w/
500 gal Salt Flush - 50 Sxs 50/50 poz 270 gal 7" 6il 3/4 of 1% CFR 2
Tailed 100 Sxs Common 1870 Salt Sat. 15 Sxs in Rathole
Plug down @ 2:45 PM 5-15-91

NOTE: All measurements to be made in feet and hundredths.
 All casing to be ran in numerical order of tally.
 Attach tally to back of casing report.

Anthony Hart
 Company Representative

A. L. ABERCROMBIE, Inc.

PIPE TALLY

15-165-2550-0000 DATE 5-9 1991

No. Pcs.	LENGTH		LENGTH		LENGTH		LENGTH		LENGTH	
	Ft.	Ins.	Ft.	Ins.	Ft.	Ins.	Ft.	Ins.	Ft.	Ins.
2	17	85	35	46	OUT					
2	42	57	42	62			1241.45			
3	43	20	37	34			33.98			
4	40	86	43	03			35.46			
5	41	30	40	68			19.85			
6	41	63	42	37			1155.16		TRUCK	
7	42	07	39	74			8		LOADING	
8	39	02	41	97			1163.16		SET	
9	42	57	42	24						
10	38	33	38	17						
11	40	58	33	98	OUT		RTD 1165			
12	42	73								
13	42	78								
14	41	08								
15	38	18								
16	44	02								
17	41	02								
18	42	48								
19	42	43								
20	40	15								
Total	806	85	437	60						

RECEIVED
STATE CORPORATION COMMISSION

AUG 27 1991
8-27-91
CONSERVATION DIVISION
Wichita, Kansas

Col. No.	Stock of	A. L. Abercrombie	
1	Weight	28 ⁰⁰	Size 8 ^{7/8}
2	Grade	used	Coupling Thd 8 RD
3	From	Yield Stock	
4	Sent To	Nocman #1	
5	Remarks		
Total		1244	45

No. Joints 31 Car No. B/L No. Talled By Anthony Mart

Tally Threads on 1252.20

15-165-21550-0000

ORIGINAL

REPORT OF RUNNING AND CEMENTING CASING

A. L. ABERCROMBIE, INC.

ABERCROMBIE DRILLING, INC.

MAY 15 1991

Date 5-9-91

Lease Name Norman Well No. #1
 Lease Owner/Operator A.L. Abercrombie Inc
 Drilling Contractor Abercrombie R.T.D. Inc. Rig No. 8
 Location N/2-SW-NW Sec 32 Twp 18s Rge 12W County _____
 Casing Received From: (Supply) Abercrombie Yard Stock Inv. No. _____
 Casing Charged To: (Company) A.L. Abercrombie Inc
 Casing Trucked By: Our Trucks
 Amount Of Casing Received 31 Jts. 1252.20 (Threads on) Ft.
 Amount Of Casing Left Over 3 Jts. 90.04 (Threads on) Ft.
 Disposition Of Casing Left Over Back To Abec. Yard.

Rotary Bushing T.D. 1165 Ft. Size Of Hole 12 1/4 In.
 Casing Set At: (R.B. To Bottom Of Shoe) 28 Jts. 1163.16 Ft.
 Size 8 5/8 Weight 28 Thread 8 RD
 Range 3 Grade Used Make _____
 Shoe (Type—Make) Texas Slice Float Collar (Type—Make) STATE COMMISSION
 Stage Collar (Make—Set At) _____
 Centralizers (Set At) _____
 Scratchers (Set At) _____

AUG 27 1991
8-27-91

Cemented With 400 Sacks Of 6 3/4 poz 2 3/8 bel 3 3/8 cc Cement
 Cemented By Allied Plug To: 1143.16 Ft.
 Plugs (Number—Type) 1x 8 5/8 Rubber
 Longstring—R.B. To Top Of Braden Head 7' Ft.
 Surface String—R.B. To Top Of Collar 8' Ft.

Remarks: Spudded @ 2:30 P.M. 5-9-91 Ran 28 Jts Used 8 5/8 X 28" Casing
Tally 1155.16 Set 1163.16 7 400 sx 6 3/4 poz 2 3/8 bel 3 3/8 cc
By Allied RTD 1165.16 Survey is (1) WOC 8 hrs Plug Down
12:00 P.M. 5-10-91 Drill Plug @ 12:00 Am 5-11-91

Water: Earl Moore RT 1 Box 94 Rush Center, Ks. 67575 #600⁰⁰

NOTE: All measurements to be made in feet and hundredths.
 All casing to be ran in numerical order of tally.
 Attach tally to back of casing report.

Anthony Mart
 Company Representative