

STATE OF KANSAS  
STATE CORPORATION COMMISSION

WELL PLUGGING RECORD

Give All Information Completely  
Make Required Affidavit  
Mail or Deliver Report to  
Conservation Division  
State Corporation Comm.  
245 North Water  
Wichita, KS 67202

Rush County, Sec. 3 Twp. 18S Rge. 17W E/W  
Location as "NE/CNW $\frac{1}{4}$ SW $\frac{1}{4}$ " or footage from lines  
NE/4 NW/4 SW/4

Lease Owner Frontier Oil Company  
Lease Name Schwartzkopf Well No. 1  
Office Address 1720 KSB&T Building, Wichita, Kansas 67202  
Character of Well (Completed as Oil, Gas or Dry Hole) \_\_\_\_\_

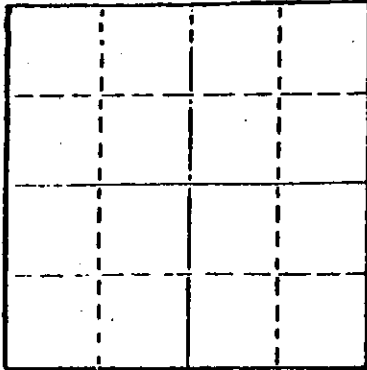

D & A  
Date Well completed March 3, 1980  
Application for plugging filed March 3, 1980  
Application for plugging approved March 3, 1980  
Plugging commenced March 3, 1980  
Plugging completed March 3, 1980  
Reason for abandonment of well or producing formation \_\_\_\_\_

D & A  
If a producing well is abandoned, date of last production \_\_\_\_\_ 19\_\_

Was permission obtained from the Conservation Division or its agents before plugging was commenced? Yes

Name of Conservation Agent who supervised plugging of this well Leo F. Massey  
Producing formation \_\_\_\_\_ Depth to top \_\_\_\_\_ Bottom \_\_\_\_\_ Total Depth of Well 13,615'  
Show depth and thickness of all water, oil and gas formations.

OIL, GAS OR WATER RECORDS

CASING RECORD

FORMATION	CONTENT	FROM	TO	SIZE	PUT IN	PULLED OUT
				8 5/8"	834.29'	-0-

Describe in detail the manner in which the well was plugged, indicating where the mud fluid was placed and the method or methods used in introducing it into the hold. If cement or other plugs were used, state the character of same and depth placed, from \_\_\_\_\_ feet to \_\_\_\_\_ feet for each plug set.

Plugged hole @ 420' w/50 sx cement  
@ 390' w/20 sx cement  
@ 40' w/1/2 sx hole plug & 10 sx cement

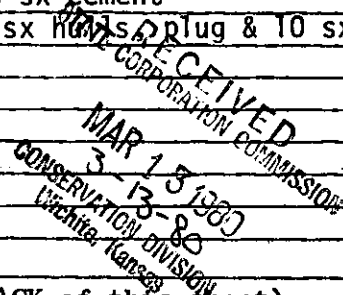

(If additional description is necessary, use BACK of this sheet)

Name of Plugging Contractor Red Tiger Drilling Company  
1720 KSB&T Building, Wichita, Kansas 67202

STATE OF Kansas COUNTY OF Sedgwick, ss.  
Gloria Fawcett (employee of owner) ~~XXXXXXXXXXXXXXXXXXXX~~

of the above-described well, being first duly sworn on oath, says: That I have knowledge of the facts, statements, and matters herein contained and the log of the above-described well as filed and that the same are true and correct. So help me God.

(Signature) Gloria Fawcett  
1720 KSB&T Building, Wichita, Kansas 67202  
(Address)

SUBSCRIBED AND SWORN TO before me this 6th day of March, 19 80.

Joyce A. Hagermann  
Notary Public.

My commission expires \_\_\_\_\_

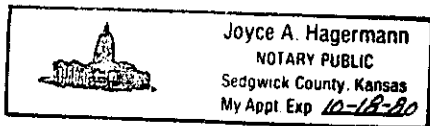

The Kansas Geological Survey needs samples from this well for research. This well penetrates the PreCambrian, the Survey would like to have all the cuttings that contain crystalline samples. This is in addition to the samples normally sent in to the Wichita Well Sample Library.

PLEASE DO NOT REMOVE SAMPLES ON THIS WELL.

**KANSAS DRILLERS LOG**

S. 3 T. 18 R. 17 <sup>E</sup>/<sub>W</sub>  
 Loc. NE NW SW  
 County Rush

API No. 15 — 165 — 20,764 - 0000  
County Number

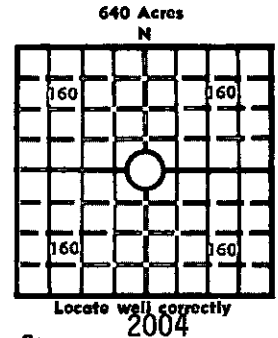

Elev.: Gr. 2004  
 DF 2006 KB 2,009

Operator  
**Frontier Oil Co.**

Address  
**1720 Kansas State Bank Bldg. Wichita, Kansas 67202**

Well No. # 1 Lease Name **Schwartzkopf**

Footage Location **2310 FSL** **990 FWL**  
feet from (N) (S) line feet from (E) (W) line

Principal Contractor **Red Tiger Drilling Company** Geologist **Richard Parker**

Spud Date **February 21, 1980** Total Depth **3,615'** P.B.T.D.

Date Completed **March 3, 1980** Oil Purchaser

**CASING RECORD**

Report of all strings set— surface, intermediate, production, etc.

Purpose of string	Size hole drilled	Size casing set (in O.D.)	Weight lbs/ft.	Setting depth	Type cement	Sacks	Type and percent additives
Surface	12 1/4"	8 5/8"	24#	841.59'	Common	400	3% C.C., 2% Gel

**LINER RECORD**

**PERFORATION RECORD**

Top, ft.	Bottom, ft.	Sacks cement	Shots per ft.	Size & type	Depth interval

**TUBING RECORD**

Size	Setting depth	Packer set at

**ACID, FRACTURE, SHOT, CEMENT SQUEEZE RECORD**

Amount and kind of material used	Depth interval treated

**INITIAL PRODUCTION**

Date of first production \_\_\_\_\_ Producing method (flowing, pumping, gas lift, etc.) \_\_\_\_\_

<b>RATE OF PRODUCTION PER 24 HOURS</b>	Oil _____	Gas _____	Water _____	Gas-oil ratio _____
	bbls.	MCF	bbls.	CFPB

Disposition of gas (vented, used on lease or sold) \_\_\_\_\_ Producing interval (s) \_\_\_\_\_

RECEIVED  
 STATE CORPORATION COMMISSION  
 MAR 18 1980  
 CONSERVATION DIVISION  
 WICHITA, KANSAS

**INSTRUCTIONS:** As provided in KCC Rule 82-2-125, within 90 days after completion of a well, one completed copy of this Drillers Log shall be transmitted to the State Geological Survey of Kansas, 4150 Monroe Street, Wichita, Kansas 67209. Copies of this form are available from the Conservation Division, State Corporation Commission, 3830 So. Meridian (P.O. Box 17027), Wichita, Kansas 66217. Phone AC 316-522-2206. If confidential custody is desired, please note Rule 82-2-125. Drillers Logs will be on open file in the Oil and Gas Division, State Geological Survey of Kansas, Lawrence, Kansas 66044.

Operator **Frontier Oil Company** DESIGNATE TYPE OF COMP.: OIL, GAS,  
DRY HOLE, SWDW, ETC.:  
**D & A**

Well No. **1** Lease Name **Schwartzkopf**

S **3** T **18S** R **17W** E  
W

**WELL LOG**

Show all important zones of porosity and contents thereof; cored intervals, and all drill-stem tests, including depth interval tested, cushion used, time tool open, flowing and shut-in pressures, and recoveries.

SHOW GEOLOGICAL MARKERS, LOGS RUN, OR OTHER DESCRIPTIVE INFORMATION.

FORMATION DESCRIPTION, CONTENTS, ETC.	TOP	BOTTOM	NAME	DEPTH
Clay, Sand & Shale	0	495		
Sand	495	712		
Red Bed	712	1090		
Anhydrite	1090	1119		
Shale	1119	1805		
Lime & Shale	1805	2925		
Lime	2925	3595		
Granite Wash	3595	3615		
RTD		3615		

USE ADDITIONAL SHEETS, IF NECESSARY, TO COMPLETE WELL RECORD.

Date Received \_\_\_\_\_

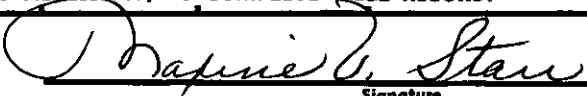
  
 \_\_\_\_\_  
 Signature  
 Office Manager  
 \_\_\_\_\_  
 Title  
 March 11, 1980  
 \_\_\_\_\_  
 Date