

STATE OF KANSAS
STATE CORPORATION COMMISSION

WELL PLUGGING RECORD

Give All Information Completely
Make Required Affidavit
Mail or Deliver Report to
Conservation Division
State Corporation Comm.
245 North Water
Wichita, KS 67202

Rush County. Sec. 10 Twp. 18S Rge. 17W E/W
Location as "NE/CNW 1/4 SW 1/4" or footage from lines
NE/4 NE/4 SE/4

Lease Owner Frontier Oil Company
Lease Name Wilhelm Well No. 1
Office Address 1720 KSB&T Building, Wichita, Kansas 67202
Character of Well (Completed as Oil, Gas or Dry Hole) D & A

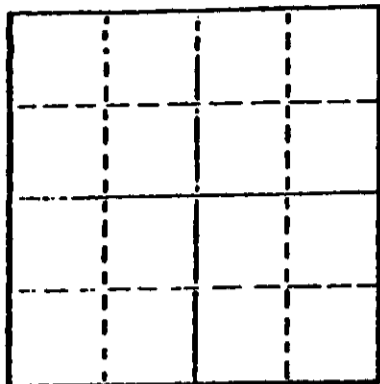

Locate well correctly on above
Section Plat

Date Well completed July 8, 1979
Application for plugging filed July 8, 1979
Application for plugging approved July 8, 1979
Plugging commenced July 8, 1979
Plugging completed July 8, 1979
Reason for abandonment of well or producing formation D & A

If a producing well is abandoned, date of last production 19

Was permission obtained from the Conservation Division or its agents before plugging was commenced? Yes

Name of Conservation Agent who supervised plugging of this well Marion Schmidt
Producing formation _____ Depth to top _____ Bottom _____ Total Depth of Well 3,590
Show depth and thickness of all water, oil and gas formations.

OIL, GAS OR WATER RECORDS

CASING RECORD

FORMATION	CONTENT	FROM	TO	SIZE	PUT IN	PULLED OUT
				8 5/8"	1048.80'	-0-

Describe in detail the manner in which the well was plugged, indicating where the mud fluid was placed and the method or methods used in introducing it into the hold. If cement or other plugs were used, state the character of same and depth placed, from _____ feet to _____ feet for each plug set.

Hole plugged w/60 sx cement @ 600'
10 sx cement @ 40'

5 sx cement in rathole
Cement was 50/50 Pozmix, 4% Gel

RECEIVED
STATE CORPORATION COMMISSION
8-17-79
AUG 17 1979

(If additional description is necessary, use BACK of this sheet)

Name of Plugging Contractor Red Tiger Drilling Company
1720 KSB&T Building, Wichita, Kansas 67202

STATE OF Kansas COUNTY OF Sedgwick, ss.
Gloria Fawcett (employee of owner) or _____

of the above-described well, being first duly sworn on oath, says: That I have knowledge of the facts, statements, and matters herein contained and the log of the above-described well as filed and that the same are true and correct. So help me God.

(Signature) Gloria Fawcett
1720 KSB&T Building, Wichita, Kansas 67202
(Address)

SUBSCRIBED AND SWORN TO before me this 16th day of July, 1979.

Joyce A. Hagermann
Notary Public.

My commission expires _____

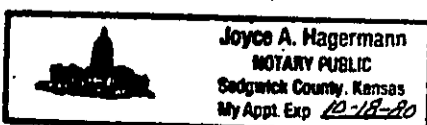

The Kansas Geological Survey needs samples from this well for research. Also, if this well penetrates the PreCambrian, the Survey would like to have all the cuttings that contain crystalline samples.

IMPORTANT
Kans. Geo. Survey request samples on this well.

KANSAS DRILLERS LOG

S. 10 T. 18 R. 17 ²/_W

Loc. NE NE SE

County Rush

API No. 15 — 165 County — 20,726-0000 Number

Operator Frontier Oil Co.

Address 1720 KSB&T Bldg. Wichita, Kansas 67202

Well No. #1 Lease Name Wilhelm

Footage Location
feet from (N) (S) line _____ feet from (E) (W) line _____

Principal Contractor Red Tiger Drilling Company Geologist Richard Parker

Spud Date June 23, 1979 Total Depth 3,590' P.B.T.D. _____

Date Completed July 8, 1979 Oil Purchaser _____

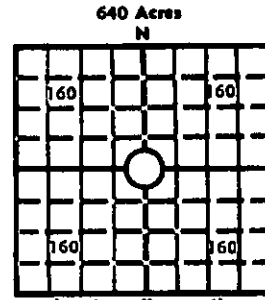

Elev.: Gr. _____

DF _____ KB 1,971'

CASING RECORD

Report of all strings set — surface, intermediate, production, etc.

Purpose of string	Size hole drilled	Size casing set (in O.D.)	Weight lbs/ft.	Setting depth	Type cement	Sacks	Type and percent additives
Surface	12 1/4"	8 5/8"	24#	1,055'	60/40 Pozmix Common	225 200	2% Gel, 3% C.C.

LINER RECORD

PERFORATION RECORD

Top, ft.	Bottom, ft.	Sacks cement	Shots per ft.	Size & type	Depth interval

TUBING RECORD

Size	Setting depth	Pecker set at

ACID, FRACTURE, SHOT, CEMENT SQUEEZE RECORD

Amount and kind of material used	Depth interval treated

RECEIVED
STATE GEOLOGICAL SURVEY

INITIAL PRODUCTION

8-17-79
AUG 17 1979

Date of first production _____ Producing method (flowing, pumping, gas lift, etc.) _____

RATE OF PRODUCTION PER 24 HOURS
Oil _____ Gas _____ Water _____ Gas-oil ratio _____
bbls. MCF bbls. CFPB

Disposition of gas (vented, used on lease or sold) _____ Producing interval (s) _____

INSTRUCTIONS: As provided in KCC Rule 82-2-125, within 90 days after completion of a well, one completed copy of this Drillers Log shall be transmitted to the State Geological Survey of Kansas, 4150 Monroe Street, Wichita, Kansas 67209. Copies of this form are available from the Conservation Division, State Corporation Commission, 3830 So. Meridian (P.O. Box 17027), Wichita, Kansas 66217. Phone AC 316-522-2206. If confidential custody is desired, please note Rule 82-2-125. Drillers Logs will be on open file in the Oil and Gas Division, State Geological Survey of Kansas, Lawrence, Kansas 66044.

15-165-20726-0000

Operator Frontier Oil Company		DESIGNATE TYPE OF COMP.: OIL, GAS, DRY HOLE, SWDW, ETC.: Dry Hole
Well No. 1	Lease Name Wilhelm	
s 10 T 18 S R 17 W ^E W		

WELL LOG

Show all important zones of porosity and contents thereof; cored intervals, and all drill-stem tests, including depth interval tested, cushion used, time tool open, flowing and shut-in pressures, and recoveries.

SHOW GEOLOGICAL MARKERS, LOGS RUN, OR OTHER DESCRIPTIVE INFORMATION.

FORMATION DESCRIPTION, CONTENTS, ETC.	TOP	BOTTOM	NAME	DEPTH
Shales	0	460		
Sand	460	592		
Shale	592	620		
Sand	620	680		
Shale	680	1040		
Anhydrite	1040	1075		
Shale	1075	2800		
Lime	2800	2885		
Lime & Shale	2885	2994		
Lime	2994	3590		
RTD		3590		

RECEIVED
STATE OPERATIONS COMMISSION
8-17-79
AUG 17 1979

USE ADDITIONAL SHEETS, IF NECESSARY, TO COMPLETE WELL RECORD.

Date Received	<p><i>Dorrie V. Star</i></p> <p>Signature</p> <p>Office Manager</p> <p>Title</p> <p>August 16, 1979</p> <p>Date</p>