

15-145-20474-00-00

STATE OF KANSAS
STATE CORPORATION COMMISSION

Give All Information Completely
Make Required Affidavit
Mail or Deliver Report to:
Conservation Division
State Corporation Commission
P. O. Box 17027
Wichita, Kansas 67217
NORTH

WELL PLUGGING RECORD

RUSH County, Sec. 21 Twp. 17S Rge. (E) 20(W)
Location as "NE/CNW/SW" or footage from lines SW SE SE SEC 21-17S-20W
Lease Owner JET DRILLING CO INC & BILL J PORTER
Lease Name RIXON Well No. 2
Office Address 514 ONE TWENTY BUILDING
Character of Well (completed as Oil, Gas or Dry Hole) DRY HOLE
Date well completed OCTOBER 16 1973
Application for plugging filed OCTOBER 16 1973
Application for plugging approved OCTOBER 16 1973
Plugging commenced OCTOBER 16 1973
Plugging completed OCTOBER 16 1973
Reason for abandonment of well or producing formation TOO LOW STRUCTURALLY

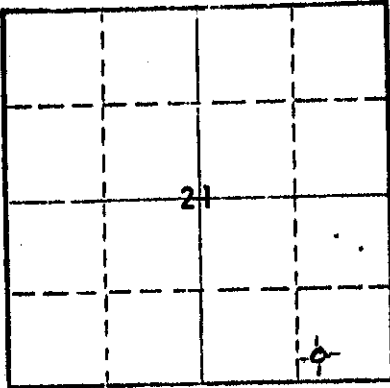

Locate well correctly on above Section Plat

If a producing well is abandoned, date of last production 19
Was permission obtained from the Conservation Division or its agents before plugging was commenced? YES

Name of Conservation Agent who supervised plugging of this well LEO F MASSEY, HAYS, KANSAS
Producing formation _____ Depth to top _____ Bottom _____ Total Depth of Well 4047 Feet
Show depth and thickness of all water, oil and gas formations.

OIL, GAS OR WATER RECORDS

CASING RECORD

FORMATION	CONTENT	FROM	TO	SIZE	PUT IN	PULLED OUT
				8 5/8"	470.90'	NONE

Describe in detail the manner in which the well was plugged, indicating where the mud fluid was placed and the method or methods used in introducing it into the hole. If cement or other plugs were used, state the character of same and depth placed, from _____ feet to _____ feet for each plug set.

FILLED WITH HEAVY MUD TO 550', SET PLUG. PUT IN 50 SACKS CEMENT, FILLED WITH HEAVY MUD TO 240', SET PLUG. PUT IN 25 SACKS CEMENT, FILLED WITH HEAVY MUD TO 40', SET PLUG, FILLED TO TOP WITH 1 SACK HULLS & 10 SACKS CEMENT.

RECEIVED
STATE CORPORATION COMMISSION
OCT 25 1973
CONSERVATION DIVISION
Wichita, Kansas

10-25-1973

(If additional description is necessary, use BACK of this sheet)
Name of Plugging Contractor C-G DRILLING CO.
Address 1107 UNION NATIONAL BUILDING, WICHITA, KANSAS 67202

STATE OF KANSAS, COUNTY OF SEDGWICK ss.
G. F. Galloway (employee of owner) or (owner or operator) of the above-described well, being first duly sworn on oath, says: That I have knowledge of the facts, statements, and matters herein contained and the log of the above-described well as filed and that the same are true and correct. So help me God.

(Signature) G. F. Galloway 1107 Union National Bldg.
(Address)

TESTED AND SWORN TO before me this 19th day of October, 1973

December 7, 1975

Phyllis Buchanan
Phyllis Buchanan Notary Public.



15-145-20474-00-00

KANSAS DRILLERS LOG

S. 21 T. 17S R. 20W^E_W

API No. 15 — RUSH — KANSAS
County Number

Loc. SW SE SE

County RUSH

Operator
JET DRILLING CO INC & BILL J PORTER

Address
514 ONE TWENTY BUILDING

Well No. 2 Lease Name RIXON

Footage Location
330 feet from (X) (S) line 330' feet from (E) (Y) line

Principal Contractor C-G DRILLING CO. Geologist ROGER WELTY

Spud Date OCTOBER 7, 1973 Total Depth 4047' P.B.T.D.

Date Completed OCTOBER 16, 1973 Oil Purchaser

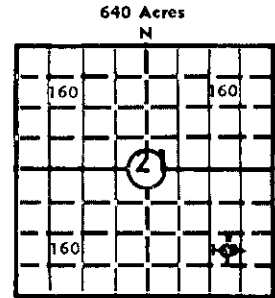

Locate well correctly
 Elev.: Gr. 2148

DF _____ KB 2153

CASING RECORD

Report of all strings set— surface, intermediate, production, etc.

Purpose of string	Size hole drilled	Size casing set (in O.D.)	Weight lbs/ft.	Setting depth	Type cement	Sacks	Type and percent additives
CASING	12 1/4"	8 5/8"	28#	470.90'	COMMON	200	2% GEL 3% CA CL

LINER RECORD

PERFORATION RECORD

Top, ft.	Bottom, ft.	Sacks cement	Shots per ft.	Size & type	Depth interval

TUBING RECORD

Size	Setting depth	Packer set at

ACID, FRACTURE, SHOT, CEMENT SQUEEZE RECORD

Amount and kind of material used	Depth interval treated

RECEIVED
 STATE CORPORATION COMMISSION

OCT 25 1973

CONSERVATION DIVISION
 Wichita, Kansas

10-25-1973

INITIAL PRODUCTION

Date of first production _____ Producing method (flowing, pumping, gas lift, etc.) _____

RATE OF PRODUCTION PER 24 HOURS	Oil	Gas	Water	Gas-oil ratio

Disposition of gas (vented, used on lease or sold) _____ Producing interval(s) _____

INSTRUCTIONS: As provided in KCC Rule 82-2-125, within 90 days after completion of a well, one completed copy of this Drillers Log shall be transmitted to the State Geological Survey of Kansas, 4150 Monroe Street, Wichita, Kansas 67209. Copies of this form are available from the Conservation Division, State Corporation Commission, 3830 So. Meridian (P.O. Box 17027), Wichita, Kansas 66217. Phone AC 316-522-2206. If confidential custody is desired, please note Rule 82-2-125. Drillers Logs will be on open file in the Oil and Gas Division, State Geological Survey of Kansas, Lawrence, Kansas 66044.

Operator **JET DRILLING CO INC & BILL J PORTER** DESIGNATE TYPE OF COMP.: OIL, GAS, DRY HOLE, SWDW, ETC.: **DRY HOLE**

Well No. **2** Lease Name **RIXON**

S 21 T 17 S R 20 ^X/_W

WELL LOG

Show all important zones of porosity and contents thereof; cored intervals, and all drill-stem tests, including depth interval tested, cushion used, time tool open, flowing and shut-in pressures, and recoveries.

SHOW GEOLOGICAL MARKERS, LOGS RUN, OR OTHER DESCRIPTIVE INFORMATION.

FORMATION DESCRIPTION, CONTENTS, ETC.	TOP	BOTTOM	NAME	DEPTH
SHALE	0	800		
SAND	800	1080		
SHALE & SAND	1080	1090		
RED BED	1090	1386		
ANHYDRITE	1386	1418		
SHALE & SHELLS	1418	1650		
SHALE	1650	1960		
SHALE & LIME	1960	3730		
LIME	3730	4047		
RTD	4047			
<p>DST #1 4026-4040 OPEN 30 SI 30 OPEN 60 SI 45 REC 5' OIL 290' WATER IBHP 551# FBHP 551# IFP 48# FFP 167#</p> <p>MISRUN 4044'</p> <p>DST #2 4039'-4047 OPEN 60 SI 30 OPEN 60 SI 30 REC 180' MUDDY OIL WATER IBHP 540# FBHP 540# IFP 43# FFP 87#</p>				

USE ADDITIONAL SHEETS, IF NECESSARY, TO COMPLETE WELL RECORD.

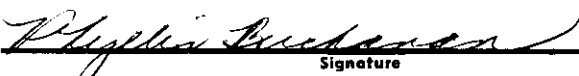
Date Received	 Signature
	Office Manager Title
	October 19, 1973 Date