

FORM MUST BE TYPED
FORM C-1 4/90

EFFECTIVE DATE: 9-4-90

State of Kansas

(CORRECTED AS PER
*) SHOWN

Correction
FORM MUST BE SIGNED

ALL BLANKS MUST BE FILLED

Must be approved by the K.C.C. five (5) days prior to commencing well

Expected Spud Date September 24 1990
month day year

120' South of
NW. NE. SW. Sec 24. Twp 18. S, Rg 18. X East
X West

OPERATOR: License # 5027
Name: J. A. Allison
Address: 300 West Douglas, Suite 305
City/State/Zip: Wichita, Kansas 67202
Contact Person: J. A. Allison
Phone: (316) 263-2241

2190' feet from South line of Section
3630' feet from East line of Section
(Note: Locate well on Section Plat on Reverse Side)

CONTRACTOR: License # 5122
Name: Woodman-Iannitti Drilling Co.

County: RUSH
Lease Name: HABERMAN Well #: 4
Field Name: Rudi

Well Drilled For: Well Class: Type Equipment:
X Oil ... Inj X Infield X Mud Rotary
... Gas ... Storage ... Pool Ext. ... Air Rotary
... OWO ... Disposal ... Wildcat ... Cable
... Seismic; ... # of Holes

Is this a Prorated Field? ... yes X no
Target Formation(s): Arbuckle
Nearest lease or unit boundary: 330'
Ground Surface Elevation: 1986 feet MSI
Domestic well within 330 feet: ... yes X no
Municipal well within one mile: ... yes X no
Depth to bottom of fresh water: 150
Depth to bottom of usable water: 550
Surface Pipe by Alternate: X 1 ... 2
Length of Surface Pipe Planned to be set: 1120'
Length of Conductor pipe required: None
Projected Total Depth: 3720'
Formation at Total Depth: Arbuckle

If OWO: old well information as follows:
Operator: _____
Well Name: _____
Comp. Date: _____ Old Total Depth _____

Water Source for Drilling Operations:
... well ... farm pond X other
DWR Permit #: _____
Will Cores Be Taken?: ... yes X no
If yes, proposed zone: _____

Directional, Deviated or Horizontal wellbore? ... yes X no
If yes, total depth location: _____

WAS: 2316 FSL

AFFIDAVIT

IS: 2190 FSL

The undersigned hereby affirms that the drilling, completion and eventual plugging of this well will comply with K.S.A. 55-101, et. seq.

It is agreed that the following minimum requirements will be met:

1. The appropriate district office shall be notified before setting surface pipe;
2. The minimum amount of surface pipe as specified above shall be set by circulating cement to the top; in all cases surface pipe shall be set through all unconsolidated materials plus a minimum of 20 feet into the underlying formation;
3. If the well is dry, a plugging proposal shall be submitted to the district office. An agreement between the operator and the district office on plug length and placement is necessary prior to plugging;
4. The appropriate district office will be notified before well is either plugged or production casing is cemented in;
5. If an Alternate II completion, production pipe shall be cemented from below any usable water to surface within 120 days of spud date. In all cases, notify district office prior to any cementing.

I hereby certify that the statements made herein are true and to the best of my knowledge and belief.

Date: September 6, 1990 Signature of Operator or Agent: J. A. Allison Title: Operator

FOR KCC USE:

API # 15- 165-21,534-0000

Conductor pipe required None feet

Minimum surface pipe required 570 feet per Alt. (1)

Approved by: MPW 9-7-90 8-30-90

EFFECTIVE DATE: 9-4-90

This authorization expires: 2-28-91

(This authorization void if drilling not started within 6 months of effective date.)

Spud date: _____ Agent: _____

RECEIVED
STATE OF KANSAS - COMMISSIONER

SEP 7 1990
9-7-90
CONSERVATION DIVISION
Wichita, Kansas

24
18
1840

REMEMBER TO:

- File Drill Pit Application (form CDP-1) with Intent to Drill;
- File Completion Form ACO-1 within 120 days of spud date;
- File acreage attribution plat according to field proration orders;
- Notify appropriate district office 48 hours prior to workover or re-entry;
- Submit plugging report (CP-4) after plugging is completed;
- Obtain written approval before disposing or injecting salt water.

PLAT OF ACREAGE ATTRIBUTABLE TO A WELL

State Corporation Commission, Conservation Division
200 Colorado Derby Bldg. Wichita, Kansas 67202

OPERATOR J. A. ALLISON LOCATION OF WELL:
 LEASE HABERMAN (*) 2190 feet north of SE corner
 WELL NUMBER #4 3630 feet west of SE corner
 FIELD Rudi Sec. 24 T 18 R 18 NE/W
 COUNTY RUSH
 NO. OF ACRES ATTRIBUTABLE TO WELL 10 IS SECTION X REGULAR IRREGULAR?
 DESCRIPTION OF ACREAGE SW/4 IF IRREGULAR, LOCATE WELL FROM NEAREST
 CORNER BOUNDARY.

NOTE: If plat depicted is insufficient for your circumstances, you may attach your own scaled or surveyed plat.

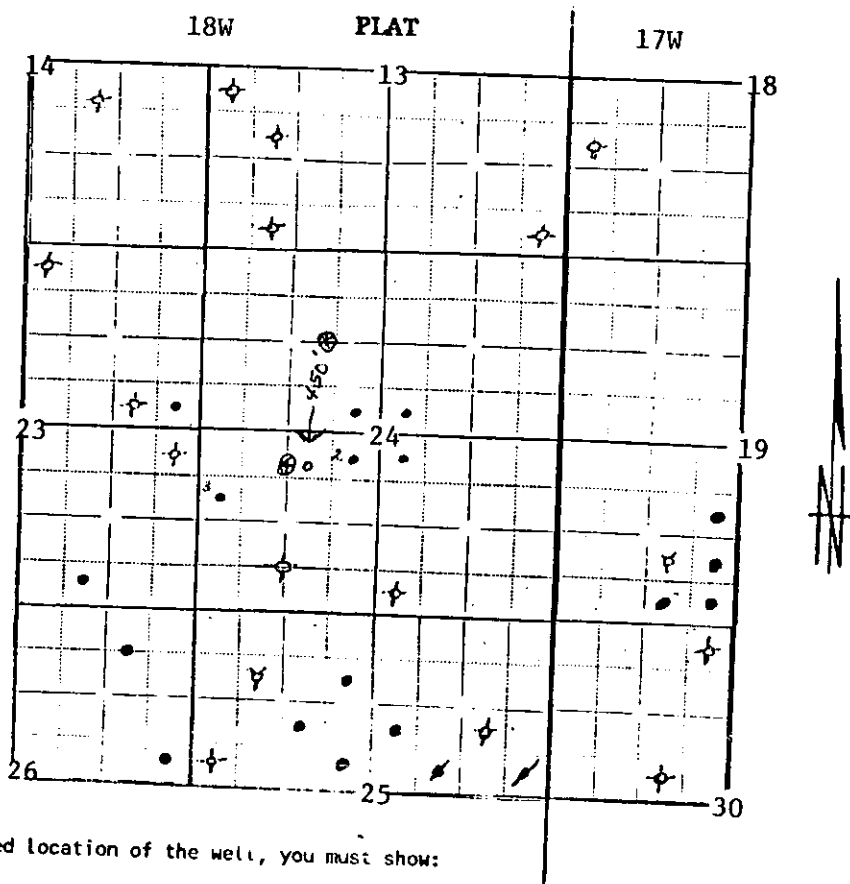

In plotting the proposed location of the well, you must show:

- 1) The manner in which you are using the depicted plat by identifying section lines, i.e. 1 section, 1 section with 8 surrounding partial sections, 4 sections, 16 sections, etc.;
- 2) the well's location relative to the location of other wells producing from the same common source or supply in adjoining drilling units, pursuant to K.A.R. 82-3-108, 82-3-207, 82-3-312, or special orders of the Commission;
- 3) the distance of the proposed drilling location from the section's east and south lines; and
- 4) the distance to the nearest lease or unit boundary line.

I hereby certify that the statements made herein are true and to the best of my knowledge and belief.

Signature of Operator or Agent J. A. Allison
 Date Sept. 6, 1990 Title Operator