

FOR KCC USE:

FORM C-1 7/91

EFFECTIVE DATE: 2-14-96

FORM MUST BE TYPED

DISTRICT # 1

State of Kansas

FORM MUST BE SIGNED

SEAT Yes No

NOTICE OF INTENTION TO DRILL

ALL BLANKS MUST BE FILLED

Must be approved by the K.C.C. five (5) days prior to commencing well

Expected Spud Date February 20, 1996

Spot NE NE SE Sec 2 Twp 18 S. Rg 19 East West

OPERATOR: License # 3869 IMPERIAL OIL PROPERTIES, INC. Address: 212 N. MARKET ST., #513 WICHITA, KS 67202 Contact Person: Robert L. Williams, Jr. Phone: (316) 265-6977

2,310 feet from South line of Section 330 feet from East line of Section IS SECTION X REGULAR IRREGULAR?

CONTRACTOR: License #: 5929 DUKE DRILLING COMPANY, INC.

(NOTE: Locate well on the Section Plat on Reverse Side) County: RUSH Lease Name: PIVONKA TRUST "A" Well #: 1 Field Name: Wildcat

Well Drilled For: Well Class: Type Equipment: X Oil Enh Rec Infield X Mud Rotary Gas Storage Pool Ext. Air Rotary CWMO Disposal X Wildcat Cable Seismic: # of Holes Other

Is this a Prorated/Spaced Field? yes X no Target Formation(s): Arbuckle Nearest lease or unit boundary: 330 feet Ground Surface Elevation: 2078 feet MSL

If CWMO: old well information as follows: Operator: Well Name: Comp. Date: Old Total Depth

* Water well within one-quarter mile: X yes no Public water supply well within one mile: yes X no Depth to bottom of fresh water: 180 feet Depth to bottom of usable water: 380 feet

Directional, Deviated or Horizontal wellbore? yes X no If yes, true vertical depth: Bottom Hole Location

Surface Pipe by Alternate: X 1 2 Length of Surface Pipe Planned to be set: 1,275 feet Length of Conductor pipe required: Projected Total Depth: 3,985 feet

Formation at Total Depth: ARBICKLE Water Source for Drilling Operations: well farm pond X other

DWR Permit #: Will Cores Be Taken?: yes X no If yes, proposed zone:

AFFIDAVIT

*Note An old abandoned farmstead and water well is adjacent to the drill-site

The undersigned hereby affirms that the drilling, completion and eventual plugging of this well will comply with K.S.A. 55-101, et. seq.

It is agreed that the following minimum requirements will be met:

- 1. Notify the appropriate district office prior to spudding of well; 2. A copy of the approved notice of intent to drill shall be posted on each drilling rig; 3. The minimum amount of surface pipe as specified below shall be set by circulating cement to the top; in all cases surface pipe shall be set through all unconsolidated materials plus a minimum of 20 feet into the underlying formation; 4. If the well is dry hole, an agreement between the operator and the district office on plug length and placement is necessary prior to plugging; 5. The appropriate district office will be notified before well is either plugged or production casing is cemented in; 6. IF AN ALTERNATE II COMPLETION, PRODUCTION PIPE SHALL BE CEMENTED FROM BELOW ANY USABLE WATER TO SURFACE WITHIN 120 DAYS OF SPUD DATE. IN ALL CASES, NOTIFY DISTRICT OFFICE PRIOR TO ANY CEMENTING.

I hereby certify that the statements made herein are true and to the best of my knowledge and belief.

Date: February 8, 1996 Signature of Operator or Agent: Robert L. Williams Title: President

FOR KCC USE: API # 15- 165-216930000 Conductor pipe required NONE feet Minimum surface pipe required 400 feet per Alt. (1) Approved by: K 2-9-96 This authorization expires: 8-9-96 (This authorization void if drilling not started within 6 months of effective date.) Spud date: Agent:

RECEIVED KANSAS CORPORATION COMMISSION

FEB 09 1996

2-9-96

CONSERVATION DIVISION WICHITA, KS

REMEMBER TO:

- File Drill Pit Application (form CDP-1) with Intent to Drill; - File Completion Form ACO-1 within 120 days of spud date; - File acreage attribution plat according to field proration orders; - Notify appropriate district office 48 hours prior to workover or re-entry; - Submit plugging report (CP-4) after plugging is completed; - Obtain written approval before disposing or injecting salt water.

Mail to: Conservation Division, 200 Colorado Derby Building, 202 W. First St., Wichita, Kansas 67202-1286.

IN ALL CASES PLOT THE INTENDED WELL ON THE PLAT BELOW

PLAT OF ACREAGE ATTRIBUTABLE TO A WELL IN A PRORATED OR SPACED FIELD

If the intended well is in a prorated or spaced field, please fully complete this side of the form. If the intended well is in a prorated or spaced field complete the plat below showing that the well will be properly located in relationship to other wells producing from the common source of supply. Please show all the wells within 1 mile of the boundaries of the proposed acreage attribution unit for gas wells and within 1/2 mile of the boundaries of the proposed acreage attribution unit for oil wells.

API NO. 15- _____
 OPERATOR IMPERIAL OIL PROPERTIES, INC.
 LEASE PIVONKA TRUST "A"
 WELL NUMBER 1
 FIELD Wildcat

LOCATION OF WELL: COUNTY RUSH
2,310 feet from south/north line of section
330 feet from east/west line of section
 SECTION 2 TWP 18S RG 19W

NUMBER OF ACRES ATTRIBUTABLE TO WELL _____
 QTR/QTR/QTR OF ACREAGE NE - NE - SE

IS SECTION X REGULAR or _____ IRREGULAR
IF SECTION IS IRREGULAR, LOCATE WELL FROM NEAREST CORNER BOUNDARY.

Section corner used: _____ NE _____ NW _____ SE _____ SW
PLAT

(Show location of the well and shade attributable acreage for prorated or spaced wells.)
 (Show footage to the nearest lease or unit boundary line.)

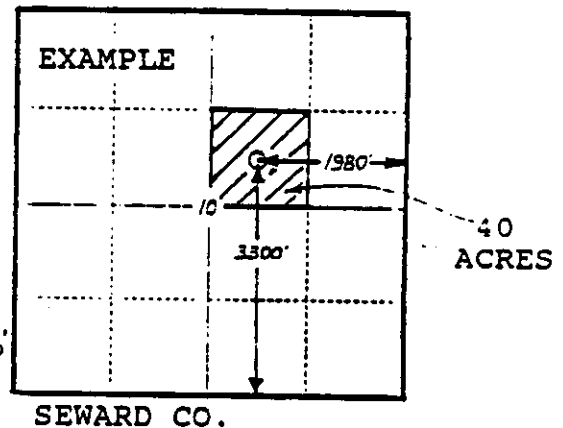
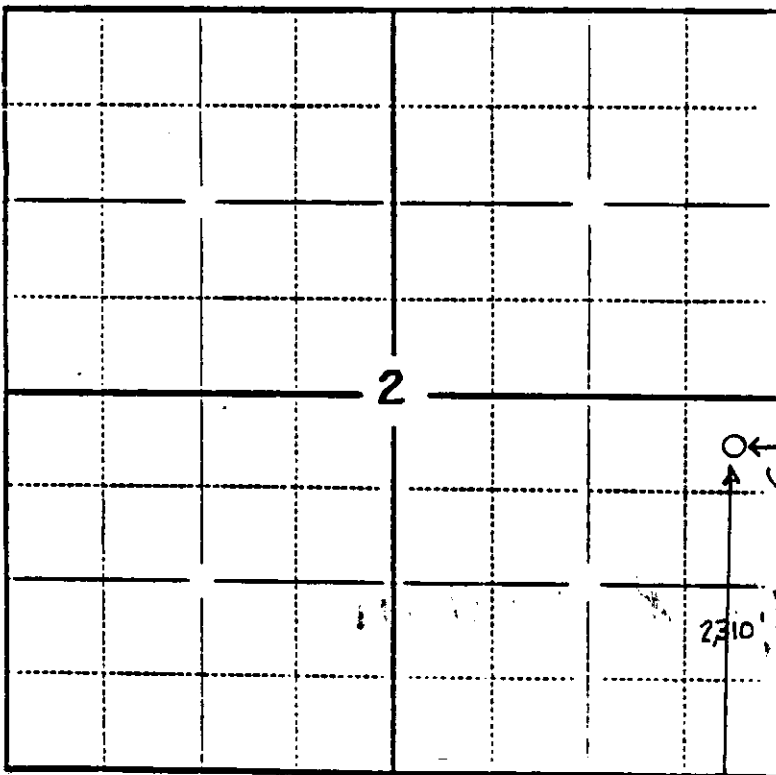

In plotting the proposed location of the well, you must show:

- 1) The manner in which you are using the depicted plat by identifying section lines, i.e. 1 section, 1 section with 8 surrounding sections, 4 sections, etc.;
- 2) the distance of the proposed drilling location from the section's south/north and east/west lines; and
- 3) the distance to the nearest lease or unit boundary line.