

FOR KCC USE:

FORM C-1 7/91

EFFECTIVE DATE: 10-13-93

FORM MUST BE TYPED

DISTRICT # 1

State of Kansas  
NOTICE OF INTENTION TO DRILL

FORM MUST BE SIGNED

SEAT Yes No

Must be approved by the K.C.C. five (5) days prior to commencing well

ALL BLANKS MUST BE FILLED

Expected Spud Date 10-9-93  
month day year

50' <sup>Spot</sup> S. NE. SW. NW. Sec. 33. Twp. 18. S. Rg. 20. East West

OPERATOR: License # 30444 ✓  
Name: CHARTER PRODUCTION COMPANY  
Address: 224 E. Douglas, Suite 400  
City/State/Zip: Wichita, Kansas 67202  
Contact Person: Jerald W. Rains  
Phone: 316-264-2808

1700' feet from ~~XXXX~~ North line of Section  
990' feet from ~~XXXX~~ West line of Section  
IS SECTION X REGULAR IRREGULAR?

(NOTE: Locate well on the Section Plat on Reverse Side)

County: RUSH

Lease Name: FRANK Well #: 1

Field Name:

Is this a Prorated/Spaced Field? yes X no ✓

Target Formation(s): Cherokee/Mississippi

Nearest lease or unit boundary: 990' ✓

Ground Surface Elevation: 2139' feet NSL

Water well within one-quarter mile: yes X no ✓

Public water supply well within one mile: yes X no ✓

Depth to bottom of fresh water: 420' ✓

Depth to bottom of usable water: 440' ✓

Surface Pipe by Alternate: 1 X 2

Length of Surface Pipe Planned to be set: (360') 200' ✓

Length of Conductor pipe required: NA ✓

Projected Total Depth: 4250' ✓

Formation at Total Depth: Mississippi ✓

Water Source for Drilling Operations:

well X farm pond other ✓

DWR Permit #:

Will Cores Be Taken?: yes X no ✓

If yes, proposed zone:

CONTRACTOR: License #: 5929 ✓  
Name: Duke Drilling Co.

Well Drilled For: Well Class: Type Equipment:

X Oil ... Enh Rec ... Infield X Mud Rotary  
X Gas ... Storage ... Pool Ext. ... Air Rotary  
OWVO ... Disposal X Wildcat ... Cable  
Seismic; ... # of Holes ... Other  
Other

If OWVO, old well information as follows:

Operator:

Well Name:

Comp. Date: Old Total Depth

Directional, Deviated or Horizontal wellbore? yes X no

If yes, true vertical depth:

Bottom Hole Location:

AFFIDAVIT

The undersigned hereby affirms that the drilling, completion and eventual plugging of this well will comply with K.S.A. 55-101, et. seq.

It is agreed that the following minimum requirements will be met:

- 1. Notify the appropriate district office prior to spudding of well;
- 2. A copy of the approved notice of intent to drill shall be posted on each drilling rig;
- 3. The minimum amount of surface pipe as specified below shall be set by circulating cement to the top; in all cases surface pipe shall be set through all unconsolidated materials plus a minimum of 20 feet into the underlying formation;
- 4. If the well is dry hole, an agreement between the operator and the district office on plug length and placement is necessary prior to plugging;
- 5. The appropriate district office will be notified before well is either plugged or production casing is cemented in;
- 6. IF AN ALTERNATE IS COMPLETED, PRODUCTION PIPE SHALL BE CEMENTED FROM BELOW ANY USABLE WATER TO SURFACE WITHIN 120 DAYS OF SPUD DATE. IN ALL CASES, NOTIFY DISTRICT OFFICE PRIOR TO ANY CEMENTING.

I hereby certify that the statements made herein are true and to the best of my knowledge and belief.

Date October 7, 1993 Signature of Operator or Agent: Jerald W. Rains Title: Operations Manager

FOR KCC USE:  
API # 15- 165 - 21643 - 0000  
Conductor pipe required None feet  
Minimum surface pipe required 200' feet per Alt. X(2)  
Approved by: CR 10-8-93  
This authorization expires: 4-8-94  
(This authorization void if drilling not started within 6 months of effective date.)  
Spud date: Agent:

REMEMBER TO:

- File Drill Pit Application (form CDP-1) with Intent to Drill;
- File Completion Form ACO-1 within 120 days of spud date;
- File acreage attribution plat according to field proration orders;
- Notify appropriate district office 48 hours prior to workover or re-entry;
- Submit plugging report (CP-4) after plugging is completed;
- Obtain written approval before disposing or injecting salt water.

Mail to: Conservation Division, 200 Colorado Derby Building, 202 W. First St., Wichita, Kansas 67202-1286.

33  
18  
20

IN ALL CASES PLOT THE INTENDED WELL ON THE PLAT BELOW.

**PLAT OF ACREAGE ATTRIBUTABLE TO A WELL IN A PRORATED OR SPACED FIELD**

If the intended well is in a prorated or spaced field, please fully complete this side of the form. If the intended well is in a prorated or spaced field complete the plat below showing that the well will be properly located in relationship to other wells producing from the common source of supply. Please show all the wells within 1 mile of the boundaries of the proposed acreage attribution unit for gas wells and within 1/2 mile of the boundaries of the proposed acreage attribution unit for oil wells.

API NO. 15- \_\_\_\_\_  
 OPERATOR Charter Production Company LOCATION OF WELL: COUNTY RUSH  
 LEASE Frank 1700' feet from ~~XXXXX~~ north line of section  
 WELL NUMBER #1 990' feet from ~~XXXXX~~ west line of section  
 FIELD 50'S NE SW NW SECTION 33 TWP 18s RG 20w

NUMBER OF ACRES ATTRIBUTABLE TO WELL \_\_\_\_\_ IS SECTION X REGULAR or \_\_\_\_\_ IRREGULAR  
 QTR/QTR/QTR OF ACREAGE \_\_\_\_\_ IF SECTION IS IRREGULAR, LOCATE WELL FROM NEAREST  
CORNER BOUNDARY.

Section corner used: \_\_\_\_\_ NE \_\_\_\_\_ NW \_\_\_\_\_ SE \_\_\_\_\_ SW

**PLAT**

(Show location of the well and shade attributable acreage for prorated or spaced wells.)  
 (Show footage to the nearest lease or unit boundary line.)

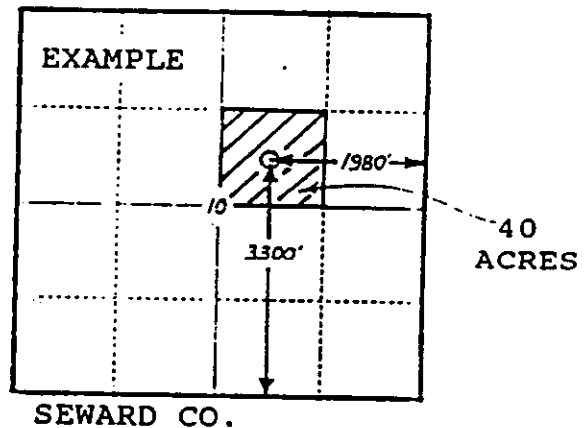
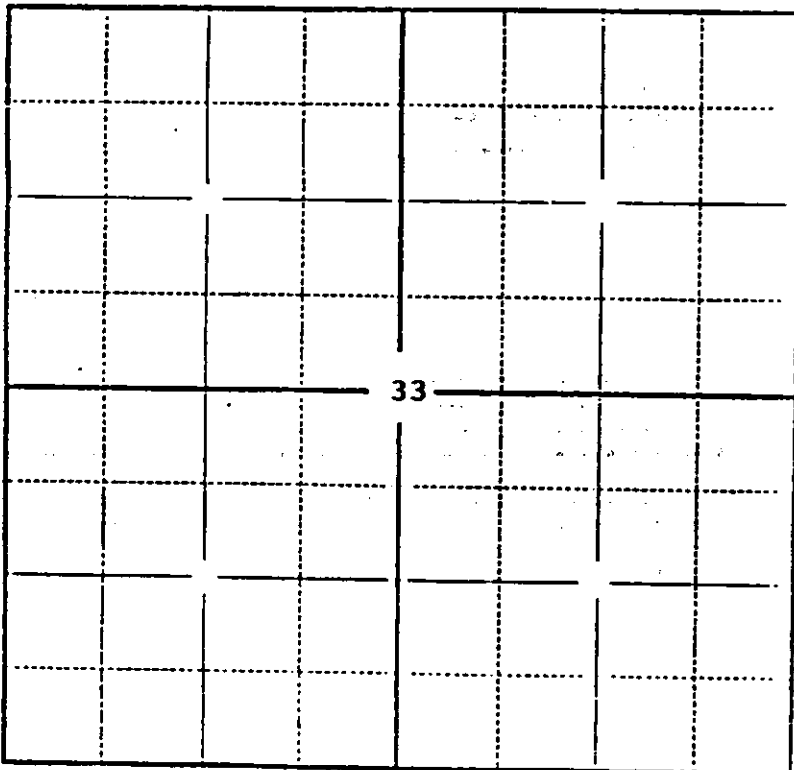

In plotting the proposed location of the well, you must show:

- 1) The manner in which you are using the depicted plat by identifying section lines, i.e. 1 section, 1 section with 8 surrounding sections, 4 sections, etc.;
- 2) the distance of the proposed drilling location from the section's south/north and east/west lines; and
- 3) the distance to the nearest lease or unit boundary line.