

FOR KCC USE:

FORM C-1 7/91

FORM MUST BE TYPED

FORM MUST BE SIGNED

ALL BLANKS MUST BE FILLED

EFFECTIVE DATE: 10-25-99

DISTRICT # 1

SGA? Yes No

State of Kansas
NOTICE OF INTENTION TO DRILL

Must be approved by the K.C.C. five (5) days prior to commencing well.

Expected Spud Date 11 10 99
month day year

Spot SE NE Sec 33 Twp 18 S, Rg 20 East West

OPERATOR: License # KLN #9408
Name: Trans Pacific Oil Corporation
Address: 100 South Main, Suite 200
City/State/Zip: Wichita, KS 67202
Contact Person: Alan D. Banta
Phone: (316) 262-3596

1980 feet from South / North line of Section
660 feet from East / West line of Section
IS SECTION REGULAR IRREGULAR?

(NOTE: locate well on the Section Plat on Reverse Side)

County: Rush
Lease Name: Showalter Well #: I
Field Name: Wildcat Belle Prairie SE

CONTRACTOR: License # KLN #5929
Name: Duke Drilling Company

Is this a Prorated/Spaced Field? yes no

Target Formation(s): Cherokee Sand

Nearest lease or unit boundary: 660'

Ground Surface Elevation: Est 2170 feet MSL

Water well within one-quarter mile: yes no

Public water supply well within one mile: yes no

Depth to bottom of fresh water: 280'

Depth to bottom of usable water: 480' 620' PERMAN

Surface Pipe by Alternate: 1 2

Length of Surface Pipe Planned to be set: 300'

Length of Conductor pipe required: None

Projected Total Depth: 4250'

Formation at Total Depth: Mississippian

Water Source for Drilling Operations:

... well farm pond ... other

Well Drilled For: Well Class: Type Equipment:
 Oil ... Enh Rec Infield Mud Rotary
... Gas ... Storage ... Pool Ext. ... Air Rotary
... O/WO ... Disposal ... Wildcat ... Cable
... Seismic; ... # of Holes ... Other
... Other
If O/WO: old well information as follows:
Operator: N/A
Well Name:
Comp. Date: Old Total Depth

Directional, Deviated or Horizontal wellbore? ... yes no
If yes, true vertical depth:
Bottom Hole Location:

Will Cores Be Taken? ... yes no
If yes, proposed zone:

AFFIDAVIT

The undersigned hereby affirms that the drilling, completion and eventual plugging of this well will comply with K.S.A. 55-101, et. seq.

It is agreed that the following minimum requirements will be met:

- 1. Notify the appropriate district office prior to spudding of well;
- 2. A copy of the approved notice of intent to drill shall be posted on each drilling rig;
- 3. The minimum amount of surface pipe as specified below shall be set by circulating cement to the top; in all cases surface pipe shall be set through all unconsolidated materials plus a minimum of 20 feet into the underlying formation;
- 4. If the well is dry hole, an agreement between the operator and the district office on plug length and placement is necessary prior to plugging;
- 5. The appropriate district office will be notified before well is either plugged or production casing is cemented in;
- 6. IF AN ALTERNATE II COMPLETION, PRODUCTION PIPE SHALL BE CEMENTED FROM BELOW ANY USABLE WATER TO SURFACE WITHIN 120 DAYS OF SPUD DATE. IN ALL CASES, NOTIFY DISTRICT OFFICE PRIOR TO ANY CEMENTING.

I hereby certify that the statements made herein are true and to the best of my knowledge and belief.

Date: 10/18/99 Signature of Operator or Agent [Signature] Title: Senior Vice President

FOR KCC USE:
API # 15- 165-217210000
Conductor pipe required NONE feet
Minimum surface pipe required 300 feet per Alt. X(2)
Approved by: JK 10-20-99
This authorization expires: 4-20-2000
(This authorization void if drilling not started within 6 months of effective date.)
Spud date: Agent:

RECEIVED
KANSAS CORP COMS
1999 OCT 19 A 11:36
10-19-99
33
18
20W

- REMEMBER TO:
- File Drill Pit Application (form CDP-1) with Intent to Drill;
 - File Completion Form ACO-1 within 120 days of spud date;
 - File acreage attribution plat according to field proration orders;
 - Notify appropriate district office 48 hours prior to workover or re-entry;
 - Submit plugging report (CP-4) after plugging is completed;
 - Obtain written approval before disposing or injecting salt water.

Mail to: KCC - Conservation Division, 130 S. Market - Room 2078, Wichita, Kansas 67202.

IN ALL CASES PLOT THE INTENDED WELL ON THE PLAT BELOW

PLAT OF ACREAGE ATTRIBUTABLE TO A WELL IN A PRORATED OR SPACED FIELD

If the intended well is in a prorated or spaced field, please fully complete this side of the form. If the intended well is in a prorated or spaced field complete the plat below showing that the well will be properly located in relationship to other wells producing from the common source of supply. Please show all the wells within 1 mile of the boundaries of the proposed acreage attribution unit for gas wells and within 1/2 mile of the boundaries of the proposed acreage attribution unit for oil wells.

API NO. 15- _____
 OPERATOR Trans Pacific Oil Corporation LOCATION OF WELL: COUNTY Rush
 LEASE Showalter "A" #1 _____ 1980 feet from south/north line of section
 WELL NUMBER 1 _____ 660 feet from east/west line of section
 FIELD Wildcat _____ SECTION 33 TWP 18S RG 20W

NUMBER OF ACRES ATTRIBUTABLE TO WELL 40 IS SECTION X REGULAR or _____ IRREGULAR
 QTR/QTR/QTR OF ACREAGE _____ - SE - NE IF SECTION IS IRREGULAR, LOCATE WELL FROM NEAREST
 CORNER BOUNDARY.

Section corner used: X NE _____ NW _____ SE _____ SW

PLAT

(Show location of the well and shade attributable acreage for prorated or spaced wells.)
 (Show footage to the nearest lease or unit boundary line.)

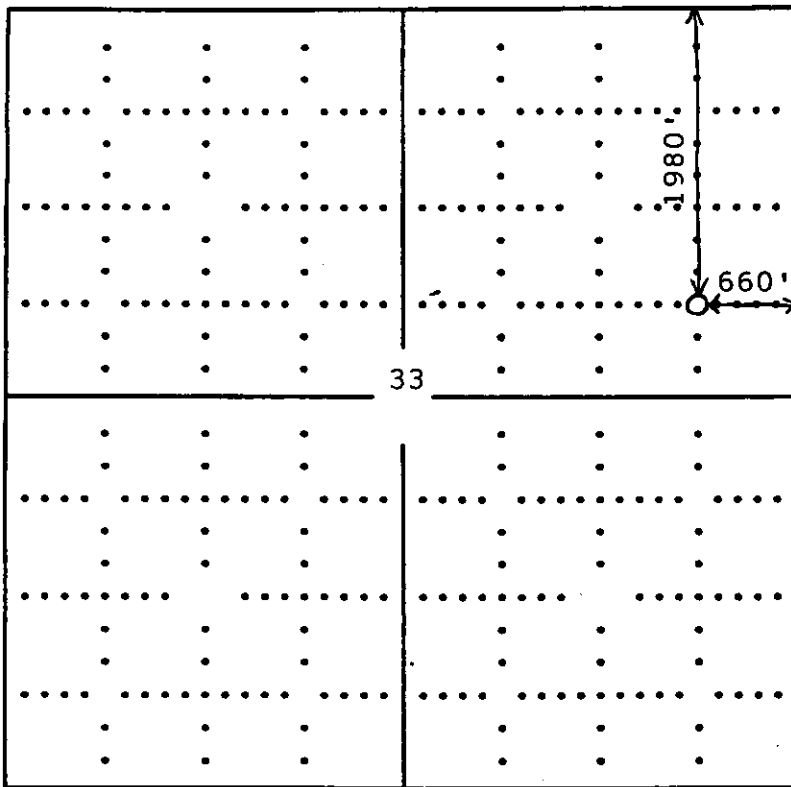

Rush County

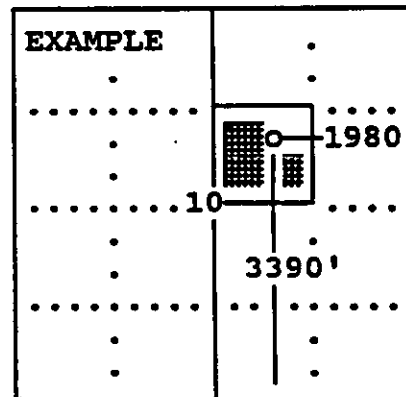

SEWARD CO.

In plotting the proposed location of the well, you must show:

- 1) The manner in which you are using the depicted plat by identifying section lines, i.e. 1 section, 1 section with 8 surrounding sections, 4 sections, etc.;
- 2) the distance of the proposed drilling location from the section's south/north and east/west; and
- 3) the distance to the nearest lease or unit boundary line.