

CARD MUST BE TYPED

State of Kansas

CARD MUST BE SIGNED

NOTICE OF INTENTION TO DRILL

(see rules on reverse side)

Starting Date 10 month 16 day 87 year

API Number 15-165-21,387-0000

OPERATOR: License # 6177

SW NW SW Sec. 32 Twp. 17 S, Rg. 17 East West

Name Foxfire Exploration, Inc.

Address 1022 Union Center

City/State/Zip Wichita, Kansas 67202

Contact Person Gary Fisher (913)743-5654

Phone or D.C. Marchant (805)549-0690

CONTRACTOR: License # 8430

Name Foxfire Drilling Co., Inc.

City/State Box 133, Wakeeney, Kansas 67672

Well Drilled For: Well Class: Type Equipment:

Oil SWD Infield Mud Rotary

Gas Inj Pool Ext. Air Rotary

OWWO Expl Wildcat Cable

If OWWO: old well info as follows:

Operator

Well Name

Comp Date Old Total Depth

I certify that well will comply with K.S.A. 55-101, et seq., plus eventually plugging hole to KCC specifications.

Date 10/5/87 Signature of Operator or Agent *D.C. Marchant* Title: President

For KCC Use:

Conductor Pipe Required feet; Minimum Surface Pipe Required 420 feet per Alt.

This Authorization Expires 3-23-87 Effective Approved By *Feb 9-23-87*

9-28-87

1650 Ft. from South Line of Section
4950 Ft. from East Line of Section

(Note: Locate well on Section Plat on reverse side)

Nearest lease or unit boundary line 330 feet

County Rush

Lease Name Edwards Well # 1

Ground surface elevation est. 2015 feet MSL

Domestic well within 330 feet: yes no

Municipal well within one mile: yes no

Depth to bottom of fresh water 350 feet

Depth to bottom of usable water 400 feet

Surface pipe by Alternate: 1 2

Surface pipe planned to be set 1100'

Conductor pipe required N.A.

Projected Total Depth 3625 feet

Formation Penn. Sand

DA

Must be filed with the K.C.C. five (5) days prior to commencing well
This card void if drilling not started within six (6) months of date received by K.C.C.

Important procedures to follow:

1. Notify District office before setting surface casing.
2. Set surface casing by circulating cement to the top.
3. File completion forms ACO-1 with K.C.C. within 90 days of well completion, following instructions on ACO-1, side 1, and including copies of wireline logs.
4. Notify District office 48 hours prior to old well workover or re-entry.
5. Prior to filing Intent, prepare a proposed plugging plan in case well is D & A, then obtain approval of plan when calling district office prior to setting surface pipe.
6. Submit plugging report (CP-4) to K.C.C. after plugging is completed.
7. Obtain an approved injection docket number before disposing of salt water.
8. Notify K.C.C. within 10 days when injection commences or terminates.
9. If an alternate 2 completion, cement in the production pipe from below any usable water to surface within 120 days of spud date.

A Regular Section of Land 1 Mile = 5,280 Ft.

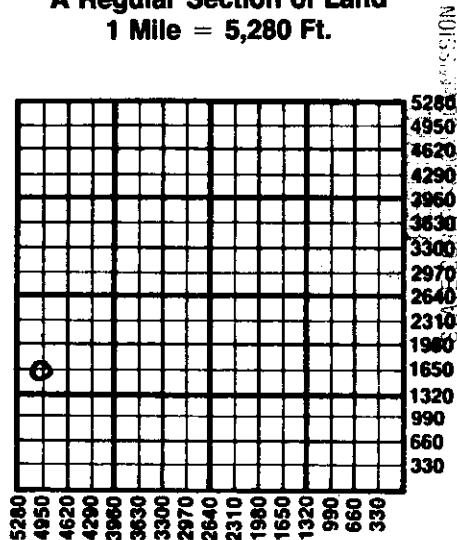

State Corporation Commission of Kansas
Conservation Division
200 Colorado Derby Building
Wichita, Kansas 67202
(316) 263-3238