

STATE OF KANSAS
STATE CORPORATION COMMISSION

WELL PLUGGING RECORD

Give All Information Completely
Make Required Affidavit
Mail or Deliver Report to
Conservation Division
State Corporation Comm.
245 North Water
Wichita, KS 67202

Rush County, Sec. 34 Twp. 17S Rge. 17W E/W
Location as "NE/CNW $\frac{1}{4}$ SW $\frac{1}{4}$ " or footage from lines
NE/4 NE/4 SW/4

Lease Owner Frontier Oil Company
Lease Name Reinhardt Well No. 1
Office Address 1720 KSB&T Building, Wichita, Kansas 67202
Character of Well (Completed as Oil, Gas or Dry Hole)
D & A

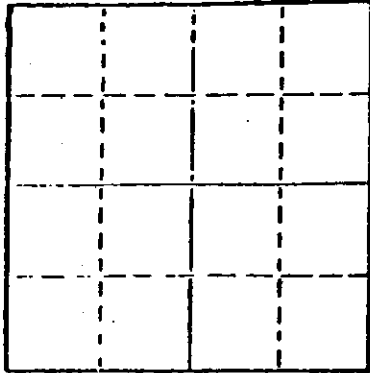

Locate well correctly on above
Section Plat

Date Well completed March 7, 1980
Application for plugging filed March 7, 1980
Application for plugging approved March 7, 1980
Plugging commenced March 7, 1980
Plugging completed March 7, 1980
Reason for abandonment of well or producing formation
D & A

If a producing well is abandoned, date of last production
19

Was permission obtained from the Conservation Division or
its agents before plugging was commenced? Yes

Name of Conservation Agent who supervised plugging of this well Marion Schmidt
Producing formation _____ Depth to top _____ Bottom _____ Total Depth of Well 3,610'
Show depth and thickness of all water, oil and gas formations.

OIL, GAS OR WATER RECORDS

CASING RECORD

FORMATION	CONTENT	FROM	TO	SIZE	PUT IN	PULLED OUT
				8 5/8"	831.91'	-0-

Describe in detail the manner in which the well was plugged, indicating where the mud fluid was placed and the method or methods used in introducing it into the hold. If cement or other plugs were used, state the character of same and depth placed, from _____ feet to _____ feet for each plug set.

1st Plug @ 780' w/60 sx cement
2nd Plug @ 420' w/30 sx cement
1/2 sx Hulls, plug @ 40' w/10 sx cement
50/50 Pozmix

STATE RECEIVED
CONSERVATION COMMISSION
4-16-80
APR 16 1980
CONSERVATION DIVISION
WICHITA, KANSAS

(If additional description is necessary, use BACK of this sheet)

Name of Plugging Contractor Red Tiger Drilling Company
1720 KSB&T Building, Wichita, Kansas 67202

STATE OF Kansas COUNTY OF Sedgwick, ss.
Gloria Fawcett (employee of owner)

of the above-described well, being first duly sworn on oath, says: That I have knowledge of the facts, statements, and matters herein contained and the log of the above-described well as filed and that the same are true and correct. So help me God.

(Signature) Gloria Fawcett
1720 KSB&T Building, Wichita, Kansas 67202
(Address)

SUBSCRIBED AND SWORN TO before me this 11th day of March, 1980.

Joyce A. Hagermann
Notary Public.

My commission expires _____

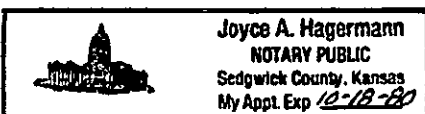

The Kansas Geological Survey needs samples from this well for research. If this well penetrates the PreCambrian, the Survey at Lawrence would like to have all the cuttings that contain crystalline samples. This is in addition to the samples normally sent in to the Wichita Well Sample Library.

State Geol. Survey
 4150 Monroe Street
 Lawrence, Kansas 66044

KANSAS DRILLERS LOG

S. 34 T. 17 R. 17 ^R/_W

API No. 15 — 165 — 20,765 — 0000
 County Number

Loc. NE NE SW

Operator
Frontier Oil Co.

County Rush

Address
1720 Kansas State Bank Bldg. Wichita, Kansas 67202

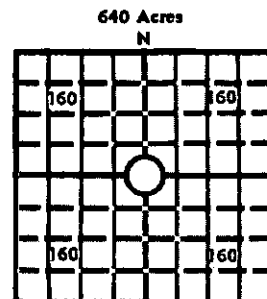

Well No. #1 Lease Name Reinhardt

Elev.: Gr. 2,019'

Footage Location
 feet from (N) (S) line feet from (E) (W) line

Principal Contractor Red Tiger Drilling Company Geologist Richard Parker

Spud Date February 27, 1980 Total Depth 3,610' P.B.T.D.

Date Completed March 7, 1980 Oil Purchaser

DF _____ KB _____

CASING RECORD

Report of all strings set — surface, intermediate, production, etc.

Purpose of string	Size hole drilled	Size casing set (in O.D.)	Weight lbs/ft.	Setting depth	Type cement	Sacks	Type and percent additives
Surface	12 1/4"	8 5/8"	24#	838.91'	Common	400	3% C.C., 2% Gel

LINER RECORD

PERFORATION RECORD

Top, ft.	Bottom, ft.	Sacks cement	Shots per ft.	Size & type	Depth interval

TUBING RECORD

Size	Setting depth	Packer set at

ACID, FRACTURE, SHOT, CEMENT SQUEEZE RECORD

Amount and kind of material used	Depth interval treated

STATE RECEIVED
 CONSERVATION COMMISSION
 4-16-80
 APR 16 1980
 CONSERVATION DIVISION
 Wichita, Kansas

INITIAL PRODUCTION

Date of first production	Producing method (flowing, pumping, gas lift, etc.)
RATE OF PRODUCTION PER 24 HOURS	Oil Gas Water Gas-oil ratio
Disposition of gas (vented, used on lease or sold)	Producing interval(s)

INSTRUCTIONS: As provided in KCC Rule 82-2-125, within 90 days after completion of a well, one completed copy of this Drillers Log shall be transmitted to the State Geological Survey of Kansas, 4150 Monroe Street, Wichita, Kansas 67209. Copies of this form are available from the Conservation Division, State Corporation Commission, 3830 So. Meridian (P.O. Box 17027), Wichita, Kansas 66217. Phone AC 316-522-2206. If confidential custody is desired, please note Rule 82-2-125. Drillers Logs will be on open file in the Oil and Gas Division, State Geological Survey of Kansas, Lawrence, Kansas 66044.

Operator **Frontier Oil Company** DESIGNATE TYPE OF COMP.: OIL, GAS, DRY HOLE, SWDW, ETC.: **D & A**

Well No. **1** Lease Name **Reinhardt**

S 34 T 17S R 17W ^E/_W

WELL LOG

Show all important zones of porosity and contents thereof; cored intervals, and all drill-stem tests, including depth interval tested, cushion used, time tool open, flowing and shut-in pressures, and recoveries.

SHOW GEOLOGICAL MARKERS, LOGS RUN, OR OTHER DESCRIPTIVE INFORMATION.

FORMATION DESCRIPTION, CONTENTS, ETC.	TOP	BOTTOM	NAME	DEPTH
Sand & Shale	0	375		
Surface Clay	375	498		
Sand	498	730		
Shale	730	1095		
Anhydrite	1095	1127		
Shale	1127	2100		
Shale & Lime	2100	2755		
Lime & Shale	2755	3030		
Lime	3030	3530		
Lime & Sand	3530	3570		
Lime	3570	3610		
RTD		3610		

USE ADDITIONAL SHEETS, IF NECESSARY, TO COMPLETE WELL RECORD.

Date Received	<i>Drapine & Starr</i>
	Signature
	Office Manager
	Title
	April 15, 1980
	Date