

KANSAS CORPORATION COMMISSION
OIL & GAS CONSERVATION DIVISION

Form ACO-4
Form must be typed
September 2005

APPLICATION FOR COMMINGLING OF
PRODUCTION (K.A.R. 82-3-123) OR FLUIDS (K.A.R. 82-3-123a)

Commingling ID # CD100806

Operator Information:

License #: 5003
Name: McCoy Petroleum Corporation
Address: 8080 E. Central, Suite #300
City/State/Zip: Wichita, KS 67206-2366
Contact Person: Brent B. Reinhardt
Phone #: 316-686-2737 x 128

Well Information:

API #: 15-051-25797-00-00
Lease Name: MADDEN "A" Well #: #2-21
Spot: SW SE SE Sec 21 Twp. 12 S. Rng. 18 East
County: Ellis West
Feet from North / South Line of Section
Feet from East / West Line of Section

X 1. Name and upper and lower limit of each production interval to be commingled:

Formation: <u>Arbuckle</u>	(Perfs): <u>PF: 3642-3647'</u>
Formation: <u>Conglomerate</u>	(Perfs): <u>PF: 3634-3639'</u>
Formation: <u>Lansing 'B'</u>	(Perfs): <u>PF: 3410-3414'</u>
Formation: _____	(Perfs): _____
Formation: _____	(Perfs): _____

X 2. Estimated amount of fluid production to be commingled from each interval:

Formation: <u>Arbuckle</u>	BOPD: <u>20</u>	MCFPD: <u>0</u>	BWPD: <u>10</u>
Formation: <u>Conglomerate</u>	BOPD: <u>20</u>	MCFPD: <u>0</u>	BWPD: <u>10</u>
Formation: <u>Lansing 'B'</u>	BOPD: <u>40</u>	MCFPD: <u>0</u>	BWPD: <u>20</u>
Formation: _____	BOPD: _____	MCFPD: _____	BWPD: _____
Formation: _____	BOPD: _____	MCFPD: _____	BWPD: _____

X 3. Plat map showing the location of the subject well, all other wells on the subject lease, and all wells on offsetting leases within a 1/2 mile radius of the subject well, and for each well the names and addresses of the lessee of record or operator.

X 4. Signed certificate showing service of the application as required in K.A.R. 82-3-135a(b).

For Commingling of PRODUCTION ONLY, include the following:

- X 5. Wireline log of subject well. **Already submitted to the KCC**
X 6. Complete Form ACO-1 (Well Completion form) for the subject well. **Already submitted to the KCC**

For Commingling of FLUIDS ONLY include the following:

- _____ 5. Well construction diagram of subject well.
_____ 6. Any available water chemistry data demonstrating the compatibility of the fluids to be commingled.

State of Kansas)
) SS:
County of Sedgwick)

VERIFICATION: I hereby certify that to the best of my current information, knowledge and personal belief, this request for commingling is true and proper and I have no information or knowledge, which is inconsistent with the information supplied in this application.

Signature: *Scott Hampel*
Printed Name: Scott Hampel
Title: Vice President - Production
Subscribed & sworn to before me this 27th day of October, 2008
Notary Public: *Brent B Reinhardt*
Brent B. Reinhardt
My Commission Expires: 12/7/2011

RECEIVED
KANSAS CORPORATION COMMISSION
OCT 29 2008
CONSERVATION DIVISION
WICHITA, KS

KCC Office Use Only
 Denied Approved
KCC Date Received: _____ 15-Day Periods Ends: 11/25/08
Approved By: _____ Date: _____

BRENT B. REINHARDT
Notary Public - State of Kansas
My Appt. Expires 12/7/2011

Affidavit of Notice Served

Re: Application for: McCoy Petroleum Corporation Commingling of Production (K.A.R. 82-3-123) or Fluids (K.A.R. 82-3-123a)

Well Name: MADDEN "A" #2-21 Legal Location: SW SE SE, Sec 21-12s-18w, Ellis County, KS

The undersigned hereby certifies that he / she is a duly authorized agent for the applicant, and that on the day 27th of October, 2008

a true and correct copy of the application referenced above was delivered or mailed to the following parties:

Note: A copy of this affidavit must be served as a part of the application.

Name and Address (Attach additional sheets if necessary) Name and Address (Attach additional sheets if necessary) Name and Address (Attach additional sheets if necessary)

Clement J. Karlin
P.O.Box 726
Hays, KS 67601
NE/4, Sec 21-12s-18w

Fred & Pam Joy
2073 250th Ave.,
Hays, KS 67601
NW/4 tract, Sec 21-12s-18w

Heartland Flatbed Transport, LLC
1109 Amhurst Street
Hays, KS 67601
NW/4 tract, Sec 22-12s-18w

Michael & Theresa A. Madden
1310 W 45th Street
Hays, KS 67601
SE/4, Sec 21-12s-18w

Robert Threlkel
1550 Locust Grove Road
Hays, KS 67601
NW/4 tract, Sec 21-12s-18w

The Wichita Eagle
Official State Newspaper
Legal Notices Department
P.O. Box 820
Wichita, KS 67201-0820

Todd F. Staab
1960 280th Ave.
Hays, KS 67601
SW/4, Sec 21-12s-18w

Hurst Family Revocable Trust
2316 Timber Drive
Hays, KS 67601
NE/4 tract, Sec 28-12s-18w

Hays Daily News
Official County Newspaper
Legal Notices Department
P.O. Box 857
Hays, KS 67601

Donald & Linda L. Joy
230 Green Acres Drive
Granite Shoals, TX 78654
NW/4, Sec 21-12s-18w

Paul McRae
1616 Locust Grove Road
Hays, KS 67601
W/2, Sec 22-12s-18w

Western Coop Electric Assoc., Inc.
P.O. Box 278
Wakeeney, KS 67672
NW/4, Sec 21-12s-18w

Marvin Braun
500 E 55th Street
Hays, KS 67601
NW/4 tract, Sec 22-12s-18w

RECEIVED
KANSAS CORPORATION COMMISSION

OCT 29 2008

CONSERVATION DIVISION
WICHITA, KS

I further attest that notice of the filing of this application is to be published in the Wichita Eagle, the official state newspaper and the Hays Daily News, the official county newspaper. A copy of the affidavit of this publication will be forwarded once published.

Signed this 27th day of October, 2008

Applicant of Duly Authorized Agent Scott Hampel, Vice President - Production

Subscribed and sworn to before me this 27th day of October, 2008

Notary Public

My Commission Expires: 12/7/2011

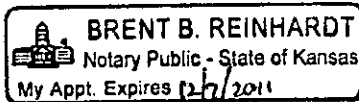

Protests may be filed by any party having a valid interest in the application. Petitions for protests shall be in writing and shall clearly identify the name and address of the protestant and the title of the application. The petition shall include a clear and concise statement of the direct and substantial interest of the protestant in the proceedings, including the manner in which the protestant may be affected, and the nature, extent, character and grounds of the protest. Protestants shall serve the protest upon the applicant by mail or personal service at the same time or before the protestant files the protest with the Conservation Division.



Kathleen Sebelius, Governor
Thomas E. Wright, Chairman
Michael C. Moffet, Commissioner
Joseph F. Harkins, Commissioner

February 24, 2009

Brent Reinhardt
McCoy Petroleum Corporation
8080 E. Central, Suite #300
Wichita, KS 67206-2366

RE: Approved Commingling CO100806
Madden "A" 2-21, Sec. 21-T12S-R18W, Ellis County
API No. 15-051-25797-00-00

Dear Mr. Reinhardt:

Your Application for Commingling (ACO-4) for the above described well has been reviewed and approved by the Kansas Corporation Commission (KCC) per K.A.R. 82-3-123. Notice was examined and found to be proper per K.A.R. 82-3-135a. No protest had been filed within the 15-day protest period. This application, which was received by the KCC on October 29, 2008 concerns approval to simultaneously produce from the following sources of supply through the same tubing string in the same wellbore:

Source of Supply	Estimated Current Production			Perf Depth
	BOPD	MCFPD	BWPD	
Arbuckle	20	0	10	3642-3647
Conglomerate	20	0	10	3634-3639
Lansing 'B'	40	0	20	3410-3414
Total Estimated Current Production	80	0	40	

Based upon the depth of the Arbuckle formation perforations, total oil production shall not exceed 100 BOPD and total gas production shall not exceed 50% of the absolute open flow (AOF).

Docket Number CO100806 has been assigned to this approved application. Use this number for well completion reports (ACO-1) and other correspondence that may concern this approved commingling.

Sincerely,

Rick Hestermann
Production Department

PLAT AND CERTIFICATION OF ACREAGE ATTRIBUTABLE TO A OIL WELL

Kansas Corporation Commission, Conservation Division
 Finney state office Building, 130 South Market, Room 2078 Wichita, Kansas 67202

API NUMBER: 15-051-25737
 OPERATOR: McCoy Petroleum Corporation
 LEASE: MADDEN "A" #2-21
 WELL NUMBER: #2-21
 FIELD: Bemis-Shutts
 NUMBER OF ACRES ATTRIBUTABLE TO WELL: 160
 QTR/QTR/QTR OF ACREAGE: SE

LOCATION OF WELL: COUNTY: Ellis
 LOCATION OF WELL: SW SE SE
330 feet from N S Line of Section
990 feet from E W Line of Section
 SECTION 21 TWP 12 (S) RNG 18 E W
 IS SECTION REGULAR or IRREGULAR
 IF SECTION IS IRREGULAR, LOCATE WELL FROM NEAREST
 CORNER BOUNDARY. (check line below)
 Section corner used: NE NW SE SW

(Show the location of the well and shade attributable acreage for prorated or spaced wells).
 (Show the footage to the nearest lease or unit boundary line, and show footage to the nearest common source supply well).

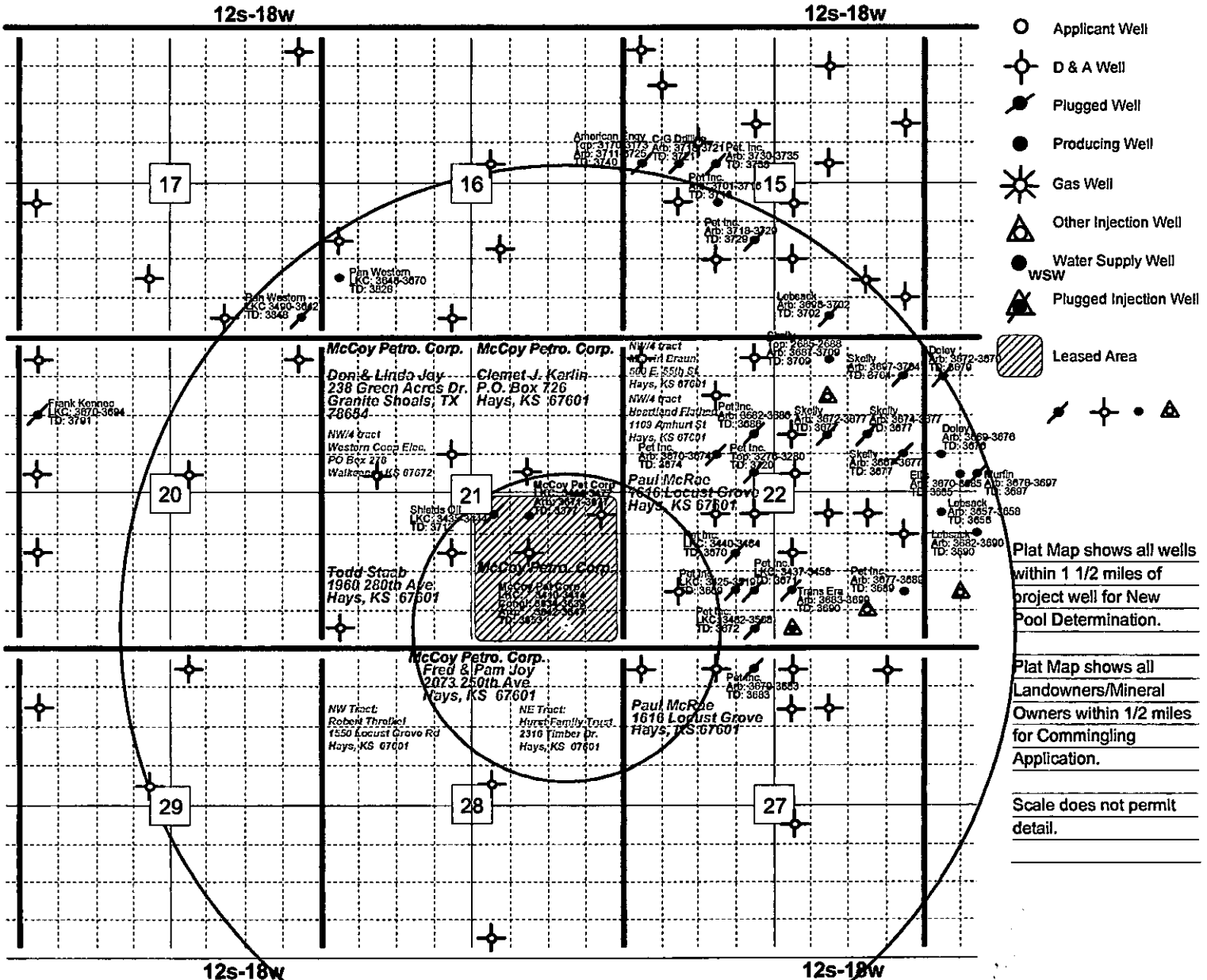

- Applicant Well
- D & A Well
- Plugged Well
- Producing Well
- Gas Well
- Other Injection Well
- Water Supply Well WSW
- Plugged Injection Well
- Leased Area

Plat Map shows all wells within 1 1/2 miles of project well for New Pool Determination.

Plat Map shows all Landowners/Mineral Owners within 1/2 miles for Commingling Application.

Scale does not permit detail.

The undersigned hereby certifies as Vice President - Production (title) for McCoy Petroleum Corporation (Co.), a duly authorized agent, that all information shown hereon is true and correct to the best of my knowledge and belief, that all acreage claimed attributable to the well named herein is held by production from that well and hereby make application for an allowable to be assigned to the well upon the filing of this form and the State test, whichever is later.

Signature _____

Scott Hampel
 Scott Hampel

Subscribed and sworn to before me on this 27th day of October, 2008

BRENT B. REINHARDT
 Notary Public - State of Kansas
 My Appt. Expires 12/7/2011

Brent B Reinhardt
 Brent B Reinhardt
 Notary Public

My Commission expires: _____

12/7/2011

RECEIVED
KANSAS COMMISSION ON
ARTS AND LETTERS
OCT 03 2008
KANSAS COMMISSION ON
ARTS AND LETTERS
WICHITA, KS



Natural Gas • Crude Oil
Exploration & Production

McGOY PETROLEUM CORPORATION

8080 E. Central, Suite 300
Wichita, KS 67206-2366

316-636-2737
316-636-2741 (Fax)

MEMO

October 27, 2008

Fm: Scott Hampel
To: Offset Operator, Landowner or Unleased Mineral Owner
Subj: MADDEN "A" #2-21, SW SE SE, Sec 21-12s-18w, Ellis County, KS

Enclosed For Your Information (FYI) is a copy of an application we have filed with the Kansas Corporation Commission on the above subject well. No Action Is Required on your part.

Sincerely yours,

A handwritten signature in cursive script that reads 'Scott Hampel'.

Scott Hampel
Vice President - Production

RECEIVED
KANSAS CORPORATION COMMISSION

OCT 29 2008

CONSERVATION DIVISION
WICHITA, KS

AFFIDAVIT OF PUBLICATION

State of Kansas, Ellis County, ss:

Mary Karst

being first duly sworn, deposes and says:

That he/she is Advertising Manger of THE HAYS DAILY NEWS, a daily newspaper printed in the State of Kansas, and published in and of general circulation in Ellis County, Kansas, with a general paid circulation on a yearly basis in Ellis County, Kansas, and that said newspaper is not a trade, religious or fraternal publication.

Said newspaper is published daily, except Saturday, is published at least weekly 50 times a year; has been so published continuously and uninterrupted in said county and state for a period of more than five years prior to the first publication of said notice; and has been admitted at the post office of Hays in said county as second class matter.

That the attached notice is a true copy thereof and was published in the regular and entire issue of said newspaper for 1 consecutive day, the first publication thereof being made as aforesaid on the 31st day of October, 2008, with subsequent publications being made on the following dates:

_____	20	_____	20
_____	20	_____	20
_____	20	_____	20

Mary Karst

Subscribed and sworn to before me this 31st day of October, 2008.

[Signature]
Notary Public

My Appointment expires 5-28-09
Printer's Fee..... \$50.82
Additional copies..... \$
Total Fee..... \$50.82

(Published in The Hays Daily News
October 31, 2008)
BEFORE THE STATE
CORPORATION COMMISSION OF
THE STATE OF KANSAS

NOTICE OF FILING APPLICATION
RE: McCoy Petroleum Corporation—
Application for the commingling of
production from various zones.

TO: All Oil and Gas Producers,
Unleased Minerals Interest
Owners, Landowners, and all
persons whomsoever concerned.
You, and each of you, are hereby
notified that McCoy Petroleum
Corporation has filed an application
to commingle the Arbuckle,
Conglomerate and Lansing Kansas
City zones in their MADDEN "A" #2-
21, located SW SE SE, Section 21-
12s-18w, Ellis County, Kansas.

Any persons who object to or protest
this application shall be required to
file their objections or protests with
the Conservation Division of the State
Corporation Commission of the State
of Kansas within fifteen (15) days from
the date of this publication. These
protests shall be filed pursuant to the
Commission regulations and must
state specific reasons why the grant
of the application may cause waste,
violate correlative rights or pollute
the natural resources of the state of
Kansas. If no protests are received,
this application may be granted
through a summary proceeding. If
valid protests are received, this matter
will be set for hearing.

All persons interested or concerned
shall take notice of the forgoing and
shall govern themselves accordingly.
McCoy Petroleum Corporation
By Scott Hampel
Vice President-Production
8080 E. Central, Suite #300
Wichita, KS 67206-2366
316-636-2737
Scott Hampel

RE
NOV
MCCOY,
CORP.

RECEIVED
KANSAS CORPORATION COMMISSION

NOV 14 2008

CONSERVATION DIVISION
WICHITA KS

NOTARY PUBLIC - State of Kansas
JANICE C. JINKEL
My Appt. Exp. 5-28-09