

KANSAS CORPORATION COMMISSION
OIL & GAS CONSERVATION DIVISION

Form ACO-4
Form must be typed
July 2006

APPLICATION FOR COMMINGLING OF
PRODUCTION (K.A.R. 82-3-123) OR FLUIDS (K.A.R. 82-3-123a)

Commingling ID # CO 120801

Operator Information:

License #: 5135
Name: John O. Farmer, Inc.
Address: P.O. Box 352
City/State/Zip: Russell, KS 67665
Contact Person: Marge Schulte
Phone #: (785) 483-3145, Ext. 214

Well Information:

API #: 15 - 051-25,802-00-00
Lease Name: Dreiling "A" Well #: 1
Spot: SE - NW - SW - SW Sec. 23 Twp. 12 S. R. 16 East
County: Ellis West
Feet from North / South Line of Section: 970
Feet from East / West Line of Section: 650

1. Name and upper and lower limit of each production interval to be commingled:

Formation: Penn Sand (Perfs): 3395-99'
Formation: Lansing "D" (Perfs): 3185-90'
Formation: _____ (Perfs): _____
Formation: _____ (Perfs): _____
Formation: _____ (Perfs): _____

2. Estimated amount of fluid production to be commingled from each interval:

Formation: Penn Sand BOPD: 4.30 MCFPD: _____ BWPD: 0
Formation: Lansing "D" BOPD: 60.00 MCFPD: _____ BWPD: 0
Formation: _____ BOPD: _____ MCFPD: _____ BWPD: _____
Formation: _____ BOPD: _____ MCFPD: _____ BWPD: _____
Formation: _____ BOPD: _____ MCFPD: _____ BWPD: _____

3. Plat map showing the location of the subject well, all other wells on the subject lease, and all wells on offsetting leases within a 1/2 mile radius of the subject well, and for each well the names and addresses of the lessee of record or operator.

4. Signed certificate showing service of the application and affidavit of publication as required in K.A.R. 82-3-135a.

For Commingling of PRODUCTION ONLY, include the following:

- 5. Wireline log of subject well.
- 6. Complete Form ACO-1 (Well Completion form) for the subject well. *log w/ plot + 20-10*

For Commingling of FLUIDS ONLY, include the following:

- 5. Well construction diagram of subject well.
- 6. Any available water chemistry data demonstrating the compatibility of the fluids to be commingled.

State of Kansas)
)
County of Russell)

ss:

VERIFICATION: I hereby certify that to the best of my current information, knowledge and personal belief, this request for commingling is true and proper and I have no information or knowledge, which is inconsistent with the information supplied in this application.

Signature: John O. Farmer III
Printed Name: John O. Farmer III
Title: President

Subscribed & sworn to before me this 8th day of December, 20 08

Notary Public: Margaret A. Schulte

My Commission Expires: _____

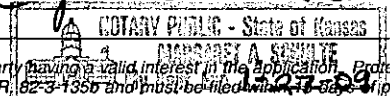

Protests may be filed by any party having a valid interest in the application. Protests must be in writing and comply with K.A.R. 82-3-135b and must be filed within 90 days of publication of the notice of application.

RECEIVED
KANSAS CORPORATION COMMISSION
DEC 09 2008
CONSERVATION DIVISION
WICHITA, KS

KCC Office Use Only
 Denied Approved
KCC Date Received: _____ 15-Day Periods Ends: 1/22/09
Approved By: _____ Date: _____

January 22, 2009

Marge Schulte
John O. Farmer, Inc.
PO Box 352
Russell, KS 67665

RE: Approved Commingling CO120801
Dreiling "A" #1, Sec. 23-T12S-R16W, Ellis County
API No. 15-051-25802-00-00

Dear Ms. Schulte:

Your Application for Commingling (ACO-4) for the above described well has been reviewed and approved by the Kansas Corporation Commission (KCC) per K.A.R. 82-3-123a. Notice was examined and found to be proper per K.A.R. 82-3-135a. No protest had been filed within the 15-day protest period. This application, which was received by the KCC on December 9, 2008 concerns approval to simultaneously produce from the following sources of supply through the same tubing string in the same wellbore:

Source of Supply	Estimated Current Production			Perf Depth
	BOPD	MCFPD	BWPD	
Penn Sand	4.3	0	0	3395-3399
Lansing "D"	60	0	0	3185-3190
Total Estimated Current Production	64.3	0	0	

Based upon the depth of the Penn Sand formation perforations, total oil production shall not exceed 100 BOPD and total gas production shall not exceed 50% of the absolute open flow (AOF).

Docket Number CO120801 has been assigned to this approved application. Use this number for well completion reports (ACO-1) and other correspondence that may concern this approved commingling.

Sincerely,



Rick Hestermann
Production Department

OFFSET OPERATORS/UNLEASED MINERAL OWNERS
(within 1/2 mile radius)
TO JOHN O. FARMER, INC.

Dreiling "A" #1
970' FSL & 650' FWL
Sec. 23-12S-16W
Ellis County, Kansas

Sec. 22-12S-16W

NE/4	Bennett & Schulte Oil Company P.O. Box 329 Russell, KS 67665-0329
SE/4	Ginther Oil Operations P.O. Box 135 Russell, KS 67665-0135

Sec. 23-12S-16W

W/2 W/2	John O. Farmer, Inc. (Dreiling "A" Lease)
SE/4, E/2 SW/4 & E/2 NW/4	Leo J. Dreiling Farms, Inc. P.O. Box 550 Hays, KS 67601-0550 (unleased mineral owner)

Sec. 26-12S-16W

NE/4	Rapid Well Service, Inc. P.O. Box 208 Russell, KS 67665-0208
NW/4	Brungardt Oil & Leasing Company P.O. Box 871 Russell, KS 67665-0871

Sec. 27-12S-16W

NW/4 NE/4	Prospect Oil & Gas Corporation P.O. Box 837 Russell, KS 67665-0837
E/2 NE/4 & SW/4 NE/4	John O. Farmer, Inc.

I certify that a copy of the ACO-16 (Application For New Pool Determination) and ACO-4 (Application for Commingling of Production) has been sent to the offset operators and unleased mineral owner listed previously as of the 8th day of December, 2008.



JOHN O. FARMER III, PRESIDENT

RECEIVED
KANSAS CORPORATION COMMISSION

DEC 09 2008

CONSERVATION DIVISION
WICHITA, KS

John O. Farmer, Inc.
Total Depth & Producing
Zones Map
Ellis County, KS
10/2/2008

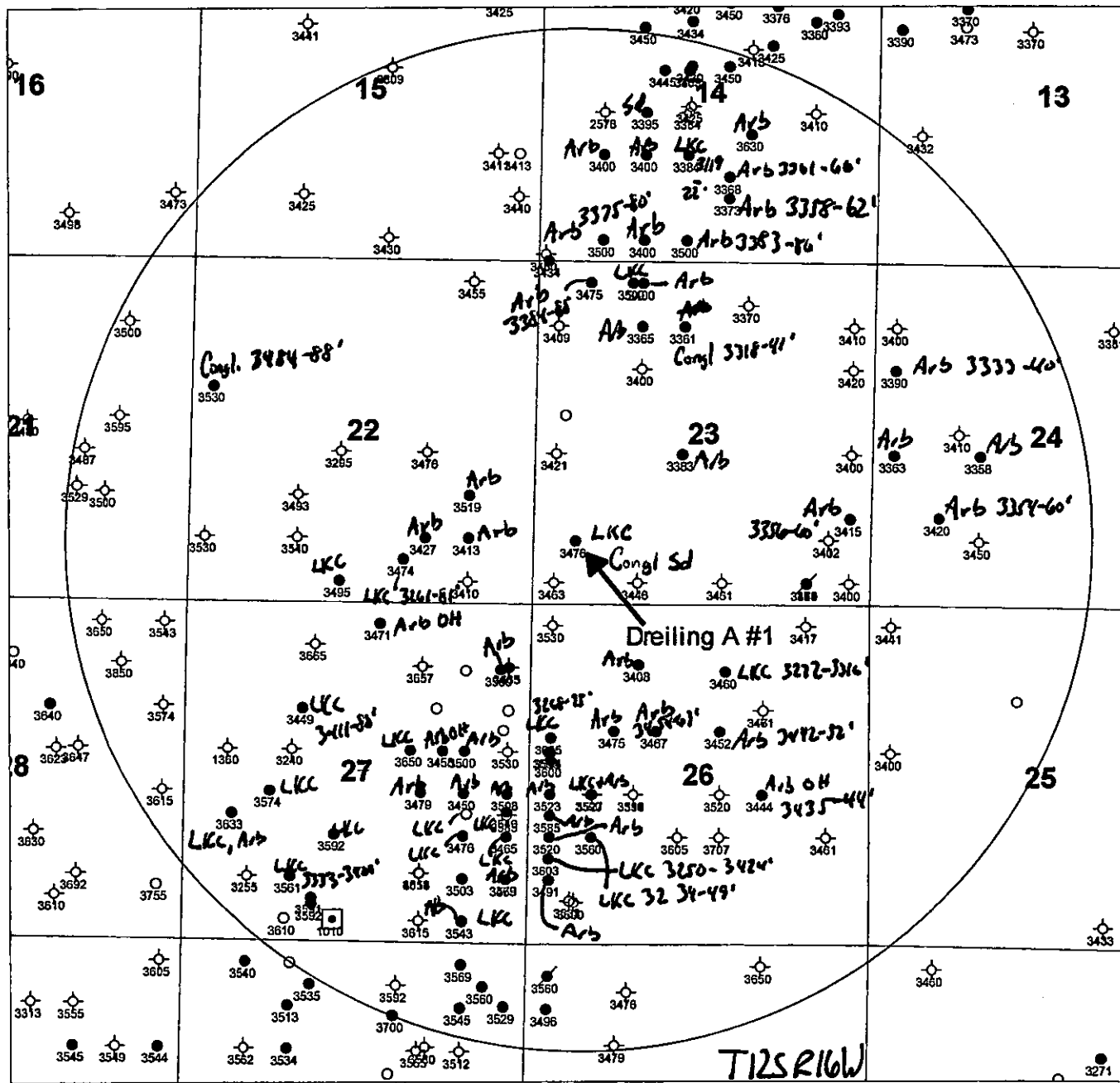

RECEIVED
KANSAS CORPORATION COMMISSION

DEC 09 2008

CONSERVATION DIVISION
KANSAS CORPORATION COMMISSION

AFFIDAVIT OF PUBLICATION

State of Kansas, Ellis County, ss:

Mary Karst

being first duly sworn, deposes and says:

That he/she is Advertising Manager of THE HAYS DAILY NEWS, a daily newspaper printed in the State of Kansas, and published in and of general circulation in Ellis County, Kansas, with a general paid circulation on a yearly basis in Ellis County, Kansas, and that said newspaper is not a trade, religious or fraternal publication.

Said newspaper is published daily, except Saturday, is published at least weekly 50 times a year; has been so published continuously and uninterrupted in said county and state for a period of more than five years prior to the first publication of said notice; and has been admitted at the post office of Hays in said county as second class matter.

That the attached notice is a true copy thereof and was published in the regular and entire issue of said newspaper for 1 consecutive day, the first publication thereof being made as aforesaid on the 16th day of December, 2008, with subsequent publications being made on the following dates:

___,	20__	___,	20__
___,	20__	___,	20__
___,	20__	___,	20__

Mary Karst

Subscribed and sworn to before me this 16th day of Dec., 2008.

[Signature]

Notary Public

My Appointment expires 5-28-09
 Printer's Fee..... \$43.89
 Additional copies..... \$ ____
 Total Fee..... \$43.89

(Published in The Hays Daily News December 16, 2008)
BEFORE THE STATE CORPORATION COMMISSION OF THE STATE OF KANSAS

NOTICE OF FILING APPLICATION
RE: JOHN O. FARMER, INC.--
Application for Commingling of Production in the Dreiling "A" #1, located in Ellis County, Kansas.

TO: All Oil and Gas Producers, Unleased Mineral Interest Owners, Landowners, and all persons whosoever concerned.

You, and each of you, are hereby notified that John O. Farmer, inc. has filed an application to commingle the Penn Sand and Lansing "D" producing formations at the Dreiling "A" #1, located 970' from the south line and 650' from the west line of Sec. 23-T12S-R16W, Ellis County, Kansas.

Any persons who object to or protest this application shall be required to file their objections or protests with the Conservation Division of the State Corporation Commission of the State of Kansas within fifteen (15) days from the date of the publication. These protests shall be filed pursuant to Commission regulations and must state specific reasons why the grant of the application may cause waste, violate correlative rights or pollute the natural resources of the State of Kansas.

All persons interested or concerned shall take notice of the foregoing and shall govern themselves accordingly.

John O. Farmer III
John O. Farmer, Inc.
P.O. Box 352
Russell, KS 67665
Telephone 785-483-3144

RECEIVED
KANSAS CORPORATION COMMISSION

JAN 14 2009

CONSERVATION DIVISION
WICHITA

NOTARY PUBLIC - State of Kansas
JANICE C. TINKEL
My Appt. Exp. 5-28-09

AFFIDAVIT

STATE OF KANSAS \
- SS.
County of Sedgwick /

Nicole Mandina, of lawful age, being first duly sworn, deposeth and saith: That she is Record Clerk of The Wichita Eagle, a daily newspaper published in the City of Wichita, County of Sedgwick, State of Kansas, and having a general paid circulation on a daily basis in said County, which said newspaper has been continuously and uninterruptedly published in said County for more than one year prior to the first publication of the notice hereinafter mentioned, and which said newspaper has been entered as second class mail matter at the United States Post Office in Wichita, Kansas, and which said newspaper is not a trade, religious or fraternal publication and that a notice of a true copy is hereto attached was published in the regular and entire Morning issue of said The Wichita Eagle for 1 issues - weeks, that the first publication of said notice was

made as aforesaid on the 7th of

January A.D. 2009 , with

subsequent publications being made on the following dates:

And affiant further says that she has personal knowledge of the statements above set forth and that they are true.

Nicole Mandina

Subscribed and sworn to before me this

7th day of January , 2009

Janice L. Trammell
Notary Public Sedgwick County, Kansas

JANICE L. TRAMMELL
Notary Public - State of Kansas
My Appt. Expires 4-29-2012

Printers Fee: \$78.00

LEGAL PUBLICATION

Published in the Wichita Eagle on January 7, 2009 (2916301) BEFORE THE STATE CORPORATION COMMISSION OF THE STATE OF KANSAS

NOTICE OF FILING APPLICATION

RE: JOHN O. FARMER, INC. -- Application for commingling of Production in the Drilling "A" #1, located in Ellis County, Kansas.

TO: All Oil and Gas Producers, Unleased Mineral Interest Owners, landowners, and all persons whosever concerned. You, and each of you, are hereby notified that John O. Farmer, Inc. has filed an application to commingle the Penn Sand and Lansing "D" production formations at the Drilling "A" #1, located 970' from the south line and 650' from the west line of Sec. 23-T12S-R16W, Ellis County, Kansas. Any persons who object to or protest this application shall be required to file their objections or protests with the Conservation Division of the State Corporation Commission of the State of Kansas within fifteen (15) days from the date of the publication. These protests shall be filed pursuant to Commission regulations and must state specific reasons why the grant of the application may cause waste, violate correlative rights or pollute the natural resources of the State of Kansas.

All persons interested or concerned shall take notice of the foregoing and shall govern themselves accordingly. John O. Farmer III, John O. Farmer, Inc., P.O. Box 352, Russell, KS 67665, Telephone (785) 483-3144

RECEIVED
KANSAS CORPORATION COMMISSION

JAN 14 2009

CONSERVATION DIVISION
WICHITA, KS