

KANSAS CORPORATION COMMISSION  
OIL & GAS CONSERVATION DIVISION

Form ACO-4  
Form must be typed  
July 2006

APPLICATION FOR COMMINGLING OF  
PRODUCTION (K.A.R. 82-3-123) OR FLUIDS (K.A.R. 82-3-123a)

Commingling ID # CO110802

Operator Information:

License #: 4767  
Name: Ritchie Exploration, Inc.  
Address: P.O. Box 783188  
City/State/Zip: Wichita, KS 67278-3188  
Contact Person: John Niernberger  
Phone #: 316-691-9500

Well Information:

API #: 15 - 137-20460-0008  
Lease Name: Minks 33AD Well #: 1  
Spot: approx - W/2 - NE - SE Sec. 33 Twp. 5 S. R. 22  East  
County: Norton  West  
Feet from  North /  South Line of Section: 2040  
Feet from  East /  West Line of Section: 850

1. Name and upper and lower limit of each production interval to be commingled:

Formation: LKC (Perfs): 3707.8'-3712.3'; 3677.5'-3683'; 3609.5'-3612.5'; 3562'-3567'  
Formation: Toronto (Perfs): 3545'-3549.5'  
Formation: \_\_\_\_\_ (Perfs): \_\_\_\_\_  
Formation: \_\_\_\_\_ (Perfs): \_\_\_\_\_  
Formation: \_\_\_\_\_ (Perfs): \_\_\_\_\_

2. Estimated amount of fluid production to be commingled from each interval:

Formation: LKC BOPD: 20.99 MCFPD: \_\_\_\_\_ BWPD: 31.73  
Formation: Toronto BOPD: 74.05 MCFPD: \_\_\_\_\_ BWPD: 1.67  
Formation: \_\_\_\_\_ BOPD: \_\_\_\_\_ MCFPD: \_\_\_\_\_ BWPD: \_\_\_\_\_  
Formation: \_\_\_\_\_ BOPD: \_\_\_\_\_ MCFPD: \_\_\_\_\_ BWPD: \_\_\_\_\_  
Formation: \_\_\_\_\_ BOPD: \_\_\_\_\_ MCFPD: \_\_\_\_\_ BWPD: \_\_\_\_\_

3. Plat map showing the location of the subject well, all other wells on the subject lease, and all wells on offsetting leases within a 1/2 mile radius of the subject well, and for each well the names and addresses of the lessee of record or operator.

4. Signed certificate showing service of the application and affidavit of publication as required in K.A.R. 82-3-135a.

For Commingling of PRODUCTION ONLY, include the following:

- 5. Wireline log of subject well.
- 6. Complete Form ACO-1 (Well Completion form) for the subject well.

For Commingling of FLUIDS ONLY, include the following:

- \_\_\_\_\_ 5. Well construction diagram of subject well.
- \_\_\_\_\_ 6. Any available water chemistry data demonstrating the compatibility of the fluids to be commingled.

State of Kansas )  
 )  
County of Sedgwick )

ss:



VERIFICATION: I hereby certify that to the best of my current information, knowledge and personal belief, this request for commingling is true and proper and I have no information or knowledge, which is inconsistent with the information supplied in this application.

Signature: \_\_\_\_\_  
Printed Name: John C. Niernberger  
Title: Production Manager  
Subscribed & sworn to before me this 4th day of November, 20 08  
Notary Public: Ronda Messer  
My Commission Expires: 5/7/12

Protests may be filed by any party having a valid interest in the application. Protests must be in writing and comply with K.A.R. 82-3-135b and must be filed within 15 days of publication of the notice of application.

**KCC Office Use Only**  
 Denied  Approved  
KCC Date Received: \_\_\_\_\_ 15-Day Periods Ends: 11/26/08  
Approved By: \_\_\_\_\_ Date: \_\_\_\_\_

RECEIVED  
KANSAS CORPORATION COMMISSION

NOV 05 2008

CONSERVATION DIVISION  
WICHITA, KS

December 12, 2008

John Niernberger  
Ritchie Exploration, Inc.  
PO Box 783188  
Wichita, KS 67278-3188

**RE: Approved Commingling CO110802**  
**Minks 33AD #1, Sec. 33-T5S-R22W, Norton County, Kansas**  
**API No. 15-137-20460-00-01**

Dear Mr. Niernberger:

Your Application for Commingling (ACO-4) for the above described well has been reviewed and approved by the Kansas Corporation Commission (KCC) per K.A.R. 82-3-123a. Notice was examined and found to be proper per K.A.R. 82-3-135a. No protest had been filed within the 15-day protest period. This application, which was received by the KCC on November 5, 2008 concerns approval to simultaneously produce from the following sources of supply through the same tubing string in the same wellbore:

Source of Supply	Estimated Current Production			Perf Depth
	BOPD	MCFPD	BWPD	
LKC	20.99	0	31.73	3562-3712.3 OA
Toronto	74.05	0	1.67	3545-3549.5
Total Estimated Current Production	95.04	0	33.40	

Based upon the depth of the LKC formation perforations, total oil production shall not exceed 100 BOPD and total gas production shall not exceed 50% of the absolute open flow (AOF).

Docket Number CO110802 has been assigned to this approved application. Use this number for well completion reports (ACO-1) and other correspondence that may concern this approved commingling.

Sincerely,



Rick Hestermann  
Production Department

CONSERVATION DIVISION

S 5 H

S 6 H

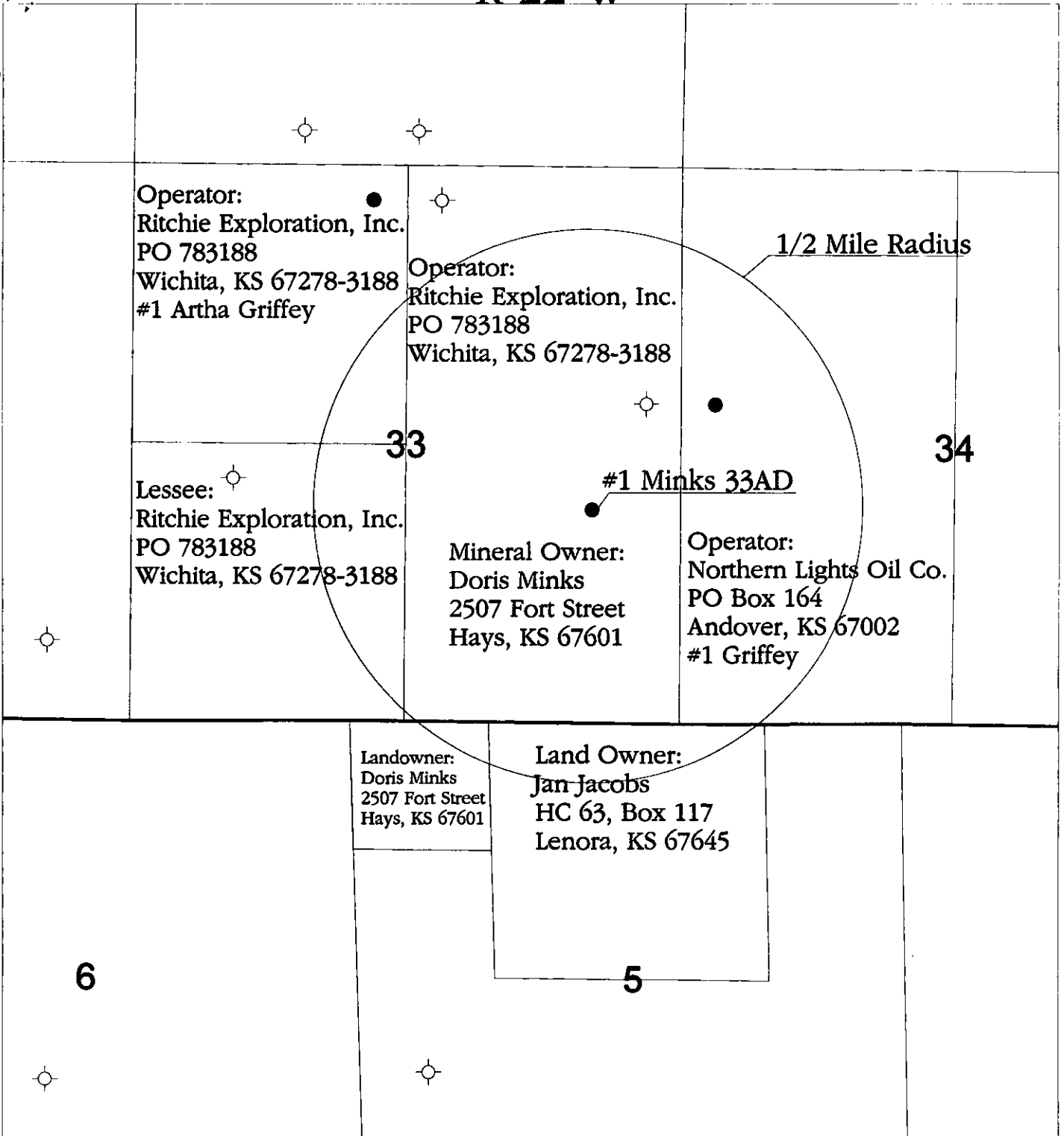

**LEGEND**  
 ● Oil Well  
 ⊕ Dry and Abandoned Well

RECEIVED  
 KANSAS CORPORATION COMMISSION

NOV 05 2008

CONSERVATION DIVISION  
 WICHITA, KS

 <b>RITCHIE</b> <small>EXPLORATION, INC.</small> <small>Wichita, Kansas</small>		<b>Application for          Commingling of          Production or Fluids</b>
<b>Applicant Well: #1 Minks 33AD</b> Operator, Lessee, or Unleased Mineral Owner Within 1/2 Mile Radius		
<b>GRAHAM / NORTON COUNTY, KANSAS</b>		
PREPARED BY: <b>JUSTIN CLEGG</b>	SCALE: <b>1 : 16,500</b>	Date: <b>October 9, 2008</b>

**APPLICATION FOR COMMINGLING OF PRODUCTION OR FLUIDS**

**Operator, Lessee or Unleased Mineral Owner  
within a ½ mile radius of Ritchie Exploration, Inc.'s**

**#1 Minks 33AD  
2040' FSL & 850' FEL  
Section 33-5S-22W  
Norton Co., KS**

**Township 5 South, Range 22 West  
Norton Co., KS**

Sec. 33:	NW/4	Ritchie Exploration, Inc.	Operator: #1 Artha Griffey
	SW/4	Ritchie Exploration, Inc.	Lessee
	E/2	Ritchie Exploration, Inc.	Operator: #1 Minks 33AD
		Doris Minks 2507 Fort Street Hays, KS 67601	Mineral Owner
Sec. 34:	W/2	Northern Lights Oil Company P.O. Box 164 Andover, KS 67002	Operator: #1 Griffey

**Township 6 South, Range 22 West  
Graham Co., KS**

Sec. 5:	NW/4NW/4	Doris Minks	Landowner
	W/2NE/4 & E/2NW/4	Jan Jacobs HC 63, Box 117 Lenora, KS 67645	Landowner

RECEIVED  
KANSAS CORPORATION COMMISSION

NOV 05 2008

CONSERVATION DIVISION  
WICHITA, KS



November 4, 2008

Doris Minks  
2507 Fort Street  
Hays, KS 67601

To Whom It May Concern:

Enclosed please find Ritchie Exploration, Inc.'s Application for Wellbore Commingling of fluids from the Lansing-Kansas City and Toronto sources of supply for the #1 Minks 33AD well located approx. W/2 NE SE of Section 33-5S-22W, Norton County, Kansas.

All oil/gas operators in Kansas are required by the Kansas Corporation Commission Regulations #82-3-123a and #82-3-135a(b) to notify each operator, lessee, or unleased mineral owner within one-half mile radius of the subject well.

No response is required, but if you should have a valid protest, it should be directed to the KCC office in Wichita, Kansas.

If you have any questions, please feel free to call John Niernberger at 316-691-9500.  
Thanks for your time.

Sincerely,

John Niernberger, Production Manager

RECEIVED  
KANSAS CORPORATION COMMISSION

Date this application and certificate was mailed : 11/04/2008

NOV 05 2008

STATE OF KANSAS )  
COUNTY OF SEDGWICK ) SS

CONSERVATION DIVISION  
WICHITA, KS

This instrument was acknowledged before me on November 4, 2008 by John Niernberger as Production Manager of Ritchie Exploration, Inc., on behalf of said corporation.

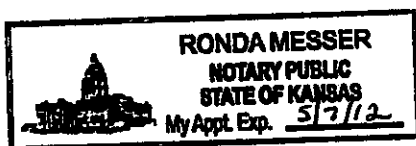

*Ronda Messer*

Ronda Messer, Notary Public  
My commission expires: 05/07/2012

P.O. Box 783188  
Wichita, Kansas 67278-3188

(316) 691-9500  
Fax (316) 691-9550  
[rei@ritchie-exp.com](mailto:rei@ritchie-exp.com)

8100 E. 22<sup>nd</sup> St. N., Bldg. 700  
Wichita, Kansas 67226-2328



November 4, 2008

Northern Lights Oil Company  
P.O. Box 164  
Andover, KS 67002

To Whom It May Concern:

Enclosed please find Ritchie Exploration, Inc.'s Application for Wellbore Commingling of fluids from the Lansing-Kansas City and Toronto sources of supply for the #1 Minks 33AD well located approx. W/2 NE SE of Section 33-5S-22W, Norton County, Kansas.

All oil/gas operators in Kansas are required by the Kansas Corporation Commission Regulations #82-3-123a and #82-3-135a(b) to notify each operator, lessee, or unleased mineral owner within one-half mile radius of the subject well.

No response is required, but if you should have a valid protest, it should be directed to the KCC office in Wichita, Kansas.

If you have any questions, please feel free to call John Niernberger at 316-691-9500.  
Thanks for your time.

Sincerely,

John Niernberger, Production Manager

RECEIVED  
KANSAS CORPORATION COMMISSION

NOV 05 2008

Date this application and certificate was mailed : 11/04/2008

CONSERVATION DIVISION  
WICHITA, KS

STATE OF KANSAS )  
COUNTY OF SEDGWICK ) SS

This instrument was acknowledged before me on November 4, 2008 by John Niernberger as Production Manager of Ritchie Exploration, Inc., on behalf of said corporation.

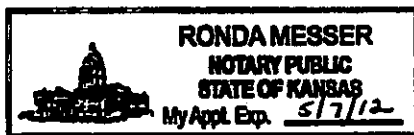

Ronda Messer, Notary Public  
My commission expires: 05/07/2012

P.O. Box 783188  
Wichita, Kansas 67278-3188

(316) 691-9500  
Fax (316) 691-9550  
[rei@ritchie-exp.com](mailto:rei@ritchie-exp.com)

8100 E. 22<sup>nd</sup> St. N., Bldg. 700  
Wichita, Kansas 67226-2328



November 4, 2008

Jan Jacobs  
HC 63 Box 117  
Lenora, KS 67645

To Whom It May Concern:

Enclosed please find Ritchie Exploration, Inc.'s Application for Wellbore Commingling of fluids from the Lansing-Kansas City and Toronto sources of supply for the #1 Minks 33AD well located approx. W/2 NE SE of Section 33-5S-22W, Norton County, Kansas.

All oil/gas operators in Kansas are required by the Kansas Corporation Commission Regulations #82-3-123a and #82-3-135a(b) to notify each operator, lessee, or unleased mineral owner within one-half mile radius of the subject well.

No response is required, but if you should have a valid protest, it should be directed to the KCC office in Wichita, Kansas.

If you have any questions, please feel free to call John Niernberger at 316-691-9500.  
Thanks for your time.

Sincerely,

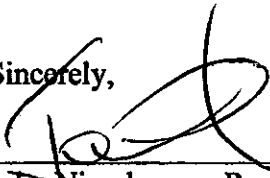
  
\_\_\_\_\_  
John Niernberger, Production Manager

RECEIVED  
KANSAS CORPORATION COMMISSION

NOV 05 2008

CONSERVATION DIVISION  
WICHITA, KS

Date this application and certificate was mailed : 11/04/2008

STATE OF KANSAS )  
COUNTY OF SEDGWICK ) SS

This instrument was acknowledged before me on November 4, 2008 by John Niernberger as Production Manager of Ritchie Exploration, Inc., on behalf of said corporation.

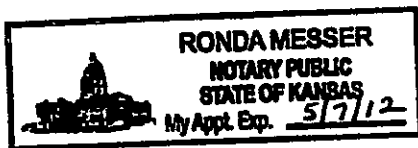

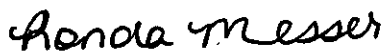
  
\_\_\_\_\_  
Ronda Messer, Notary Public  
My commission expires: 05/07/2012

P.O. Box 783188  
Wichita, Kansas 67278-3188

(316) 691-9500  
Fax (316) 691-9550  
[rei@ritchie-exp.com](mailto:rei@ritchie-exp.com)

8100 E. 22<sup>nd</sup> St. N., Bldg. 700  
Wichita, Kansas 67226-2328

**AFFIDAVIT**

STATE OF KANSAS \  
- SS.  
County of Sedgwick /

Nicole Mandina, of lawful age, being first duly sworn, deposeth and saith: That she is Record Clerk of The Wichita Eagle, a daily newspaper published in the City of Wichita, County of Sedgwick, State of Kansas, and having a general paid circulation on a daily basis in said County, which said newspaper has been continuously and uninterruptedly published in said County for more than one year prior to the first publication of the notice hereinafter mentioned, and which said newspaper has been entered as second class mail matter at the United States Post Office in Wichita, Kansas, and which said newspaper is not a trade, religious or fraternal publication and that a notice of a true copy is hereto attached was published in the regular and entire Morning issue of said The Wichita Eagle for  1  issues - weeks, that the first publication of said notice was

made as aforesaid on the  10th  of  November  A.D.  2008 , with

subsequent publications being made on the following dates:

And affiant further says that she has personal knowledge of the statements above set forth and that they are true.



Subscribed and sworn to before me this

10th  day of  November ,  2008

  
Notary Public Sedgwick County, Kansas

Printers Fee:  \$66.00

**LEGAL PUBLICATION**

Published in the Wichita Eagle  
on November 10, 2008 (2901427)

**LEGAL NOTICE**

You, and each of you, are hereby notified that Ritchie Exploration, Inc. has filed an application to commence the commingling of production from the Lansing-Kansas City and Toronto sources of supply for the #1 Minks 33AD well located approx. W/2 NE SE of Section 33-55-22W, Norton County, Kansas.

Any persons who object to or protest this application shall be required to file their objections or protests with the Conservation Division of the State Corporation Commission of the State of Kansas within fifteen (15) days from the date of the publication. These protests shall be filed pursuant to Commission regulations and must state specific reasons why the grant of the application may cause waste, violate correlative rights or pollute the natural resources of the state of Kansas. If no protests are received, this application may be granted through a summary proceeding. If valid protests are received, this matter will be set for hearing.

All persons interested or concerned shall take notice of the foregoing and shall govern themselves accordingly.

RITCHIE EXPLORATION, INC.  
P.O. Box 783188  
Wichita, KS 67278-3188  
(316)691-9500

RECEIVED  
KANSAS CORPORATION COMMISSION

DEC 11 2008

CONSERVATION DIVISION  
WICHITA, KS



# Proof of Publication

State of Kansas  
NORTON COUNTY

Sherry Hickman of lawful age, being duly sworn upon oath, states that he/she is the designated representative of the Norton Telegram.

THAT said newspaper has been published at least one hundred (100) times a year and has been so published for at least one year prior to the first publication of the attached notice:

THAT said paper was entered as second class mail matter at the post office of its publication:

THAT said paper has a general paid circulation in NORTON County, Kansas, and is NOT a trade, religious or fraternal publication and has been published in NORTON County, Kansas.

THE ATTACHED was published on the following dates in a regular issue of the said newspaper:

- 1st publication was made on the 7 day of November, 2008
- 2nd publication was made on the \_\_\_ day of \_\_\_\_\_, 2008
- 3rd publication was made on the \_\_\_ day of \_\_\_\_\_, 2008
- 4th publication was made on the \_\_\_ day of \_\_\_\_\_, 2008
- 5th publication was made on the \_\_\_ day of \_\_\_\_\_, 2008

5 " Publication fee \$ 27.30  
 Affidavit, Notary's fees \$ \_\_\_\_\_  
 Additional copies \$ \_\_\_\_\_

TOTAL publication fees \$ 27.30

(Sign) Sherry Hickman

Witness my hand this 17th day of November, 2008

SUBSCRIBED and Sworn to before me this 17th day of November, 2008. State of Kansas, County of Norton

Paula D. Engel  
Chief Clerk



Published in The Norton Telegram on Friday, November 7, 2008.

### LEGAL NOTICE

You, and each of you, are hereby notified that Ritchie Exploration, Inc. has filed an application to commence the commingling of production from the Lansing-Kansas City and Toronto sources of supply for the #1 Minks 33AD well located approx. W/2 NE SE of Section 33-5S-22W, Norton County, Kansas.

Any persons who object to or protest this application shall be required to file their objections or protests with the Conservation Division of the State Corporation Commission of the State of Kansas within fifteen (15) days from the

date of the publication. These protests shall be filed pursuant to Commission regulations and must state specific reasons why the grant of the application may cause waste, violate correlative rights or pollute the natural resources of the state of Kansas. If no protests are received, this application may be granted through a summary proceeding. If valid protests are received this matter will be set for hearing.

All persons interested or concerned shall take notice of the foregoing and shall govern themselves accordingly.

RITCHIE EXPLORATION, INC.  
P.O. Box 783188  
Wichita, KS 67278-3188  
(316) 691-9500

RECEIVED  
KANSAS CORPORATION COMMISSION

DEC 11 2008

CONSERVATION DIVISION  
WICHITA, KS