

KANSAS CORPORATION COMMISSION  
OIL & GAS CONSERVATION DIVISION

Form ACO-4  
Form must be typed  
July 2008

APPLICATION FOR COMMINGLING OF  
PRODUCTION (K.A.R. 82-3-123) OR FLUIDS (K.A.R. 82-3-123a)

Commingling ID # CO 04QPD1

Operator Information:

License #: 4767  
Name: Ritchie Exploration, Inc.  
Address: P.O. Box 783188  
City/State/Zip: Wichita, KS 67278-3188  
Contact Person: John Niernberger  
Phone #: 316-691-9500

Well Information:

API #: 15 - 057-20585-0000  
Lease Name: Peintner Trust Well #: 1  
Spot: approx - W/2 - SW - SE Sec. 2 Twp. 26 S. R. 22  East  
County: Ford  West  
Feet from  North /  South Line of Section: 660  
Feet from  East /  West Line of Section: 2150

1. Name and upper and lower limit of each production interval to be commingled:

Formation: Marmaton (Perfs): 4574' - 4575'  
Formation: Altamont B (Perfs): 4650' - 4660'  
Formation: \_\_\_\_\_ (Perfs): \_\_\_\_\_  
Formation: \_\_\_\_\_ (Perfs): \_\_\_\_\_  
Formation: \_\_\_\_\_ (Perfs): \_\_\_\_\_

2. Estimated amount of fluid production to be commingled from each interval:

Formation: Marmaton BOPD: 29.57 MCFPD: \_\_\_\_\_ BWPD: 66.40  
Formation: Altamont B BOPD: 1.67 MCFPD: \_\_\_\_\_ BWPD: 3.34  
Formation: \_\_\_\_\_ BOPD: \_\_\_\_\_ MCFPD: \_\_\_\_\_ BWPD: \_\_\_\_\_  
Formation: \_\_\_\_\_ BOPD: \_\_\_\_\_ MCFPD: \_\_\_\_\_ BWPD: \_\_\_\_\_  
Formation: \_\_\_\_\_ BOPD: \_\_\_\_\_ MCFPD: \_\_\_\_\_ BWPD: \_\_\_\_\_

3. Plat map showing the location of the subject well, all other wells on the subject lease, and all wells on offsetting leases within a 1/2 mile radius of the subject well, and for each well the names and addresses of the lessee of record or operator.

4. Signed certificate showing service of the application and affidavit of publication as required in K.A.R. 82-3-135a.

For Commingling of PRODUCTION ONLY, include the following:

- 5. Wireline log of subject well.
- 6. Complete Form ACO-1 (Well Completion form) for the subject well.

For Commingling of FLUIDS ONLY, include the following:

- \_\_\_\_\_ 5. Well construction diagram of subject well.
- \_\_\_\_\_ 6. Any available water chemistry data demonstrating the compatibility of the fluids to be commingled.

State of Kansas )  
County of Sedgwick )

ss:

Signature: \_\_\_\_\_  
Printed Name: John C. Niernberger  
Title: Production Manager

Subscribed & sworn to before me this 2nd day of April, 20 08  
Notary Public: Debra K. Phillips  
My Commission Expires: 5-4-11

Protests may be filed by any party having a valid interest in the application. Protests must be in writing and comply with K.A.R. 82-3-135b and must be filed within 15 days of publication of the notice of application.

KCC Office Use Only

Denied  Approved

KCC Date Received: 4/3/08 15-Day Periods Ends: 4/24/08

Approved By: [Signature] Date: 4/24/08

Mail with all required attachments and files to: KCC - Conservation Division, 130 S. Market - Room 2078, Wichita, Kansas 67202

DEBRA K. PHILLIPS  
Notary Public - State of Kansas  
My Appt. Expires 5-4-11

RECEIVED  
KANSAS CORPORATION COMMISSION  
APR 03 2008  
CONSERVATION DIVISION  
WICHITA, KS

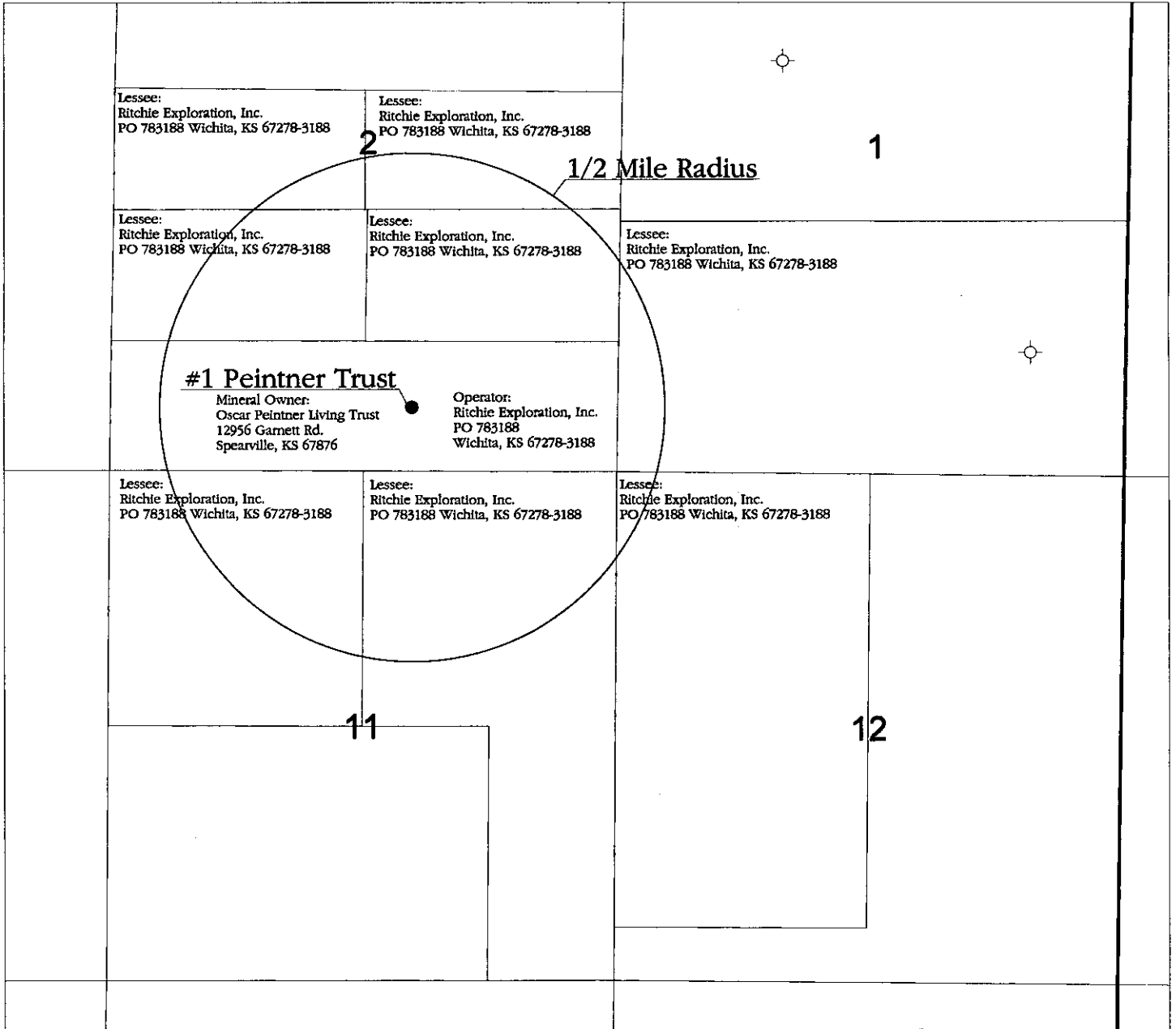

RECEIVED  
KANSAS CORPORATION COMMISSION  
APR 03 2008  
CONSERVATION DIVISION  
WICHITA, KS

- Legend**
- Oil Well
  - ⊙ Dry and Abandoned Well



**RITCHIE**  
EXPLORATION, INC.  
Wichita, Kansas

**Application for  
Commingling of  
Production or Fluids**

**Applicant Well: #1 Peintner Trust**  
Wells on Offsetting Leases Within 1/2 Mile Radius  
Lessee of Record and or Mineral Owner within 1/2 Mile

**Ford County, Kansas**

Prepared By: Justin Clegg	Scale: 1 : 19,500	Date: February 29, 2008
------------------------------	----------------------	----------------------------



April 2, 2008

Oscar Peintner, Trustee of the  
Oscar Peintner Living Trust, dated 2/28/84  
12956 Garnett Rd.  
Spearville, KS 67876

To Whom It May Concern:

Enclosed please find Ritchie Exploration, Inc.'s Application for Wellbore Commingling of fluids from the Marmaton and Altamont B sources of supply for the #1 Peintner Trust well located approx W/2 SW SE of Sec. 2-26S-22W, Ford County, Kansas.

All oil/gas operators in Kansas are required by the Kansas Corporation Commission Regulations #82-3-123a and #82-3-135a(b) to notify each operator, lessee, or unleased mineral owner within one-half mile radius of the subject well.

No response is required, but if you should have a valid protest, it should be directed to the KCC office in Wichita, Kansas.

If you have any questions, please feel free to call John Niernberger at 316-691-9500.  
Thanks for your time.

Sincerely,

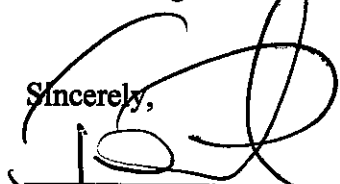
  
\_\_\_\_\_  
John Niernberger, Production Manager

RECEIVED  
KANSAS CORPORATION COMMISSION

APR 03 2008

CONSERVATION DIVISION  
WICHITA, KS

Date this application and certificate was mailed : 04/02/2008

STATE OF KANSAS )  
COUNTY OF SEDGWICK ) SS

This instrument was acknowledged before me on April 2, 2008 by John Niernberger as Production Manager of Ritchie Exploration, Inc., on behalf of said corporation.

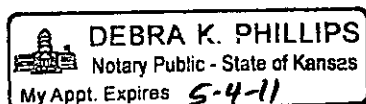
  
\_\_\_\_\_  
Debra K. Phillips, Notary Public  
My commission expires: 05/04/2011

P.O. Box 783188  
Wichita, Kansas 67278-3188

(316) 691-9500  
Fax (316) 691-9550  
[rei@ritchie-exp.com](mailto:rei@ritchie-exp.com)

8100 E. 22<sup>nd</sup> St. N., Bldg. 700  
Wichita, Kansas 67226-2328

# APPLICATION FOR COMMINGLING OF PRODUCTION OR FLUIDS

**Operator, Lessee or Unleased Mineral Owner  
within a ½ mile radius of Ritchie Exploration, Inc.'s**

**#1 Peintner Trust  
660' FSL & 2150' FEL  
Section 2-26S-22W  
Ford Co., KS**

## Township 26 South, Range 22 West

Sec. 1:	S/2	Ritchie Exploration, Inc.	Lessee
Sec. 2:	N/2 SE/4	Ritchie Exploration, Inc.	Lessee
	N/2 SW/4	Ritchie Exploration, Inc.	Lessee
	S/2 S/2	Ritchie Exploration, Inc.	Operator: #1 Peintner Trust
		Oscar Peintner, Trustee of the Oscar Peintner Living Trust, dated 2/28/84 12956 Garnett Rd. Spearville, KS 67876	Mineral Owner
	S/2 NE/4	Ritchie Exploration, Inc.	Lessee
	S/2 NW/4	Ritchie Exploration, Inc.	Lessee
Sec. 11:	NE/4; E/2 SE/4	Ritchie Exploration, Inc.	Lessee
	NW/4	Ritchie Exploration, Inc.	Lessee
Sec. 12:	W/2, ex. the S. 546 ft SW/4	Ritchie Exploration, Inc.	Lessee

RECEIVED  
KANSAS CORPORATION COMMISSION

APR 03 2008

CONSERVATION DIVISION  
WICHITA, KS

Dodge City Daily Globe

**PAID**  
Date 4/15/08 By KR  
Amt. \$ 23.40  
Daily Globe - Shopper's Weekly

RITCHIE EXPLORATION, INC.  
PO BOX 783188  
WICHITA KS 67278

REFERENCE: 14170  
59851 Notice-Appl/Marmaton

David Meadows of lawful age, being duly sworn upon oath, states that he is the Publisher of the DODGE CITY DAILY GLOBE.

THAT said newspaper has been published at least weekly fifty(50) times a year and has been so published for at least five years prior to the first publication of the attached notice;

THAT said paper was entered as second class mail matter at the post office of its publication;

THAT said paper has a general paid circulation on a daily, or weekly, or yearly basis in FORD COUNTY KANSAS, and is NOT a trade, religious or fraternal publication and has been PRINTED and published in FORD COUNTY, KANSAS.

THE ATTACHED was published on the following dates in a regular issue of said paper:

(sign) *D Meadows*

PUBLISHED ON: 04/05

TOTAL COST: 23.40 AD SPACE: 4.500 INCH  
FILED ON: 04/05/08

Witness my hand this 5 day of Apr. 2008

SUBSCRIBED and Sworn To Before Me this 5 day of Apr. 2008

*Kathy Runquist*  
Notary Public, Ford County, Kansas

(Published in the Dodge City Daily Globe, April 5, 2008)

**LEGAL NOTICE**

You, and each of you, are hereby notified that Ritchie Exploration, Inc. has filed an application to commence the commingling of production from the Marmaton and Altamont B sources of supply in the #1 Peintner Trust well, located approx W/2 SW SE Sec. 2-26S-22W, Lane County, Kansas.

Any persons who object to or protest this application shall be required to file their objections or protests with the Conservation Division of the State Corporation Commission of the State of Kansas within Fifteen (15) days from the date of the publication. These protests shall be filed pursuant to Commission regulations and must state specific reasons why the grant of the application may cause waste, violate correlative rights or pollute the natural resources of the state of Kansas. If no protests are received, this application may be granted through a summary proceeding. If valid protests are received, this matter will be set for hearing.

005 PUBLIC NOTICES/  
LEGAL NOTICES

005 PUBLIC NOTICES/  
LEGAL NOTICES

All persons interested or concerned shall take notice of the foregoing and shall govern themselves accordingly.

RITCHIE EXPLORATION, INC.  
P.O. Box 783188  
Wichita, KS 67278-3188  
(316)691-9500  
11 Sat

RECEIVED  
KANSAS CORPORATION COMMISSION

APR 22 2008

CONSERVATION DIVISION  
WICHITA, KS

**KATHY RUNQUIST**  
Notary Public - State of Kansas  
My Appt. Expires 11/23/08

**AFFIDAVIT**

STATE OF KANSAS \  
- SS.  
County of Sedgwick /

Nicole Mandina, of lawful age, being first duly sworn, depose and saith: That she is Record Clerk of The Wichita Eagle, a daily newspaper published in the City of Wichita, County of Sedgwick, State of Kansas, and having a general paid circulation on a daily basis in said County, which said newspaper has been continuously and uninterruptedly published in said County for more than one year prior to the first publication of the notice hereinafter mentioned, and which said newspaper has been entered as second class mail matter at the United States Post Office in Wichita, Kansas, and which said newspaper is not a trade, religious or fraternal publication and that a notice of a true copy is hereto attached was published in the regular and entire Morning issue of said The Wichita Eagle for  1  issues - weeks, that the first publication of said notice was

made as aforesaid on the  9th  of

April  A.D.  2008 , with

subsequent publications being made on the following dates:

And affiant further says that she has personal knowledge of the statements above set forth and that they are true.

Subscribed and sworn to before me this

9th day of April, 2008

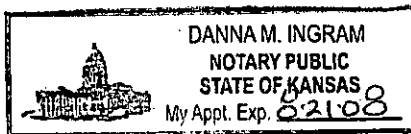
  
Notary Public Sedgwick County, Kansas

Printers Fee:  \$64.00

**LEGAL PUBLICATION**

Published in the Wichita Eagle  
on April 9, 2008 (2816587)

**LEGAL NOTICE**

You, and each of you, are hereby notified that Ritchie Exploration, Inc. has filed an application to commence the commingling of production from the Marmaton and Altamont B sources of supply in the #1 Peintner Trust well, located approx W/2 SW SE Sec. 2-26S-22W, Lane County, Kansas. Any persons who object to or protest this application shall be required to file their objections or protests with the Conservation Division of the State Corporation Commission of the State of Kansas within fifteen (15) days from the date of the publication. These protests shall be filed pursuant to Commission regulations and must state specific reasons why the grant of the application may cause waste, violate correlative rights or pollute the natural resources of the State of Kansas. If no protests are received, this application may be granted through a summary proceeding. If valid protests are received, this matter will be set for hearing. All persons interested or concerned shall take notice of the foregoing and shall govern themselves accordingly.

RITCHIE EXPLORATION, INC.  
P.O. Box 783188  
Wichita, KS 67278-3188  
(316) 691-9500

RECEIVED  
KANSAS CORPORATION COMMISSION  
APR 22 2008  
CONSERVATION DIVISION  
WICHITA, KS



Kathleen Sebelius, Governor  
Thomas E. Wright, Chairman  
Michael C. Moffet, Commissioner  
Joseph F. Harkins, Commissioner

April 24, 2008

John Niernberger  
Ritchie Exploration, Inc.  
PO Box 783188  
Wichita, KS 67278-3188

**RE: Approved Commingling CO040801  
Peintner Trust #1, Sec. 2-T26S-R22W, Ford County, Kansas  
API No. 15-057-20585-00-00**

Dear Mr. Niernberger:

Your "Application for Commingling" (ACO-4) for the above described well has been reviewed and approved by the Kansas Corporation Commission (KCC) per **K.A.R. 82-3-123a**. Notice was examined and found to be proper per **K.A.R. 82-3-135a**. No protest had been filed within the 15-day protest period. This application, which was received by the KCC on **April 3, 2008** concerns approval to simultaneously produce from the following **two** sources of supply through the same tubing string in the same wellbore: the **Marmaton and Altamont B** formations.

According to your application, the estimated current production from the **Marmaton** source of supply is **29.57 BOPD, 0 Mcfpd** and **66.40 BWPD**. The estimated current production from the **Altamont B** source of supply is **1.67 BOPD, 0 Mcfpd** and **3.34 BWPD**. The total estimated current production from all sources of supply in the subject well is **31.24 BOPD, 0 Mcfpd** and **69.74 BWPD**.

Based upon the depth of the **Altamont B** formation perforations, total oil production shall not exceed **200 BOPD** and total gas production shall not exceed **50%** of the absolute open flow (AOF).

Docket Number **CO40801** has been assigned to this approved application. Please use this number for well completion reports (ACO-1) and other correspondence that may concern this approved commingling.

Sincerely,

Rick Hestermann  
Production Department

CONSERVATION DIVISION

Finney State Office Building, 130 S. Market, Room 2078, Wichita, KS 67202-3802  
(316) 337-6200 • Fax: (316) 337-6211 • <http://kcc.ks.gov/>