

KANSAS CORPORATION COMMISSION
OIL & GAS CONSERVATION DIVISION

Form ACO-4
Form must be typed
July 2006

APPLICATION FOR COMMINGLING OF
PRODUCTION (K.A.R. 82-3-123) OR FLUIDS (K.A.R. 82-3-123a)

Commingling ID # C0042823

Operator Information:

License #: 5135
Name: John O. Farmer, Inc.
Address: P.O. Box 352
City/State/Zip: Russell, KS 67665
Contact Person: Marge Schulte
Phone #: (785) 483-3145, Ext. 214

Well Information:

API #: 15 - 065-23,391-00-00
Lease Name: Brassfield Unit Well #: 1
Spot: NW - NW - NW - NW Sec. 21 Twp. 9 S. R. 22 East
County: Graham West
Feet from North / South Line of Section: 120
Feet from East / West Line of Section: 240

1. Name and upper and lower limit of each production interval to be commingled:

Formation: Lansing "H" (Perfs): 3780-84'
Formation: Arbuckle (Perfs): 4004-08', 4011-16', 4020-24'
Formation: _____ (Perfs): _____
Formation: _____ (Perfs): _____
Formation: _____ (Perfs): _____

2. Estimated amount of fluid production to be commingled from each interval:

Formation: Lansing "H" BOPD: 16 MCFPD: _____ BWPD: 42
Formation: Arbuckle BOPD: 30 MCFPD: _____ BWPD: 0
Formation: _____ BOPD: _____ MCFPD: _____ BWPD: _____
Formation: _____ BOPD: _____ MCFPD: _____ BWPD: _____
Formation: _____ BOPD: _____ MCFPD: _____ BWPD: _____

3. Plat map showing the location of the subject well, all other wells on the subject lease, and all wells on offsetting leases within a 1/2 mile radius of the subject well, and for each well the names and addresses of the lessee of record or operator.

4. Signed certificate showing service of the application and affidavit of publication as required in K.A.R. 82-3-135a.

For Commingling of PRODUCTION ONLY, include the following:

- 5. Wireline log of subject well.
- 6. Complete Form ACO-1 (Well Completion form) for the subject well.

For Commingling of FLUIDS ONLY, include the following:

- _____ 5. Well construction diagram of subject well.
- _____ 6. Any available water chemistry data demonstrating the compatibility of the fluids to be commingled.

State of Kansas)
)
County of Russell)

ss:

VERIFICATION: I hereby certify that to the best of my current information, knowledge and personal belief, this request for commingling is true and proper and I have no information or knowledge, which is inconsistent with the information supplied in this application.

Signature: John O. Farmer III
Printed Name: John O. Farmer III
Title: President

RECEIVED
KANSAS CORPORATION COMMISSION

APR 16 2008

CONSERVATION DIVISION
WICHITA, KS

KCC Office Use Only
 Denied Approved
KCC Date Received: 4/16/08 15-Day Periods Ends: 5/8/08
Approved By: [Signature] Date: 5/8/08

Subscribed & sworn to before me this 15th day of April, 20 08
Notary Public: Margaret A. Schulte
My Commission Expires: 1-27-09
Protests may be filed by any party having a valid interest in the application. Protests must be in writing and comply with K.A.R. 82-3-135b and must be filed within 15 days of publication of the notice of application.

APR 16 2008

CONSERVATION DIVISION
WICHITA, KS

John O. Farmer, Inc.
Commingling Application
T9S R22W
Graham County, KS

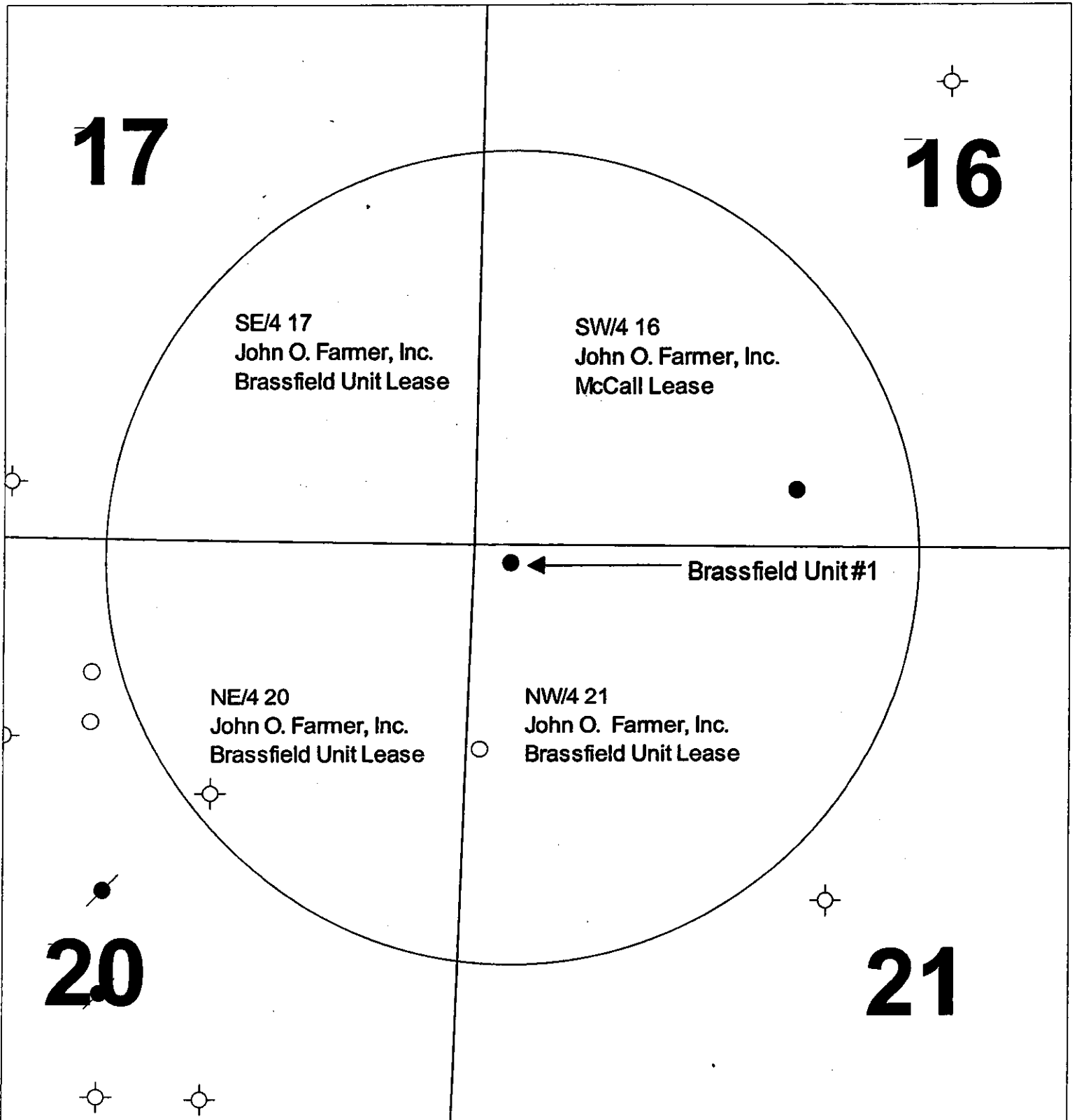

BEFORE THE STATE CORPORATION COMMISSION OF THE STATE OF KANSAS

NOTICE OF FILING APPLICATION

RE: JOHN O. FARMER, INC. - Application for Commingling of Production in the Brassfield Unit #1 located in Graham County, Kansas.

TO: All Oil and Gas Producers, Unleased Mineral Interest Owners, Landowners, and all persons who-soever concerned.

You, and each of you, are hereby notified that John O. Farmer, Inc. has filed an application to commingle the Lansing "H" and Arbuckle producing formations at the Brassfield Unit #1, located 120' from the north line and 240' from the west line of Sec. 21-T9S-R22W, Graham County, Kansas.

Any persons who object to or protest this application shall be required to file their objections or protests with the Conservation Division of the State Corporation Commission of the State of Kansas within fifteen (15) days from the date of the publication. These protests shall be filed pursuant to Commission regulations and must state specific reasons why the grant of the application may cause waste, violate correlative rights or pollute the natural resources of the State of Kansas.

All persons interested or concerned shall take notice of the foregoing and shall govern themselves accordingly.

John O. Farmer III
John O. Farmer, Inc.
P. O. Box 352
Russell, KS 67665

AFFIDAVIT OF PUBLICATION State of Kansas, County of Graham, ss:

JIM LOGBACK, of lawful age, being duly sworn, upon oath states that he is publisher of THE HILL CITY TIMES;

THAT said newspaper has been published weekly at least fifty (50) times a year and has been published at least five (5) years in Graham County, Kansas prior to the first publication of the attached notice;

THAT said newspaper has a general PAID circulation in GRAHAM COUNTY, KANSAS, and is NOT a trade, religious or fraternal publication.

THAT said newspaper is PRINTED IN KANSAS and PUBLISHED in GRAHAM COUNTY, KANSAS, and entered as second class mail matter at the post office of its publication in HILL CITY, KANSAS;

THAT, a notice of which the attached is a true and correct copy, was published in a regular issue of said newspaper for 1 consecutive weeks commencing with the issue of April 23, 2008.

Publication Fee \$ 25.29
Affidavits @ 75¢ .. \$
Extra Copies @ 50¢ \$
TOTAL LEGAL FEE ... \$ 25.29

SUBSCRIBED and sworn to before me this 23 day of April, 2008.

Manuel D. [Signature]

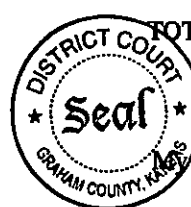

My commission expires KSA 53-501, Notary Public Clerk of the District Court Graham County

RECEIVED APR 28 2008 KCC WICHITA

AFFIDAVIT

STATE OF KANSAS \
- SS.
County of Sedgwick /

Nicole Mandina, of lawful age, being first duly sworn, deposeth and saith: That she is Record Clerk of The Wichita Eagle, a daily newspaper published in the City of Wichita, County of Sedgwick, State of Kansas, and having a general paid circulation on a daily basis in said County, which said newspaper has been continuously and uninterruptedly published in said County for more than one year prior to the first publication of the notice hereinafter mentioned, and which said newspaper has been entered as second class mail matter at the United States Post Office in Wichita, Kansas, and which said newspaper is not a trade, religious or fraternal publication and that a notice of a true copy is hereto attached was published in the regular and entire Morning issue of said The Wichita Eagle for 1 issues - weeks, that the first publication of said notice was

made as aforesaid on the 21st of

April A.D. 2008 , with

subsequent publications being made on the following dates:

And affiant further says that she has personal knowledge of the statements above set forth and that they are true.



Subscribed and sworn to before me this

21st day of April, 2008

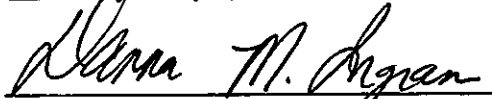
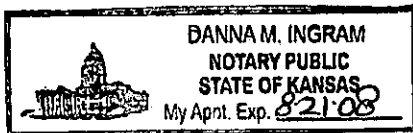
Notary Public Sedgwick County, Kansas

Printers Fee: \$60.00

LEGAL PUBLICATION

Published in The Wichita Eagle
on April 21, 2008 (2821099)
BEFORE THE STATE CORPORATION
COMMISSION OF THE
STATE OF KANSAS

NOTICE OF FILING APPLICATION

RE: JOHN O. FARMER, INC. -- Application for Commingling of Production in the Brassfield Unit #1 located in Graham County, Kansas.

TO: All Oil and Gas Producers, Unleased Mineral Interest Owners, Landowners, and all persons whosoever concerned.

You, and each of you, are hereby notified that John O. Farmer, Inc. has filed an application to commingle the Lansing "H" and Arbuckle producing formations at the Brassfield Unit #1, located 120' from the north line and 240' from the west line of Sec. 21-T9S-R22W, Graham County, Kansas.

Any persons who object to or protest this application shall be required to file their objections or protests with the Conservation Division of the State Corporation Commission of the State of Kansas within fifteen (15) days from the date of the publication. These protests shall be filed pursuant to Commission regulations and must state specific reasons why the grant of the application may cause waste, violate correlative rights or pollute the natural resources of the State of Kansas.

All persons interested or concerned shall take notice of the foregoing and shall govern themselves accordingly.

John O. Farmer III
John O. Farmer, Inc.
P.O. Box 352
Russell, KS 67665
Telephone (785) 483-3144

RECEIVED
APR 28 2008
KCC WICHITA



Kathleen Sebelius, Governor
Thomas E. Wright, Chairman
Michael C. Moffet, Commissioner
Joseph F. Harkins, Commissioner

May 8, 2008

Marge Schulte
John O. Farmer, Inc.
PO Box 352
Russell, KS 67665

**RE: Approved Commingling CO040803
Brassfield Unit #1, Sec. 21-T9S-R22W, Graham County, Kansas
API No. 15-065-23391-00-00**

Dear Ms. Schulte:

Your "Application for Commingling" (ACO-4) for the above described well has been reviewed and approved by the Kansas Corporation Commission (KCC) per K.A.R. 82-3-123a. Notice was examined and found to be proper per K.A.R. 82-3-135a. No protest had been filed within the 15-day protest period. This application, which was received by the KCC on April 16, 2008 concerns approval to simultaneously produce from the following two sources of supply through the same tubing string in the same wellbore:

Source of Supply	Estimated Current Production			Perf Depth
	BOPD	MCFPD	BWPD	
Lansing "H"	16	0	42	3780-3784
Arbuckle	30	0	0	4004-4024
Total Estimated Current Production	46	0	42	

Based upon the depth of the **Arbuckle** formation perforations, total oil production shall not exceed **200 BOPD** and total gas production shall not exceed **50%** of the absolute open flow (AOF).

Docket Number **CO040803** has been assigned to this approved application. Please use this number for well completion reports (ACO-1) and other correspondence that may concern this approved commingling.

Sincerely,

Rick Hestermann
Production Department