

**ENTERED**

NOV 29 2004

05-cons-133-com

OPERATOR Pickrell Drilling Company, INC TICKET # 05110404 DATE 11-19-04  
 ADDRESS 100 S. Main, Suite 505 OPERATOR'S LICENSE # 5123  
Wichita, Kansas 67202 API NO. 15-135-24,255-0000  
 LEASE Carlson-Rolf WELL NO. 1  
 QUARTER SE/4 SEC 30 TWP 16S RGE 26 E       
 W X

**COMMINGLING 82-3-123**

- X 1. Description of the well.  
A plat showing:
  - a) Location of subject well.
  - b) Location of other wells on the lease.
  - c) Location of offsetting wells and operator's name.
- X 2. Names and upper and lower limits of the source of supply involved.

(NAME) Ft. Scott (Lower) (PERFS) 4477-4500 Overall  
 (NAME) Lansing "K" (PERFS) 4230-4234  
 (NAME) \_\_\_\_\_ (PERFS) \_\_\_\_\_

- X 3. Wireline log of the subject well.
- X 4. A complete ACO-1 form.
- X 5. Expected production, oil-gas-water, for each source of supply.

FORMATION	<u>Ft. Scott</u>	BOPD	<u>1.67</u>	MCF	_____	BWPD	<u>6</u>
FORMATION	<u>Lsg. "K"</u>	BOPD	<u>21.65</u>	MCF	_____	BWPD	<u>-0-</u>
FORMATION	_____	BOPD	_____	MCF	_____	BWPD	_____
FORMATION	_____	BOPD	_____	MCF	_____	BWPD	_____

ESTIMATED COMBINED TOTAL \_\_\_\_\_ BOPD \_\_\_\_\_ MCF 23.22 BWPD 6

- X 6. Application shall be supported by an Affidavit and shall contain a certificate showing service of a copy of the application without attachments to the offsetting operators. You are responsible for this. Unless waivers are obtained, applications are held for fifteen days to give offsetting operators time to file objections. If waivers are obtained, applications can be processed immediately. If objections are filed, applications are then set for hearing.

RECEIVED  
NOV 22 2004  
KCC WICHITA

BAKER SERVICE TOOLS - TALLY PAD

New Completion  Work

Oil Company \_\_\_\_\_ Well No. 1 Field \_\_\_\_\_ Lease Carlson-Rolf  
Company Man \_\_\_\_\_ Date Drilled \_\_\_\_\_ County Ness State Kansas

Comingled Production

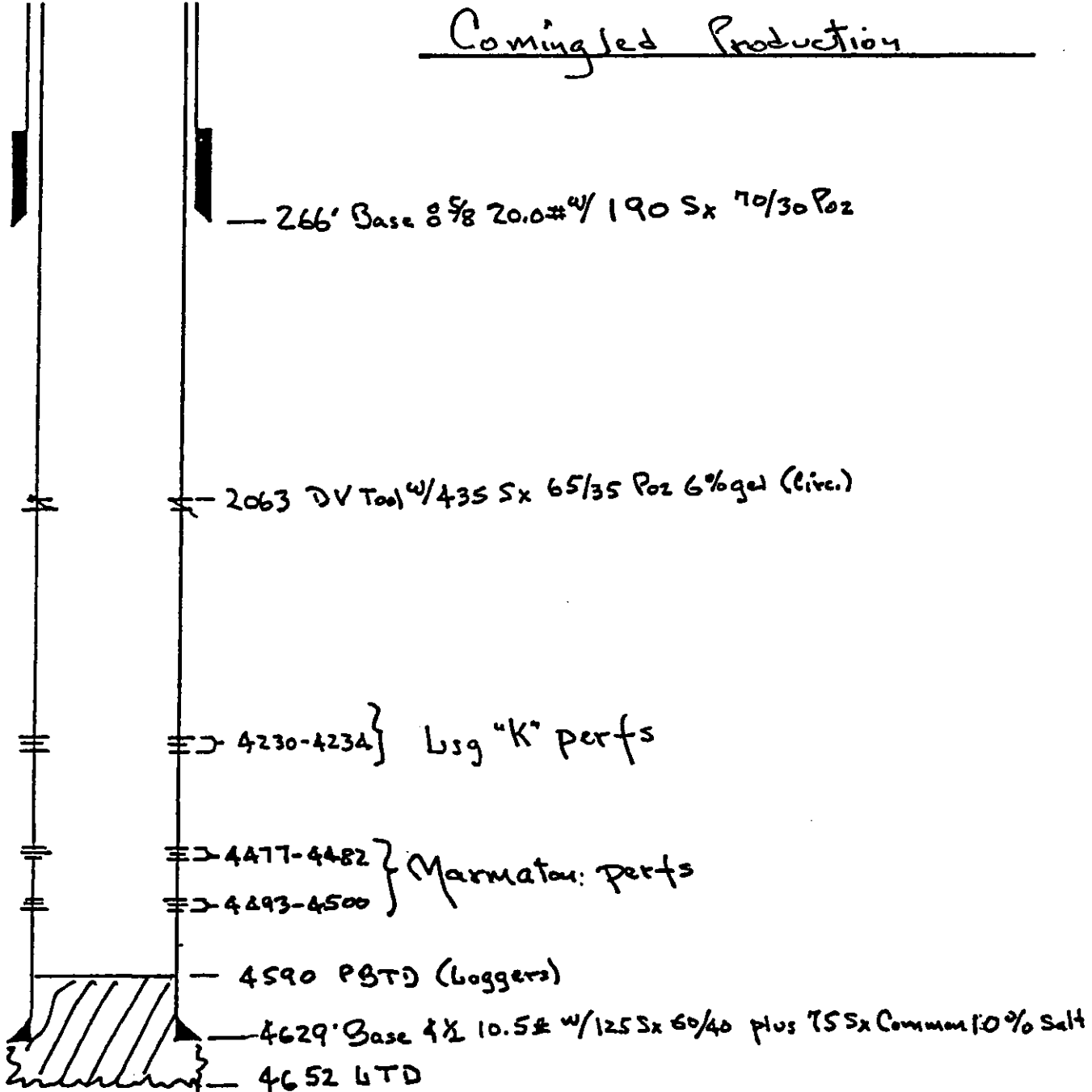

# R26W

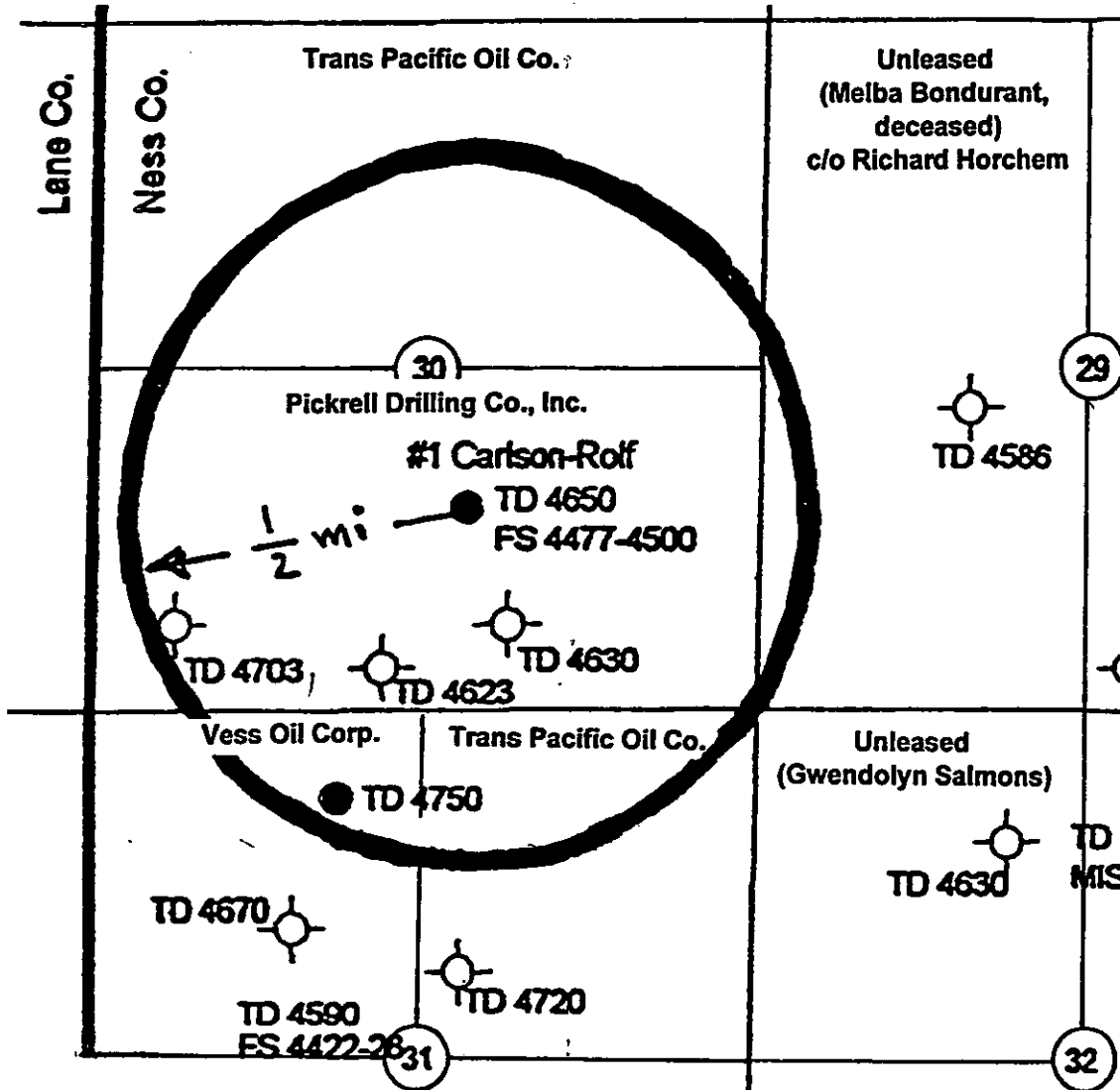

T16S

**AFFIDAVIT OF NOTICE SERVED**

RE: Application for: Comingling

Well Name: Carlson-Rolf

Legal location: 1550 ft. FSL & 2310 ft. FEL of Sec. 30-16S-26W  
Ness County, Kansas

The undersigned hereby certifies that he/she is a duly authorized agent for the applicant, and that on the 19<sup>th</sup> day of November, 2004, a true and correct copy of the application referenced above was delivered or mailed to the following parties:

Ownership within one-half mile of subject well:

NE/4 Section 30-16s-26w &  
NW/4 Section 30-16s-26w

Leased  
Trans Pacific Oil Corp.  
100 S. Main, Suite 200, Wichita, Ks. 67202

S/2 Section 30-16s-26w

Leased  
Pickrell Drilling Company, Inc.  
100 S. Main, Suite 505, Wichita, Ks. 67202

NW/4 Section 31-16s-26w

Leased  
Vess Oil Corp.  
8100 E. 22<sup>nd</sup> No. Bldg. 300  
Wichita, Ks. 67226

NE/4 Section 31-16s-26w

Leased  
Trans Pacific Oil Corp.  
100 S. Main, Suite 200, Wichita, Ks. 67202

W/2 Section 29-16s-26w

Unleased  
Melba Bondurant, Deceased  
c/o Richard Horchem  
506 North Street, Ness City, Ks. 67560

NW/4 Section 32-16s-26w

Unleased  
Gwendolyn Salmons  
P. O. Box 128  
Hanston, Ks. 67849

Signed this 19<sup>th</sup> day of November, 2004.

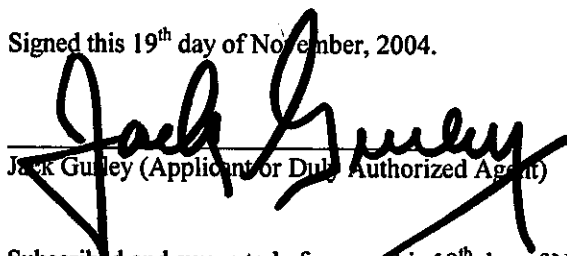
  
Jack Guiley (Applicant or Duly Authorized Agent)

Subscribed and sworn to before me this 19<sup>th</sup> day of November, 2004.

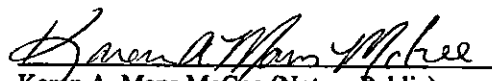
  
Karen A. Mans McGee (Notary Public)

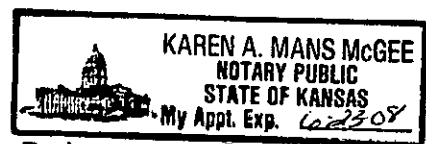

My Commission Expires: June 23, 2008

Protests may be filed by any party having a valid interest in the application. Petitions for protests shall be in writing and shall clearly identify the name and address of the protestant and the title of the application. The petition shall include a clear and concise statement of the direct and substantial interest of the protestant in the proceedings, including the manner in which the protestant may be affected, and the nature, extent, character and grounds of the protest. Protestants shall serve the protests upon the applicant by mail or personal service at the same time or before the protestant files the protest with the Conservation Division.