

R 22 W

T
11
S

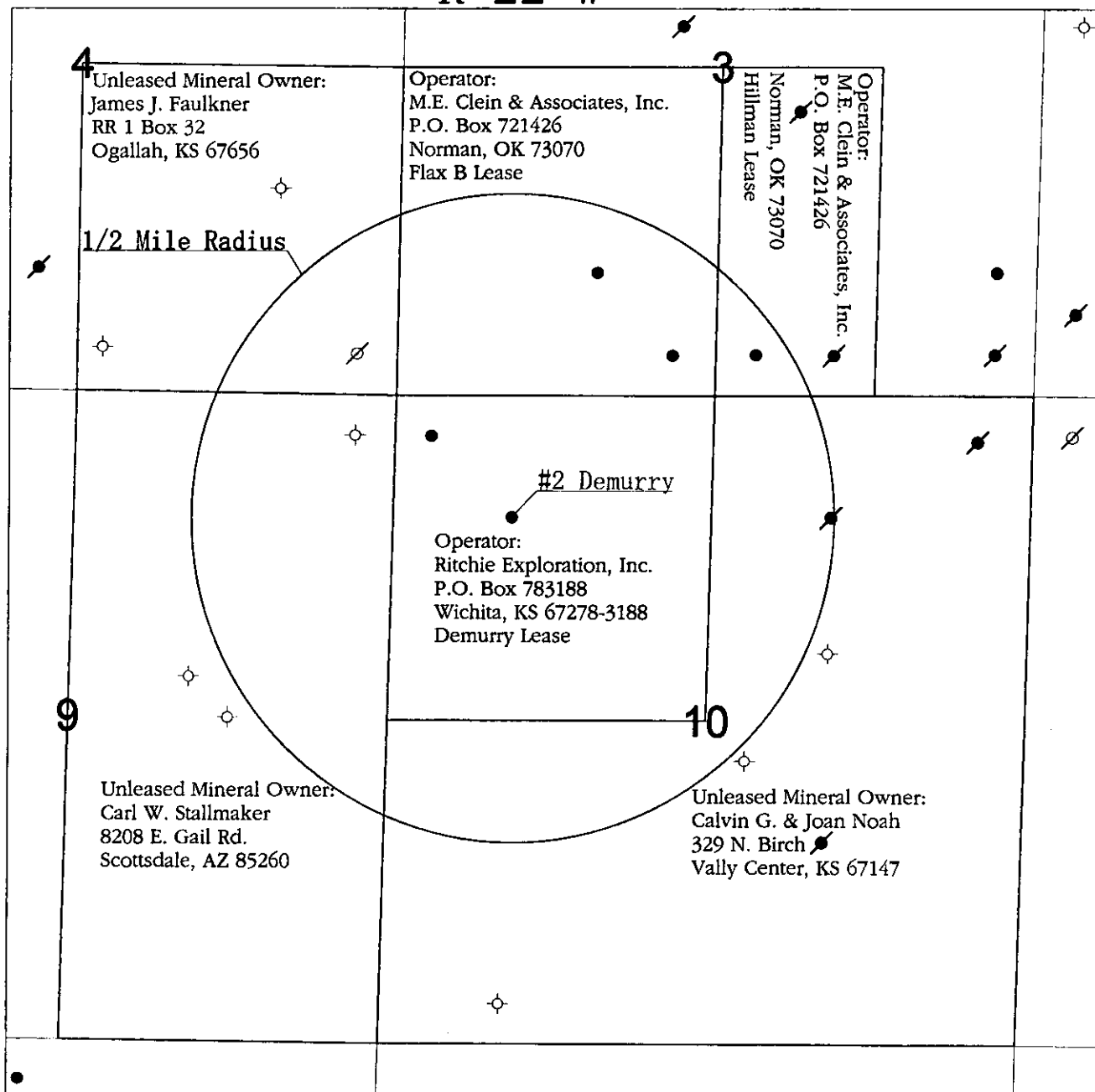

Legend

- Oil Well
- ⦿ Abandoned Oil Well
- Dry and Abandoned Well
- ⊗ Abandoned Location
- ▭ Lease Boundary

Ritchie Exploration, Inc.

**#2 Demurry Commingle Application Plat
Leaseholders Within 1/2 Mile Radius
Trego County, Kansas**

Author: Justin Clegg	Scale: 1 : 15,840	Date: 4 April, 2005
-------------------------	----------------------	------------------------

RECEIVED

APR 08 2005

KCC WICHITA



**#2 DeMurry
SE NW NW
Sec. 10-11S-22W
Trego County, Kansas**

**COMMINGLE LIST OF OWNERS AND OPERATORS
(WITHIN A ½ MILE RADIUS)**

SW/4 Sec. 04-11S-22W	James J. Faulkner RR1, Box 32 Ogallah, KS 67656	<u>Mineral Owner</u> Unleased
SE/4 Sec. 03-11S-22W	M.E. Clein & Associates, Inc. P.O. Box 747426 Norman, OK 73070	<u>Operator</u> Flax B Lease
E/2 SE/4 Sec. 03-11S-22W	M.E. Clein & Associates, Inc. P.O. Box 747426 Norman, OK 73070	<u>Operator</u> No Lease
E/2 Sec. 09-11S-22W	Carl W. Stallmaker Trust 8208 E. Gail Rd. Scottsdale, AZ 85269	<u>Mineral Owner</u> Unleased
S/2 & NE/4 Sec. 10-11S-22W	Calvin G. & Joan Noah 329 N. Birch Valley Center, KS 67147	<u>Mineral Owner</u> Unleased

**RECEIVED
APR 08 2005
KCC WICHITA**

P.O. Box 783188
Wichita, Kansas 67278-3188

(316) 691-9500
Fax (316) 691-9550
rei@ritchie-exp.com

8100 E. 22nd St. N., Bldg. 700
Wichita, Kansas 67226-2328

7004 1350 0000 3539 9366

U.S. Postal Service™
CERTIFIED MAIL™ RECEIPT
 (Domestic Mail Only; No Insurance Coverage Provided)

For delivery information visit our website at www.usps.com®

OFFICIAL USE

Postage	\$ 0.60
Certified Fee	2.30
Return Receipt Fee (Endorsement Required)	1.75
Restricted Delivery Fee (Endorsement Required)	
Total Postage & Fees	\$ 4.65

Postmark Here

Sent To
 Carl W. Stallmaker Trust
 8208 E. Gail Rd.
 Scottsdale, AZ 85269

PS Form 3800, June 2002 See Reverse for Instructions

7004 1350 0000 3539 9366

U.S. Postal Service™
CERTIFIED MAIL™ RECEIPT
 (Domestic Mail Only; No Insurance Coverage Provided)

For delivery information visit our website at www.usps.com®

OFFICIAL USE

Postage	\$ 0.60
Certified Fee	2.30
Return Receipt Fee (Endorsement Required)	1.75
Restricted Delivery Fee (Endorsement Required)	
Total Postage & Fees	\$ 4.65

Postmark Here

Sent To
 Calvin G. & Joan Noah
 329 N. Birch
 Valley Center, KS 67147

PS Form 3800, June 2002 See Reverse for Instructions

7004 1350 0000 3539 9376

U.S. Postal Service™
CERTIFIED MAIL™ RECEIPT
 (Domestic Mail Only; No Insurance Coverage Provided)

For delivery information visit our website at www.usps.com®

OFFICIAL USE

Postage	\$ 0.60
Certified Fee	2.30
Return Receipt Fee (Endorsement Required)	1.75
Restricted Delivery Fee (Endorsement Required)	
Total Postage & Fees	\$ 4.65

Postmark Here

Sent To
 M.E. Clein & Associates, Inc.
 P.O. Box 747426
 Norman, OK 73070

PS Form 3800, June 2002 See Reverse for Instructions

7004 1350 0000 3539 9352

U.S. Postal Service™
CERTIFIED MAIL™ RECEIPT
 (Domestic Mail Only; No Insurance Coverage Provided)

For delivery information visit our website at www.usps.com®

OFFICIAL USE

Postage	\$ 0.60
Certified Fee	2.30
Return Receipt Fee (Endorsement Required)	1.75
Restricted Delivery Fee (Endorsement Required)	
Total Postage & Fees	\$ 4.65

Postmark Here

Sent To
 James J. Faulkner
 RR1, Box 32
 Ogallah, KS 67656

PS Form 3800, June 2002 See Reverse for Instructions

RECEIVED
APR 08 2005
KCC WICHITA

DeMurre #1 & #2



April 6, 2005

State Corporation Commission
Conservation Division
130 S. Market, Room 2078
Wichita, KS 67202

**RE: #2 DeMurry
SE NW NW
Sec. 10-11S-22W
Trego County, Kansas**

To Whom It May Concern:

Enclosed please find Ritchie Exploration, Inc.'s Commingling Application (Form ACO-4) for the above referenced well. Enclosed are the required attachments. We are requesting the enclosed information be held confidential for maximum allowable time.

If you have any questions, please feel free to call the undersigned or John Niernberger at 316-691-9500. Thank you.

Sincerely,

A handwritten signature in cursive script, appearing to read "Jennifer Foss".

Jennifer Foss
Production Assistant

jlf

Enclosures

RECEIVED
APR 08 2005
KCC WICHITA

KANSAS

CORPORATION COMMISSION

KATHLEEN SEBELIUS, GOVERNOR

BRIAN J. MOLINE, CHAIR

ROBERT E. KREHBIEL, COMMISSIONER

MICHAEL C. MOFFET, COMMISSIONER

May 11, 2005

Jennifer Foss
Ritchie Exploration, Inc.
PO Box 783188
Wichita, KS 67278-3188

RE: **API No. 15-195-21406-00-01**
Demurry #2
SE NW NW, 10-11-21W
Trego County, Kansas

Dear Ms. Foss:

Your "Application for Commingling" (ACO-4) for the above described well has been technically reviewed and approved by the Kansas Corporation Commission (KCC) per **K.A.R. 82-3-123a**. This application, which was received by the KCC on **April 18, 2005**, concerns approval to simultaneously produce from the following **two** sources of supply through the same tubing string in the same wellbore: the **Topeka and Lansing-Kansas City**.

According to your application, the estimated current production from the **Topeka** source of supply is **9.86 BOPD** and **9.41 BWPD** and the estimated current production from the **Lansing-Kansas City** source of supply is **9.32 BOPD** and **12.21 BWPD**. The total estimated current production from all sources of supply in the subject well is **19.18 BOPD** and **21.62 BWPD**. Included in this application was operator verification that the offset operators had been formally notified of this application. No protest had been filed within the 15-day protest period.

Based upon the depth of the **Lansing-Kansas City** formation perforations, total oil production shall not exceed **100 BOPD** and total gas production shall not exceed **50%** of open flow. Docket Number **CO 040504** has been assigned to this approved application. Please use this number for well completion reports (ACO-1) and other correspondence that may concern this approved commingling.

Sincerely,



Bob Petersen

Geologist/KCC Production

DepartmentM:\PROD\Production_Shared\Prod_2005\AD-ORD\COMMINGLING\RITCHIE\CO

040504.doc