

OPERATOR DOWNING-NELSON OIL CO., INC DOCKET # CO 040508 DATE 3-24-05  
 ADDRESS POB 372 OPERATOR'S LICENSE # 30717  
HAYS, KS. 67601 API NO. 15- 135-24,323-00-00  
 LEASE SWARTZ "B" WELL NO. #1  
 QUARTER SE SEC 10 TWP 17s RGE 21w E W X X

COMMINGLING 82-3-123

RECEIVED

APR 06 2005

KCC WICHITA

- ✓ 1. Description of the well.  
 A plat showing:  
 a) Location of subject well.  
 b) Location of other wells on the lease.  
 c) Location of offsetting wells and operator's name.
- ✓ 2. Names and upper and lower limits of the source of supply involved.

(NAME) CHEROKEE SAND (PERFS) 4100-03  
 (NAME) MISSISSIPPIAN CHERT (PERFS) 4164-70  
 (NAME) \_\_\_\_\_ (PERFS) \_\_\_\_\_

- ✓ 3. Wireline log of the subject well.

- ✓ 4. A complete ACO-1 form.

- ✓ 5. Expected production, oil-gas-water, for each source of supply.

FORMATION	BOPD	MCF	BWPD
<u>CHEROKEE SAND</u>	<u>10</u>	<u>0</u>	<u>20</u>
<u>MISS CHERT</u>	<u>10</u>	<u>0</u>	<u>100</u>
_____	_____	_____	_____
_____	_____	_____	_____
<b>ESTIMATED COMBINED TOTAL</b>	<u>20</u>	<u>0</u>	<u>120</u>

6. Application shall be supported by an Affidavit and shall contain a certificate showing service of a copy of the application without attachments to the offsetting operators. You are responsible for this. Unless waivers are obtained, applications are held for fifteen days to give offsetting operators time to file objections. If waivers are obtained, applications can be processed immediately. If objections are filed, applications are then set for hearing.

RECEIVED  
KANSAS CORPORATION COMMISSION

APR 6 2005

REGISTRATION DIVISION  
UIC SECTION

Proposed 3D Survey

N/2 Sec. 10  
NO PROD. LEASED BY DOWNING-NELSON

10

DOWNING-NELSON  
SWARTZ #1-10

Cherokee Sd.  
4124 (-1904)

DOWNING-NELSON  
S/2 Sec. 10  
SWARTZ "B" #1  
Cherokee Sd.  
4100 (-1893)

Miss. 4164 (-1957)

N/2 Sec. 15  
NO PROD. LEASED BY DOWNING-NELSON

15

DOWNING-NELSON  
• CONNOR-WIERMAN #1-15  
Cherokee Sd. 4133 (1931)  
Miss. 4130 (-1978)

DOWNING-NELSON S/2 Sec. 15

RECEIVED  
KANSAS CORPORATION COMMISSION

APR 6 2005

CONSERVATION DIVISION  
UID SECTION

All Sec. 11 NO  
NO PROD LEASED  
BY DOWNING-  
NELSON

11

RECEIVED  
APR 06 2005  
KCC WICHITA

All Sec. 14  
NO PROD LEASED  
BY DOWNING-  
NELSON

14

17S21W

**Plat and Certificate of Injection Well Location and Surrounding Acreages**

Operator: DOWNING-NELSON OIL CO., INC. Location of Well: 3m. west MCRACKEN, KS.

Lease: SWARTZ "B" 930' Feet from SOUTH Section Line

Well Number: 1 910' Feet from EAST Section Line

County: NESS Sec. 10 Twp. 17 S. R. 21  East  West

**Plat**

Show the following information: applicant injection well, all producing wells, inactive wells, plugged wells, and other wells within a one-half mile radius, all lease boundaries, lease operators, unleased mineral rights owners, well numbers, and producing wells producing formation tops.

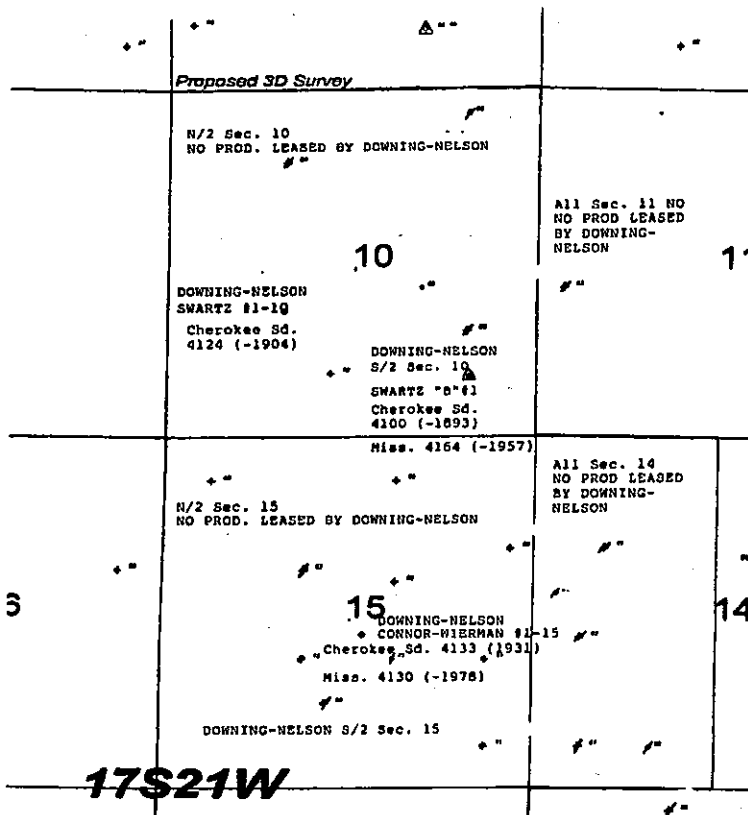

RECEIVED  
KANSAS CORPORATION COMMISSION  
APR 6 2005  
CONSERVATION DIVISION  
(HC SECTION)

RECEIVED  
APR 06 2005  
KCC WICHITA

- applicant well
- producing well
- plugged injection well
- D & A well
- other injection well
- temporary abandoned well
- plugged producer
- water supply well

The undersigned hereby certifies that he / she is a duly authorized agent for Downing-Nelson Oil Co., Inc. and that all of the information shown herein is true, complete and correct to the best of his / her knowledge.

Ale Downing  
Applicant or Duly Authorized Agent

Subscribed and sworn before me this 04 day of April, 2005

Shawn J. Robben  
SHAWN J. ROBBEN Public  
NOTARY PUBLIC  
STATE OF KANSAS  
My Appt. Exp. 2-2-06  
Commission Expires: 02/04/08

# KANSAS

## CORPORATION COMMISSION

KATHLEEN SEBELIUS, GOVERNOR  
BRIAN J. MOLINE, CHAIR  
ROBERT E. KREHBIEL, COMMISSIONER  
MICHAEL C. MOFFET, COMMISSIONER

April 26, 2005

Alan Downing  
Downing-Nelson Oil Co., Inc.  
PO Box 372  
Hays KS 67601

RE: Commingling and Dual Completion Applications for the Swartz "B" # 1,  
NW SE SE, 10-17-21W, Ness County, Kansas, API 15-135-24232-00-00

Dear Mr. Downing,

The above described commingling (ACO-4) and dual completion (ACO-5) applications were received on April 6, 2004 and assigned KCC docket numbers CO 040508 and DC 040509, respectively. Technical review has found that the following item is needed to complete this application:

- ACO-4 item 6 and ACO-5 item 8 "Affidavit of Notice Served to offset operators".

These applications, apparently, are associated with a saltwater disposal application for the Arbuckle in the same wellbore. Proof of notice served specifically for commingling and dual completion is required. If you have any questions please contact me at 316-337-6223.

Thank You,

  
Robert Petersen

M:\PROD\Production\_Shared\Prod\_2005\AD-ORD\COMMINGLING\DOWNING-NELSON\Outinfo.doc

# KANSAS

## CORPORATION COMMISSION

KATHLEEN SEBELIUS, GOVERNOR  
BRIAN J. MOLINE, CHAIR  
ROBERT E. KREHBIEL, COMMISSIONER  
MICHAEL C. MOFFET, COMMISSIONER

December 9, 2005

Downing-Nelson Oil Co., Inc.  
PO Box 372  
Hays KS 67601

**RE: Second Notice for information regarding Commingling and Dual Completion Applications for the Swartz "B" # 1, NW SE SE, 10-17-21W, Ness County, Kansas, API 15-135-24232-00-00.**

Dear Operator,

On April 26, 2005 I sent you a letter requesting information to complete the above referenced commingling (ACO-4) and dual completion (ACO-5) applications received on April 6, 2005. The following information was requested in the April letter:

- ACO-4 item 6 and ACO-5 item 8 "Affidavit of Notice Served to offset operators".

Proof of notice served specific to the commingling and dual completion applications is required. If you have any questions please contact me at 316-337-6223.

Thank You,

  
Robert Petersen

M:\PROD\Production\_Shared\Prod\_2005\AD-ORD\COMMINGLING\DOWNING-NELSON\Outinfo.doc

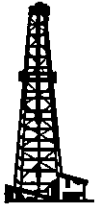

# Downing - Nelson Oil Co., Inc.



Ron Nelson (785) 628-3449  
Cell (785) 623-3592

113 West 13th  
P.O. Box 372  
Hays, Kansas 67601

Alan Downing (620) 598-2122  
Cell (620) 544-5283

Office: (785) 621-2610 Fax: (785) 621-2612

December 15, 2005

Kansas Corporation Commission  
Conservation Division  
130 S Market, Room 2078  
Wichita, KS 67202-3802

Attn: Robert Peterson

RE: Second notice for information regarding Commingling and Dual Completion Applications for the Swartz "B" #1, NW SE SE, 10-17-21W, Ness County, Kansas.

Downing & Nelson Oil Company, is the lease holder of all of the offset acreage.

RECEIVED  
DEC 19 2005  
KCC WICHITA

  
\_\_\_\_\_  
Signature of Applicant of Agent

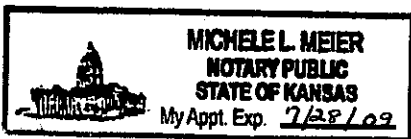

  
\_\_\_\_\_  
Notary Public

My Commission Expires: 7-28-09

# KANSAS

CORPORATION COMMISSION

KATHLEEN SEBELIUS, GOVERNOR  
BRIAN J. MOLINE, CHAIR  
ROBERT E. KREHBIEL, COMMISSIONER  
MICHAEL C. MOFFET, COMMISSIONER

December 9, 2005

Downing-Nelson Oil Co., Inc.  
PO Box 372  
Hays KS 67601

**RE: Second Notice for information regarding Commingling and Dual Completion Applications for the Swartz "B" # 1, NW SE SE, 10-17-21W, Ness County, Kansas, API 15-135-24232-00-00**

Dear Operator,

On April 26, 2005 I sent you a letter requesting information to complete the above referenced commingling (ACO-4) and dual completion (ACO-5) applications received on April 6, 2005. The following information was requested in the April letter:

- ACO-4 item 6 and ACO-5 item 8 "Affidavit of Notice Served to offset operators".

Proof of notice served specific to the commingling and dual completion applications is required. If you have any questions please contact me at 316-337-6223.

Thank You,

  
Robert Petersen

**RECEIVED**  
**DEC 19 2005**  
**KCC WICHITA**

M:\PROD\Production\_Shared\Prod\_2005\AD-ORD\COMMINGLING\DOWNING-NELSON\Outinfo.doc

*wayne*

# KANSAS

## CORPORATION COMMISSION

KATHLEEN SEBELIUS, GOVERNOR  
BRIAN J. MOLINE, CHAIR  
ROBERT E. KREHBIEL, COMMISSIONER  
MICHAEL C. MOFFET, COMMISSIONER

December 21, 2005

Ron Nelson  
Downing-Nelson Oil Co., Inc.  
PO Box 372  
Hays KS 67601

**RE: Approved Commingling CO 040508**  
**Swartz "B" #1, NW SE SE, Sec. 10, T.17S, R. 21W, Ness County, Kansas**  
**API No. 15-135-24323-00-00**

Dear Mr. Nelson:

Your "Application for Commingling" (ACO-4) for the above described well has been technically reviewed and approved by the Kansas Corporation Commission (KCC) per **K.A.R. 82-3-123a**. This application, which was received by the KCC on **April 6, 2005** concerns approval to simultaneously produce from the following **two** sources of supply through the same tubing string in the same wellbore: the **Cherokee Sand** and the **Mississippian Chert** formations.

According to your application, the estimated current production from the **Cherokee Sand** source of supply is **10 BOPD and 20 BWPD**. The estimated current production from the **Mississippian Chert** source of supply is **10 BOPD and 100 BWPD**. The total estimated current production from all sources of supply in the subject well is **20 BOPD and 120 BWPD**. Included in this application was operator verification that the offset operators had been formally notified of this application. No protest had been filed within the 15-day protest period.

Based upon the depth of the **Mississippian Chert** formation perforations, total oil production shall not exceed **200 BOPD** and total gas production shall not exceed **50%** of open flow.

Docket Number **CO 040508** has been assigned to this approved application. Please use this number for well completion reports (ACO-1) and other correspondence that may concern this approved commingling.

Sincerely,



Robert Petersen

Geologist/KCC Production

DepartmentM:\PROD\Production\_Shared\Prod\_2005\AD-ORD\COMMINGLING\DOWNING-  
NELSON\CO 040508.doc