

RECEIVED

JUN 23 2005

KCC WICHITA

ACO-4
8/90

COMMINGLING 82-3-123

OPERATOR Ritchie Exploration, Inc. DOCKET # CO 060504 DATE 6/22/2005
 ADDRESS P.O. Box 783188 OPERATOR LICENSE # 4767
Wichita, KS 67278-3188 API NO. 15 - 101-21870-00-00
 LEASE Richards-James WELL NO. #1

QUARTER E/2 SEC 17 TWP 17 RGE 28 E W

- 1. Description of the well.
A plat showing:
 - a) Location of subject well.
 - b) Location of other wells on the lease.
 - c) Location of offsetting wells and operator's name.

- 2. Name and upper and lower limits of the source of supply involved.

| | |
|------------------------|-----------------------------|
| (NAME) <u>Marmaton</u> | (PERFS) <u>4327'- 4331'</u> |
| (NAME) <u>LKC-H</u> | (PERFS) <u>4150'- 4154'</u> |
| (NAME) <u>LKC-E</u> | (PERFS) <u>4054'- 4060'</u> |
| (NAME) _____ | (PERFS) _____ |

- 3. Wireline log of the subject well.

- 4. A completed ACO-1 form

- 5. Expected production, oil-gas-water, for each source of supply.

| | | | |
|---------------------------------|-----------------------|------------------|-----------------------|
| FORMATION <u>Marmaton</u> | BOPD <u>4</u> | MCF _____ | BWPD <u>23</u> |
| FORMATION <u>LKC-H</u> | BOPD <u>10</u> | MCF _____ | BWPD <u>1</u> |
| FORMATION <u>LKC-E</u> | BOPD <u>8</u> | MCF _____ | BWPD <u>1</u> |
| FORMATION _____ | BOPD _____ | MCF _____ | BWPD _____ |
| FORMATION _____ | BOPD _____ | MCF _____ | BWPD _____ |
| ESTIMATED COMBINED TOTAL | BOPD <u>22</u> | MCF _____ | BWPD <u>25</u> |

- 6. Application shall be supported by an affidavit and shall contain a certificate showing service of a copy of the application without attachments to the offsetting operators. You are responsible for this. Unless waivers are obtained, applications are held for fifteen days to give the offsetting operators time to file objections. If waivers are obtained, applications can be processed immediately. If objections are filed, applications are set for hearing.

R 28 W

T
17
S

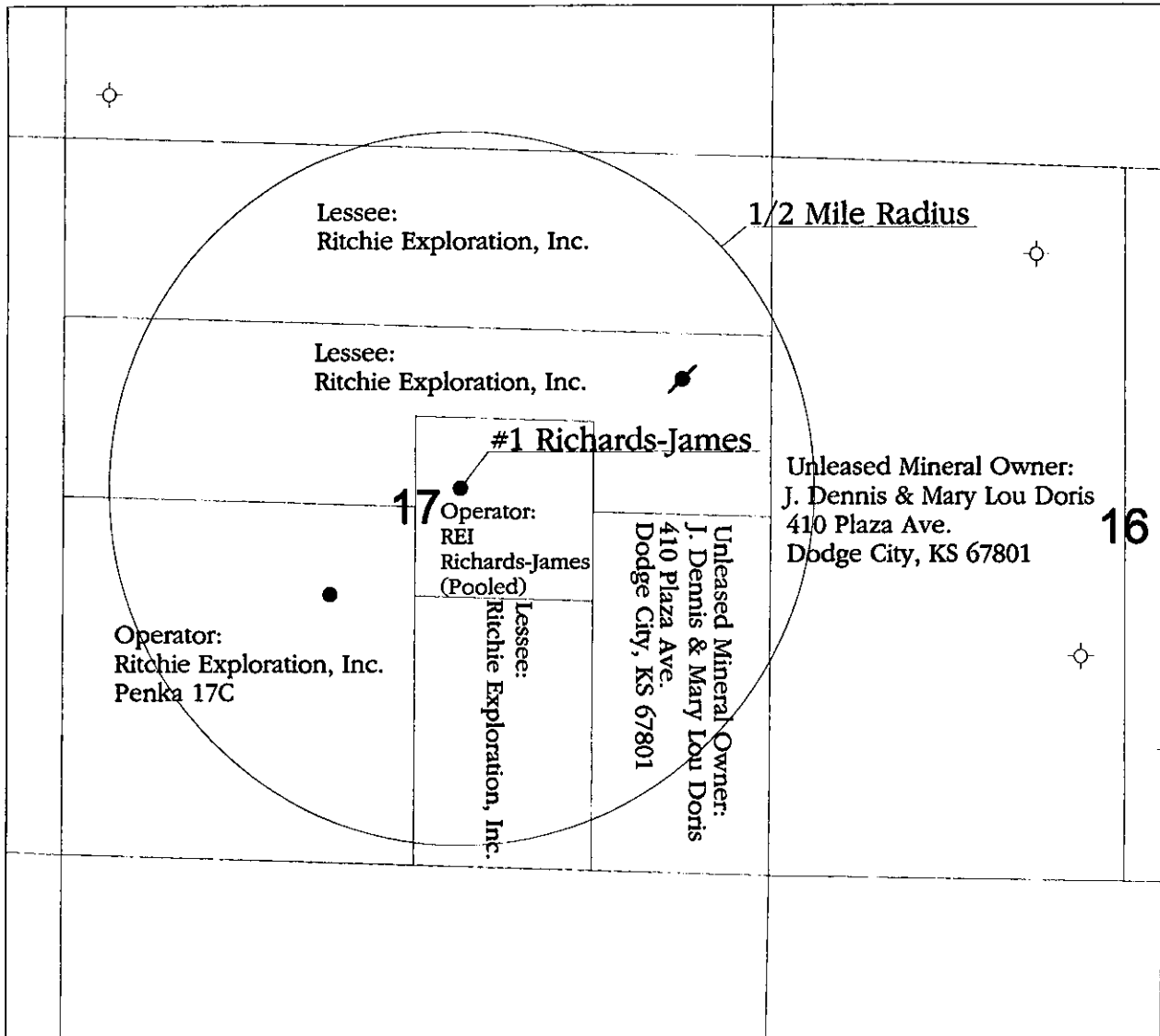

- Legend**
- Oil Well
 - ⚡ Abandoned Oil Well
 - ⊙ Dry and Abandoned Well

| | | |
|---|----------------------|-------------------------|
| Ritchie Exploration, Inc. | | |
| #1 Richards-James Commingle Application Plat Leaseholders Within 1/2 Mile Radius Lane County, Kansas | | |
| Created By: Justin Clegg | | Date: 19 April, 2005 |
| | Scale: 1 : 15,840 | |

RECEIVED

JUN 23 2005

KCCWICHT

#1 Richards-James
 2510' FNL & 2310' FEL
 Section 17-17S-28W
 Lane Co., Kansas

Offset Operators, Unleased Mineral Owners or Lessee within ½ Mile

17S-28W

| | | | |
|---------|--------------------------------|--|---|
| Sec. 16 | W/2 | J. Dennis & Mary Lou Doris 410 Plaza Ave. Dodge City, KS 67801 | Land/Mineral Owners |
| Sec. 17 | N/2 N/2 | Ritchie Exploration, Inc. | Lessee |
| | S/2 NW, N/2 SW NE, SE NE | Ritchie Exploration, Inc. | Lessee |
| | S/2 SE NE, N/2 NW SE | Ritchie Exploration, Inc. | Operator: Richards-James (pooled) |
| | SW/4 | Ritchie Exploration, Inc. | Operator: Penka 17C |
| | E/2 SE/4 | J. Dennis & Mary Lou Doris 410 Plaza Avenue Dodge City, KS 67801 | Land/Mineral Owners |

RECEIVED
 JUN 23 2005
 KCC WICHITA



RITCHIE

EXPLORATION, INC.
Wichita, Kansas

RECEIVED

JUN 23 2005

KCCWICHITA

June 22, 2005

State Corporation Commission
Conservation Division
130 S. Market, Room 2078
Wichita, KS 67202

RE: #1 Richards-James
Sec. 17-17S-28W
Lane County, Kansas

To Whom It May Concern:

Enclosed please find an ACO-4 for the above referenced well. The required attachments have also been enclosed. Ritchie Exploration, Inc. requests this information to be held confidential for the maximum allowable time.

If you have any questions, please feel free to call the undersigned or John Niernberger at 316-691-9500. Thank you for all of your help in this matter.

Sincerely,

Debbie Phillips
Accounting Supervisor

Enclosures



RECEIVED
SEP 09 2005
KCC WICHITA

September 8, 2005

State Corporation Commission
Conservation Division
130 S. Market, Room 2078
Wichita, KS 67202

RE: #1 Richards-James
Sec. 17-17S-28W
Lane County, Kansas

To Whom It May Concern:

Enclosed please find a copy of the list of offset Operators, Unleased Mineral Owners or Lessee's within a 1/2 mile radius of our Richards-James #1 well. Please note that there are not any offset Operators.

If you have any questions, please feel free to call 316-691-9500. Thank you for all of your help in this matter.

Sincerely,

John C. Niernberger
Production Manager

Enclosures

Subscribed and sworn to me on this 8th day of September, 2005.

Debra K. Phillips (Notary Public)
My Commission Expires on 5/4/07.

DEBRA K. PHILLIPS
Notary Public - State of Kansas
My Appt. Expires 5/4/07

RECEIVED
SEP 09 2005
KCC WICHITA

#1 Richards-James
2510' FNL & 2310' FEL
Section 17-17S-28W
Lane Co., Kansas

Offset Operators, Unleased Mineral Owners or Lessee within 1/2 Mile

17S-28W

| | | | |
|---------|--------------------------------|--|---|
| Sec. 16 | W/2 | J. Dennis & Mary Lou Doris 410 Plaza Ave. Dodge City, KS 67801 | Land/Mineral Owners |
| Sec. 17 | N/2 N/2 | Ritchie Exploration, Inc. | Lessee |
| | S/2 NW, N/2 SW NE, SE NE | Ritchie Exploration, Inc. | Lessee |
| | S/2 SE NE, N/2 NW SE | Ritchie Exploration, Inc. | Operator: Richards-James (pooled) |
| | SW/4 | Ritchie Exploration, Inc. | Operator: Penka 17C |
| | E/2 SE/4 | J. Dennis & Mary Lou Doris 410 Plaza Avenue Dodge City, KS 67801 | Land/Mineral Owners |

KANSAS

CORPORATION COMMISSION

KATHLEEN SEBELIUS, GOVERNOR
BRIAN J. MOLINE, CHAIR
ROBERT E. KREHBIEL, COMMISSIONER
MICHAEL C. MOFFET, COMMISSIONER

August 31, 2005

Debbie Phillips
Ritchie Exploration, Inc.
PO Box 783188
Wichita, KS 67278-3188

RE: **API No. 15-101-21870-00-00**
Richard-James #1
E/2 17-17-28W
Lane County, Kansas

Dear Ms. Phillips:

Your "Application for Commingling" (ACO-4) for the above described well was received by the KCC on June 23, 2005. The following information is needed to complete this application:

Item 6.) Affidavit of notice to offset operators.

If there are no offset operators to notice please provide a notarized affidavit stating that there are no offset operators. Please contact me if you have any questions regarding this application.

Sincerely,

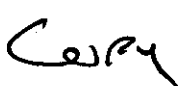
Bob Petersen
Geologist/KCC Production
DepartmentM:\PROD\Production_Shared\Prod_2005\AD-ORD\COMMINGLING\RITCHIE\CO
060504 outinfo.doc

KANSAS

CORPORATION COMMISSION

KATHLEEN SEBELIUS, GOVERNOR
BRIAN J. MOLINE, CHAIR
ROBERT E. KREHBIEL, COMMISSIONER
MICHAEL C. MOFFET, COMMISSIONER

Debbie Phillips
Ritchie Exploration, Inc.
PO Box 783188
Wichita, KS 67278-3188

RE: Commingling Application
Richard-James #1, E/2 17-17-28W, Lane County, Kansas
API No. 15-101-21870-00-00

Dear Ms. Foss:

Your "Application for Commingling" (ACO-4) for the above described well has been technically reviewed and approved by the Kansas Corporation Commission (KCC) per **K.A.R. 82-3-123a**. This application, which was received by the KCC on **June 23, 2005**, concerns approval to simultaneously produce from the **Lansing-Kansas City** and **Marmaton** sources of supply through the same tubing string in the same wellbore.

According to your application, the **Lansing-Kansas City** source of supply is estimated to produce **18 BOPD** and **2 BWPD** and the **Marmaton** source of supply is estimated to produce **4 BOPD** and **23 BWPD**. The total estimated current production from both sources of supply in the subject well is **22 BOPD** and **25 BWPD**. Operator verification was included with this application that stated that there are no offset operators to the subject well.

Based upon the depth of the **Marmaton** formation perforations the total oil production shall not exceed **200 BOPD** and total gas production shall not exceed **50%** of open flow. Docket Number **CO 060504** has been assigned to this approved application. Please use this number for well completion reports (ACO-1) and other correspondence that may concern this approved commingling.

Sincerely,

Bob Petersen

Geologist/KCC Production

DepartmentM:\PROD\Production_Shared\Prod_2005\AD-ORD\COMMINGLING\RITCHIE\CO 060504.doc