

ENTERED

APR 01 2004

CONFIDENTIAL

RECEIVED

APR 01 2004

ACO-4  
8/90

KCC WICHITA

04-CONS-302-COM

OPERATOR Ritchie Exploration, Inc. DOCKET # CO 040401 DATE 3/30/04

ADDRESS P.O. Box 783188 OPERATOR'S LICENSE # 4767

Wichita, KS 67278-3188 API NO. 15-159-02069-00-01

LEASE Grizzell C WELL NO. 3

QUARTER SE NE SW SEC 5 TWP 19 RGE 9 E      
W X

COMMINGLING 82-3-123

X 1. Description of the well.  
A plat showing:

- a) Location of subject well.
- b) Location of other wells on the lease.
- c) Location of offsetting wells and operator's name.

X 2. Names and upper and lower limits of the source of supply involved.

(NAME) L/KC (PERFS) 2973.3' - 2979.3'

(NAME) Arbuckle (PERFS) 3231' - 3236' (open-hole)

(NAME) \_\_\_\_\_ (PERFS) \_\_\_\_\_

X 3. Wireline log of the subject well.

X 4. A complete ACO-1 form.

X 5. Expected production, oil-gas-water, for each source of supply.

FORMATION L/KC BOPD 3 MCF \_\_\_\_\_ BWPD 79

FORMATION Arbuckle BOPD 2 MCF \_\_\_\_\_ BWPD 76

FORMATION \_\_\_\_\_ BOPD \_\_\_\_\_ MCF \_\_\_\_\_ BWPD \_\_\_\_\_

FORMATION \_\_\_\_\_ BOPD \_\_\_\_\_ MCF \_\_\_\_\_ BWPD \_\_\_\_\_

ESTIMATED COMBINED TOTAL \_\_\_\_\_ BOPD 5 MCF \_\_\_\_\_ BWPD 155

X 6. Application shall be supported by an Affidavit and shall contain a certificate showing service of a copy of the application without attachments to the offsetting operators. You are responsible for this. Unless waivers are obtained, applications are held for fifteen days to give offsetting operators time to file objections. If waivers are obtained, applications can be processed immediately. If objections are filed, applications are then set for hearing.

4322 5E86 9836 223E  
7000 099T E002

U.S. Postal Service™  
**CERTIFIED MAIL™ RECEIPT**  
(Domestic Mail Only; No Insurance Coverage Provided)  
For delivery information visit our website at www.usps.com®  
**OFFICIAL USE**

Postage	\$ .37	Postmark Here
Certified Fee	2.30	
Return Receipt Fee (Endorsement Required)	1.75	
Restricted Delivery Fee (Endorsement Required)		
Total Postage & Fees	\$ 4.42	

Sent To Deseret Trust Co. Farm Management  
 Street, Apt. No., or PO Box No. 50 East North Temple St. 22nd Fl  
 City, State, ZIP+4 Salt Lake City, UT 84150  
 PS Form 3800, June 2002 See Reverse for Instructions

4322 5E86 9836 223E  
7000 099T E002

U.S. Postal Service™  
**CERTIFIED MAIL™ RECEIPT**  
(Domestic Mail Only; No Insurance Coverage Provided)  
For delivery information visit our website at www.usps.com®  
**OFFICIAL USE**

Postage	\$ .37	Postmark Here
Certified Fee	2.30	
Return Receipt Fee (Endorsement Required)	1.75	
Restricted Delivery Fee (Endorsement Required)		
Total Postage & Fees	\$ 4.42	

Sent To Long Land L.P. George Ross  
 Street, Apt. No., or PO Box No. 2805 N. Adams  
 City, State, ZIP+4 Hutchinson, KS 67502  
 PS Form 3800, June 2002 See Reverse for Instructions

4322 5E86 9836 223E  
7000 099T E002

U.S. Postal Service™  
**CERTIFIED MAIL™ RECEIPT**  
(Domestic Mail Only; No Insurance Coverage Provided)  
For delivery information visit our website at www.usps.com®  
**OFFICIAL USE**

Postage	\$ .37	Postmark Here
Certified Fee	2.30	
Return Receipt Fee (Endorsement Required)	1.75	
Restricted Delivery Fee (Endorsement Required)		
Total Postage & Fees	\$ 4.42	

Sent To Duncan MacLaren  
 Street, Apt. No., or PO Box No. 875 Avenue H  
 City, State, ZIP+4 Chase, KS 67524  
 PS Form 3800, June 2002 See Reverse for Instructions

4322 5E86 9836 223E  
7000 099T E002

U.S. Postal Service™  
**CERTIFIED MAIL™ RECEIPT**  
(Domestic Mail Only; No Insurance Coverage Provided)  
For delivery information visit our website at www.usps.com®  
**OFFICIAL USE**

Postage	\$ .37	Postmark Here
Certified Fee	2.30	
Return Receipt Fee (Endorsement Required)	1.75	
Restricted Delivery Fee (Endorsement Required)		
Total Postage & Fees	\$ 4.42	

Sent To LARRY & Joan Novotny  
 Street, Apt. No., or PO Box No. P.O. Box 48  
 City, State, ZIP+4 Bushton, KS 67427  
 PS Form 3800, June 2002 See Reverse for Instructions

4322 5E86 9836 223E  
7000 099T E002

U.S. Postal Service™  
**CERTIFIED MAIL™ RECEIPT**  
(Domestic Mail Only; No Insurance Coverage Provided)  
For delivery information visit our website at www.usps.com®  
**OFFICIAL USE**

Postage	\$ .37	Postmark Here
Certified Fee	2.30	
Return Receipt Fee (Endorsement Required)	1.75	
Restricted Delivery Fee (Endorsement Required)		
Total Postage & Fees	\$ 4.42	

Sent To James + Elma Groves  
 Street, Apt. No., or PO Box No. 2569 S. Boris  
 City, State, ZIP+4 Commerce, CA 90040  
 PS Form 3800, June 2002 See Reverse for Instructions

4322 5E86 9836 223E  
7000 099T E002

U.S. Postal Service™  
**CERTIFIED MAIL™ RECEIPT**  
(Domestic Mail Only; No Insurance Coverage Provided)  
For delivery information visit our website at www.usps.com®  
**OFFICIAL USE**

Postage	\$ .37	Postmark Here
Certified Fee	2.30	
Return Receipt Fee (Endorsement Required)	1.75	
Restricted Delivery Fee (Endorsement Required)		
Total Postage & Fees	\$ 4.42	

Sent To Theodore P. Keller  
 Street, Apt. No., or PO Box No. 1401 Pased Maravillosa  
 City, State, ZIP+4 Green Valley, AZ 85614  
 PS Form 3800, June 2002 See Reverse for Instructions

U.S. Postal Service™  
**CERTIFIED MAIL™ RECEIPT**  
(Domestic Mail Only; No Insurance Coverage Provided)

For delivery information visit our website at [www.usps.com](http://www.usps.com)

**OFFICIAL USE**

2912 5996 1000 0991 E002

Postage	\$ .37
Certified Fee	2.30
Return Receipt Fee (Endorsement Required)	1.75
Restricted Delivery Fee (Endorsement Required)	
Total Postage & Fees	\$ 4.42

Postmark  
Here

Sent To	Val Energy, Inc
Street, Apt. No., or PO Box No.	P.O. Box 116
City, State, ZIP+4	Wichita, KS 67201-0116



RECEIVED  
APR 01 2004  
KCC WICHITA

March 30, 2004

State Corporation Commission  
Conservation Division  
130 S. Market, Room 2078  
Wichita, KS 67202

RE: #3 Grizzell C  
SE NE SW  
Sec. 5-19S-9W  
Rice County, Kansas

To Whom It May Concern:

Enclosed please find Ritchie Exploration, Inc.'s Commingling Application (Form ACO-4) for the above referenced well. Enclosed are the required attachments. We are requesting the information be held confidential for a one-year period.

If you have any questions, please feel free to call the undersigned or John Niernberger at 316-691-9500. Thank you.

Sincerely,

Debbie Phillips  
Accounting Supervisor

dkp

Enclosures

# 19S - 9W

1/2 Mile Radius

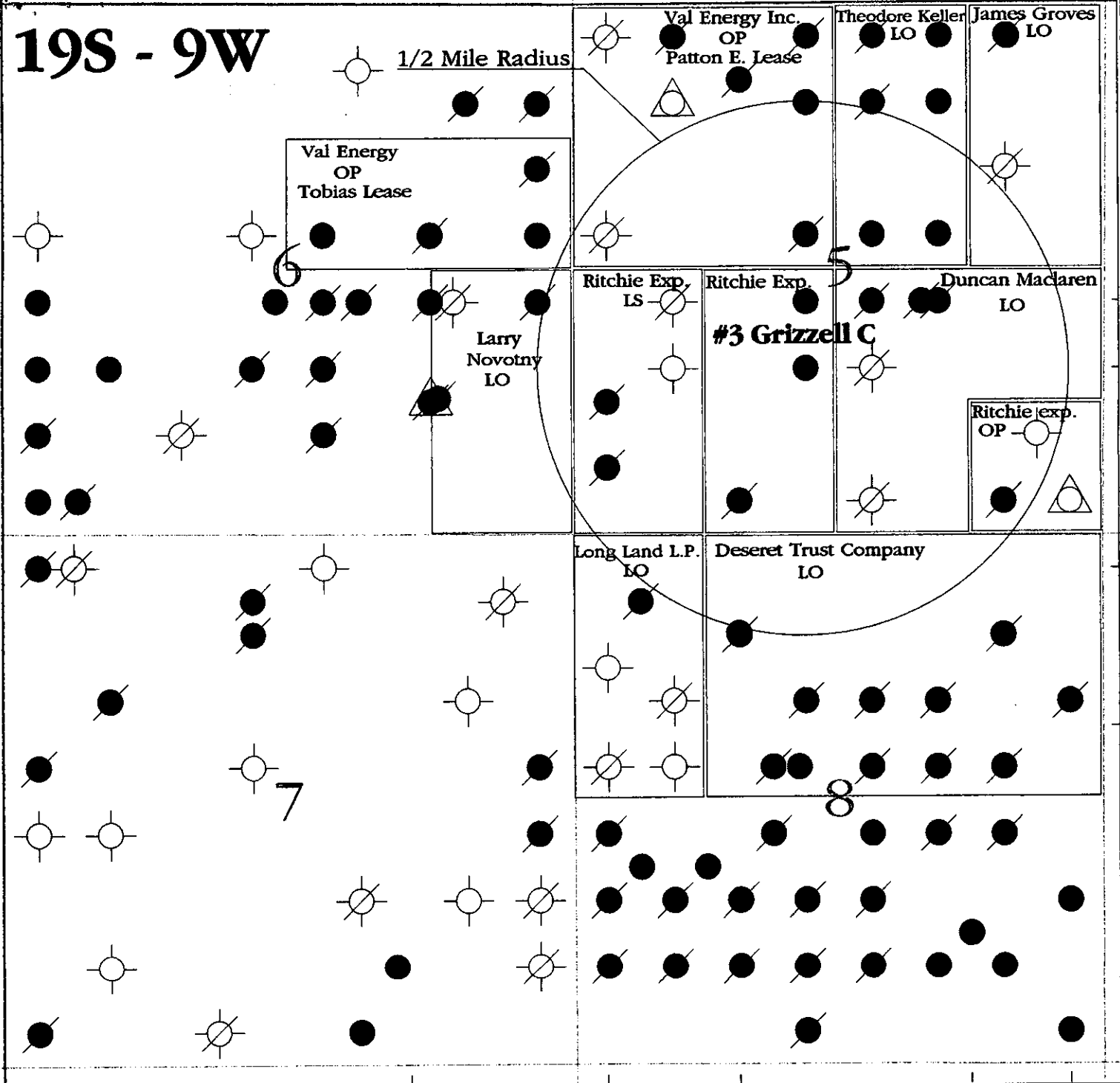

**LEGEND**

- Oil Well
- ◊ Drilled and Abandoned
- △ Service Well
- ⊗ Abandoned Oil Well
- ⊕ Service Well Completion Attempt
- ⊗ Dry and Abandoned Completion Attempt
- LO = Land Owner
- LS = Lessee
- OP = Operator

**RECEIVED**  
**APR 01 2004**  
**KCC WICHITA**

Ritchie Exploration, Inc.		
#3 Grizzell C Commingle Plat Application Rice County		
Justin Clegg		11/18/2003
Scale 1:17000.		

Each operator or lessee or landowner of record within a one-half mile radius of the

#3 Grizzell C  
E/2SW/4 Section 5-19S-9W  
Rice County, Kansas

RECEIVED  
APR 01 2004  
KCC WICHITA

19S-9W

<b>Sec. 5</b>	NW	Val Energy, Inc. PO Box 116 Wichita, KS 67201-0116	Operator: Patton E Lease
	E/2 NE	James & Elma Groves 2569 S. Boris Commerce, CA 90040	Landowner
	W/2 NE	Theodore P. Keller 1401 Paseo Maravilloso Green Valley, AZ 85614	Landowner
	W/2 SW	Ritchie Exploration, Inc. PO Box 783188 Wichita, KS 67278-3188	Lessee
	SE*	Duncan MacLaren 875 Avenue H Chase, KS 67524	Landowner
	*SE SE SE	Ritchie Exploration, Inc. PO Box 783188 Wichita, KS 67278-3188	Operator: #1 MacLaren SWD
<b>Sec. 6</b>	S/2 NE	Val Energy	Operator: Tobias Lease
	E/2 SE	Larry & Joan Novotny PO Box 48 Bushton, KS 67427	Landowner
<b>Sec. 8</b>			
	NE & E/2 NW	Deseret Trust Company % Farm Management 50 East North Temple St, 22 <sup>nd</sup> floor Salt Lake City, UT 84150	Landowner
	W/2 NW	Long Land, L.P. % George Ross 2805 N. Adams Hutchinson, KS 67502	Landowner