

ENTERED

CONFIDENTIAL

ACO-4
8/90

04-CONS-332-CCOM

OPERATOR Ritchie Exploration, Inc. DOCKET # CO 040406 DATE 4/8/04
 ADDRESS P.O. Box 783188 OPERATOR'S LICENSE # 4767
Wichita, KS 67278-3188 API NO. 15-065-22451-0001
 LEASE Allen Worcester B WELL NO. #1
 QUARTER NE SEC 24 TWP 6S RGE 22 E
W X

COMINGLING 82-3-123

RECEIVED

APR 21 2004

KCC WICHITA

- X 1. Description of the well.
 A plat showing:
 a) Location of subject well.
 b) Location of other wells on the lease.
 c) Location of offsetting wells and operator's name.
- X 2. Names and upper and lower limits of the source of supply involved.
- | | |
|-----------------------|--------------------------------|
| (NAME) <u>Shawnee</u> | (PERFS) <u>3535' - 3538'</u> |
| (NAME) <u>L/KC</u> | (PERFS) <u>3552.5' - 3555'</u> |
| (NAME) _____ | (PERFS) _____ |
- X 3. Wireline log of the subject well.
- X 4. A complete ACO-1 form.
- X 5. Expected production, oil-gas-water, for each source of supply.
- | | | | |
|--------------------------|----------------|-----------|---------------|
| FORMATION <u>Shawnee</u> | BOPD <u>59</u> | MCF _____ | BWPD <u>0</u> |
| FORMATION <u>L/KC</u> | BOPD <u>1</u> | MCF _____ | BWPD <u>0</u> |
| FORMATION _____ | BOPD _____ | MCF _____ | BWPD _____ |
| FORMATION _____ | BOPD _____ | MCF _____ | BWPD _____ |
- ESTIMATED COMBINED TOTAL _____ BOPD 60 MCF _____ BWPD 0
- X 6. Application shall be supported by an Affidavit and shall contain a certificate showing service of a copy of the application without attachments to the offsetting operators. You are responsible for this. Unless waivers are obtained, applications are held for fifteen days to give offsetting operators time to file objections. If waivers are obtained, applications can be processed immediately. If objections are filed, applications are then set for hearing.

CONFIDENTIAL

COMMINGLE APPLICATION

**#1 Allen Worcester B
E/2 SE/4 Sec. 13
& N/2 NE/4 Sec. 24-6S-22W
Graham Co., KS**

(Operators, Lessee & Landowners within 1/2 mile)

6S-21W

Sec. 18	SW/4	Esther Mae Worcester 3081 340th Avenue Bogue, KS 67625	Landowner
Sec. 19	NW/4	David & Wanda Worcester 3298 V Road Hill City, KS 67642	Landowner

6S-22W

Sec. 13	E/2SE/4	Ritchie Exploration, Inc.	Operator: Allen Worcester B
	W/2SE/4 & SW/4	Osage Resources, LLC 1605 E. 56th Avenue Hutchinson, KS 67502	Lessee
Sec. 24	N/2 NE/4	Ritchie Exploration, Inc.	Operator: Allen Worcester B
	S/2 NE/4 & NW/4	Great Eastern Energy PO Box 2436 Midland, TX 79702-2436	Lessee

**RECEIVED
APR 21 2004
KCC WICHITA**

R 22 W

R 21 W

6S

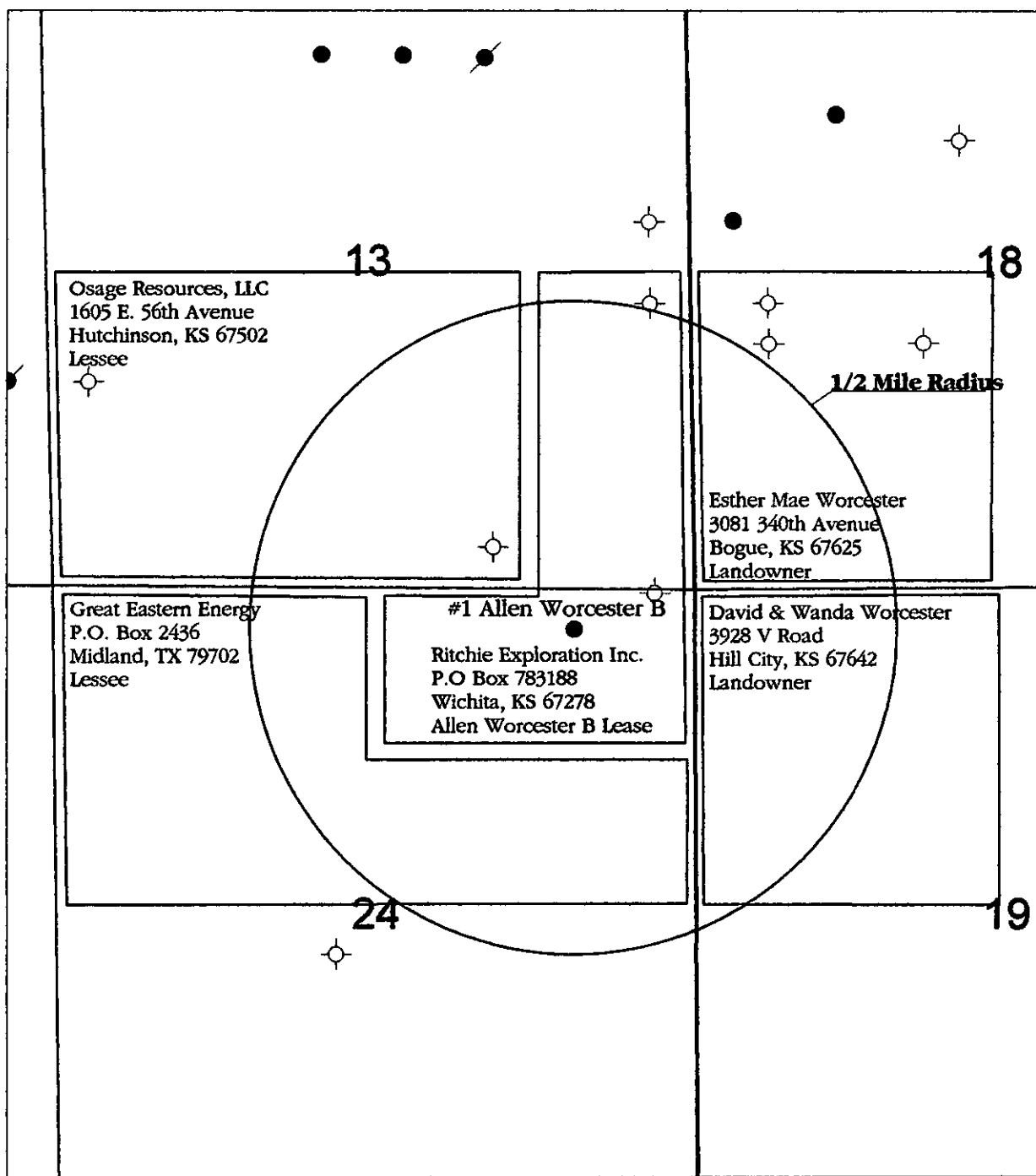

Ritchie Exploration Inc.

**#1 Allen Worcester B Commingle Application
6S-22W Sec. 24 : Graham County, Kansas
Operators, Lessee & Landowners Within 1/2 Mile**

Author: Justin Clegg	Date: 7 April, 2004
Scale: 1:15840	

RECEIVED
APR 21 2004
KCC WICHITA

7003 1680 0001 9835 2267

U.S. Postal Service™
CERTIFIED MAIL™ RECEIPT
 (Domestic Mail Only; No Insurance Coverage Provided)

For delivery information visit our website at www.usps.com

OFFICIAL USE

Postage	\$.37	Postmark Here
Certified Fee	2.30	
Return Receipt Fee (Endorsement Required)	1.75	
Restricted Delivery Fee (Endorsement Required)		
Total Postage & Fees	\$ 4.42	

Sent To: David + Wanda Worcester
 Street, Apt. No., or PO Box No.: 3298 V Road
 City, State, ZIP+4: Hill City, KS 67642

PS Form 3800, June 2002 See Reverse for Instructions

4222 5E96 7000 099T E002

U.S. Postal Service™
CERTIFIED MAIL™ RECEIPT
 (Domestic Mail Only; No Insurance Coverage Provided)

For delivery information visit our website at www.usps.com

OFFICIAL USE

Postage	\$.37	Postmark Here
Certified Fee	2.30	
Return Receipt Fee (Endorsement Required)	1.75	
Restricted Delivery Fee (Endorsement Required)		
Total Postage & Fees	\$ 4.42	

Sent To: Osage Resources, LLC
 Street, Apt. No., or PO Box No.: 11625 E 56th Avenue
 City, State, ZIP+4: Hutchinson, KS 67502

PS Form 3800, June 2002 See Reverse for Instructions

40E2 5E96 7000 099T E002

U.S. Postal Service™
CERTIFIED MAIL™ RECEIPT
 (Domestic Mail Only; No Insurance Coverage Provided)

For delivery information visit our website at www.usps.com

OFFICIAL USE

Postage	\$.83	Postmark Here
Certified Fee	2.30	
Return Receipt Fee (Endorsement Required)	1.75	
Restricted Delivery Fee (Endorsement Required)		
Total Postage & Fees	\$ 4.88	

Sent To: Great Eastern Energy
 Street, Apt. No., or PO Box No.: P.O. Box 2436
 City, State, ZIP+4: Midland TX 79702-2436

PS Form 3800, June 2002 See Reverse for Instructions

0522 5E96 7000 099T E002

U.S. Postal Service™
CERTIFIED MAIL™ RECEIPT
 (Domestic Mail Only; No Insurance Coverage Provided)

For delivery information visit our website at www.usps.com

OFFICIAL USE

Postage	\$.37	Postmark Here
Certified Fee	2.30	
Return Receipt Fee (Endorsement Required)	1.75	
Restricted Delivery Fee (Endorsement Required)		
Total Postage & Fees	\$ 4.42	

Sent To: Esther Mae Worcester
 Street, Apt. No., or PO Box No.: 3081 340th Avenue
 City, State, ZIP+4: Boque, KS 67625

PS Form 3800, June 2002 See Reverse for Instructions

RECEIVED
 APR 21 2004
 KCC WICHITA



RECEIVED
APR 21 2004
KCC WICHITA

April 20, 2004

State Corporation Commission
Conservation Division
130 S. Market, Room 2078
Wichita, KS 67202

RE: #1 Allen Worcester B
NW NE NE
Sec. 24-6S-22W
Graham County, Kansas

To Whom It May Concern:

Enclosed please find Ritchie Exploration, Inc.'s ACO-1 and ACO-4 for the above referenced well. Enclosed are the required attachments. We are requesting the information be held confidential for a one year period.

If you have any questions, please feel free to call the undersigned or John Niernberger at 316-691-9500. Thank you.

Sincerely,

Debbie Phillips
Accounting Supervisor

dkp

Enclosures