

COMMINGLING 82-3-123

OPERATOR Ritchie Exploration, Inc. DOCKET # G 10-05-03 DATE 10/12/2005
 ADDRESS P.O. Box 783188 OPERATOR LICENSE # 4767
Wichita, KS 67278-3188 API NO. 15 - 101-21851-00-0002
 LEASE Penka 17C WELL NO. #1
 QUARTER C NE SW SEC 17 TWP 17S RGE 28 E W

NE-SW

1. Description of the well.
 A plat showing:
 a) Location of subject well.
 b) Location of other wells on the lease.
 c) Location of offsetting wells and operator's name.
2. Name and upper and lower limits of the source of supply involved.

(NAME) <u>Marmaton</u>	(PERFS) <u>4330'-4333'</u>
(NAME) <u>LKC</u>	(PERFS) <u>4237'-4304'</u>
(NAME) _____	(PERFS) _____
(NAME) _____	(PERFS) _____

3. Wireline log of the subject well.
4. A completed ACO-1 form ✓
5. Expected production, oil-gas-water, for each source of supply.

FORMATION <u>Marmaton</u>	BOPD <u>30</u>	MCF _____	BWPD <u>20</u>
FORMATION <u>LKC</u>	BOPD <u>63</u>	MCF _____	BWPD <u>0</u>
FORMATION _____	BOPD _____	MCF _____	BWPD _____
FORMATION _____	BOPD _____	MCF _____	BWPD _____
FORMATION _____	BOPD _____	MCF _____	BWPD _____
ESTIMATED COMBINED TOTAL	BOPD <u>93</u>	MCF _____	BWPD <u>20</u>

RECEIVED
OCT 21 2005
KCC WICHITA

6. Application shall be supported by an affidavit and shall contain a certificate showing service of a copy of the application without attachments to the offsetting operators. You are responsible for this. Unless waivers are obtained, applications are held for fifteen days to give the offsetting operators time to file objections. If waivers are obtained, applications can be processed immediately. If objections are filed, applications are set for hearing. ✓

R 28 W

T
17
S

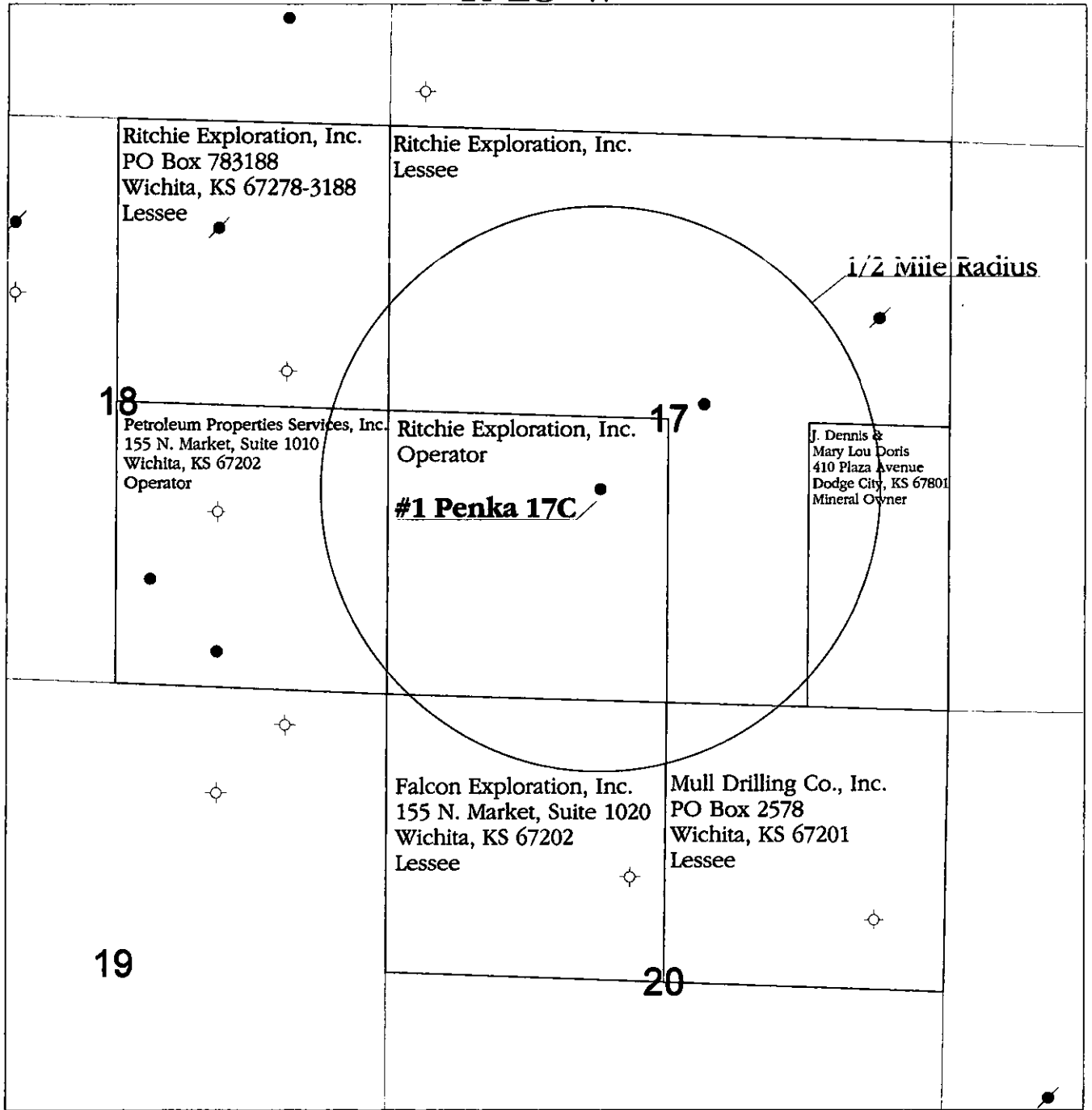

- Legend**
- Oil Well
 - / Abandoned Oil Well
 - Dry and Abandoned Well

RECEIVED
OCT 21 2005
KCC WICHITA

 <p>RITCHIE EXPLORATION, INC. Wichita, Kansas</p>		<p>#1 Penka 17C</p>
<p>Commingle Application: Lessee of Record, Operators, and Mineral Owners Within 1/2 Mile Radius Lane County, Kansas</p>		
<p>Prepared By: Justin Clegg</p>	<p>Scale: 1 : 17,500</p>	<p>Date: September 8, 2005</p>

7005 0390 0003 1631 9647

U.S. Postal Service™
CERTIFIED MAIL™ RECEIPT
(Domestic Mail Only; No Insurance Coverage Provided)

For delivery information visit our website at www.usps.com

OFFICIAL USE

Postage	\$.37
Certified Fee	2.30
Return Receipt Fee (Endorsement Required)	1.75
Restricted Delivery Fee (Endorsement Required)	
Total Postage & Fees	\$ 4.42

Postmark Here

Sent To Petroleum Properties Services, Inc.
 Street, Apt. No., or PO Box No. 155 N. Market, Suite 1010
 City, State, ZIP+4 Wichita, KS 67202
 PS Form 3800, June 2002 See Reverse for Instructions

7005 0390 0003 1631 9646

U.S. Postal Service™
CERTIFIED MAIL™ RECEIPT
(Domestic Mail Only; No Insurance Coverage Provided)

For delivery information visit our website at www.usps.com

OFFICIAL USE

Postage	\$.37
Certified Fee	2.30
Return Receipt Fee (Endorsement Required)	1.75
Restricted Delivery Fee (Endorsement Required)	
Total Postage & Fees	\$ 4.42

Postmark Here

Sent To Mull Drilling Co., Inc.
 Street, Apt. No., or PO Box No. P.O. Box 2578
 City, State, ZIP+4 Wichita, KS 67201
 PS Form 3800, June 2002 See Reverse for Instructions

7005 0390 0003 1631 9654

U.S. Postal Service™
CERTIFIED MAIL™ RECEIPT
(Domestic Mail Only; No Insurance Coverage Provided)

For delivery information visit our website at www.usps.com

OFFICIAL USE

Postage	\$.37
Certified Fee	2.30
Return Receipt Fee (Endorsement Required)	1.75
Restricted Delivery Fee (Endorsement Required)	
Total Postage & Fees	\$ 4.42

Postmark Here

Sent To J. Dennis & Mary Lou Doris
 Street, Apt. No., or PO Box No. 410 Plaza Ave
 City, State, ZIP+4 Sodge City, KS 67801
 PS Form 3800, June 2002 See Reverse for Instructions

7005 0390 0003 1631 9646

U.S. Postal Service™
CERTIFIED MAIL™ RECEIPT
(Domestic Mail Only; No Insurance Coverage Provided)

For delivery information visit our website at www.usps.com

OFFICIAL USE

Postage	\$.37
Certified Fee	2.30
Return Receipt Fee (Endorsement Required)	1.75
Restricted Delivery Fee (Endorsement Required)	
Total Postage & Fees	\$ 4.42

Postmark Here

Sent To Falcon Exploration, Inc.
 Street, Apt. No., or PO Box No. 155 N. Market, Ste 1020
 City, State, ZIP+4 Wichita, KS 67202
 PS Form 3800, June 2002 See Reverse for Instructions

RECEIVED
OCT 21 2005
KCC WICHITA

KANSAS

CORPORATION COMMISSION

KATHLEEN SEBELIUS, GOVERNOR
BRIAN J. MOLINE, CHAIR
ROBERT E. KREHBIEL, COMMISSIONER
MICHAEL C. MOFFET, COMMISSIONER

December 8, 2005

John Niernberger
Ritchie Exploration Inc.
PO Box 793188
Wichita KS 67278-3188

RE: Approved Commingling CO 100503
Penka 17C #1, NE SW, Sec. 17, T.17S, R. 28W, Lane County, Kansas
API No. 15-101-21851-00-0002

Dear Mr. Neirnberger:

Your "Application for Commingling" (ACO-4) for the above described well has been technically reviewed and approved by the Kansas Corporation Commission (KCC) per **K.A.R. 82-3-123a**. This application, which was received by the KCC on **October 21, 2005** concerns approval to simultaneously produce from the following two sources of supply through the same tubing string in the same wellbore: the **Lansing-Kansas City** and the **Marmaton** formations.

According to your application, the estimated current production from the **Lansing-Kansas City** source of supply is **63 BOPD**. The estimated current production from the **Marmaton** source of supply is **30 MCFGPD** and **20 BWPD**. The total estimated current production from all sources of supply in the subject well is **93 BOPD** and **20 BWPD**. Included in this application was operator verification that the offset operators had been formally notified of this application. No protest had been filed within the 15-day protest period.

Based upon the depth of the **Marmaton** formation perforations, total oil production shall not exceed **200 BOPD** and total gas production shall not exceed **50%** of open flow.

Docket Number **CO 100503** has been assigned to this approved application. Please use this number for well completion reports (ACO-1) and other correspondence that may concern this approved commingling.

Sincerely,



Robert Petersen
Geologist/KCC Production

DepartmentM:\PROD\Production_Shared\Prod_2005\AD-ORD\COMMINGLING\RITCHIE\CO

100503.doc