

KANSAS CORPORATION COMMISSION
OIL & GAS CONSERVATION DIVISION

Form ACO-4
Form must be typed
September 2005

APPLICATION FOR COMMINGLING OF
PRODUCTION (K.A.R. 82-3-123) OR FLUIDS (K.A.R. 82-3-123a)

Commingling ID # 06110505

Operator Information:

License #: 33335
Name: IA Operating, Inc.
Address: 900 N Tyler Road #14
City/State/Zip: Wichita, KS 67212
Contact Person: Hal Porter
Phone #: 316-721-0036

Well Information:

API #: 15 - 151-25281 - 0000
Lease Name: Mary Well #: 29-1
Spot: NE - NW - SE - SW Sec. 29 Twp. 12 S. R. 16 ☐ East
County: Ellis ☒ West
Feet from ☐ North / ☒ South Line of Section: 1200
Feet from ☐ East / ☒ West Line of Section: 1720

1. Name and upper and lower limit of each production interval to be commingled:

| | |
|---------------------------------|--------------------------------------|
| Formation: <u>Topeka</u> | (Perfs): <u>3019'-22'</u> |
| Formation: <u>LKC-C</u> | (Perfs): <u>3312'-16'</u> |
| Formation: <u>LKC-D</u> | (Perfs): <u>3326'-32'</u> |
| Formation: <u>LKC-F & G</u> | (Perfs): <u>3368'-70', 3375'-80'</u> |
| Formation: <u>LKC-I & K</u> | (Perfs): <u>3437'-41', 3484'-87'</u> |

2. Estimated amount of fluid production to be commingled from each interval:

| | | | |
|---------------------------------|----------------|-----------------|----------------|
| Formation: <u>Topeka</u> | BOPD: <u>1</u> | MCFPD: <u>0</u> | BWPD: <u>2</u> |
| Formation: <u>LKC-C</u> | BOPD: <u>1</u> | MCFPD: <u>0</u> | BWPD: <u>2</u> |
| Formation: <u>LKC-D</u> | BOPD: <u>1</u> | MCFPD: <u>0</u> | BWPD: <u>2</u> |
| Formation: <u>LKC-F & G</u> | BOPD: <u>1</u> | MCFPD: <u>0</u> | BWPD: <u>2</u> |
| Formation: <u>LKC-I & K</u> | BOPD: <u>1</u> | MCFPD: <u>0</u> | BWPD: <u>2</u> |

☒ 3. Plat map showing the location of the subject well, all other wells on the subject lease, and all wells on offsetting leases within a 1/2 mile radius of the subject well, and for each well the names and addresses of the lessee of record or operator.

☒ 4. Signed certificate showing service of the application as required in K.A.R. 82-3-135a(b).

For Commingling of PRODUCTION ONLY, include the following:

- ☒ 5. Wireline log of subject well.
☒ 6. Complete Form ACO-1 (Well Completion form) for the subject well.

For Commingling of FLUIDS ONLY, include the following:

5. Well construction diagram of subject well.
6. Any available water chemistry data demonstrating the compatibility of the fluids to be commingled.

State of _____)
County of _____)

ss:

VERIFICATION: I hereby certify that to the best of my current information, knowledge and personal belief, this request for commingling is true and proper and I have no information or knowledge, which is inconsistent with the information supplied in this application.

Signature: Hal Porter
Printed Name: Hal Porter
Title: President

Subscribed & sworn to before me this 10 day of November, 20 05
Notary Public: Julie Burrows
My Commission Expires: March 10, 2009

KCC Office Use Only

☐ Denied ☒ Approved

KCC Date Received: 11/14 15-Day Periods Ends: 11/29
Approved By: 258 Date: 12/29/05



State of Kansas Geographic Information Systems Policy Board, Data Access and Support Center, and
Please email questions and comments on t

Kansas Oil and Gas Field Viewer

Overview Map

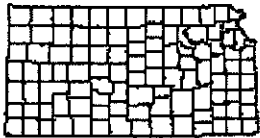

? Zoom Level: 1.5 Full Field Extent

EMMERAM TOWNSITE
LANS.-K.C. & ARBUCKLE
Produces Oil
Active
[Legal Field Definition](#)
[Link to Gemini Production Module](#)
[Link to DPA Field Horizon Mapping](#)

?
Legend

- Unknown
- CBM
- TA
- SWD
- Other
- Oil
- Oil & Gas
- Location
- Injection
- Gas
- EOR
- PLSS

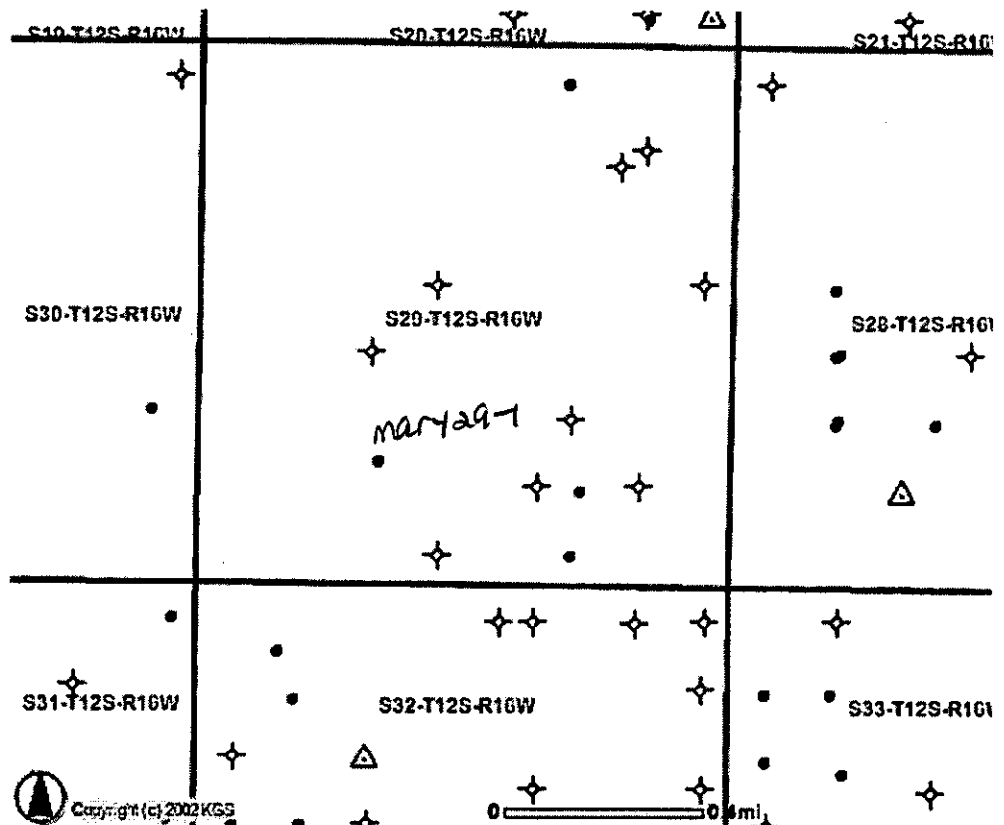

RECEIVED
NOV 14 2005
KCC WICHITA