

ENTERED

JAN 15 2004

RECEIVED

04-CONS-188-COM

JAN 09 2004

ACO-4
8/90

KCC WICHITA 04-CONS-188-COM

OPERATOR Pickrell Drilling Co., Inc DOCKET # 0010408 DATE 12-10-03

ADDRESS 100 S. Main, Suite 505 OPERATOR'S LICENSE # 5123

Wichita, KS 67202 API NO. 15-033-21,315-0001

LEASE Bird "N" WELL NO. 2

QUARTER SW SE SEC 4 TWP 32S RGE 19 E W X

COMMINGLING 82-3-123

- 1. Description of the well.
A plat showing:
 - a) Location of subject well.
 - b) Location of other wells on the lease.
 - c) Location of offsetting wells and operator's name.
- 2. Names and upper and lower limits of the source of supply involved.

(NAME) Altamont (PERFS) 5007-5011

(NAME) Mississippi (PERFS) 5208-5213

(NAME) _____ (PERFS) _____

- 3. Wireline log of the subject well.
- 4. A complete ACO-1 form.
- 5. Expected production, oil-gas-water, for each source of supply.

FORMATION Altamont BOPD -0- MCF 25 BHPD 5

FORMATION Mississippi BOPD -0- MCF 170 BHPD 50

FORMATION _____ BOPD _____ MCF _____ BHPD _____

FORMATION _____ BOPD _____ MCF _____ BHPD _____

ESTIMATED COMBINED TOTAL _____ BOPD -0- MCF 195 BHPD 55

- 6. Application shall be supported by an Affidavit and shall contain a certificate showing service of a copy of the application without attachments to the offsetting operators. You are responsible for this. Unless waivers are obtained, applications are held for fifteen days to give offsetting operators time to file objections. If waivers are obtained, applications can be processed immediately. If objections are filed, applications are then set for hearing.

Township 32S Range 19W County Comanche State Kansas

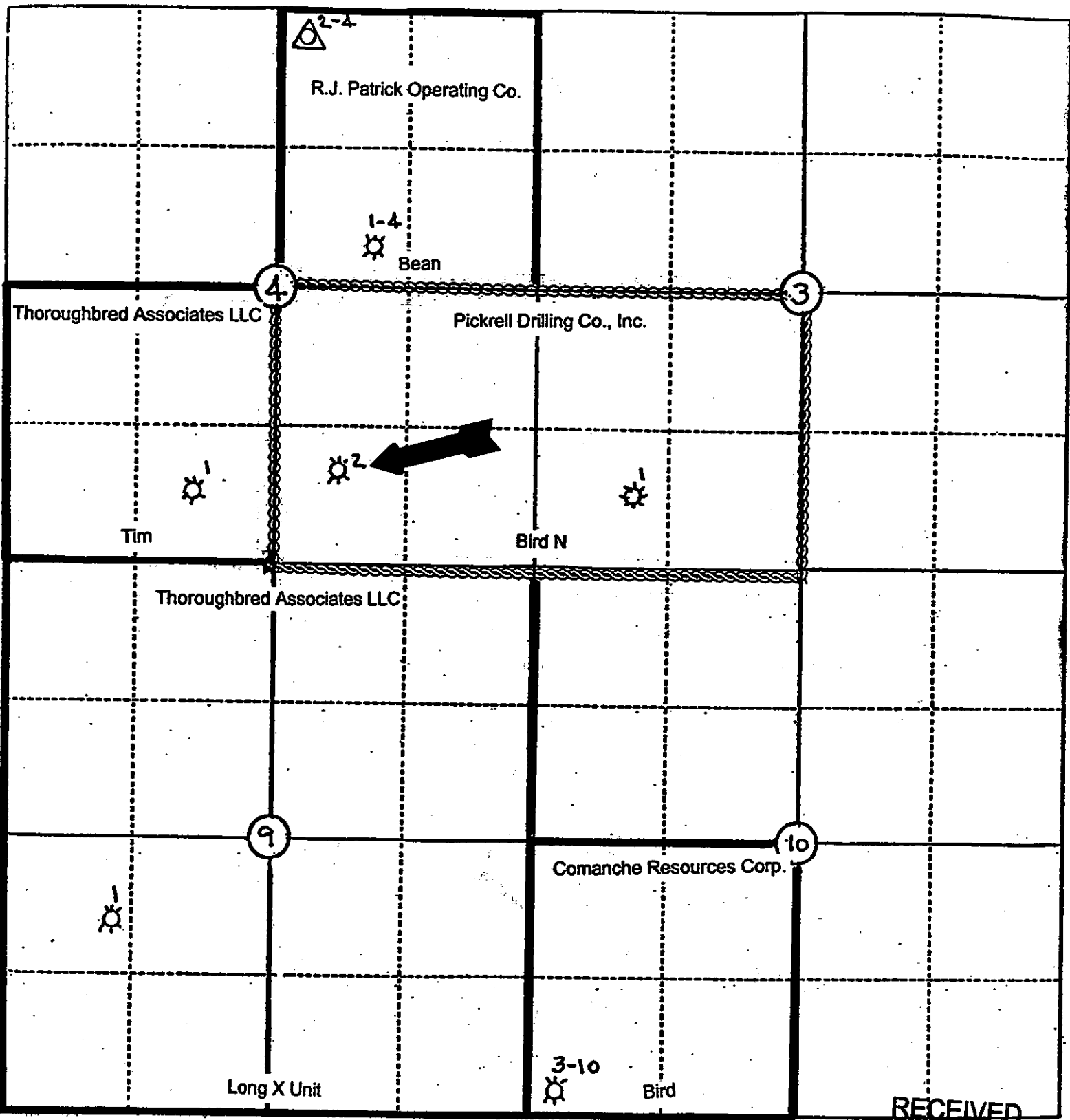

RECEIVED

JAN 09 2004
KCC WICHITA