

RECEIVED

JAN 26 2004

ACO-4
8/90

KCC WICHITA 04-CONS-194-COM

OPERATOR Citation Oil & Gas Corp. DOCKET # COOFOY11 DATE 1/20/04
 ADDRESS P O Box 690688 OPERATOR'S LICENSE # 03553
Houston, Texas 77269 API NO. 15- 007-00877 - 00-01
 LEASE R. L. Nuckolls WELL NO. 3
 QUARTER N/S S/2 NE SEC 30 TWP 31S RGE 11 E
 W X

COMMINGLING 82-3-123

- X 1. Description of the well. ✓
A plat showing:
a) Location of subject well.
b) Location of other wells on the lease.
c) Location of offsetting wells and operator's name.
- X 2. Names and upper and lower limits of the source of supply involved.

(NAME) Elgin (PERFS) 3368-3384
 (NAME) Miss Chat (PERFS) 4310-4332
 (NAME) _____ (PERFS) _____

- X 3. Wireline log of the subject well.
- X 4. A complete ACO-1 form.
- X 5. Expected production, oil-gas-water, for each source of supply.

FORMATION	<u>Elgin</u>	BOPD	<u>0</u>	MCF	<u>95</u>	BWPD	<u>47</u>
FORMATION	<u>Miss Chat</u>	BOPD	<u>2</u>	MCF	<u>100</u>	BWPD	<u>35</u>
FORMATION	_____	BOPD	_____	MCF	_____	BWPD	_____
FORMATION	_____	BOPD	_____	MCF	_____	BWPD	_____
ESTIMATED COMBINED TOTAL		BOPD	<u>2</u>	MCF	<u>195</u>	BWPD	<u>82</u>

- X 6. Application shall be supported by an Affidavit and shall contain a certificate showing service of a copy of the application without attachments to the offsetting operators. You are responsible for this. Unless waivers are obtained, applications are held for fifteen days to give offsetting operators time to file objections. If waivers are obtained, applications can be processed immediately. If objections are filed, applications are then set for hearing.

**KANSAS CORPORATION COMMISSION
OIL & GAS CONSERVATION DIVISION
WELL COMPLETION FORM
WELL HISTORY - DESCRIPTION OF WELL & LEASE**

Form ACO-1
September 1999
Form Must Be Typed

Operator: License # 03553
 Name: Citation Oil & Gas Corp.
 Address: P.O. Box 690688
 City/State/Zip: Houston, Texas 77269-0688
 Purchaser: People's Gas
 Operator Contact Person: Debra Harris
 Phone: (281) 517-7194
 Contractor: Name: Plains
 License: _____
 Wellsite Geologist: _____
 Designate Type of Completion:
 _____ New Well _____ Re-Entry Workover
 _____ Oil _____ SWD _____ SIOW _____ Temp. Abd.
 Gas _____ ENHR _____ SIGW
 _____ Dry _____ Other (Core, WSW, Expl., Cathodic, etc)
 If Workover/Re-entry: Old Well Info as follows:
 Operator: Tenneco Oil Exploration and Production
 Well Name: R.L. Nuckolls #3
 Original Comp. Date: 2/19/1952 Original Total Depth: 4332'
 _____ Deepening Re-perf. _____ Conv. to Enhr./SWD
 _____ Plug Back RBP @4260' _____ Plug Back Total Depth
 _____ Commingled _____ Docket No. _____
 _____ Dual Completion _____ Docket No. _____
 _____ Other (SWD or Enhr.?) _____ Docket No. _____

<u>8/13/2003</u>	<u>Unknown</u>	<u>8/27/2003</u>
Spud Date or Recompletion Date	Date Reached TD	Completion Date or Recompletion Date

API No. 15 - Unknown as there is no record in file
 County: Barber
 C N2 S2 NE Sec. 30 Twp. 1 S. R. 11 East West
 +/- 800 feet from S / N (circle one) Line of Section
 +/- 1200 feet from E / W (circle one) Line of Section
 Footages Calculated from Nearest Outside Section Corner:
 (circle one) NE SE NW SW
 Lease Name: R.L. Nuckolls Well #: 3
 Field Name: Wheilan
 Producing Formation: Elgin
 Elevation: Ground: 1552' Kelly Bushing: 1558'
 Total Depth: 4332' Plug Back Total Depth: 4260' RBP
 Amount of Surface Pipe Set and Cemented at 155 Feet
 Multiple Stage Cementing Collar Used? Yes No
 If yes, show depth set _____ Feet
 If Alternate II completion, cement circulated from _____
 feet depth to _____ w/ _____ sx cmt.

Drilling Fluid Management Plan

(Data must be collected from the Reserve Pit)

Chloride content _____ ppm Fluid volume _____ bbls
 Dewatering method used _____
 Location of fluid disposal if hauled offsite:
 Operator Name: _____
 Lease Name: _____ License No.: _____
 Quarter _____ Sec. _____ Twp. _____ S. R. _____ East West
 County: _____ Docket No.: _____

INSTRUCTIONS: An original and two copies of this form shall be filed with the Kansas Corporation Commission, 130 S. Market - Room 2078, Wichita, Kansas 67202, within 120 days of the spud date, recompletion, workover or conversion of a well. Rule 82-3-130, 82-3-106 and 82-3-107 apply. Information of side two of this form will be held confidential for a period of 12 months if requested in writing and submitted with the form (see rule 82-3-107 for confidentiality in excess of 12 months). One copy of all wireline logs and geologist well report shall be attached with this form. ALL CEMENTING TICKETS MUST BE ATTACHED. Submit CP-4 form with all plugged wells. Submit CP-111 form with all temporarily abandoned wells.

All requirements of the statutes, rules and regulations promulgated to regulate the oil and gas industry have been fully complied with and the statements herein are complete and correct to the best of my knowledge.

Signature: Debra Harris
 Title: Prod/Reg Coordinator Date: 9/11/2003
 Subscribed and sworn to before me this 11th day of September
 2003.
 Notary Public: Renee Harrell
 Date Commission Expires: 3-2-07

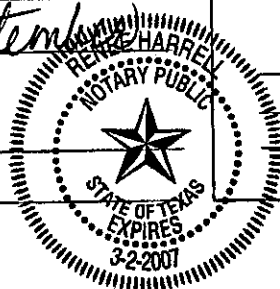

KCC Office Use ONLY

_____ Letter of Confidentiality Attached
 If Denied, Yes Date: _____
 _____ Wireline Log Received
 _____ Geologist Report Received
 _____ UIC Distribution

Operator Name: Citation Oil & Gas Corp. Lease Name: R.L. Nuckolls Well #: 3
 Sec. 30 Twp. 1 S. R. 11 East West County: Barber

INSTRUCTIONS: Show important tops and base of formations penetrated. Detail all cores. Report all final copies of drill stems tests giving interval tested, time tool open and closed, flowing and shut-in pressures, whether shut-in pressure reached static level, hydrostatic pressures, bottom hole temperature, fluid recovery, and flow rates if gas to surface test, along with final chart(s). Attach extra sheet if more space is needed. Attach copy of all Electric Wireline Logs surveyed. Attach final geological well site report.

Drill Stem Tests Taken Yes No
 (Attach Additional Sheets)
 Samples Sent to Geological Survey Yes No
 Cores Taken Yes No
 Electric Log Run Yes No
 (Submit Copy)
 List All E. Logs Run:

Log Formation (Top), Depth and Datum Sample
 Name Top Datum
 Elgin 3368'
 Miss. Chat 4310'

CASING RECORD <input type="checkbox"/> New <input checked="" type="checkbox"/> Used							
Report all strings set-conductor, surface, intermediate, production, etc.							
Purpose of String	Size Hole Drilled	Size Casing Set (In O.D.)	Weight Lbs./ Ft.	Setting Depth	Type of Cement	# Sacs Used	Type and Percent Additives
Surface	Unknown	8-5/8"	Unknown	155'	Unknown	125	Unknown
Production	Unknown	5-1/2"	17#	4310'	Unknown	175	Unknown

ADDITIONAL CEMENTING / SQUEEZE RECORD				
Purpose:	Depth Top Bottom	Type of Cement	#Sacks Used	Type and Percent Additives
<input type="checkbox"/> Perforate <input checked="" type="checkbox"/> Protect Casing <input type="checkbox"/> Plug Back TD <input type="checkbox"/> Plug Off Zone	3200'- 3393'	"A"	50 sx	2% CC
	3240' - 3358'	"C"	50 sx	2% CC

Shots Per Foot	PERFORATION RECORD - Bridge Plugs Set/Type Specify Footage of Each Interval Perforated	Acid, Fracture, Shot, Cement Squeeze Record (Amount and Kind of Material Used)	Depth
4 spf	Pkr @3176'; perf'd 1' @3393'	Pumped 50 sx "A" + 2% CC and drid out	3394' (btm)
4 spf	Pkr @3145'; perf'd @3358'	Pumped 50 sx "C" + 2% CC and drid out	3363' (btm)
4 spf	Perf'd Elgin Sand 3368' - 3384'	Acidized with 500 gals 7.5% DSFE Acid	3284' (pkr)

TUBING RECORD		Size	Set At	Packer At	Liner Run
		2-3/8"	3440'	3440'	<input type="checkbox"/> Yes <input checked="" type="checkbox"/> No
Date of First, Resumerd Production, SWD or Enhr. 8/28/2003			Producing Method <input checked="" type="checkbox"/> Flowing <input type="checkbox"/> Pumping <input type="checkbox"/> Gas Lift <input type="checkbox"/> Other (Explain)		
Estimated Production Per 24 Hours	Oil Bbls.	Gas Mcf	Water Bbls.	Gas-Oil Ratio	Gravity
0	195	82	N/A	N/A	

Disposition of Gas **METHOD OF COMPLETION** Production Interval
 Vented Sold Used on Lease Open Hole Perf. Dually Comp. Commingled
 (If vented, Submit ACO-18.) Other (Specify) _____

24

20

25

29

36

31

32

RECEIVED
JAN 26 2004
KCC WICHITA 19

31S 11W

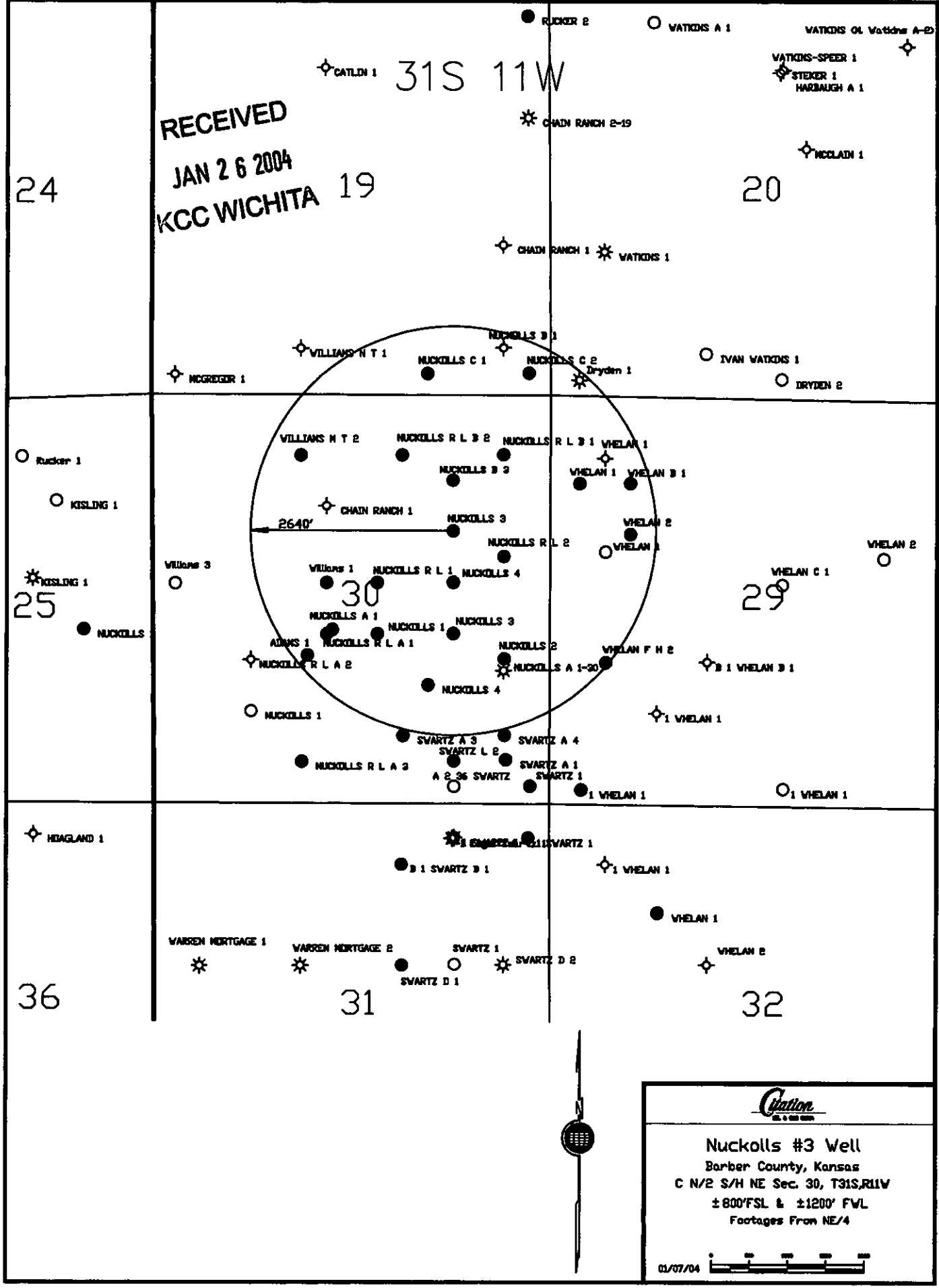
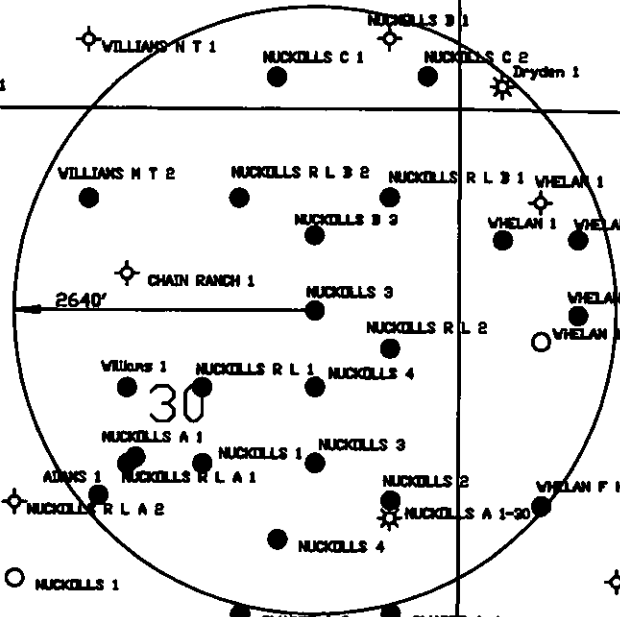

Chilton
S & S

Nuckolls #3 Well
Barber County, Kansas
C N/2 S/H NE Sec. 30, T31S,R11W
±800'FSL & ±1200' FVL
Footages From NE/4

01/07/04



Tenneco Oil Exploration and Production

RECEIVED

JAN 26 2004

KCC WICHITA

Lease & Well No. Nuckolls #3
 Location C 1/2 S 1/2 NE 1/4 Sec. 30-T31S-R11W
 Field Whelan
 County & State Barber Kansas
 Elevation 1558' (1552' GL) ~~(1552' RB)~~

Comp. 2-19-52
 5 1/2 bfpw 14% water (2-20-52)

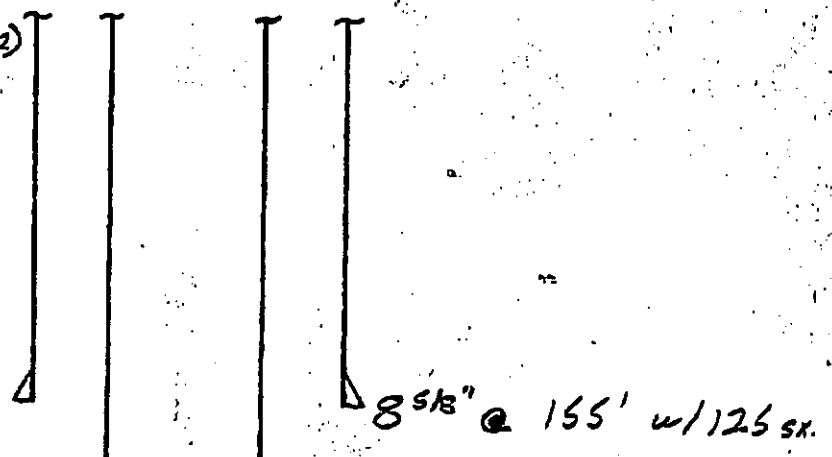

Treatments

- 17-55 Frac w/ 300 gal MA + oil flush
1400# 20/40 sd + ? gal wtr
- 24-57 Frac w/ 300 gal MA +
6000# 20/40 sd. Screened out
6000 psi max, 3200 psi min. press.
5 bpm
- 11-59 A/ 500 gal acid + 175 bbl wtr
- 15-61 Frac w/ 30,000# 20/40 sd +
9600 gal Dowell x 15%
2400# max p. 1250# min ISZP 1000#
VOC in 2 min.

TOC 3440'
Temp. Survey

Miss
Chat
O.H.
TO 4332'

5 1/2" 17# @ 4310' w/ 175 sx.
Prepared by TRR
Date 9-14-83

RECEIVED
 JAN 26 2004
 KCC WICHITA

COMMINGLING AFFIDAVIT CERTIFICATE OF SERVICE

Operator Name: Citation Oil & Gas Corp. KCC License Number: 03553
 Operator Address: P O Box 690688
Houston, Texas 77269
 Contact Person: Sharon Ward Phone Number: 281-517-7309
 Lease Name & Number: R. L. Nuckolls #3 API #: 15-007-00877
 Location: N/2 S/2 NE/4 SECTION 30; TWP 31S; RNG 11W
 County: Barber Field: Elgin/Miss Chat

All requirements of the statutes, rules and regulations promulgated to regulate the oil and gas industry have been fully complied with the statements here are complete and correct to the best of my knowledge. The well subscribed to in this affidavit will be produced in accordance with the terms of the applicable basic proration order. I hereby certify that I caused a true and correct copy of the foregoing Affidavit and any attachments of said Affidavit to be served by placing the same in the United States mail, postage paid, to the following parties:

Name Address

Offset Operators:

19-31S-11W	None		
20-31S-11W	None		
29-31S-11W	J. Fred Hambright, Inc.	125 North Market, Ste 1415	Wichita, KS 67530
30-31S-11W	Petroleum Property Services, Inc.	155 North Market, Ste 1010	Wichita, KS 67202-1824
30-31S-11W	Lario Oil & Gas Company c/o Sullivan & Cools	P O Box 756	Goddard, KS 67052
30-31S-11W	Abercrombie Energy, LLC	150 North Main, Ste 801	Wichita, KS 67202
31-31S-11W	Mich Energy Corp.	P O Box 20707	OKC, OK 73156

Surface Owners:

19-31S-11W
N/2 NE/4 Donald R & Barbara L. Rucker P O Box 71 Sharon, KS 67138
N/2 NW/4 Charles Haywood c/o Ralph Chain Rt. 1, Box 159 Canton, OK 73724
N/2 SE/4 c/o Ralph Chain



RECEIVED

JAN 26 2004

KCC WICHITA

January 21, 2004

Kansas Corporation Commission
Conservation Division
Finney State Office Building
130 S. Market, Room 2078
Wichita, KS 67202-3802

RE: R. L. Nuckolls #3
Application to Downhole Commingle
Elgin & Miss Chat
Barber County, KS

Dear Commission:

Citation Oil & Gas Corp. requests permission to downhole commingle the Elgin and Miss Chat formations in the R. L. Nuckolls #3 well.

Enclosed are as follows:

Form ACO-4
Form ACO-1
Plat of 1/2 mile radius showing offset wells
Wellbore schematic
Affidavit certificate of service, notarized
Plat showing offset operators and surface owners
Gamma Ray Neutron log of subject well

If you require additional information, please advise by contacting me at 281-517-7309 or e-mail at sward@cogc.com. Thank you.

Sincerely,

Sharon Ward
Regulatory Administrator
Citation Oil & Gas Corp.