

Briceland, Tom

Subject:

Page 1 - Public ROW Station 905 (H)

Public ROW Station 905 (H)

API #15-173-20951 -00-00

W 29th & N Meridian, Wichita (Sedgwick Co)

It appears that 8 API numbers were assigned to one cathodic groundbed for rectifier #905 but only 7 bore-holes were drilled.

Please see attached KGS work order 051.056.3721.010008 and Foreman's Log showing one bore-hole per (2) anodes (for wells "A" thru "G"). Hole for "H" was not drilled so therefor, API #15-173-20951 assigned to hole "H" was not needed.

FIELD SKETCH

VALLEY PARK

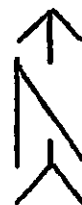

2- ANODES PER HOLE
 (E.E. & MERIDIAN)
 #1 - 171 N. & 29TH
 #2 - 191 N. & 29TH
 #3 - 211 N. & 29TH
 #4 - 231 N. & 29TH
 #5 - 251 N. & 29TH
 #6 - 271 N. & 29TH
 #7 - 291 N. & 29TH
 (SEE ANODE LOG FOR DEPTH)

MERIDIAN

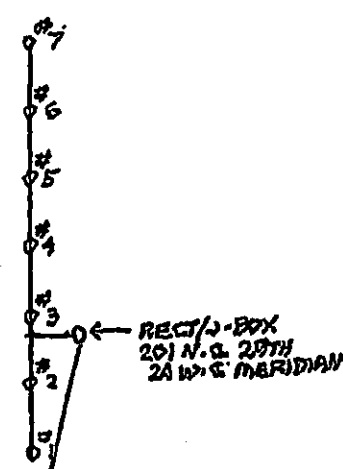

RECT/BOX
 291 N. & 29TH
 24 W. & MERIDIAN

SCALE

splice

29TH N. 22' E. OF E. 4' S. 21' S. &

PIPE CONDITION
 BARE: CORROSION: LIGHT: MODERATE:
 COATED: COATING: GOOD: POOR: DAMAGED:

COATING TYPE
 BELL: THIN FILM: PAINTED: MASTIC:

DRAIN POINT T/S BOX NEXT TO CURB & W. SIDE OF WHEEL CHAIR RAMP
 24' S. OF E. OF 29TH & 24' E. OF E. OF MERIDIAN

CATHODIC PROTECTION: RECTIFIER _____ PIPE TO SOIL POTENTIAL:
 NO. OF ANODES _____ CURRENT DRAIN _____ NEW MAIN: _____ OLD MAIN:
 ANODE SIZE _____ TYPE OF SOIL _____ VOLTS BEFORE _____ VOLTS
 ANODE DEPTH _____ MAIN DEPTH _____ AFTER _____ VOLTS

FOR _____ OFFICE _____ PERSONNEL _____ ONLY
 TO LAY _____ OF _____
 L.A. ID. _____
 TOWN _____ COUNTY _____ STATE _____
 DATE _____ W.O. _____

**DAILY LOG
RECTIFIER #905**

29TH N. & MERIDIAN

WO 051-056-3721-010008

NEW SITE-TO INSTALL GROUND BED AND RECTIFIER #905

HOLES DRILLED BY DARLING DRILLING OUT OF HUTCHINSON

11/13/01-MONDAY

HIT SHALE AT 45 FT. AND COULD ONLY LOAD 2 ANODES PER HOLE. REQUESTED MORE DRILLING PERMITS WITH THE KCC. DECIDED TO ONLY USE 14 ANODES.

DRILLED HOLE #4 (E) AT 231' N. OF C/L OF 29TH / 18' E. OF C/L OF MERIDIAN. LOGGED HOLE AND LOADED ANODES #7 AND #8---(#7 IS BOTTOM ANODE).

DRILLED HOLE #5 (A) AT 251' N. OF C/L OF 29TH /18' E. OF C/L OF MERIDIAN. LOGGED HOLE AND LOADED ANODES #9 AND #10---(#9 IS BOTTOM ANODE).

11/14/01-TUESDAY

DRILLED HOLE #1 (B) AT 171' N. OF C/L OF 29TH /18' E. OF C/L OF MERIDIAN. LOGGED HOLE AND LOADED ANODES #1 AND #2---(#1 IS BOTTOM ANODE).

DRILLED HOLE #2 (D) AT 191' N. OF C/L OF 29TH /18' E. OF C/L OF MERIDIAN. LOGGED HOLE AND LOADED ANODES #3 AND #4---(#3 IS BOTTOM ANODE).

DRILLED HOLE #3 (C) AT 211' N. OF C/L OF 29TH / 18 E. OF C/L OF MERIDIAN. LOGGED HOLE AND LOADED ANODES #5 AND #6---(#5 IS BOTTOM ANODE).

JEFF CLOCK WITH KCC WAS ON SITE.

11/15/01-WEDNESDAY

DRILLED HOLE #6 (F) AT 271' N. OF C/L OF 29TH/18 E. OF C/L OF MERIDIAN. LOGGED HOLE AND LOADED ANODES #11 AND #12---(#11 IS BOTTOM ANODE).

DRILLED HOLE #7 (G) AT 291' N. OF C/L OF 29TH/18 E. OF C/L OF MERIDIAN. LOGGED HOLE AND LOADED ANODES #13 AND #14---(#13 IS BOTTOM ANODE).

HUNG RECTIFIER AND JCT. BOX ON POLE

11/28/01-WENESDAY

KPL CREW RAN ANODE LEADS OVER TO JCT. BOX.

**ANODE LOG-RECTIFIER #905
29TH N. & MERIDIAN
WO 051-056-3721-010008**

11/14/01-(WED)-HOLE #1 (B)

ANODES-#1 & #2

171' N. OF C/L OF 29TH
18' E. OF C/L OF MERIDIAN
14.2 VLTS APPL.

DEPTH	AMPS
5FT	.7
10	1.3
15	1.7
20	1.6
25	1.6
30	1.7
35	1.6
40	1.7

BOTTOM OF HOLE 42 FT
BOTTOM OF 1ST ANODE 40 FT.-(#1)
TOP OF 1ST ANODE 33FT.
BOTTOM OF 2ND ANODE 31 FT.-(#2)
TOP OF 2ND ANODE 24 FT.

11/14/01-(WED)-HOLE #3 (C)

ANODES-#5 & #6

211' N. OF C/L OF 29TH
18' E. OF C/L OF MERIDIAN
14.4 VLTS APPL.

DEPTH	AMPS
5FT	.5
10	1.0
15	1.4
20	1.3
25	1.3
30	1.3
35	1.3
40	1.4
45	1.4

BOTTOM OF HOLE 45 FT.
BOTTOM OF 1ST ANODE 43 FT.-(#5)
TOP OF 1ST ANODE 36 FT.
BOTTOM OF 2ND ANODE 34 FT.-(#6)
TOP OF 2ND ANODE 27 FT.

11/14/01-(WED)-HOLE #2 (D)

ANODES #3 & #4

191' N. OF C/L OF 29TH
18' E. OF C/L OF MERIDIAN
14.4 VLTS APPL.

DEPTH	AMPS
5FT	.8
10	1.4
15	1.9
20	1.8
25	1.9
30	2.2
35	2.2
40	2.2

BOTTOM OF HOLE 42 FT
BOTTOM OF 1ST ANODE 40 FT.-(#3)
TOP OF 1ST ANODE 33 FT.
BOTTOM OF 2ND ANODE 31 FT.-(#4)
TOP OF 2ND ANODE 24 FT.

11/13/01-(TUE)-HOLE #4 (E)

ANODES-#7 & #8

231' N. OF C/L OF 29TH
18' E. OF C/L OF MERIDIAN
14.2 VLTS APPL.

DEPTH	AMPS
5FT	.5
10	1.2
15	1.5
20	1.5
25	1.4
30	1.5
35	1.5
40	1.5
45	1.5

BOTTOM OF HOLE 45 FT.
BOTTOM OF 1ST ANODE 43 FT.-(#7)
TOP OF 1ST ANODE 36 FT.
BOTTOM OF 2ND ANODE 34 FT.-(#8)
TOP OF 2ND ANODE 27 FT.

ANODE LOG-RECTIFIER #905
29TH N. & MERIDIAN
WO 051-056-3721-010008

11/13/01-(TUE)-HOLE #5 (A)

ANODES-#9 & #10

251' N. OF C/L OF 29TH

18' E. OF C/L OF MERIDIAN

14.2 VLTS APPL

DEPTH	AMPS
-------	------

5 FT	.7
------	----

10	1.9
----	-----

15	1.8
----	-----

20	1.3
----	-----

25	1.5
----	-----

30	1.7
----	-----

35	1.7
----	-----

40	2.0
----	-----

45	1.9
----	-----

BOTTOM OF HOLE 45 FT.

BOTTOM OF 1ST ANODE 43 FT.-(#9)

TOP OF 1ST ANODE 36 FT.

BOTTOM OF 2ND ANODE 34 FT.-(#10)

TOP OF 2ND ANODE 27 FT.

11/15/01-(THU)-HOLE #6 (F)

ANODES-#11 & #12

271' N. OF C/L OF 29TH

18' E. OF C/L OF MERIDIAN

14.4 VLTS APPL

DEPTH	AMPS
-------	------

5 FT	.5
------	----

10	1.0
----	-----

15	1.5
----	-----

20	1.6
----	-----

25	1.4
----	-----

30	1.3
----	-----

35	1.5
----	-----

40	1.5
----	-----

44	1.5
----	-----

BOTTOM OF HOLE 44 FT.

BOTTOM OF 1ST ANODE 42 FT.-(#11)

TOP OF 1ST ANODE 35 FT.

BOTTOM OF 2ND ANODE 33 FT.-(#12)

TOP OF 2ND ANODE 26 FT.

11/15/01-(THU)-HOLE #7 (G)

ANODES-#13 & #14

HOLE #7 (G)

291' N. OF C/L OF 29TH

18' E. OF C/L OF MERIDIAN

14.4 VLTS APPL

DEPTH	AMPS
-------	------

5 FT.	.5
-------	----

10	1.2
----	-----

15	1.5
----	-----

20	1.5
----	-----

25	1.3
----	-----

30	1.3
----	-----

35	1.2
----	-----

40	1.2
----	-----

BOTTOM OF HOLE 42 FT.

BOTTOM OF 1ST ANODE 40 FT.-(#13)

TOP OF 1ST ANODE 33 FT.

BOTTOM OF 2ND ANODE 31 FT.-(#14)

TOP OF 2ND ANODE 24 FT.

