

KANSAS CORPORATION COMMISSION
OIL & GAS CONSERVATION DIVISION

Form ACO-4
Form must be typed
September 2005

APPLICATION FOR COMMINGLING OF
PRODUCTION (K.A.R. 82-3-123) OR FLUIDS (K.A.R. 82-3-123a)

Commingling ID # CO 080606

Operator Information:

License #: 3553
Name: Citation Oil & Gas Corp.
Address: P O Box 690688
City/State/Zip: Houston, Texas 77269
Contact Person: Sharon Ward
Phone #: 281-517-7309

Well Information:

API #: 15 - 051-25282 - 0000
Lease Name: Wasinger Well #: 20
Spot: NE - SW - SE Sec. 21 Twp. 11 S. R. 18 East West
County: Ellis
Feet from North / South Line of Section: 990'
Feet from East / West Line of Section: 1650'

1. Name and upper and lower limit of each production interval to be commingled:

Formation: Arbuckle Lime (Perfs): 3607-3620 OH
Formation: LKC (Perfs): 3467-3532
Formation: _____ (Perfs): _____
Formation: _____ (Perfs): _____
Formation: _____ (Perfs): _____

2. Estimated amount of fluid production to be commingled from each interval:

Formation: Arbuckle Lime BOPD: 4 MCFPD: 0 BWPD: 200
Formation: LKC BOPD: 2 MCFPD: 0 BWPD: 94
Formation: _____ BOPD: _____ MCFPD: _____ BWPD: _____
Formation: _____ BOPD: _____ MCFPD: _____ BWPD: _____
Formation: _____ BOPD: _____ MCFPD: _____ BWPD: _____

3. Plat map showing the location of the subject well, all other wells on the subject lease, and all wells on offsetting leases within a 1/2 mile radius of the subject well, and for each well the names and addresses of the lessee of record or operator.

4. Signed certificate showing service of the application as required in K.A.R. 82-3-135a(b).

For Commingling of PRODUCTION ONLY, include the following:

- 5. Wireline log of subject well.
- 6. Complete Form ACO-1 (Well Completion form) for the subject well.

For Commingling of FLUIDS ONLY, include the following:

- 5. Well construction diagram of subject well.
- 6. Any available water chemistry data demonstrating the compatibility of the fluids to be commingled.

State of Texas)
)
County of Harris)

ss:

VERIFICATION: I hereby certify that to the best of my current information, knowledge and personal belief, this request for commingling is true and proper and I have no information or knowledge, which is inconsistent with the information supplied in this application.

Signature: Sharon Ward
Printed Name: Sharon Ward
Title: Permitting Manager
Subscribed & sworn to before me this 24 day of August, 20 06
Notary Public: Nathanial Algawad
My Commission Expires: _____

RECEIVED
AUG 28 2006
KCC WICHITA

KCC Office Use Only
 Denied Approved
KCC Date Received: 8/28/06 15-Day Periods Ends: 9/10/06
Approved By: [Signature] Date: 11:300

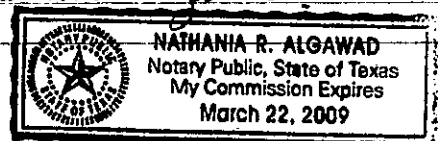

11S 18W

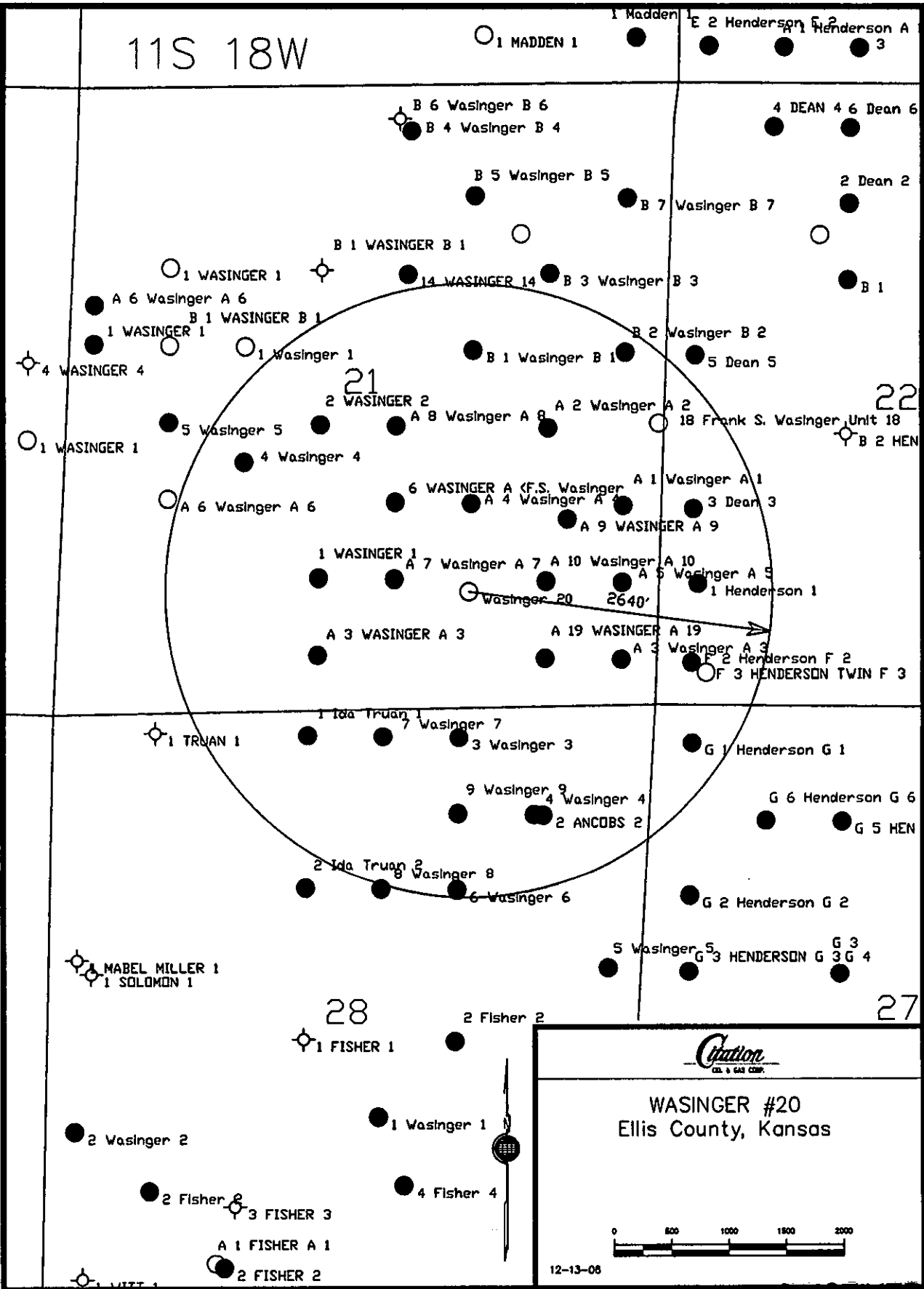

Caution
OIL & GAS CORP.

WASINGER #20
Ellis County, Kansas

0 500 1000 1500 2000

12-13-06

RECEIVED
AUG 28 2006
100 WICHITA

Commingling Affidavit Certificate of Service

Citation Oil & Gas Corp. 03553

Wasinger 20 15-051-25282

Pg 2

21-11S-18W

Stephen F Wasinger
Thomas M Wasinger
Russell T Rudy Energy, LLC
Susan Hughes
Mary Jo Egloff
Karen Betthausen
Paul & Lou Anne Betthausen
Jeanne Betthausen
Gregory M Betthausen
Roger L Comeau

350 McMilian Rd
1602 Elm
5701 Woodway Dr. Ste 222
2843 E Peakview Ave
P O Box 394
3425 S Harrison St.
8054 S Adams Way
2733 S. Harrison St.
735 2nd Ave E
308 W Mill

Gross Pointe Farms, MI 48236
Hays, KS 67601
Houston, TX 77057
Centennial, CO 80121
Hartsel, CO 80449
Denver, CO 80210
Centennial, CO 80122
Denver, CO 80210
Kalispell, MT 59901
Plainville, KS 67663

22-11S-18W

Upland Resources, Inc.
Production Drilling Inc.
S J Peavey
Newray Limited Partners
Newell R Hays Enterprises, Inc.

427 South Boston, Suite 800
P O Box 680
207 SW 9th Street

P O Box 161

Tulsa, OK 74103
Hays, KS 67601
Plainville, KS 67663

Alamogordo, NM 88311

27-11S-18W

S J Peavey
MK Royalty Company
Murfin Drilling Company

207 SW 9th Street
8451 East Oregon Pl
250 N. Water, S #300

Plainville, KS 67663
Denver, CO 80231
Wichita, KS 67202

28-11S-18W

Donald W Johnson
Daniel H Johnson

121 Oak Pointe Circle
P O Box 247

State College, PA 16801
Hays, KS 67601

Signature: Sharon Ward

Date: August 24, 2006

Title: Permitting Manager

Subscribed and sworn to before me this 24th day of August, 2006

Notary Public: Nathania Algawad

Date Commission Expires: _____

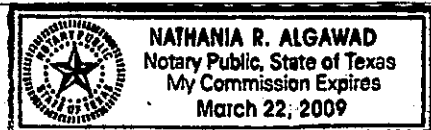

RECEIVED
AUG 28 2006
KCC WICHITA

2 Township 11 South, Range 18 West, 6th P.M.
Section 21: SENW

Mineral Ownership:

G. E. Simpson
PO Box 460991
Garland, TX 75046-0991

Houston L. Whiteside, Trust
FBO Morton Houston
1st National Bank of Huthinson
PO Box 913
Hutchinson, KS 67504

E.J. Dreiling
1111 Country Club Dr
Hays, KS 67601-1809

Mana Gas, Inc.
2520 Tramway Terrace Ct. N.
Albuquerque, NM 87122

Norma Lee Wasinger (Allen)
Waldo L. Allen
200 W. Sterne PKWY Apt. 716
Littleton, CO 80120

Twila Fae Wasinger (Sweeney)
Thomas J. Sweeney
7658 S. Cedar CIR
Littleton, CO 80120

Patricia Ann McPherson
11424 Skyland Rd.
Sunland, CA 91040

Rita & Simon Roth Jr.
PO Box 743
Hays, KS 67601

Marilyn C. Smith (Wasinger)
2412 Pershing Dr.
Hays, KS 67601

Frank Kirk Wasinger
211 Ash St. Apt. B
Hays, KS 67601

Guyanna Weilert
2243 Bramblewood #1103
Wichita, KS 67226

RECEIVED
AUG 28 2006
KCC WICHITA

2 Township 11 South, Range 18 West, 6th P.M.

Section 21: SENW

Mineral Ownership:

Marcia Power
22 Londonberry DR
Holmdel, NJ 07733

Linda Ann Riedel
202 E. 14th
Ellis, KS 67637

Stephen F. Wasinger
350 McMilian Rd.
Gross Pointe Farms, MI 48236

Thomas M. Wasinger
1602 Elm
Hays, KS 67601

Russell T. Rudy Energy, LLC
5701 Woodway Dr., Ste. 222
Houston, TX 77057

Susan Hughes
2843 E. Peakview Ave.
Centennial, CO 80121

Mary Jo Egloff
PO Box 394
Hartsel, CO 80449

Karen Betthauser
3425 S. Harrison St.
Denver, CO 80210

Paul Betthauser
8054 S Adams Way
Centennial, CO 80122

Lou Anne Betthauser
8054 S Adams Way
Centennial, CO 80122

Jeanne Betthauser
2733 S. Harrison St.
Denver, Co 80210

Gregory M. Betthauser
735 2nd Ave. E
Kalispell, MT 59901

RECEIVED
AUG 28 2006
KCC WICHITA

2 Township 11 South, Range 18 West, 6th P.M.

Section 21: SENW

Mineral Ownership: Roger L. Comeau
308 W. Mill
Plainville, KS 67663

Leasehold WI Ownership: None - Unleased

Offset Well Names/Operators:

API Well Name/Status

There are no producing wells within 1/2 mile of the Wasinger #20 in this tract

3 Township 11 South, Range 18 West, 6th P.M.

Section 21: SW

Operator Great Eastern Energy & Dev.
550 West Texas, Suite 660
Midland, TX 79701

Offset Well Names/Operators:

<u>API</u>	<u>Well Name/Status</u>	<u>Operator Name/Address</u>
15-051-04863	Wasinger 2/Producing	Great Eastern Energy & Dev. 550 West Texas, Suite 660 Midland, TX 79701
15-051-05311	Wasinger 4/Producing	Same as above
15-051-04947	Wasinger A3/Producing	Same as above
15-051-04862	Wasinger 1/TA	Same as above

4 Township 11 South, Range 18 West, 6th P.M.

Section 22: SWNW, NWSW

Mineral Ownership: Upland Resources, Inc.
427 South Boston, Suite 800
Tulsa, OK 74103

Leasehold WI Ownership: Larry Patterson, President of
Production Drilling Inc.
P.O. Box 680
Hays, KS 67601

Offset Well Names/Operators:

API Well Name/Status Operator Name/Address

There are no producing wells within 1/2 mile of the Wasinger #20 in this tract

RECEIVED
AUG 28 2006
KCC WICHITA

5 Township 11 South, Range 18 West, 6th P.M.

Section 22: SWSW

Mineral Ownership: S. J. Peavey
207 SW 9th Street
Plainville, KS 67663

Newray Limited Partners and
Newell R. Hays Enterprises,
Inc.
P.O. Box 161
Alamogordo, NM 88311

Leasehold WI Ownership: None - Unleased

Offset Well Names/Operators:

<u>API</u>	<u>Well Name/Status</u>	<u>Operator Name/Address</u>
There are no producing wells within 1/2 mile of the Wasinger #20 in this tract		

6 Township 11 South, Range 18 West, 6th P.M.

Section 27: NWNW

Mineral Ownership: S. J. Peavey
207 SW 9th Street
Plainville, KS 67663

MK Royalty Company
c/o Gary Kleiman
8451 East Oregon Pl.
Denver, CO 80231

Leasehold WI Ownership: **Murfin Drilling Company**
250 N. Water S; # 300
Wichita, KS 67202

Offset Well Names/Operators:

<u>API</u>	<u>Well Name/Status</u>	<u>Operator Name/Address</u>
There are no producing wells within 1/2 mile of the Wasinger #20 in this tract		

7 Township 11 South, Range 18 West, 6th P.M.

Section 28: NE

Operator **Great Eastern Energy & Dev.**
550 West Texas, Suite 660
Midland, TX 79701

7 Township 11 South, Range 18 West, 6th P.M.

Section 28: NE

Offset Well Names/Operators:

<u>API</u>	<u>Well Name/Status</u>	<u>Operator Name/Address</u>
15-051-05224	Wasinger 4/Producing	Great Eastern Energy & Dev. 550 West Texas, Suite 660 Midland, TX 79701
15-051-19023	Wasinger 3/TA	Same as above
15-051-05227	Wasinger 7/TA	Same as above
15-051-05510	Wasinger 9/TA	Same as above

8 Township 11 South, Range 18 West, 6th P.M.

Section 28: NW

Mineral Ownership:

Donald W. Johnson
121 Oak Pointe Circle
State College, PA 16801

Daniel H. Johnson
P.O. Box 247
Hays, KS 67601

Leasehold WI Ownership:

None - Unleased

Offset Well Names/Operators:

<u>API</u>	<u>Well Name/Status</u>	<u>Operator Name/Address</u>
There are no producing wells within 1/2 mile of the Wasinger #20 in this tract		

Wasinger Unit Outline

11S 18W

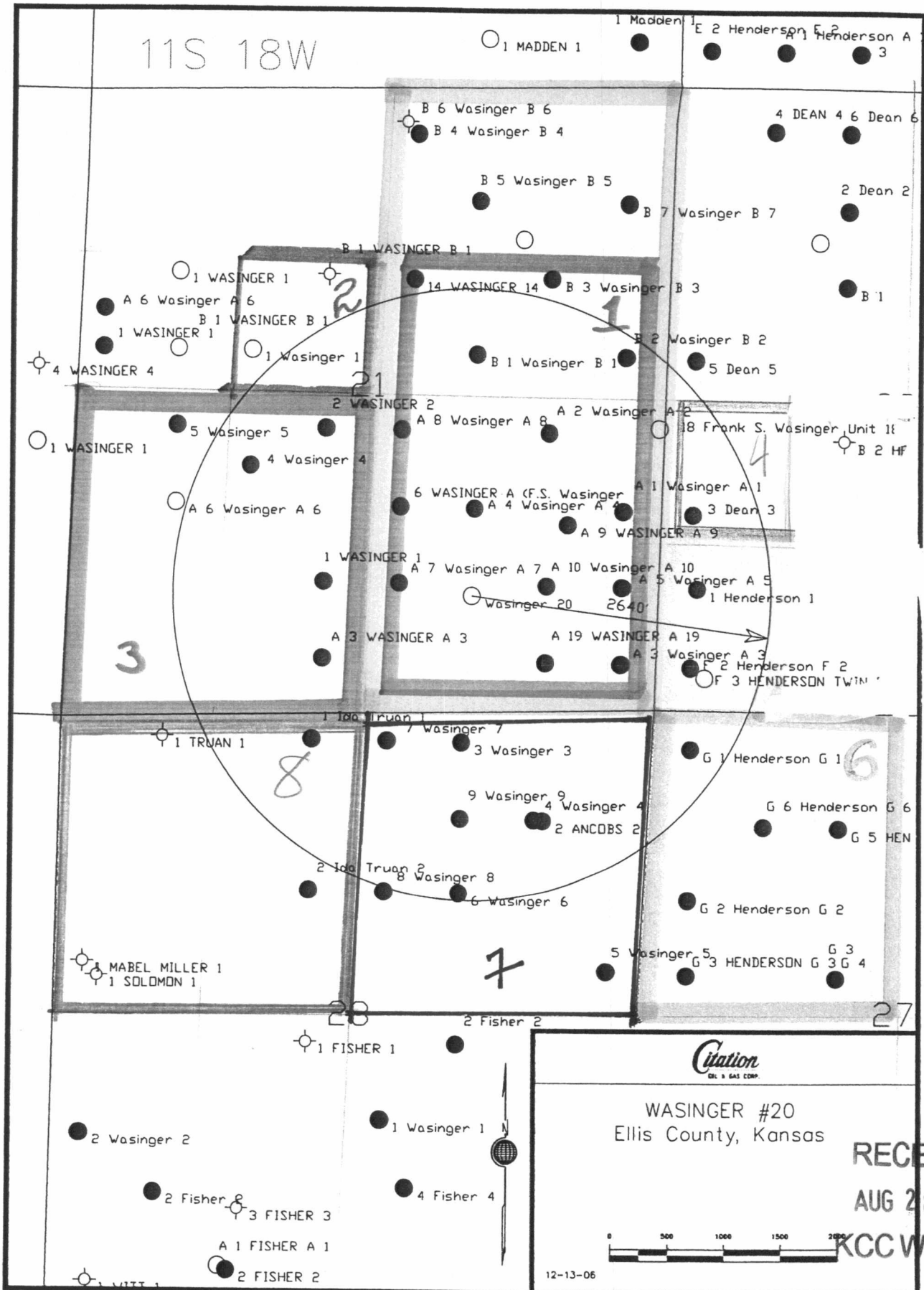

WASINGER #20
Ellis County, Kansas

RECEIVED
AUG 28 2006
KCC WICHITA

12-13-06



Water Analysis Report

8/2/2006

Address: PO Box 1542
Hays, KS 67601

Customer: Citation Oil & Gas Corp.
Attention: Neil Pfarmenstiel

Lease: Wasinger
Formation:
Salesman: Darian Dinkel

CC: Gary Glenn Jim Reisch

Target Name: Wasinger 20

Sample Point: Wasinger 20

Sample Date: 08/01/2006

Test Date: 08/02/2006

Water Analysis(mg/L)

Calcium	3400
Magnesium	535
Barium	
Strontium	
Sodium(calc.)	17086
Bicarbonate Alkalinity	478
Sulfate	2068
Chloride	32118
Resistivity	0.1148

Appended Data(mg/L)

CO2	264
H2S	75
Iron	1
Oxygen	

Physical Properties

Ionic Strength(calc.)	1.09
pH(calc.)	
Temperature(°F)	100
Pressure(psi)	25
Density	8.65

Additional Data

Specific Gravity	1.04
Total Dissolved Solids(Mg/L)	55685
Total Hardness(CaCO3 Eq Mg/)	10693

Dew Point	
Lead	
Zinc	

Calcite Calculation Information

Calculation Method
Known pH

Value
6.70

SI & PTB Results

Scale Type	SI	PTB
Calcite (Calcium Carbonate)	0.14	38.60
Gypsum (Calcium Sulfate)	-0.15	
Hemihydrate (Calcium Sulfate)	-0.14	
Anhydrite (Calcium Sulfate)	-0.27	
Barite (Barium Sulfate)		
Celestite (Strontium Sulfate)		

Remarks:

Saturation indices

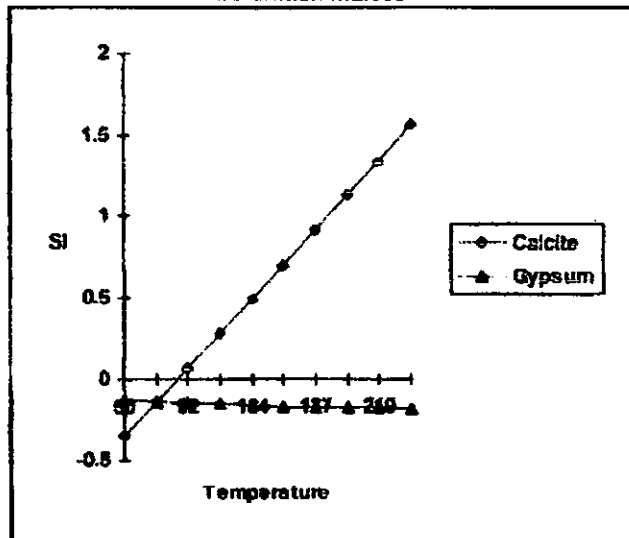

Saturation Index Data Points

	50	71	92	113	134	156	177	198	219	240
Calcite	-0.35	-0.14	0.07	0.28	0.49	0.70	0.91	1.13	1.34	1.56
Gypsum	-0.13	-0.14	-0.15	-0.15	-0.16	-0.17	-0.17	-0.17	-0.17	-0.18

RECEIVED
AUG 28 2006
KCC WICHITA

AFFIDAVIT OF PUBLICATION

State of Kansas, Ellis County, ss:

Mary Karst

being first duly sworn, deposes and says:

That he/she is Advertising Manager of **THE HAYS DAILY NEWS**, a daily newspaper printed in the State of Kansas, and published in and of general circulation in Ellis County, Kansas, with a general paid circulation on a yearly basis in Ellis County, Kansas, and that said newspaper is not a trade, religious or fraternal publication.

Said newspaper is published daily, except Saturday, is published at least weekly 50 times a year; has been so published continuously and uninterrupted in said county and state for a period of more than five years prior to the first publication of said notice; and has been admitted at the post office of Hays in said county as second class matter.

That the attached notice is a true copy thereof and was published in the regular and entire issue of said newspaper for 1 consecutive day, the first publication thereof being made as aforesaid on the 30th day of August, 2006, with subsequent publications being made on the following dates:

_____	20	_____	20
_____	20	_____	20
_____	20	_____	20

Mary Karst

Subscribed and sworn to before me this 30th day of August, 2006.

[Signature]
Notary Public

My Appointment expires 5-28-09
 Printer's Fee..... \$42.00
 Additional copies..... \$
 Total Fee..... \$42.00

(Published in The Hays Daily News August 30, 2006)

**BEFORE THE STATE CORPORATION COMMISSION OF THE STATE OF KANSAS
NOTICE OF FILING APPLICATION**

RE: Citation Oil & Gas Corp. Application for a permit to authorize the downhole commingling of the LKC and Arbuckle zones in the Wasinger Unit 20 well located in Ellis County, Kansas.

TO: All Oil and Gas Producers, Unleased Mineral Interest Owners, Landowners, and all persons whomsoever concerned.

You, and each of you, are hereby notified that Citation Oil & Gas Corp. has filed an application to commence the downhole commingling of the LKC and Arbuckle formations in the Wasinger Unit 20, located in the SE/4, Section 21, Township 11 South, Range 18 West, Ellis County, Kansas.

Any persons who object to or protest this application shall be required to file their objections or protests with the Conservation Division of the State Corporation Commission of the State of Kansas within fifteen (15) days from the date of this publication. These protests shall be filed pursuant to Commission regulations and must state specific reasons why the grant of the application may cause waste, violate correlative rights or pollute the natural resources of the state of Kansas.

All persons interested or concerned shall take notice of the foregoing and shall govern themselves accordingly.
Citation Oil & Gas Corp.
8223 Willow Place South
Houston, Texas 77070
Phone: 281-517-7309

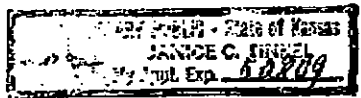

RECEIVED
KANSAS CORPORATION COMMISSION
SEP 28 2006
CONSERVATION DIVISION
WICHITA, KS

AFFIDAVIT

STATE OF KANSAS \
- SS.
County of Sedgwick /

RECEIVED
KANSAS CORPORATION COMMISSION
SEP 28 2006
CONSERVATION DIVISION
WICHITA, KS

Milt Mounts, of lawful age, being first duty sworn, deposeth and saith: That he is Record Clerk of The Wichita Eagle, a daily newspaper published in the City of Wichita, County of Sedgwick, State of Kansas, and having a general paid circulation on a daily basis in said County, which said newspaper has been continuously and uninterruptedly published in said County for more than one year prior to the first publication of the notice hereinafter mentioned, and which said newspaper has been entered as second class mail matter at the United States Post Office in Wichita, Kansas, and which said newspaper is not a trade, religious or fraternal publication and that a notice of a true copy is hereto attached was published in the regular and entire Morning issue of said The Wichita Eagle for 1 consecutive issue - weeks, that the first publication of said notice was

made as aforesaid on the 1st day of

September A.D. 2006, with

subsequent publications being made on the following dates:

LEGAL PUBLICATION
Citation Oil & Gas Corp. Application for a permit to authorize the downhole completion of the LKC and A-1000 zones in the Wasinger Unit 20 well located in Ellis County, Kansas...
TO: All Oil and Gas Producers, Unleased Minor Interest Owners, Landowners, and all persons whomsoever concerned.
You and each of you, are hereby notified that Citation Oil & Gas Corp. has filed an application to commence the downhole completion of the LKC and A-1000 zones in the Wasinger Unit 20 well located in Section 21, Township 14 South, Range 11 West, Ellis County, Kansas.
Any persons who object to or object this application shall be required to file their objections or protests with the Conservation Division of the State Corporation Commission of the State of Kansas within fifteen (15) days from the date of this publication. These protests shall be filed pursuant to Commission regulations and must state specific reasons why the grant of the application may cause waste, violate comparative rights or deplete the natural resources of the State of Kansas.
All persons interested in the application shall have notice of the application and shall govern themselves accordingly.
Citation Oil & Gas Corp.
8200 W. 11th Street, Suite 200
Houma, LA 70309
Phone: 504-833-2000

And affiant further says that _____ he has personal knowledge of the statements above set forth and that they are true.

Subscribed and sworn to before me this

1st day of September, 2006

Notary Public Sedgwick County, Kansas



Printer's Fee \$74.00

AFFIDAVIT OF PUBLICATION

State of Kansas, Ellis County, ss:

Mary Karst

being first duly sworn, deposes and says:

That he/she is Advertising Manager

of THE HAYS DAILY NEWS, a daily newspaper printed in the State of Kansas, and published in and of general circulation in Ellis County, Kansas, with a general paid circulation on a yearly basis in Ellis County, Kansas, and that said newspaper is not a trade, religious or fraternal publication.

Said newspaper is published daily, except Saturday, is published at least weekly 50 times a year; has been so published continuously and uninterrupted in said county and state for a period of more than five years prior to the first publication of said notice; and has been admitted at the post office of Hays in said county as second class matter.

That the attached notice is a true copy thereof and was published in the regular and entire issue of said newspaper for 1 consecutive day, the first publication thereof being made as aforesaid on the 30th day of August, 2006, with subsequent publications being made on the following dates:

_____, 20____, _____, 20____
_____, 20____, _____, 20____
_____, 20____, _____, 20____

Mary Karst

Subscribed and sworn to before me this 30th day of August, 2006.

[Signature]
Notary Public

My Appointment expires 5-28-09

Printer's Fee..... \$42.00

Additional copies..... \$ _____

Total Fee..... \$42.00

(Published in The Hays Daily News August 30, 2006)

BEFORE THE STATE CORPORATION COMMISSION OF THE STATE OF KANSAS
NOTICE OF FILING APPLICATION

RE: Citation Oil & Gas Corp.- Application for a permit to authorize the downhole commingling of the LKC and Arbuckle zones in the Wasinger Unit 20 well located in Ellis County, Kansas.

TO: All Oil and Gas Producers, Unleased Mineral Interest Owners, Landowners, and all persons whomsoever concerned.

You, and each of you, are hereby notified that Citation Oil & Gas Corp. has filed an application to commence the downhole commingling of the LKC and Arbuckle formations in the Wasinger Unit 20, located in the SE/4, Section 21, Township 11 South, Range 18 West, Ellis County, Kansas.

Any persons who object to or protest this application shall be required to file their objections or protests with the Conservation Division of the State Corporation Commission of the State of Kansas within fifteen (15) days from the date of this publication. These protests shall be filed pursuant to Commission regulations and must state specific reasons why the grant of the application may cause waste, violate correlative rights or pollute the natural resources of the state of Kansas.

All persons interested or concerned shall take notice of the foregoing and shall govern themselves accordingly.
Citation Oil & Gas Corp.
8223 Willow Place South
Houston, Texas 77070
Phone: 281-517-7309

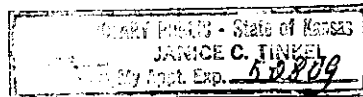

AFFIDAVIT

STATE OF KANSAS \
- SS.
County of Sedgwick /

Milt Mounts, of lawful age, being first duly sworn, deposeth and saith: That he is Record Clerk of The Wichita Eagle, a daily newspaper published in the City of Wichita, County of Sedgwick, State of Kansas, and having a general paid circulation on a daily basis in said County, which said newspaper has been continuously and uninterruptedly published in said County for more than one year prior to the first publication of the notice hereinafter mentioned, and which said newspaper has been entered as second class mail matter at the United States Post Office in Wichita, Kansas, and which said newspaper is not a trade, religious or fraternal publication and that a notice of a true copy is hereto attached was published in the regular and entire Morning issue of said The Wichita Eagle for 1 consecutive issue - ~~weeks~~ , that the first publication of said notice was

made as aforesaid on the 1st day of

September A.D. 2006 , with

subsequent publications being made on the following dates:

And affiant further says that _____ he has personal knowledge of the statements above set forth and that they are true.

Milt Mounts

Subscribed and sworn to before me this

1st day of September, 2006

Danna M. Ingram

Notary Public Sedgwick County, Kansas

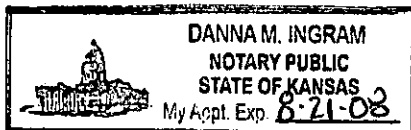

LEGAL PUBLICATION

Published in the Wichita Eagle on September 1, 2006 (2549951)

BEFORE THE STATE CORPORATION COMMISSION OF THE STATE OF KANSAS NOTICE OF FILING APPLICATION

RE: Citation Oil & Gas Corp. -- Application for a permit to authorize the downhole commingling of the LKC and Arbuckle zones in the Wasinger Unit 20 well located in Ellis County, Kansas.

TO: All Oil and Gas Producers, Unleased Mineral Interest Owners, Landowners, and all persons whomever concerned.

You, and each of you, are hereby notified that Citation Oil & Gas Corp. has filed an application to commence the downhole commingling of the LKC and Arbuckle formations in the Wasinger Unit 20, located in the SE/4, Section 21, Township 11 South, Range 18 West, Ellis County, Kansas.

Any persons who object to or protest this application shall be required to file their objections or protests with the Conservation Division of the State Corporation Commission of the State of Kansas within fifteen (15) days from the date of this publication. These protests shall be filed pursuant to Commission regulations and must state specific reasons why the grant of the application may cause waste, violate correlative rights or pollute the natural resources of the state of Kansas.

All persons interested or concerned shall take notice of the foregoing and shall govern themselves accordingly.

Citation Oil & Gas Corp. 8223 Willow Place South Houston, Texas 77070 Phone: 281-517-7309

Printer's Fee \$74.00

KANSAS

CORPORATION COMMISSION

KATHLEEN SEBELIUS, GOVERNOR
BRIAN J. MOLINE, CHAIR
ROBERT E. KREHBIEL, COMMISSIONER
MICHAEL C. MOFFET, COMMISSIONER

November 3, 2006

Sharon Ward
Citation Oil & Gas Corp.
P O Box 690688
Houston, TX 77269

RE: Approved Commingling CO080606
Wasinger #20, Sec. 21-T11S-R18W, Ellis County, Kansas
API No. 15-051-25282-0000

Dear Ms. Ward:

Your "Application for Commingling" (ACO-4) for the above described well has been technically reviewed and approved by the Kansas Corporation Commission (KCC) per **K.A.R. 82-3-123a**. Notice was examined and found to be proper per **K.A.R. 82-3-135a**. No protest had been filed within the 15-day protest period. This application, which was received by the KCC on **August 28, 2006** concerns approval to simultaneously produce from the following **two** sources of supply through the same tubing string in the same wellbore: the **Arbuckle Lime and the LKC** formations.

According to your application, the estimated current production from the **Arbuckle Lime** source of supply is **4 BOPD, 0 Mcfpd and 200 BOPD**. The estimated current production from the **LKC** source of supply is **2 BOPD, 0 Mcfpd and 94 BOPD**. The total estimated current production from all sources of supply in the subject well is **6 BOPD, 0 Mcfpd and 294 BOPD**.

Based upon the depth of the **Arbuckle Lime** formation open hole interval, total oil production shall not exceed **100 BOPD** and total gas production shall not exceed **50%** of the absolute open flow (AOF).

Docket Number **CO080606** has been assigned to this approved application. Please use this number for well completion reports (ACO-1) and other correspondence that may concern this approved commingling.

Sincerely,



Rick Hestermann
Professional Geologist