

KANSAS CORPORATION COMMISSION  
OIL & GAS CONSERVATION DIVISION

Form ACO-4  
Form must be typed  
September 2005

APPLICATION FOR COMMINGLING OF  
PRODUCTION (K.A.R. 82-3-123) OR FLUIDS (K.A.R. 82-3-123a)

Commingling ID # CO080607

Operator Information:

License #: 5003  
Name: McCOY PETROLEUM CORPORATION  
Address: 8080 E. CENTRAL, SUITE 300  
City/State/Zip: Wichita, KS 67206  
Contact Person: Scott Hampel  
Phone #: (316) 636-2737

Well Information:

API #: 15 - 135-24,507-00-00  
Lease Name: SCHLEGEL A Well #: 1-5  
Spot: NE - NE - NE Sec. 5 Twp. 20 S. R. 24  East  
County: NESS  West  
Feet from  North /  South Line of Section: 330'  
Feet from  East /  West Line of Section: 330'

1. Name and upper and lower limit of each production interval to be commingled:

Formation: MISSISSIPPIAN (Perfs): 4392 - 4402'  
Formation: LOWER FT. SCOTT (Perfs): 4306 - 4311'  
Formation: UPPER FT. SCOTT (Perfs): 4289 - 4294'  
Formation: \_\_\_\_\_ (Perfs): \_\_\_\_\_  
Formation: \_\_\_\_\_ (Perfs): \_\_\_\_\_

2. Estimated amount of fluid production to be commingled from each interval:

Formation: MISSISSIPPIAN BOPD: 20 MCFPD: 0 BWPD: 15  
Formation: LOWER FT. SCOTT BOPD: 52 MCFPD: 0 BWPD: 20  
Formation: UPPER FT. SCOTT BOPD: 55 MCFPD: 0 BWPD: 20  
Formation: \_\_\_\_\_ BOPD: \_\_\_\_\_ MCFPD: \_\_\_\_\_ BWPD: \_\_\_\_\_  
Formation: \_\_\_\_\_ BOPD: \_\_\_\_\_ MCFPD: \_\_\_\_\_ BWPD: \_\_\_\_\_

3. Plat map showing the location of the subject well, all other wells on the subject lease, and all wells on offsetting leases within a 1/2 mile radius of the subject well, and for each well the names and addresses of the lessee of record or operator.

4. Signed certificate showing service of the application as required in K.A.R. 82-3-135a(b).

For Commingling of PRODUCTION ONLY, include the following:

- 5. Wireline log of subject well.
- 6. Complete Form ACO-1 (Well Completion form) for the subject well.

For Commingling of FLUIDS ONLY, include the following:

- \_\_\_\_\_ 5. Well construction diagram of subject well.
- \_\_\_\_\_ 6. Any available water chemistry data demonstrating the compatibility of the fluids to be commingled.

State of KANSAS )  
County of SEDGWICK ) ss:

VERIFICATION: I hereby certify that to the best of my current information, knowledge and personal belief, this request for commingling is true and proper and I have no information or knowledge, which is inconsistent with the information supplied in this application.

Signature: Scott Hampel  
Printed Name: SCOTT HAMPEL  
Title: VICE PRESIDENT - PRODUCTION  
Subscribed & sworn to before me this 25th day of AUGUST, 20 06  
Notary Public: Meryl L. King  
My Commission Expires: 2-07-2010

RECEIVED  
AUG 31 2006  
KCC WICHITA

**KCC Office Use Only**  
 Denied  Approved  
KCC Date Received: \_\_\_\_\_ 15-Day Periods Ends: 12-31-06  
Approved By: [Signature] Date: \_\_\_\_\_

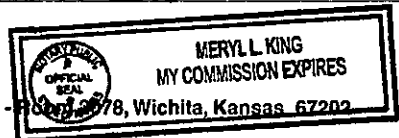

**Affidavit of Notice Served**

Re: Application for: Commingling of Production

Well Name: SCHLEGEL A # 1-5

Legal Location: NE NE NE SECTION 5-20S-24W

The undersigned hereby certifies that her/she is a duly authorized agent for the applicant, and that on the day 23TH of AUGUST, 2006, a true and correct copy of the application referenced above was delivered or mailed to the following parties:

Note: A copy of this affidavit must be served as a part of the application.

Name	Address (Attach additional sheets if necessary)
<b>PINTAIL PETROLEUM</b>	225 N. Market Wichita, KS 67202
<b>PALOMINO PETROLEUM, INC.</b>	4924 SE 84th St. Newton, KS 67114-8827
<b>DENISE &amp; JOHN CHUBB</b> %Carol Bales, O A.I.F.	Rt. E 1 Box 24A Bison, KS 67520
<b>CINDY &amp; ROBERT LADD</b>	Rt. E 1 Box 24A Bison, KS 67520
<b>EDWARD &amp; RUTH FILBERT</b>	1519 Willow Rd. Hutchinson, KS 67502

Signed this 23TH day of AUGUST, 2006

  
Applicant of Duly Authorized Agent

Subscribed and sworn to before me on this 23rd day of AUGUST, 2006

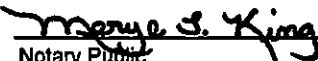
  
Notary Public

My Commission Expires: 2/7/2010



Mail to: KCC - Conservation Division, 130 S. Market - Room 2078, Wichita, Kansas 67202

**RECEIVED**  
**AUG 31 2006**  
**KCC WICHITA**

**OFFSET OPERATORS/MINERAL OWNERS  
SCHLEGEL A # 1-5  
SECTION 5-20S-24W  
NESS COUNTY, KANSAS**

**OPERATORS OF RECORD:**

Sec. 32-19S-24W    E/2 HBP  
Sec. 33-19S-24W    SW/4 HBP

**Pintail**  
225 N. Market  
Wichita, KS 67202

Sec. 5-20S-24W            HBP  
NE NE NE

**McCoy Petroleum Corp**  
8080 E. Central, Suite 300  
Wichita, KS 67206

Sec. 4-20S-24W    W/2

**Palomino Petroleum, Inc.**  
4924 SE 84<sup>th</sup> St.  
Newton, KS 67114-8827

**UNLEASED MINERAL OWNERS:**

Sec. 5-20S-24W    NW/4

**Denise T Chubb & John**  
**%Carol Bales-A.I.F.**  
**Rt. # 1 Box 24A**  
**Bison, KS 67520**

**Cindy Ladd & Robert E.**  
**%Carol Bales-A.I.F.**  
**Rt. # 1 Box 24A**  
**Bison, KS 67520**

Sec. 4-20S-24W    NW/4

**Edward & Ruth Filbert**  
**1519 Willow Rd.**  
**Hutchinson, KS 67502**

**RECEIVED**  
**AUG 31 2006**  
**<CC WICHITA**

**AFFIDAVIT**

STATE OF KANSAS \  
- SS.  
County of Sedgwick /

Milt Mounts, of lawful age, being first duly sworn, depose and saith: That he is Record Clerk of The Wichita Eagle, a daily newspaper published in the City of Wichita, County of Sedgwick, State of Kansas, and having a general paid circulation on a daily basis in said County, which said newspaper has been continuously and uninterruptedly published in said County for more than one year prior to the first publication of the notice hereinafter mentioned, and which said newspaper has been entered as second class mail matter at the United States Post Office in Wichita, Kansas, and which said newspaper is not a trade, religious or fraternal publication and that a notice of a true copy is hereto attached was published in the regular and entire Morning issue of said The Wichita Eagle for

1 consecutive issues - weeks,  
that the first publication of said notice was made as aforesaid on the 16<sup>th</sup> day, of December A.D. 2006, with subsequent publications being made on the following dates:

And affiant further says that \_\_\_\_\_ he has personal knowledge of the statements above set forth and that they are true.



Subscribed and sworn to before me this

20<sup>th</sup> day of December, 2006

  
Notary Public Sedgwick County, Kansas

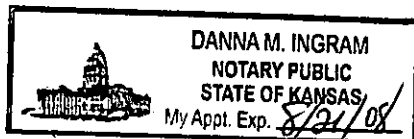

**BEFORE THE STATE CORPORATION COMMISSION OF THE STATE OF KANSAS NOTICE OF FILING APPLICATION**

**RE: McCoy Petroleum Corporation, Operator #5003 - Application for Commingling of zones in the Schlegel 'A' #1-5, located in Ness County, Kansas.**

**TO: All Oil & Gas Producers, Unleased Mineral Interest Owners, Landowners, and all persons whomsoever concerned.**

You, and each of you, are hereby notified that McCoy Petroleum Corporation has filed application to commence the commingling of the Ft Scott and Mississippian formations in the Schlegel 'A' #1-5 located 330' from the North line, and 330' from the East line, in Section 5-20S-24W, Ness County, Kansas.

Any persons who object to or protest this application shall be required to file their objections or protest with the Conservation Division of the State Corporation Commission of the State of Kansas within fifteen (15) days from the date of this publication. These protests shall be filed pursuant to Commission regulations and must state specific reasons why the grant to the application may violate correlative rights or pollute the natural resources of the State of Kansas.

All persons interested or concerned shall take notice of the foregoing and shall govern themselves accordingly.

McCoy Petroleum Corporation  
8080 E Central, Ste 300  
Wichita, KS 67207

**RECEIVED**  
**KANSAS CORPORATION COMMISSION**  
**DEC 22 2006**  
**CONSERVATION DIVISION**  
**WICHITA, KS**

**AFFIDAVIT OF PUBLICATION: --The Ness County News**

Case No. \_\_\_\_\_

(First published in the Ness County News, August 17, 2006) -1t

**BEFORE THE STATE CORPORATION COMMISSION OF THE STATE OF KANSAS NOTICE OF FILING APPLICATION**

RE: McCoy Petroleum Corporation, Operator #5003 - Application for Commingling of zones in the Schlegel A # 1-5 well, located in Ness County, Kansas

TO: All Oil & Gas Producers, Unleased Mineral Interest Owners, Landowners, and all persons whomsoever concerned.

You, and each of you, are hereby notified that McCoy Petroleum Corporation has filed application to commence the Commingling of the Ft Scott, and Mississippian formations in the Schlegel A # 1-5 located 330' from the North line, and 330' from the East line, in Section 5-20S-24W, Ness County, Kansas.

Any persons who object to or protest this application shall be required to file their objections or protest with the Conservation Division of the State Corporation Commission of the State of Kansas within fifteen (15) days from the

date of this publication. These protests shall be filed pursuant to Commission regulations and must state specific reasons why the grant to the application may violate correlative rights or pollute the natural resources of the State of Kansas.

All persons interested or concerned shall take notice of the foregoing and shall govern themselves accordingly.

McCoy Petroleum Corporation 8080 E. Central, Suite 300 Wichita, KS 67206 (316) 636-2737

STATE OF KANSAS, COUNTY OF NESS, ss:

Jerry Clarke, being first duly sworn, Deposes and says: that he is Publisher of The Ness County News, a weekly newspaper, published and printed in Ness City, State of Kansas, and published in and of general circulation in Ness County, Kansas, with a general paid circulation on a weekly basis in Ness County, Kansas, and that said newspaper is not a trade, religious or fraternal publication.

Said newspaper is a weekly published at least 50 times a year; has been so published continuously and uninterruptedly in said county and state for a period of more than five years prior to the first publication of said notice; and has been admitted at the post office of Ness City, in said County as second class mail matter.

That the attached notice is a true copy thereof and was published in the regular and entire issue of said newspaper for \_\_\_\_\_ consecutive weeks, the first publication thereof being made as aforesaid on the 17th day of August, 2006, with subsequent publications being made on the following dates:

\_\_\_\_\_, 20\_\_\_\_\_, \_\_\_\_\_, 20\_\_\_\_\_  
\_\_\_\_\_, 20\_\_\_\_\_, \_\_\_\_\_, 20\_\_\_\_\_  
\_\_\_\_\_, 20\_\_\_\_\_, \_\_\_\_\_, 20\_\_\_\_\_

Jerry Clarke, Jerry Clarke, editor

Subscribed and sworn to before me this 17th day of August, 2006

NOTARY PUBLIC - State of Kansas  
AMANDA SCHWIEN  
My Appt. Exp. 07/21/2009

Amanda Schwiem,  
Amanda Schwiem, Notary Public.

Publication Fee \_\_\_\_\_ \$ 23.56

Additional Copies @ \_\_\_\_\_ \$ \_\_\_\_\_

Total Publication Fees \_\_\_\_\_ \$ 23.56

Filed this \_\_\_\_\_ day of \_\_\_\_\_, 20\_\_\_\_\_.

Attached Proof Of Publication approved this \_\_\_\_\_ day of \_\_\_\_\_, 20\_\_\_\_\_

\_\_\_\_\_  
District Magistrate Judge

Filed this \_\_\_\_\_ day of \_\_\_\_\_, 20\_\_\_\_\_.

\_\_\_\_\_  
Clerk of the District Court.

Attached Proof Of Publication approved this \_\_\_\_\_ day of \_\_\_\_\_, 20\_\_\_\_\_

\_\_\_\_\_  
Judge Twenty-fourth Judicial District.

RECEIVED  
AUG 31 2006  
KCC WICHITA

# KANSAS

CORPORATION COMMISSION

KATHLEEN SEBELIUS, GOVERNOR  
BRIAN J. MOLINE, CHAIR  
ROBERT E. KREHBIEL, COMMISSIONER  
MICHAEL C. MOFFET, COMMISSIONER

January 5, 2007

Scott Hampel  
McCoy Petroleum Corporation  
8080 E. Central, Suite 300  
Wichita, KS 67206

**RE: Approved Commingling CO080607**  
**Schlegel A 1-5, Sec. 5-T20S-R24W, Ness County, Kansas**  
**API No. 15-135-24507-00-00**

Dear Mr. Hampel:

Your "Application for Commingling" (ACO-4) for the above described well has been technically reviewed and approved by the Kansas Corporation Commission (KCC) per **K.A.R. 82-3-123a**. Notice was examined and found to be proper per **K.A.R. 82-3-135a**. No protest had been filed within the 15-day protest period. This application, which was received by the KCC on **August 31, 2006** concerns approval to simultaneously produce from the following **three** sources of supply through the same tubing string in the same wellbore: the **Mississippian, Lower Fort Scott, and Upper Fort Scott** formations.

According to your application, the estimated current production from the **Mississippian** source of supply is **20 BOPD, 0 Mcfpd and 15 BWPD**. The estimated current production from the **Lower Fort Scott** source of supply is **52 BOPD, 0 Mcfpd and 20 BWPD**. The estimated current production from the **Upper Fort Scott** source of supply is **55 BOPD, 0 Mcfpd and 20 BWPD**. The total estimated current production from all sources of supply in the subject well is **127 BOPD, 0 Mcfpd and 55 BWPD**.

Based upon the depth of the **Marmaton** formation perforations, total oil production shall not exceed **200 BOPD** and total gas production shall not exceed **50%** of the absolute open flow (AOF).

Docket Number **CO080607** has been assigned to this approved application. Please use this number for well completion reports (ACO-1) and other correspondence that may concern this approved commingling.

Sincerely,



Rick Hestermann  
Production Department

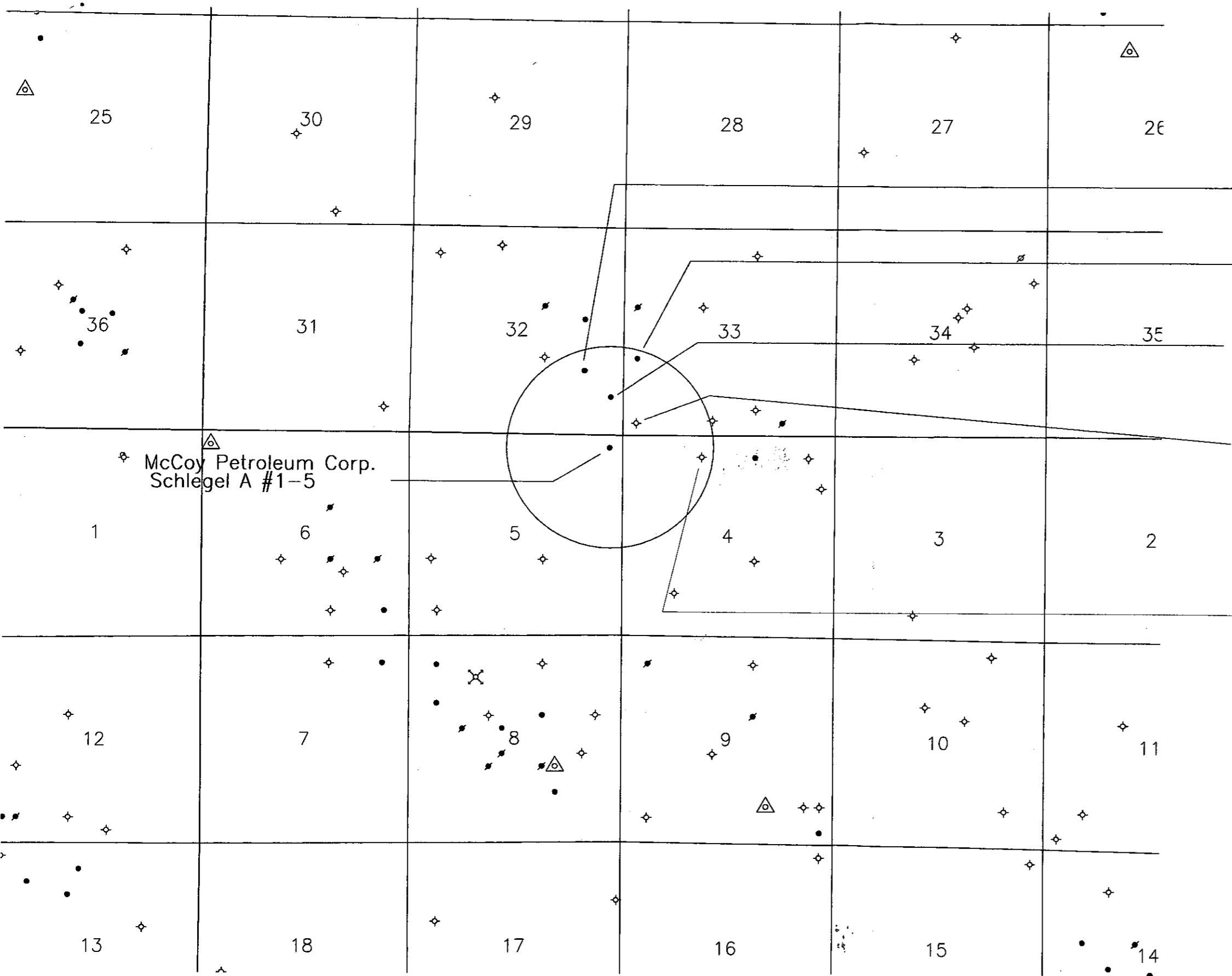

Scale 1:31980.7

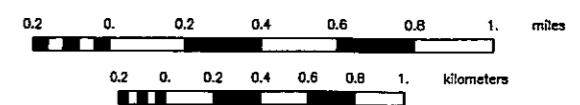

- Pintail Petroleum Shramek #2
- Pintail Petroleum Lundy #1
- Pintail Petroleum Schmalzried #1
- Pintail Petroleum Lundy #2
- Palomino Petroleum Lundy A #1

RECEIVED  
AUG 31 2006  
KCC WICHITA



**Natural Gas • Crude Oil  
Exploration & Production**

**McCOY PETROLEUM CORPORATION**  
Wichita, Kansas

SCHLEGEL "A" #1-5  
SEC. 5 - 20S - 24W  
NESS COUNTY, KANSAS