

KANSAS CORPORATION COMMISSION
OIL & GAS CONSERVATION DIVISION

Form ACO-4
Form must be typed
July 2006

APPLICATION FOR COMMINGLING OF
PRODUCTION (K.A.R. 82-3-123) OR FLUIDS (K.A.R. 82-3-123a)

Commingling ID # CO 0108D6

Operator Information:

License #: 5056
Name: F.G. Holl Company, L.L.C.
Address: 9431 E. Central, Suite 100
City/State/Zip: Wichita, Kansas 67206
Contact Person: Franklin R. Greenbaum
Phone #: (316) 684-8481, Ext. 206

Well Information:

API #: 15 - 185-23,295-0001
Lease Name: OTTE FAMILY TRUST "OWWO" Well #: 1-5
Spot: 150' N. & 60' E. of C - NE - NE Sec. 5 Twp. 21 S. R. 14 East West
County: Stafford
Feet from North / South Line of Section: 510
Feet from East / West Line of Section: 600

1. Name and upper and lower limit of each production interval to be commingled:

Formation: Lansing-Kansas City (Perfs): 3368' - 3374'
Formation: Arbuckle (Perfs): 3550' - 3568'
Formation: _____ (Perfs): _____
Formation: _____ (Perfs): _____
Formation: _____ (Perfs): _____

2. Estimated amount of fluid production to be commingled from each interval:

Formation: Lansing-Kansas City BOPD: 6.68 MCFPD: 0 BWPD: 0.5
Formation: Arbuckle BOPD: 74.00 MCFPD: 0 BWPD: 1849.5
Formation: _____ BOPD: _____ MCFPD: _____ BWPD: _____
Formation: _____ BOPD: _____ MCFPD: _____ BWPD: _____
Formation: _____ BOPD: _____ MCFPD: _____ BWPD: _____

3. Plat map showing the location of the subject well, all other wells on the subject lease, and all wells on offsetting leases within a 1/2 mile radius of the subject well, and for each well the names and addresses of the lessee of record or operator.

4. Signed certificate showing service of the application and affidavit of publication as required in K.A.R. 82-3-135a.

For Commingling of PRODUCTION ONLY, include the following:

- 5. Wireline log of subject well.
- 6. Complete Form ACO-1 (Well Completion form) for the subject well.

For Commingling of FLUIDS ONLY, include the following:

- _____ 5. Well construction diagram of subject well.
- _____ 6. Any available water chemistry data demonstrating the compatibility of the fluids to be commingled.

State of Kansas)
)
County of Sedgwick)

ss:

VERIFICATION: I hereby certify that to the best of my current information, knowledge and personal belief, this request for commingling is true and proper and I have no information or knowledge, which is inconsistent with the information supplied in this application.

Signature: Loveness Mpanje
Printed Name: Loveness Mpanje
Title: Petroleum Geologist
Subscribed & sworn to before me this 21st day of December, 2007, 20____
Notary Public: Betty H. Spotswood Booby H. Spotswood
My Commission Expires: 04/30/2010

RECEIVED
KANSAS CORPORATION COMMISSION
JAN 22 2008
CONSERVATION DIVISION
WICHITA, KS

KCC Office Use Only
 Denied Approved
KCC Date Received: 1/22/08 15-Day Periods Ends: 2-21-08
Approved By: _____ Date: _____

Protests may be filed by any party having a valid interest in the application. Protests must be in writing and comply with K.A.R. 82-3-135b and must be filed within 15 days of publication of the notice of application.

Mail with all required attachments and files to: KCC - Conservation Division, 130 S. Market - Room 2078, Wichita, Kansas 67202

Notary Public - State of Kansas
BETTY H. SPOTSWOOD
My Appointment Expires 4/30/2010

Certificate of Service

F.G. Holl Company, L.L.C.

February 11, 2008

I hereby certify that on this 26th day of December 2007 I caused a true and correct copy of the attached application to be deposited in the United States mail, postage prepaid addressed to the persons as listed below:

<u>Name</u>	<u>Address</u>
L D Drilling, Inc.	7 SW 26 th Avenue, RR1, Box 183 B, Great Bend, Kansas 67530
Irene Fparkman	1901 Lincoln, Great Bend, KS. 67530
Cara Boldwin	P.O. Box 310, Centennial, WY 82055
Mr. Walter Moody	Kansas Corporation Commission, 130 S. Market, Room 2078, Wichita, KS. 67202

Loveness Mpanje
Loveness Mpanje
Petroleum Geologist
F.G. Holl Company, L.L.C.
9431 E. Central, Suite 100
Wichita, KS. 67206
(316) 684-8481, ext. 216

RECEIVED
KANSAS CORPORATION COMMISSION
FEB 12 2008
CONSERVATION DIVISION
WICHITA, KS

Certificate of Service

F.G. Holl Company, L.L.C.

December 26, 2007

I hereby certify that on this 26th day of December 2007 I caused a true and correct copy of the attached application to be deposited in the United States mail, postage prepaid addressed to the persons as listed below:

<u>Name</u>	<u>Address</u>
Irene Fparkman	C/O Cara Baldwin 1901 Lincoln, Great Bend, KS. 67530
Patricia Hardekopf	P.O. Box 310, Centennial, WY 82055
Mr. Walter Moody	Kansas Corporation Commission, 130 S. Market, Room 2078, Wichita, KS. 67202

Loveness Mpanje
Loveness Mpanje

Petroleum Geologist
F.G. Holl Company, L.L.C.
9431 E. Central, Suite 100
Wichita, KS. 67206
(316) 684-8481, ext. 216

RECEIVED
KANSAS CORPORATION COMMISSION
JAN 22 2008
CONSERVATION DIVISION
WICHITA, KS

AFFIDAVIT

STATE OF KANSAS \
- SS.
County of Sedgwick /

Nicole Mandina, of lawful age, being first duly sworn, deposeth and saith: That she is Record Clerk of The Wichita Eagle, a daily newspaper published in the City of Wichita, County of Sedgwick, State of Kansas, and having a general paid circulation on a daily basis in said County, which said newspaper has been continuously and uninterruptedly published in said County for more than one year prior to the first publication of the notice hereinafter mentioned, and which said newspaper has been entered as second class mail matter at the United States Post Office in Wichita, Kansas, and which said newspaper is not a trade, religious or fraternal publication and that a notice of a true copy is hereto attached was published in the regular and entire Morning issue of said The Wichita Eagle for 1 issues - weeks, that the first publication of said notice was

made as aforesaid on the 3rd of

February A.D. 2008 , with

subsequent publications being made on the following dates:

Jan. 27 & 29, Feb. 1 & 2, 2008

And affiant further says that she has personal knowledge of the statements above set forth and that they are true.



Subscribed and sworn to before me this

4th day of February, 2008



Notary Public Sedgwick County, Kansas

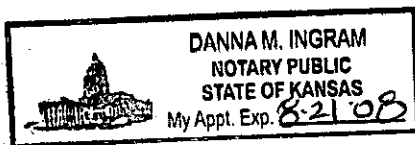

Printers Fee: \$86.00

LEGAL PUBLICATION

First Published in The Wichita Eagle on February 3, 2008 (2787479)
BEFORE THE STATE CORPORATION COMMISSION OF THE STATE OF KANSAS:
NOTICE OF FILING APPLICATION FOR COMMINGLING OF PRODUCTION
January 28, 2008

RE: F.G. Holl Company, L.L.C. - Application for order to commingle production from the Lansing-Kansas City and Arbuckle Formations at the Otte #1-5, located in Stafford County, Kansas.

TO: All Oil and Gas Producers, Unleased Mineral Interest Owners, Landowners, and all persons whosoever concerned.

You, and each one of you, are hereby notified that F.G. Holl Company, L.L.C. has filed an application to commingle production from the Lansing-Kansas City and Arbuckle Formations at its Otte #1-5 well, located 150' N. & 60' E. of C NE NE Sec. 5-21S-14W, Stafford County, Kansas.

Any persons who object or protest against this application shall be required to file their concerns with the Conservation Division of the State Corporation Commission of the State of Kansas within 15 days from the date of the publication. These protests shall be filed pursuant to Commission regulations and must state specific reasons why the grant of the application may cause waste, violate correlative rights or pollute the natural resources of the state of Kansas. If no protests are received, this application may be granted through a summary proceeding. If valid protests are received, this matter will be set for hearing.

All persons interested or concerned shall take notice of the foregoing and shall govern themselves accordingly.

F.G. Holl Company, L.L.C.
9431 E. Central, Suite 100,
Wichita, KS. 67206
(316) 684-8481

RECEIVED
KANSAS CORPORATION COMMISSION

FEB 08 2008

CONSERVATION DIVISION
WICHITA, KS

PROOF OF PUBLICATION

COURT NO. _____

STATE OF KANSAS, STAFFORD COUNTY, S.S.

David Green, of lawful age, being duly sworn upon oath states that he is the publisher of

THE STAFFORD COURIER

THAT said newspaper has been published at least weekly fifty (50) times a year and has been so published for at least five years prior to the first publication of the attached notice;

THAT said paper was entered as second class mail matter at the post office of its publication;

THAT said paper has a general circulation on a daily, or weekly, or monthly, or yearly basis in

STAFFORD County, Kansas, and is

NOT a trade, religious or fraternal publication and has been published in STAFFORD County, Kansas,

THE ATTACHED was published on the following dates in a regular issue of said newspaper:

- First Publication 1-2....., 2008.....
- Second Publication....., 20.....
- Third Publication....., 20.....
- Fourth Publication....., 20.....
- Fifth Publication....., 20.....
- Sixth Publication....., 20.....

Publication Fee \$ 23³⁹.....

Affidavit, Notary's Fee \$

Additional Copies @ \$

Total Publication Fee \$

Witness my hand this 2 day of January, 2008
(Sign) David Green

SUBSCRIBED AND SWORN TO before this 2 day of
January, 2008



Karen Kalmar
(Notary Public)

My commission expires 5-11-10

RECEIVED
KANSAS CORPORATION COMMISSION

JAN 22 2008
CONSERVATION DIVISION
WICHITA, KS

(Published In The Stafford Courier, Wednesday, January 2, 2008)
BEFORE THE STATE CORPORATION COMMISSION OF THE STATE OF KANSAS:
NOTICE OF FILING APPLICATION FOR COMMINGLING OF PRODUCTION

December 26, 2007

RE: F.G. Holl Company, L.L.C. - Application for order to commingle production from the Lansing-Kansas City and Arbuckle Formations at the Otte #1-5, located in Stafford County, Kansas.

TO: All Oil and Gas Producers, Unleased Mineral Interest Owners, Landowners, and all persons whose-ever concerned.

You, and each one of you, are hereby notified that F.G. Holl Company, L.L.C. has filed an application to commingle production from the Lansing-Kansas City and Arbuckle Formations at its Otte #1-5 well, located 150' N. & 60' E. of C NE NE Sec. 5-21S-14W, Stafford County, Kansas.

Any persons who object or protest against this application shall be required to file their concerns with the Conservation Division of the State Corporation Commission of the State of Kansas within 15 days from the date of the publication. These protests shall be filed pursuant to Commission regulations and must state specific reasons why the grant of the application may cause waste, violate correlative rights or pollute the natural resources of the state of Kansas. If no protests are received, this application may be granted through a summary proceeding. If valid protests are received, this matter will be set for hearing.

All persons interested or concerned shall take notice of the foregoing and shall govern themselves accordingly.

F.G. Holl Company, L.L.C.
9431 E. Central, Suite 100,
Wichita, KS 67206
(316) 684-8481

KANSAS
CORPORATION COMMISSION

*Kathleen Sebelius, Governor
Thomas E. Wright, Chairman
Michael C. Moffet, Commissioner
Joseph F. Harkins, Commissioner*

February 26, 2008

Franklin R. Greenbaum
F.G. Holl Company, LLC
9431 E. Central, Suite 100
Wichita, KS 67206

**RE: Approved Commingling CO010806
Otte Family Trust "OWWO" #1-5, Sec. 5-T21S-R14W, Stafford County, Kansas
API No. 15-185-23295-0001**

Dear Mr. Greenbaum:

Your "Application for Commingling" (ACO-4) for the above described well has been reviewed and approved by the Kansas Corporation Commission (KCC) per **K.A.R. 82-3-123a**. Notice was examined and found to be proper per **K.A.R. 82-3-135a**. No protest had been filed within the 15-day protest period. This application, which was received by the KCC on **January 22, 2008** concerns approval to simultaneously produce from the following **two** sources of supply through the same tubing string in the same wellbore: the **Lansing-Kansas City and Arbuckle** formations.

According to your application, the estimated current production from the **Lansing-Kansas City** source of supply is **6.68 BOPD, 0 Mcfpd and 0.5 BWPD**. The estimated current production from the **Arbuckle** source of supply is **74 BOPD, 0 Mcfpd and 1849.5 BWPD**. The total estimated current production from all sources of supply in the subject well is **80.68 BOPD, 0 Mcfpd and 1850 BWPD**.

Based upon the depth of the **Arbuckle** formation perforations, total oil production shall not exceed **100 BOPD** and total gas production shall not exceed **50%** of the absolute open flow (AOF).

Docket Number **CO010806** has been assigned to this approved application. Please use this number for well completion reports (ACO-1) and other correspondence that may concern this approved commingling.

Sincerely,



Rick Hestermann
Production Department

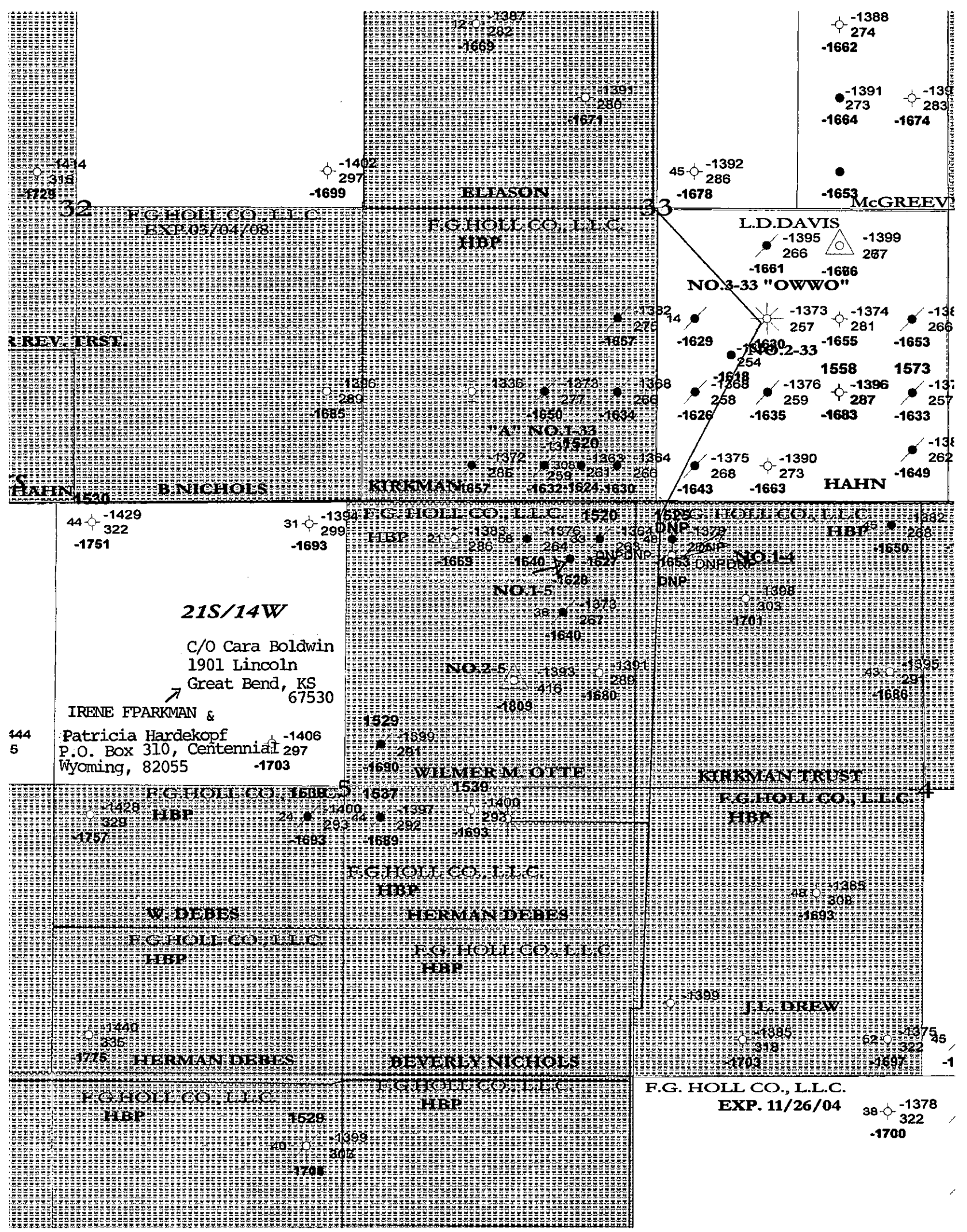

21S/14W
 C/O Cara Baldwin
 1901 Lincoln
 Great Bend, KS 67530
 IRENE FPARKMAN &
 Patricia Hardekopf
 P.O. Box 310, Centennial 297
 Wyoming, 82055



F.G. HOLL COMPANY, L.L.C.		
HULLETT AREA S-2 3-D PROSPECT OTTE NO. 2-5		
DATE	USER	DATE