



KANSAS CORPORATION COMMISSION 1056654  
 OIL & GAS CONSERVATION DIVISION

Form ACO-4  
 Form must be typed  
 March 2009

APPLICATION FOR COMMINGLING OF **Commingling ID # CO061102**  
 PRODUCTION (K.A.R. 82-3-123) OR FLUIDS (K.A.R. 82-3-123a)

OPERATOR: License # 33190  
 Name: Noble Energy, Inc.  
 Address 1: 1625 Broadway, Ste 2200  
 Address 2: \_\_\_\_\_  
 City: DENVER State: CO Zip: 80202 + \_\_\_\_\_  
 Contact Person: Liz Lindow  
 Phone: (303) 228-4342

API No. 15 - 15-009-15598-00-00  
 Spot Description: \_\_\_\_\_  
SW SW NE Sec. 24 Twp. 20 S. R. 12  East  West  
2970 Feet from  North /  South Line of Section  
2970 Feet from  East /  West Line of Section  
 County: Barton  
 Lease Name: YORK MARCHAND Well #: 4

1. Name and upper and lower limit of each production interval to be commingled:
- |                                       |                           |
|---------------------------------------|---------------------------|
| Formation: <u>Lansing-Kansas City</u> | (Perfs): <u>3191-3264</u> |
| Formation: <u>Arbuckle</u>            | (Perfs): <u>3339-3363</u> |
| Formation: _____                      | (Perfs): _____            |
| Formation: _____                      | (Perfs): _____            |
| Formation: _____                      | (Perfs): _____            |

2. Estimated amount of fluid production to be commingled from each interval:
- |                                       |                |                 |                    |
|---------------------------------------|----------------|-----------------|--------------------|
| Formation: <u>Lansing-Kansas City</u> | BOPD: <u>2</u> | MCFPD: <u>0</u> | BWPD: <u>92.6</u>  |
| Formation: <u>Arbuckle</u>            | BOPD: <u>1</u> | MCFPD: <u>0</u> | BWPD: <u>148.4</u> |
| Formation: _____                      | BOPD: _____    | MCFPD: _____    | BWPD: _____        |
| Formation: _____                      | BOPD: _____    | MCFPD: _____    | BWPD: _____        |
| Formation: _____                      | BOPD: _____    | MCFPD: _____    | BWPD: _____        |

3. Plat map showing the location of the subject well, all other wells on the subject lease, and all wells on offsetting leases within a 1/2 mile radius of the subject well, and for each well the names and addresses of the lessee of record or operator.
4. Signed certificate showing service of the application and affidavit of publication as required in K.A.R. 82-3-135a.

**For Commingling of PRODUCTION ONLY, include the following:**

5. Wireline log of subject well. Previously Filed with ACO-1:  Yes  No
6. Complete Form ACO-1 (*Well Completion form*) for the subject well.

**For Commingling of FLUIDS ONLY, include the following:**

7. Well construction diagram of subject well.
8. Any available water chemistry data demonstrating the compatibility of the fluids to be commingled.

**AFFIDAVIT:** I am the affiant and hereby certify that to the best of my current information, knowledge and personal belief, this request for commingling is true and proper and I have no information or knowledge, which is inconsistent with the information supplied in this application.

**Submitted Electronically**

<b>KCC Office Use Only</b>	
<input type="checkbox"/> Denied	<input checked="" type="checkbox"/> Approved
15-Day Periods Ends: <u>06/16/2011</u>	
Approved By: <u>Rick Hestermann</u>	Date: <u>06/21/2011</u>

*Protests may be filed by any party having a valid interest in the application. Protests must be in writing and comply with K.A.R. 82-3-135b and must be filed within 15 days of publication of the notice of application.*

**AFFIDAVIT**

STATE OF KANSAS \
- SS.
County of Sedgwick /

Mark Fletchall, of lawful age, being first duly sworn, deposeh and saith: That he is Record Clerk of The Wichita Eagle, a daily newspaper published in the City of Wichita, County of Sedgwick, State of Kansas, and having a general paid circulation on a daily basis in said County, which said newspaper has been continuously and uninterruptedly published in said County for more than one year prior to the first publication of the notice hereinafter mentioned, and which said newspaper has been entered as second class mail matter at the United States Post Office in Wichita, Kansas, and which said newspaper is not a trade, religious or fraternal publication and that a notice of a true copy is hereto attached was published in the regular and entire Morning issue of said The Wichita Eagle for 1 issues, that the first publication of said notice was

made as aforesaid on the 1st of

June A.D. 2011, with

subsequent publications being made on the following dates:

And affiant further says that he has personal knowledge of the statements above set forth and that they are true.

*Mark Fletchall*

Subscribed and sworn to before me this

1st day of June, 2011

PENNY L. CASE
Notary Public - State of Kansas
My Appt Expires 5/28/2014

*Penny L Case*
Notary Public Sedgwick County, Kansas

Printer's Fee : \$132.40

LEGAL PUBLICATION
Published in The Wichita Eagle
June 1, 2011 (3119817)
BEFORE THE STATE CORPORATION COMMISSION OF THE STATE OF KANSAS
IN THE MATTER OF THE APPLICATION OF NOBLE ENERGY, INC. FOR COMMINGLING OF PRODUCTION IN THE YORK MARCHAND 4 LOCATED IN THE SW/4 SW/4 NE/4 OF SECTION 7 - T20S - R11W IN BARTON COUNTY, KANSAS
CONSERVATION DIVISION LICENSE NO. 33190
NOTICE OF APPLICATION AND HEARING
TO: ALL OIL AND GAS PRODUCERS, UNLEASED MINERAL INTEREST OWNERS, LANDOWNERS, AND ALL PERSONS WHOMSOEVER CONCERNED
You, and each of you, are hereby notified that NOBLE ENERGY, INC. has filed an application to commingle the Lansing-Kansas City and Arbuckle producing formations at the York Marchand 4, located 330' from the south line and 990' from the west line of Sec 24-T20S-R12W, Barton County, Kansas.
Any persons who object to or protest this application shall be required to file their objections or protests with the Conservation Division of the State Corporation Commission of the State of Kansas within fifteen days from the date of the publication. These protests shall be filed pursuant to Commission regulations and must state specific reasons why the grant of the application may cause waste, violate correlative rights or pollute the natural resources of the State of Kansas.
All persons interested or concerned shall take notice of the foregoing and shall govern themselves accordingly.
Liz Lindow
Noble Energy, Inc.
1625 Broadway, Suite 2200
Denver, CO 80202
Telephone: 303-228-4000
Fax: 303-228-4286

**CERTIFICATE OF SERVICE**

I hereby certify on this 27th day of May, 2011, true and correct copies of the above and foregoing Application and the Notice of Application were served by depositing copies of the same in the United States Mail, postage prepaid, and properly addressed to the mineral owners and operators set forth in Exhibit "A" attached to the Commingling Application filed by Applicant.



---

Liz Lindow

Regulatory Analyst

Noble Energy, Inc.

1625 Broadway, Suite 2200

Denver, CO 80202

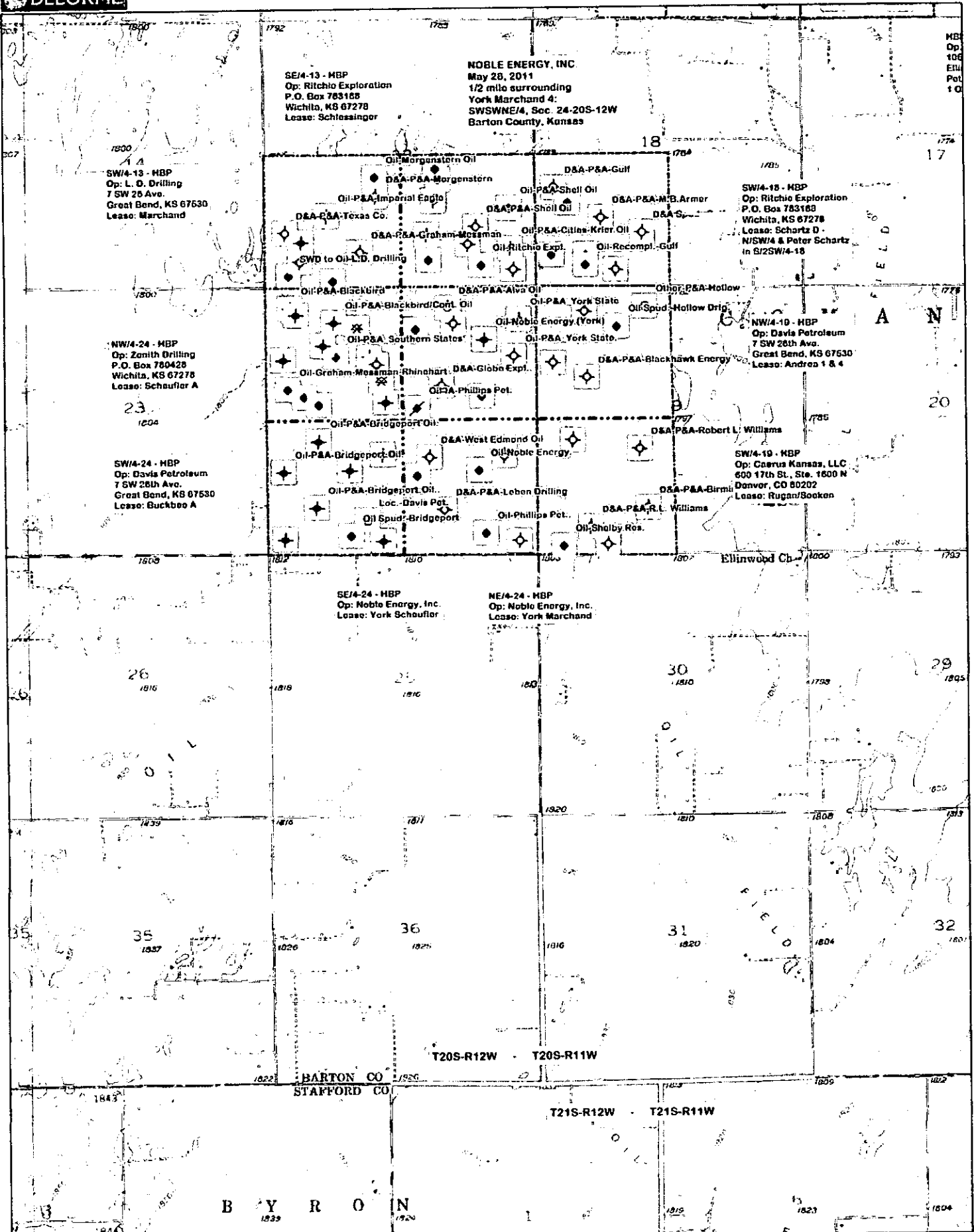

Data use subject to license.

© DeLorme XMap® 7

www.delorme.com

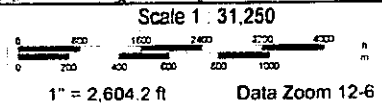
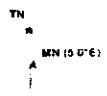

Data Zoom 12-6

STATE OF KANSAS

BARTON COUNTY

Proof of Publication

SS.

MARY HOISINGTON

of lawful age, duly sworn upon oath states that SHE

is the PUBLISHER

of THE GREAT BEND TRIBUNE

THAT said newspaper has been published at least weekly fifty (50) times a year and has been so published for at least five years prior to the first publication of the attached notice:

THAT said paper was entered as second class mail matter at the post office of its publication:

THAT said paper has a general paid circulation on a daily, or weekly, or monthly, or yearly basis in

BARTON County, Kansas, and is

NOT a trade, religious or fraternal publication and has been PRINTED and published in BARTON County, Kansas.

That the attached notice was published in a regular issue of said newspaper

for 1 consecutive weeks, the first publication being on the 1st day

of June 20 11 and the last publication on the 1st day

of June 20 11

Publication Fee \$

Affidavit, Notary's Fees \$

Additional Copies at \$

Total Publication Fee \$ 30.11

(Sign)

Witness my hand this 1st day of June, 20 11

SUBSCRIBED and Sworn to before me this 1st

day of June 20 11

Raegina Wirth

(Notary Public)

(First published in the Great Bend Tribune June 1, 2011) IT BEFORE THE STATE CORPORATION COMMISSION OF THE STATE OF KANSAS IN THE MATTER OF THE APPLICATION OF NOBLE ENERGY, INC. FOR COMMINGLING INC. FOR OF PRODUCTION IN THE YORK, MARCHAND LOCATED IN THE SW/4 SW/4 NE/4 OF SECTION 7 - T20S - R11W IN BARTON COUNTY, KANSAS Conservation Division License No. 33190 NOTICE OF APPLICATION AND HEARING TO ALL OIL AND GAS PRODUCERS, UNLEASED MINERAL INTEREST OWNERS, LANDOWNERS, AND ALL PERSONS WHOMSOEVER CONCERNED You, and each of you, are hereby notified that NOBLE ENERGY, INC. has filed an application to commingle the Lansing-Kansas City Arbuckle producing formations at the York Marchand 4, located 330' from the south line and 890' from the west line of Sec 24 - T20S-R12W, Barton County, Kansas. Any persons who object to or protest this application shall be required to file their objections or protests with the Conservation Division of the State Corporation Commission of the State of Kansas within fifteen days from the date of the publication. These protests shall be filed pursuant to Commission regulations and must state specific reasons why the grant of the application may cause waste, violate correlative rights or pollute the natural resources of the State of Kansas. All persons interested or concerned shall take notice of the foregoing and shall govern themselves accordingly. Liz Lindow Noble Energy, Inc. 1625 Broadway, Suite 2200 Denver, CO 80202 Telephone: 303-228-4000 Fax: 303-228-4288

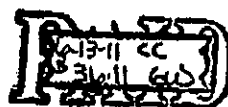

State of Kansas - Notary Public RAEGINA WERTH

My commission expires 7-26-14

Conservation Division  
Finney State Office Building  
130 S. Market, Rm. 2078  
Wichita, KS 67202-3802



Phone: 316-337-6200  
Fax: 316-337-6211  
<http://kcc.ks.gov/>

Mark Sievers, Chairman  
Ward Loyd, Commissioner  
Thomas E. Wright, Commissioner

Sam Brownback, Governor

June 21, 2011

Liz Lindow  
Noble Energy, Inc.  
1625 Broadway, Ste 2200  
Denver, CO 80202

RE: Approved Commingling CO061102  
York Marchand #4, Sec. 24-T20S-R12W, Barton County  
API No. 15-009-15598-00-00

Dear Ms. Lindow:

Your Application for Commingling (ACO-4) for the above described well has been reviewed and approved by the Kansas Corporation Commission (KCC) per K.A.R. 82-3-123. Notice was examined and found to be proper per K.A.R. 82-3-135a. No protest had been filed within the 15-day protest period. This application, which was received by the KCC on June 13, 2011 concerns approval to simultaneously produce from the following sources of supply through the same tubing string in the same wellbore:

Source of Supply	Estimated Current Production			Perf Depth
	BOPD	MCFPD	BWPD	
Lansing-Kansas City	2	0	92.6	3191-3264
Arbuckle	1	0	148.4	3339-3363
Total Estimated Current Production	3	0	241	

Based upon the depth of the Arbuckle formation perforations, total oil production shall not exceed 100 BOPD and total gas production shall not exceed 50% of the absolute open flow (AOF).

**File form ACO-1 upon completion of the well to commingle.**

Commingling ID number CO061102 has been assigned to this approved application. Use this number for well completion reports (ACO-1) and other correspondence that may concern this approved commingling.

Sincerely,

Rick Hestermann  
Production Department