

Approved 3-8-05 Date KAC-4
8/90

OPERATOR RITCHIE EXPLORATION, INC. DOCKET # C0020503 DATE 02/15/05
ADDRESS P.O. BOX 783188 OPERATOR'S LICENSE # 4767
WICHITA, KS 67278-3188 API NO. 15- 195-21, 226-0001
LEASE HIXSON FARMS A WELL NO. 3
QUARTER SW NE SE SEC 35 TWP 11 RGE 22 E
W XXc

COMMINGLING 82-3-123

RECEIVED
FEB 16 2005

KCC WICHITA

X 1. Description of the well. ✓
A plat showing:
a) Location of subject well.
b) Location of other wells on the lease.
c) Location of offsetting wells and operator's name.

X 2. Names and upper and lower limits of the source of supply involved. ✓
(NAME) LKC (PERFS) 3638' - 3727'
(NAME) MARMATON (PERFS) 3959' - 3978'
(NAME) _____ (PERFS) _____

X 3. Wireline log of the subject well.

X 4. A complete ACO-1 form.

X 5. Expected production, oil-gas-water, for each source of supply.

FORMATION	<u>LKC</u>	BOPD	<u>2.06</u>	MCF	_____	BWPD	<u>77.88</u>
FORMATION	<u>MARMATON</u>	BOPD	<u>2.22</u>	MCF	_____	BWPD	<u>3.47</u>
FORMATION	_____	BOPD	_____	MCF	_____	BWPD	_____
FORMATION	_____	BOPD	_____	MCF	_____	BWPD	_____
ESTIMATED COMBINED TOTAL		BOPD	<u>4.28</u>	MCF	_____	BWPD	<u>81.35</u>

___ 6. Application shall be supported by an Affidavit and shall contain a certificate showing service of a copy of the application without attachments to the offsetting operators. You are responsible for this. Unless waivers are obtained, applications are held for fifteen days to give offsetting operators time to file objections. If waivers are obtained, applications can be processed immediately. If objections are filed, applications are then set for hearing.

R 22W

T
11
S

T
12
S

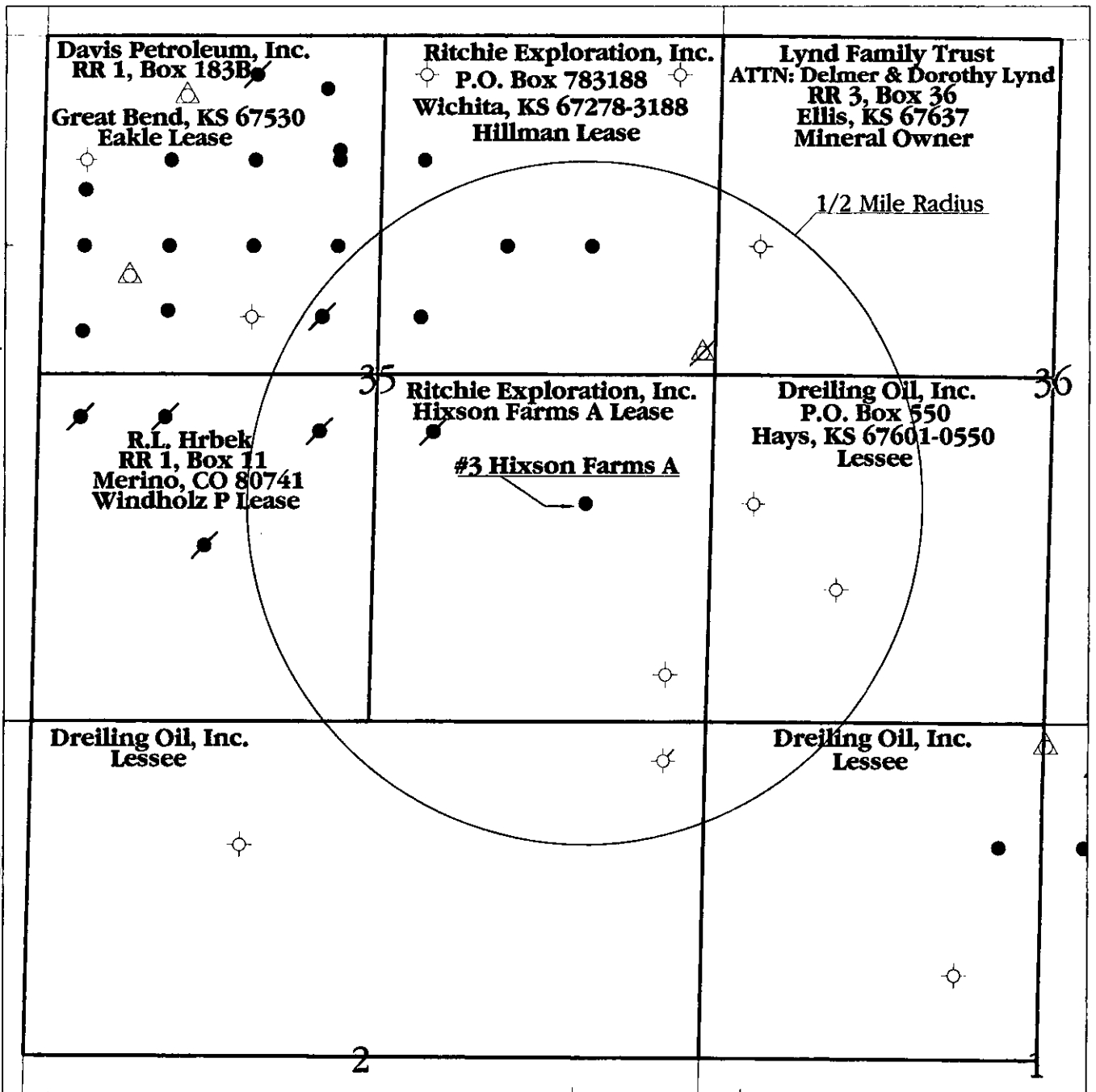

Legend

- Oil Well
- ⊗ Abandoned Oil Well
- △ Service Well
- ⊗ Abandoned Service Well
- ⊗ Dry and Abandoned, Completion Attempted
- ⊗ Dry and Abandoned Well
- Lease Boundary

Ritchie Exploration, Inc.		
#3 Hixson Farms A Commingle Application Lease Holders Within 1/2 Mile Radius Trego County, Kansas		
Author: Justin Clegg		Date: 28 December, 2004
	Scale: 1 : 14,300	

RECEIVED
FEB 16 2005
KCC WICHITA

**Hixson Farms A Lease
SE/4 Sec. 35-11S-22W
Trego Co., Kansas**

Offset Operators; Lessees; or Mineral Owners within ½ mile.

<u>11S-22W</u>	Sec. 35	NE/4	Ritchie Exploration, Inc. PO Box 783188 Wichita, KS 67278-3188	Operator: Hillman
		NW/4	Davis Petroleum, Inc. RR 1, Box 183B Great Bend, KS 67530	Operator: Eakle
		SW/4	R. L. Hrbek RR 1, Box 11 Merino, CO 80741	Operator: Windholz P
	Sec. 36	NW/4	Lynd Family Trust % Delmer & Dorothy Lynd RR 3, Box 36 Ellis, KS 67637	Mineral Owner
		SW/4	Dreiling Oil, Inc. PO Box 550 Hays, KS 67601-0550	Lessee
<u>12S-22W</u>	Sec. 1	NW/4	Dreiling Oil, Inc.	Lessee
	Sec. 2	N/2	Dreiling Oil, Inc.	Lessee

RECEIVED
FEB 16 2005
KCC WICHITA

7004 1350 0005 3539 9222

U.S. Postal Service™
CERTIFIED MAIL™ RECEIPT
(Domestic Mail Only; No Insurance Coverage Provided)

For delivery information, visit our website at www.usps.com
OFFICIAL USE

Postage	\$	0.37
Certified Fee		2.30
Return Receipt Fee (Endorsement Required)		1.75
Restricted Delivery Fee (Endorsement Required)		
Total Postage & Fees	\$	4.42

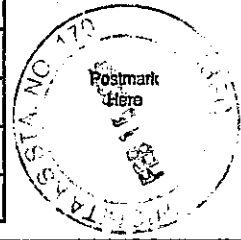

Sent To
c/o Delmer & Dorothy Lynd, Family Trust
Street, Apt. No.,
or PO Box No. **RR 3, Box 36**
City, State, ZIP+4
Ellis, KS 67637

PS Form 3800, June 2002 See Reverse for Instructions

7004 1350 0005 3539 9246

U.S. Postal Service™
CERTIFIED MAIL™ RECEIPT
(Domestic Mail Only; No Insurance Coverage Provided)

For delivery information, visit our website at www.usps.com
OFFICIAL USE

Postage	\$	0.37
Certified Fee		2.30
Return Receipt Fee (Endorsement Required)		1.75
Restricted Delivery Fee (Endorsement Required)		
Total Postage & Fees	\$	4.42

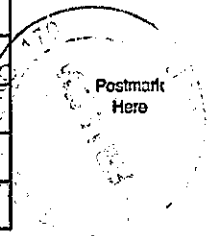

Sent To
Davis Petroleum, Inc.
Street, Apt. No.,
or PO Box No. **RR 1, Box 183B**
City, State, ZIP+4
Great Bend, KS 67530

PS Form 3800, June 2002 See Reverse for Instructions

7004 1350 0005 3539 9239

U.S. Postal Service™
CERTIFIED MAIL™ RECEIPT
(Domestic Mail Only; No Insurance Coverage Provided)

For delivery information, visit our website at www.usps.com
OFFICIAL USE

Postage	\$	0.37
Certified Fee		2.30
Return Receipt Fee (Endorsement Required)		1.75
Restricted Delivery Fee (Endorsement Required)		
Total Postage & Fees	\$	4.42



Sent To
R.L. HrBek
Street, Apt. No.,
or PO Box No. **RR 1, Box 11**
City, State, ZIP+4
Merino, CO 80741

PS Form 3800, June 2002 See Reverse for Instructions

7004 1350 0005 3539 9215

U.S. Postal Service™
CERTIFIED MAIL™ RECEIPT
(Domestic Mail Only; No Insurance Coverage Provided)

For delivery information, visit our website at www.usps.com
OFFICIAL USE

Postage	\$	0.37
Certified Fee		2.30
Return Receipt Fee (Endorsement Required)		1.75
Restricted Delivery Fee (Endorsement Required)		
Total Postage & Fees	\$	4.42

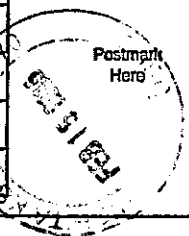

Sent To
Dreiling Oil, Inc.
Street, Apt. No.,
or PO Box No. **P.O. Box 550**
City, State, ZIP+4
Hays, KS 67601-0550

PS Form 3800, June 2002 See Reverse for Instructions

RECEIVED
FEB 16 2005
KCC WICHITA