

OPERATOR McCoy Petroleum Corporation DOCKET # C 020504 DATE DC 020504  
ADDRESS 8080 E. Central, Suite 300 OPERATOR'S LICENSE # 5003  
Wichita, KS 67206 API NO. 15-081-21555-00-00  
LEASE Connor 'A' WELL NO. 1-29  
QUARTER NE SEC 29 TWP 30S RGE 31 E X  
W X

COMMINGLING 82-3-123

RECEIVED  
FEB 18 2005  
KCC WICHITA

- 1. Description of the well.  
A plat showing:  
a) Location of subject well.  
b) Location of other wells on the lease.  
c) Location of offsetting wells and operator's name.
- 2. Names and upper and lower limits of the source of supply involved.

(NAME) KC Swope (PERFS) 4672-82'  
(NAME) KC Hertha (PERFS) 4728-38'  
(NAME) \_\_\_\_\_ (PERFS) \_\_\_\_\_

- 3. Wireline log of the subject well. (Submitted with ACO-1)
- 4. A complete ACO-1 form.
- 5. Expected production, oil-gas-water, for each source of supply.

FORMATION KC Swope BOPD 100 MCF \_\_\_\_\_ BWPD \_\_\_\_\_  
FORMATION KC Hertha BOPD \_\_\_\_\_ MCF 1000 BWPD \_\_\_\_\_  
FORMATION \_\_\_\_\_ BOPD \_\_\_\_\_ MCF \_\_\_\_\_ BWPD \_\_\_\_\_  
FORMATION \_\_\_\_\_ BOPD \_\_\_\_\_ MCF \_\_\_\_\_ BWPD \_\_\_\_\_  
ESTIMATED COMBINED TOTAL \_\_\_\_\_ BOPD 100 MCF 1000 BWPD 0

- 6. Application shall be supported by an Affidavit and shall contain a certificate showing service of a copy of the application without attachments to the offsetting operators. You are responsible for this. Unless waivers are obtained, applications are held for fifteen days to give offsetting operators time to file objections. If waivers are obtained, applications can be processed immediately. If objections are filed, applications are then set for hearing.

**Affidavit of Notice Served**

Re: Application for: Commingling of Production

Well Name: Connor A 1-29

Legal Location: SW SW NE Sec 29-30s-31w, Haskell Co., Ks

The undersigned hereby certifies that her/she is a duly authorized agent for the applicant, and that on the day 7<sup>th</sup> of January, 2005, a true and correct copy of the application referenced above was delivered or mailed to the following parties:

Note: A copy of this affidavit must be served as a part of the application.

Name	Address (Attach additional sheets if necessary)
John O. Farmer, Inc.	P O Box 352 370 W. Wichita Ave. Russell, KS 67665-0352
Cimerex Energy Co.	707 17th St., Suite #3300 Denver, CO 80202

**RECEIVED**  
**FEB 18 2005**  
**KCC WICHITA**

Signed this 17<sup>th</sup> day of February, 2005

Scott Hanzel  
Applicant of Duly Authorized Agent

Subscribed and sworn to before me on this 17<sup>th</sup> day of February, 2005

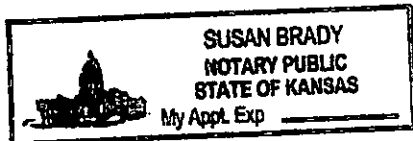

Susan Brady  
Notary Public

My Commission Expires: 11-4-07



Natural Gas • Crude Oil  
Exploration & Production

## McCOY PETROLEUM CORPORATION

8080 E. Central, Suite 300  
Wichita, Kansas 67206

316-636-2737  
316-636-2741 (Fax)

January 7, 2005

Cimarex Energy Co.  
Karen Stone  
15 East 5<sup>th</sup> Street, Suite 1000  
Tulsa, Oklahoma 74103

Re: Notice of Application for Commingling and Dual Completion  
Connor A #1-29  
SW SW NE Section 29-30S-31W  
Haskell County, Kansas

This letter is to inform you that McCoy Petroleum Corporation is making application to the Kansas Corporation Commission for approval for Commingling and Dual completion. No action is required on your part.

Please contact me if you have any questions.

Very Truly Yours,  
McCoy Petroleum Corporation

Scott Hampel  
Engineering and Production Manager

RECEIVED  
FEB 18 2005  
KCC WICHITA

Connor A#1-29

# Facilities Diagram

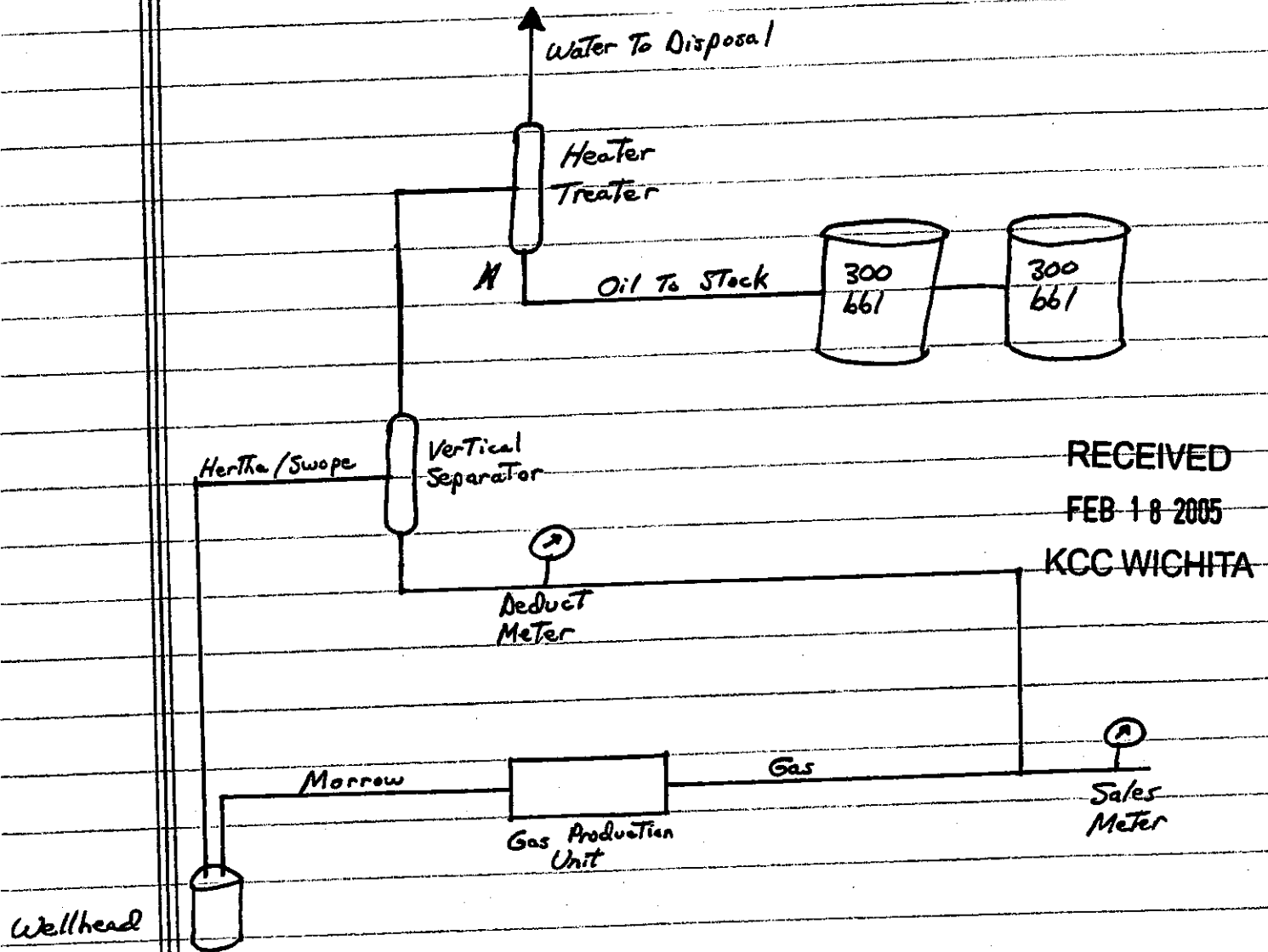

The Morrow Sand gas production will be determined by subtracting the gas volume measured at the deduct meter from the total gas volume measured at the sales meter. The commingled Hertha and Swope gas production will be measured by the deduct meter and oil production will be measured in the 300 bbl stock tanks.

# KANSAS

CORPORATION COMMISSION

KATHLEEN SEBELIUS, GOVERNOR

BRIAN J. MOLINE, CHAIR

ROBERT E. KREHBIEL, COMMISSIONER

MICHAEL C. MOFFET, COMMISSIONER

April 11, 2005

McCoy Petroleum Corporation  
8080 E. Central  
Wichita KS 67206

**RE: Commingling Application**  
**Conner "A" #1-29 SW SW NE, 29-30-31W**  
**Haskell County, Kansas API No. 15-081-21555-00-00**

Dear Operator:

Your "Application for Commingling" (ACO-4) for the above described well has been technically reviewed and approved by the Kansas Corporation Commission (KCC) per **K.A.R. 82-3-123a**. This application, which was received by the KCC on **February 18, 2005**, concerns approval to simultaneously produce from the following **two** sources of supply through the same tubing string in the same wellbore: the **SWOPE** and the **HERTHA** formations.

According to your application, the estimated current production from the **SWOPE** source of supply is **100 BOPD** and the estimated current production from the **HERTHA** source of supply is **1000 MCFGPD BOPD**. The total estimated current production from all sources of supply in the subject well is **100 BOPD** and **1000 MCFGPD**. Included in this application was operator verification that the offset operators had been formally notified of this application. No protest had been filed within the 15-day protest period, which ended **March 1, 2005**.

Based upon the depth of the **HERTHA** formation perforations, total oil production shall not exceed **200 BOPD** and total gas production shall not exceed **50%** of open flow. Docket Number **CO 020504** has been assigned to this approved application. Please use this number for well completion reports (ACO-1) and other correspondence that may concern this approved commingling.

Sincerely,



Robert Petersen

Geologist/KCC Production

DepartmentM:\PROD\Production\_Shared\Prod\_2005\AD-ORD\COMMINGLING\MCCOY\CO 020504.doc

Connor A #1-29  
SW SW NE Sec 29-30S-31W  
Haskell County, Kansas

### Wellbore Diagram

RECEIVED  
FEB 18 2005  
KCC WICHITA

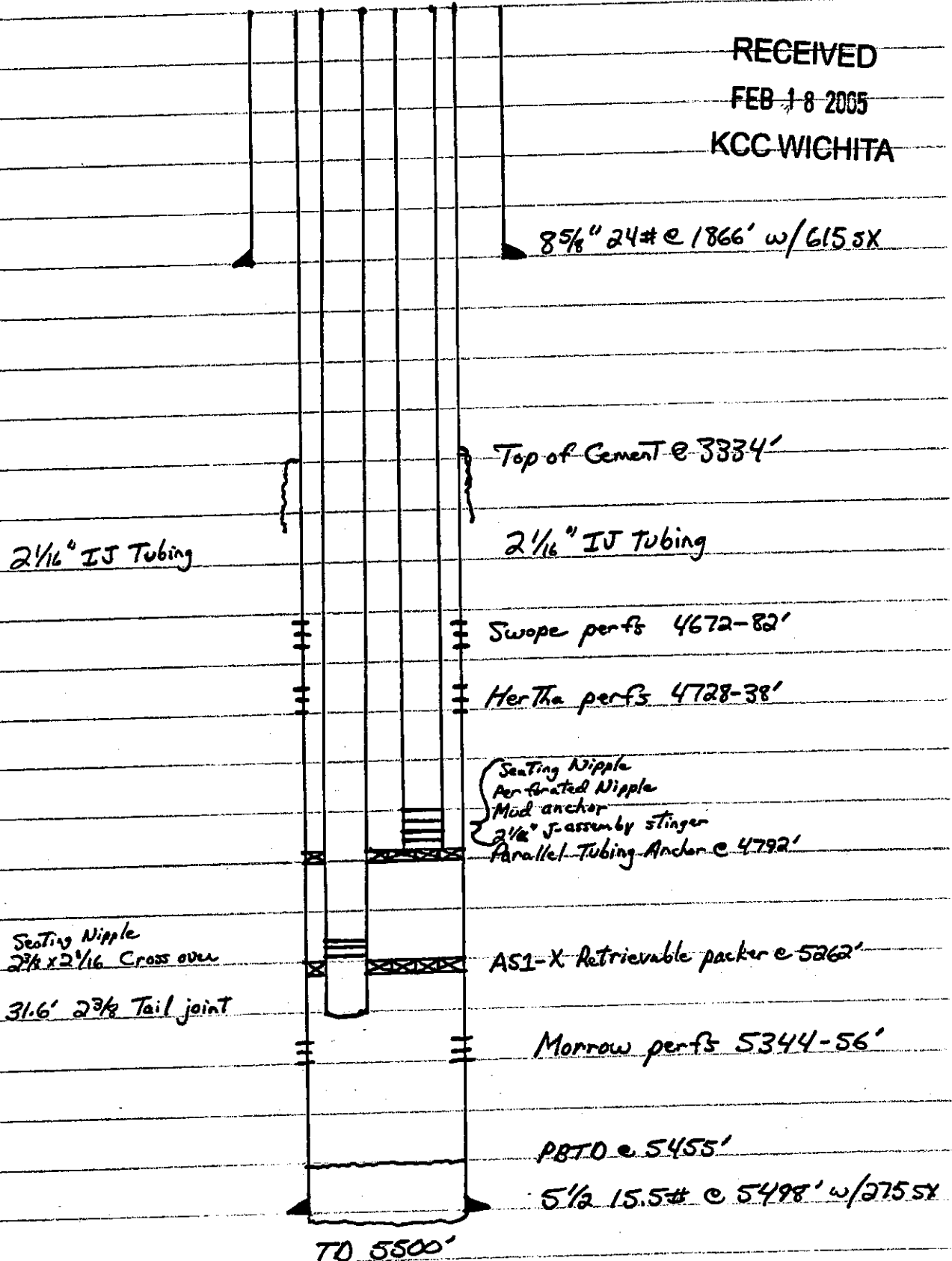

# 30S/

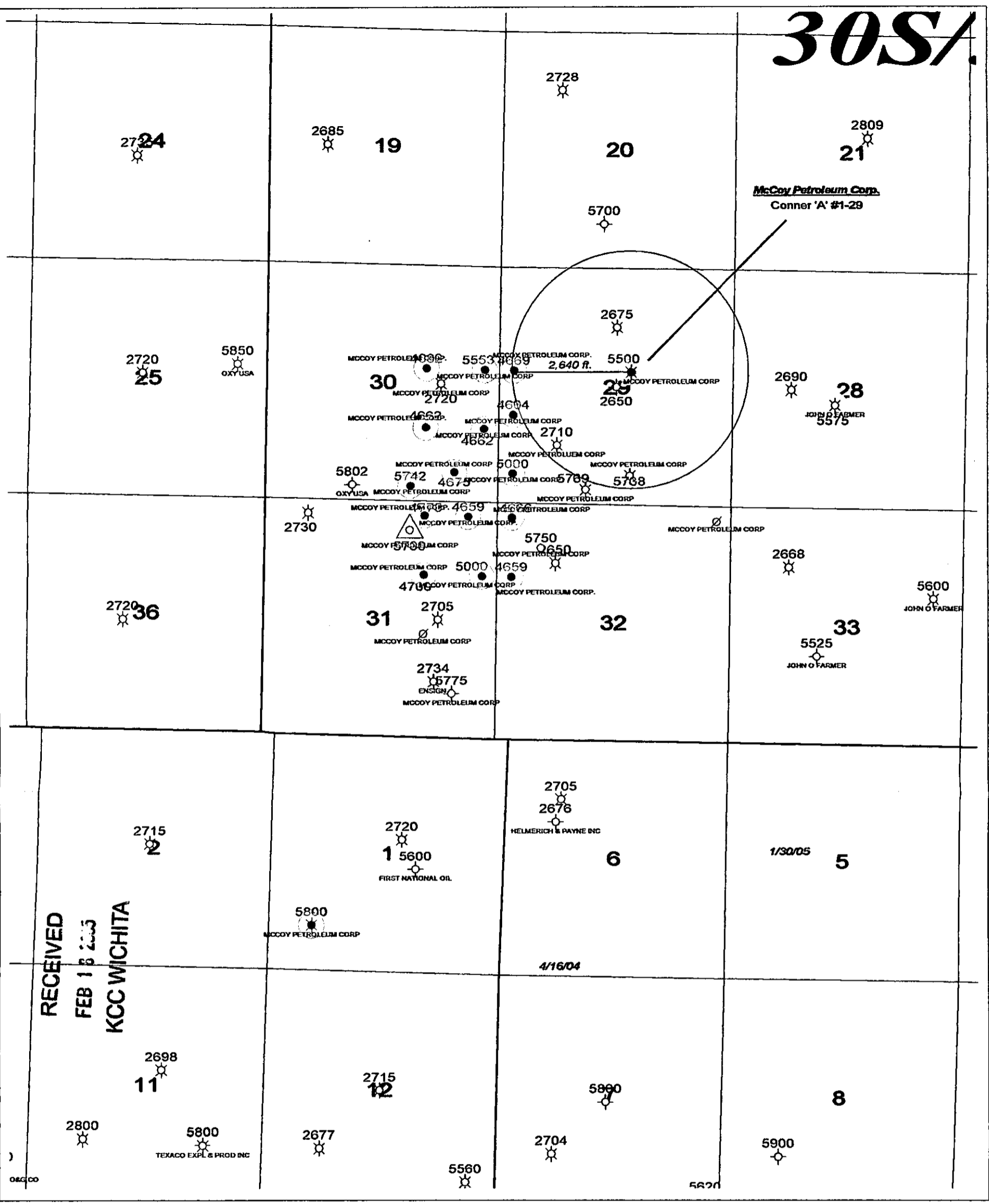

## Commingling and Dual Completion Application Map

### Legend

○ McCoy Acreage



○ Kansas City Producer



○ Morrow Producer