

ACO-5
5/88

OPERATOR McCoy Petroleum Corporation DOCKET # DC020526 DATE 2-18-05
ADDRESS 8080 E. Central, Suite 300 OPERATOR'S LICENSE # 5003
Wichita, KS 67206 API NO. 15-081-21555-0000
LEASE Connor 'A' WELL NO. 1-29
QUARTER NE SEC 29 TWP 30S RGE 31 WEST of EAST

DUAL COMPLETION 82-3-124

RECEIVED

FEB 18 2005

KCC WICHITA

1. Description of the well.
A plat showing:
a) Location of subject well.
b) Location of other wells on the lease.
c) Location of offsetting wells and operator's name.
2. Names and upper and lower limits of the source of supplies involved.
- | | | |
|-------------------------|-------------------------|--------------------|
| (NAME) <u>KC Swope</u> | (PERFS) <u>4672-82'</u> | } <u>Commingle</u> |
| (NAME) <u>KC Hertha</u> | (PERFS) <u>4728-38'</u> | |
| (NAME) <u>Morrow</u> | (PERFS) <u>5344-56'</u> | |
3. Wireline log of the subject well. (Submitted with ACO-1)
4. A complete ACO-1 form.
5. A complete description of the proposed installation including the size, weight, depth and condition of all casing and tubing, the size of all drilled holes, the amount of cement used and the tops of cement behind each casing string, the location or intended location of casing perforations, the type of packer to be used and the depth at which it is to be set. A diagram of the proposed installation shall be attached to the application.
6. Described plan for separately measuring and accounting for the production from each source of supply.
7. Description of storage facilities and a diagram of the proposed wellhead to pipeline installation.
8. Application shall be supported by an Affidavit and shall contain a certificate showing service of a copy of the application without attachments to the offsetting operators. You are responsible for this. Unless waivers are obtained, applications are held for fifteen days to give offsetting operators time to file objections. If waivers are obtained applications can be processed immediately. If objections are filed, applications are then set for hearing.
9. Operators shall notify the District Office in the area, and the operators of offset production at least 24 hours before installation of a packer.

Connor A#1-29

Facilities Diagram

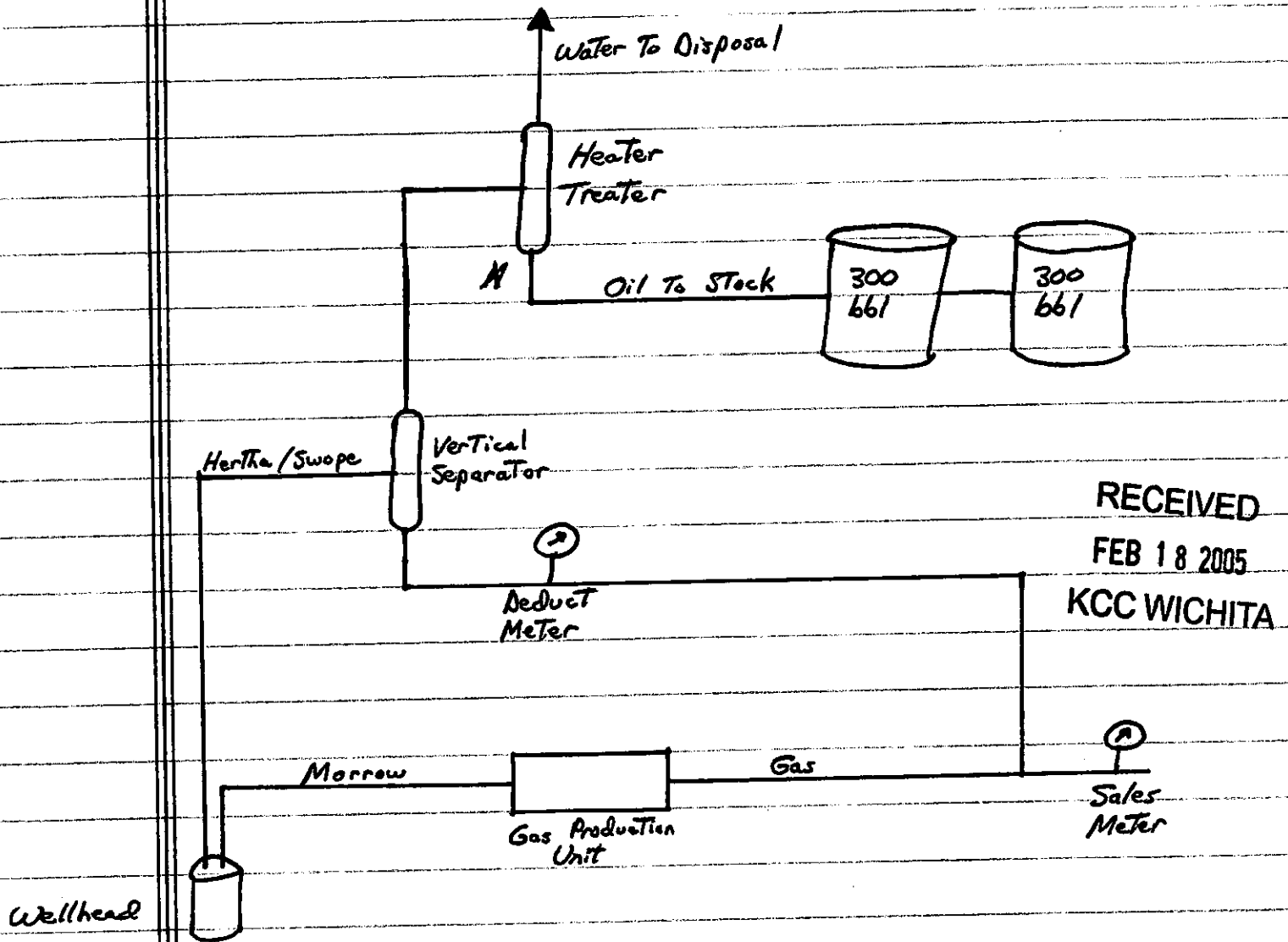

The Morrow Sand gas production will be determined by subtracting the gas volume measured at the deduct meter from the total gas volume measured at the sales meter.

The commingled Hertha and Swope gas production will be measured by the deduct meter and oil production will be measured in the 300 661 stock tanks.

Connor A #1-29
SW SW NE Sec 29-30S-31W
Haskell County, Kansas

Wellbore Diagram

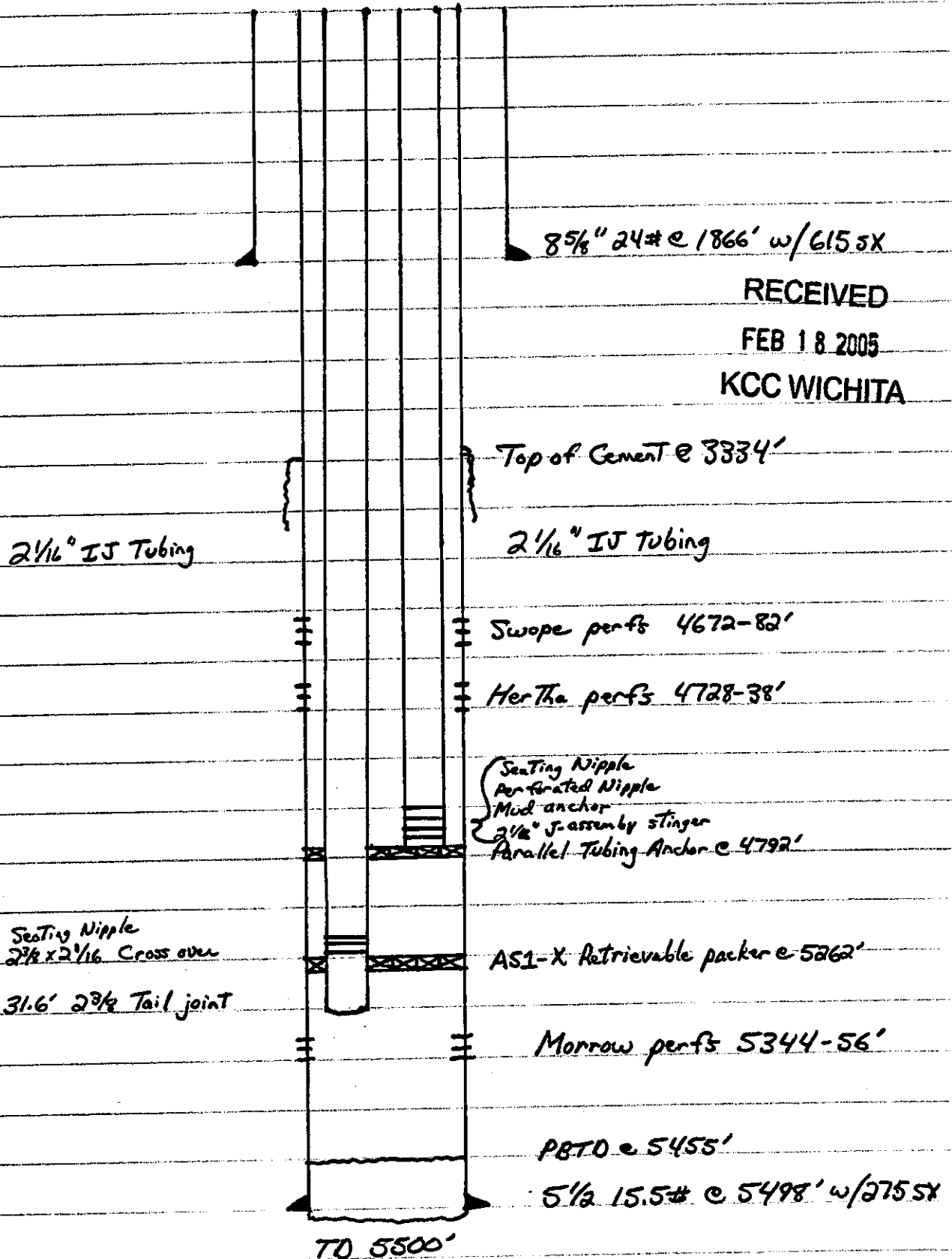

MPC

Natural Gas - Crude Oil
Exploration & Production

McCOY PETROLEUM CORPORATION

8080 E Central, Suite 300
Wichita, KS 67206

316-636-2737
316-636-2741 (Fax)

February 17, 2005

Kansas Corporation Commission
Conservation Division
Attn: Bob Petersen
130 S Market, Room 2078
Wichita, Ks 67202

Re: Commingling Application
Form ACO-4 & ACO-5
Connor A 1-29
API #15-081-21555-00-00

Dear Bob:

Enclosed please find Commingling Applications and Affidavits of Notice Served on the Connor A 1-29.

ACO-1 Completion forms and logs have already been sent to your office.
(The ACO-1 & attachments were sent on 2-17-05 also).

Let me know if you need any further information on this. Thanks for all your help!

Sincerely,



Sue Brady
Production Assistant

RECEIVED
FEB 18 2005
KCC WICHITA



Natural Gas • Crude Oil
Exploration & Production

McCoy Petroleum Corporation

8080 E. Central, Suite 300
Wichita, Kansas 67206

316-636-2737
316-636-2741 (Fax)

January 7, 2005

John O. Farmer, Inc.
P.O. Box 352
Russell, KS 67665

RECEIVED
FEB 18 2005
KCC WICHITA

Re: Notice of Application for Commingling and Dual Completion
Connor A #1-29
SW SW NE Section 29-30S-31W
Haskell County, Kansas

This letter is to inform you that McCoy Petroleum Corporation is making application to the Kansas Corporation Commission for approval for Commingling and Dual completion. No action is required on your part.

Please contact me if you have any questions.

Very Truly Yours,
McCoy Petroleum Corporation

Scott Hampel
Engineering and Production Manager

Affidavit of Notice Served

Re: Application for: Commingling of Production

Well Name: Connor A 1-29

Legal Location: SW SW NE Sec 29-30s-31w, Haskell Co., Ks

The undersigned hereby certifies that her/she is a duly authorized agent for the applicant, and that on the day 7th of January, 2005, a true and correct copy of the application referenced above was delivered or mailed to the following parties:

Note: A copy of this affidavit must be served as a part of the application.

Name

Address (Attach additional sheets if necessary)

John O. Farmer, Inc.

P O Box 352
370 W. Wichita Ave.
Russell, KS 67665-0352

Cimerex Energy Co.

707 17th St., Suite #3300
Denver, CO 80202

RECEIVED
FEB 18 2005
KCC WICHITA

Signed this 17th day of February, 2005

Scott Hanzel
Applicant of Duly Authorized Agent

Subscribed and sworn to before me on this 17th day of February, 2005

Susan Brady
Notary Public



My Commission Expires: 11-4-07

Mail to: KCC - Conservation Division, 130 S. Market - Room 2078, Wichita, Kansas 67202



Natural Gas • Crude Oil
Exploration & Production

McCOY PETROLEUM CORPORATION

8080 E. Central, Suite 300
Wichita, Kansas 67206

316-636-2737
316-636-2741 (Fax)

January 7, 2005

John O. Farmer, Inc.
P.O. Box 352
Russell, KS 67665

Re: Notice of Application for Commingling and Dual Completion
Connor A #1-29
SW SW NE Section 29-30S-31W
Haskell County, Kansas

This letter is to inform you that McCoy Petroleum Corporation is making application to the Kansas Corporation Commission for approval for Commingling and Dual completion. No action is required on your part.

Please contact me if you have any questions.

Very Truly Yours,
McCoy Petroleum Corporation

Scott Hampel
Engineering and Production Manager

RECEIVED
FEB 18 2005
KCC WICHITA



Natural Gas • Crude Oil
Exploration & Production

McCOY PETROLEUM CORPORATION

8080 E. Central, Suite 300
Wichita, Kansas 67206

316-636-2737
316-636-2741 (Fax)

January 7, 2005

Cimarex Energy Co.
Karen Stone
15 East 5th Street, Suite 1000
Tulsa, Oklahoma 74103

Re: Notice of Application for Commingling and Dual Completion
Connor A #1-29
SW SW NE Section 29-30S-31W
Haskell County, Kansas

This letter is to inform you that McCoy Petroleum Corporation is making application to the Kansas Corporation Commission for approval for Commingling and Dual completion. No action is required on your part.

Please contact me if you have any questions.

Very Truly Yours,
McCoy Petroleum Corporation

Scott Hampel
Engineering and Production Manager

RECEIVED
FEB 18 2005
KCC WICHITA

KANSAS

CORPORATION COMMISSION

KATHLEEN SEBELIUS, GOVERNOR
BRIAN J. MOLINE, CHAIR
ROBERT E. KREHBIEL, COMMISSIONER
MICHAEL C. MOFFET, COMMISSIONER

May 10, 2005

Scott Hampel
McCoy Petroleum Corporation
8080 E. Central
Wichita KS 67206

RE: **Dual Completion Conner "A" #1-29**
SW SW NE, 29-30-31W, Haskell County, Kansas
API No. 15-081-21555-00-00

Dear Mr. Hampel,

Your "Application for Dual Completion" (ACO-5) for the above described well has been technically reviewed and approved by the Kansas Corporation Commission (KCC) per **K.A.R. 82-3-124**. This application, which was received by the KCC on **February 18, 2005**, requests authority to dually complete the subject well. The application states that the **Swope** and **Hertha** formations, which are commingled together (see commingling **CO 020504**), will be produced separately from the **Morrow** through separate tubing strings. The perforations of the commingled **Hertha** and **Swope** formations are 4672' to 4682' and 4728' to 4738', respectively. The **Morrow** is perforated from 5344' to 5366'. Verification was provided that the offset operators had been formally notified of this application. No protests were received within the 15-day protest period, which ended **March 1, 2005**.

As a condition of this approval the commingled **Swope** and **Hertha** sources of supply must be measured and metered separately from the **Morrow** source of supply. Docket Number **DC 020506** has been assigned to this approved application. Please use this number for well completion reports (ACO-1) and other correspondence concerning this approved dual completion.

Sincerely,



Robert Petersen

Geologist/KCC Production

Department\MAPROD\Production_Shared\Prod_2005\AD-ORD\COMMINGLING\MCCOY\DC 020506.doc

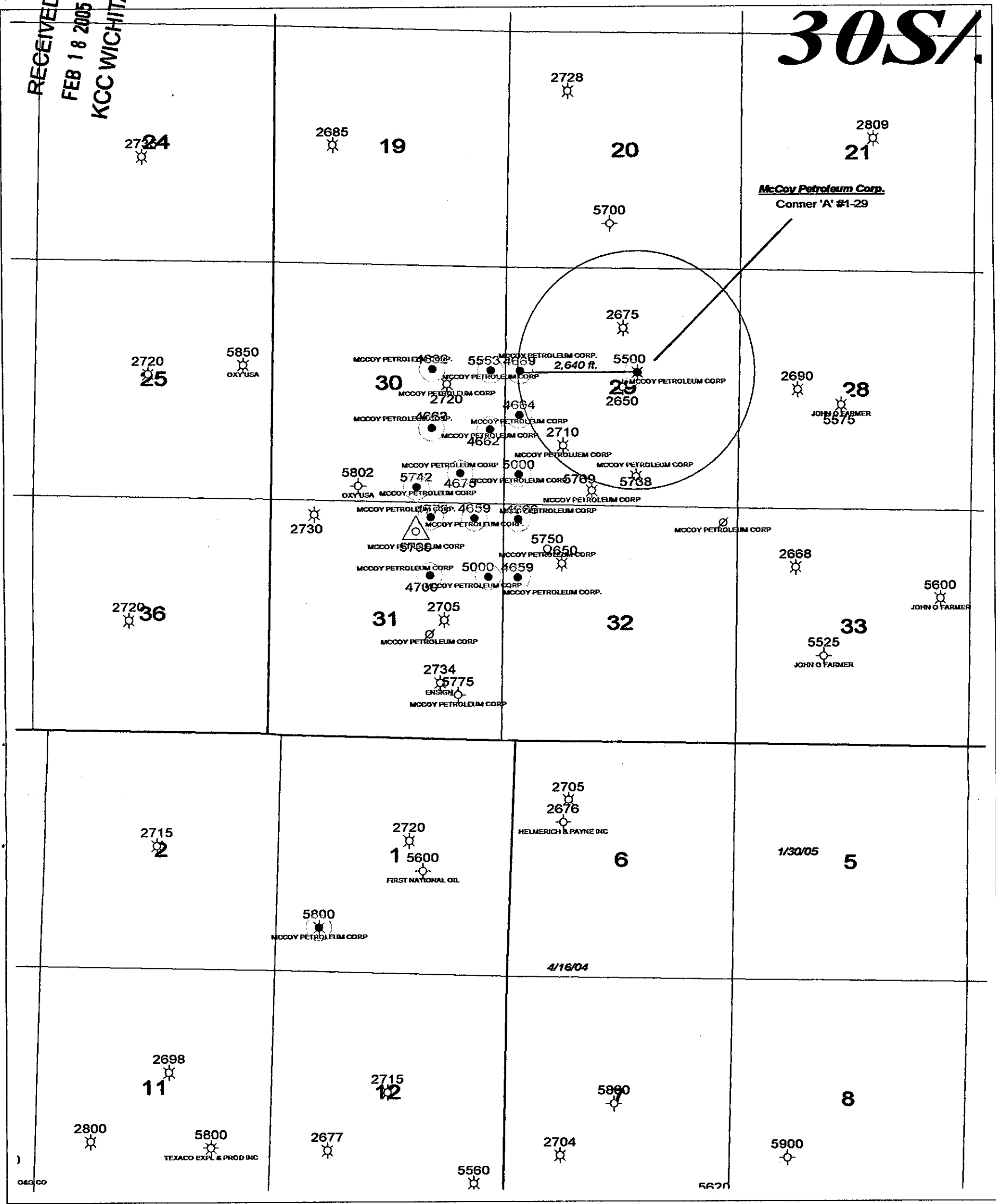

RECEIVED
 FEB 18 2005
 KCC WICHITA

30S/



**Commingling and
 Dual Completion
 Application Map**

Legend

-  **McCoy Acreage**
-  **Kansas City Producer**
-  **Morrow Producer**