

For KCC Use:
 Effective Date: 8-21-2002
 District #: 2
 SGA? Yes No

KANSAS CORPORATION COMMISSION
 OIL & GAS CONSERVATION DIVISION

RECEIVED
 AUG 02 2002
 KCC WICHITA

Form C-1
 September 1999
 Form must be Typed
 Form must be Signed
 All blanks must be Filled

NOTICE OF INTENT TO DRILL

Must be approved by KCC five (5) days prior to commencing well 8-2-02

Expected Spud Date August 12 2002
 month day year

Spot S2 N2 NE Sec 21 Twp. 31 S. R. 8 East West
990' fml feet from 1 (circle one) Line of Section
1320' fel feet from 1 (circle one) Line of Section
 Is SECTION XX Regular Irregular?

OPERATOR: License# 5003
 Name: McCoy Petroleum Corporation
 Address: P.O. Box 780208
 City/State/Zip: Wichita, KS 67278-0208
 Contact Person: Scott Hampel
 Phone: (316) 636-2737

(Note: Locate well on the Section Plat on reverse side)
 County: Harper
 Lease Name: Dombaugh Well #: 2-21
 Field Name: Spivey-Grabs

CONTRACTOR: License# 5142
 Name: Sterling Drilling Co.

Is this a Prorated / Spaced Field? Yes No
 Target Information(s): Mississippian
 Nearest Lease or unit boundary: 990' fwl
 Ground Surface Elevation: 1595' feet MSL
 Water well within One-quarter mile: Yes No
 Public water supply well within one mile: Yes No
 Depth to bottom of fresh water: 150
 Depth to bottom of usable water: 180
 Surface Pipe by Alternate: XX 1 2
 Length of Surface Pipe Planned to be set: 250'
 Length of Conductor Pipe required: None
 Projected Total Depth: 4450'
 Producing Formation Target: Mississippian

Well Drilled For: Oil Enh Rec Infield Mud Rotary
 Gas Storage Pool Ext Air Rotary
 OWWO Disposal Wildcat Cable
 Seismic; # of Holes Other
 Other

If OWWO: old well information as follows:
 Operator: _____
 Well Name: _____
 Original Completion Date: _____ Original Total Depth: _____

Directional, Deviated or Horizontal wellbore? Yes No
 If Yes, true vertical depth: _____
 Bottom Hole Location: _____
 KCC DKT #: _____

Water Source for Drilling Operations:
 Well Farm Pond: Other:
 DWR Permit #: _____
 (Note: Apply for Permit with DWR)
 Will Cores be taken? Yes No
 If Yes, proposed zone: _____

AFFIDAVIT

The undersigned hereby affirms that the drilling, completion and eventual plugging of this well will comply with K.S.A. 55-101, et. seq.
 It is agreed that the following minimum requirements will be met:

1. Notify the appropriate district office *prior* to spudding of well;
2. A copy of the approved notice of intent to drill *shall be* posted on each drilling rig;
3. The minimum amount of surface pipe as specified below *shall be set* by circulating cement to the top; in all cases surface pipe *shall be set* through all unconsolidated materials plus a minimum of 20 feet into the underlying formation.
4. If the well is dry hole, an agreement between the operator and the district office on plug length and placement is necessary *prior to plugging*;
5. The appropriate district office will be notified before well is either plugged or production casing is cemented in;
6. If an ALTERNATE 11 COMPLETION, production pipe shall be cemented from below any usable water to surface within **120 days** of spud date. *In all cases, NOTIFY district office* prior to any cementing.

I hereby certify that the statements made herein are true and to the best of my knowledge and belief.

Date: 7/30/02 Signature of Operator or Agent: Scott Hampel Title: Engineer

For KCC Use ONLY
 API # 15 - 077-21432-00-00
 Conductor pipe required NONE feet
 Minimum surface pipe required 200 feet per Alt 1
 Approved by: RJP 8-16-02
 This authorization expires: 2-16-03
 (This authorization void if drilling not started within 6 months of effective date.)
 Spud date: _____ Agent: _____

Remember to -

- File Drill Pit Application (form CDP-1) with Intent to Drill;
- File Completion Form ACO-1 within 120 days of spud date;
- File acreage attribution plat according to field proration orders;
- Notify appropriate district office 48 hours prior to workover or re-entry;
- Submit plugging report (CP-4) after plugging is completed;
- Obtain written approval before disposing or injecting salt water.

21318W

IN ALL CASES PLOT THE INTENDED WELL ON THE PLAT BELOW

Plat of acreage attributable to a well in a prorated or spaced field

If the intended well is in a prorated or spaced field, please fully complete this side of the form. If the intended well is in a prorated or spaced field complete the plat below showing that the well will be properly located in relationship to other wells producing from the common source of supply. Please show all the wells and within 1 mile of the boundaries of the proposed acreage attribution unit for gas wells and within 1/2 mile of the boundaries of the proposed acreage attribution unit for oil wells.

API No. 15 - _____
 Operator: McCoy Petroleum Corp.
 Lease: Dombaugh
 Well Number: 2-11
 Field: Spivey Grabs

Location of Well: County: Kingman
990' fl feet from S (N circle one) Line of Section
1320' fel feet from E (W circle one) Line of Section
 Sec 21 Twp 31 S. R. 8 East West

Number of Acres attributable to well: _____
 QTR / QTR / QTR of acreage: S2 - N2 - NE

Is Section XX Regular or _____ Irregular
 If Section is Irregular, locate well from nearest corner boundary.
 Section corner used: NE NW - SE SW

PLAT

*(Show location of the well and shade attributable acreage for prorated or spaced wells)
 (Show footage to the nearest lease or unit boundary fine.)*

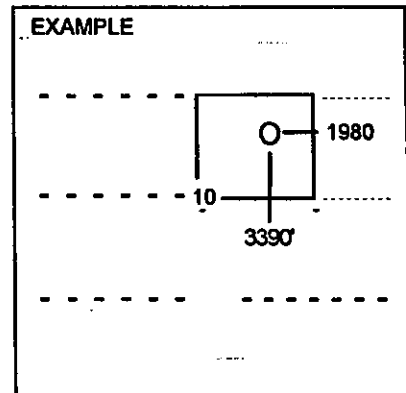
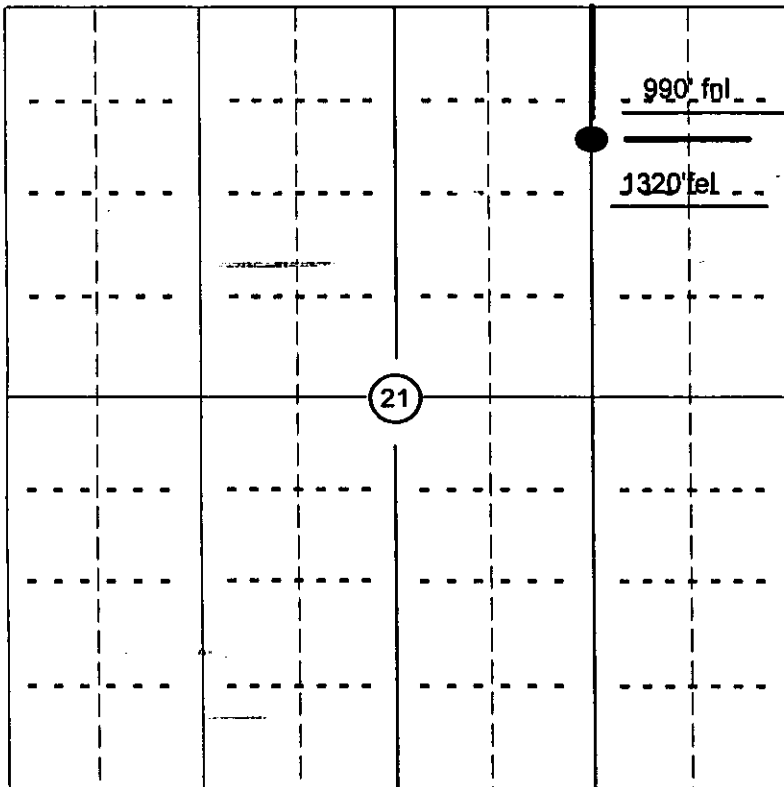

SEWARDCO.

NOTE., In all cases locate the spot of the proposed drilling location.

In plotting the proposed location of the well, you must show.

1. The manner in which you are using the depicted plat by identifying section lines, i.e. 1 section, 1 section with 8 surrounding sections, 4 sections, etc.
2. The distance of the proposed drilling location from the section's south / north and east / west.
3. The distance to the nearest lease or unit boundary line.
4. If proposed location is located within a prorated or spaced field a certificate of acreage attribution plat must be attached: (CO-7 for oil wells; CG-8 for gas wells).