

FOR KCC USE:

EFFECTIVE DATE: 10-13-92
DISTRICT # 2
SEAL: C. V. ...

State of Kansas
NOTICE OF INTENTION TO DRILL

FORM C-1 7/91
FORM MUST BE TYPED
FORM MUST BE STORED
ALL BLANKS MUST BE FILLED

Must be approved by the K.C.C. five (5) days prior to commencing well

Expected Spud Date 10 08 92
month day year

Spot N/2 NE NE Sec 21 Twp 31 S. Rg. 8 East
West

OPERATOR: License # 6581
Name: Rison Energy Corporation
Address: 9320 East Central
City/State/Zip: Wichita, KS 67206
Contact Person: C. J. Lett, III
Phone: (316) 636-1801
CONTRACTOR: License # 6039
Name: L. P. Drilling, Inc.

4950 feet from South / North line of Section
660 feet from East / West line of Section
IS SECTION X REGULAR IRREGULAR?

(NOTE: Locate well on the Section Plat on Reverse Side)

County: Harper
Lease Name: Dombaugh Well #: 1-21
Field Name: Spivey-Grabs
Is this a Prorated/Spaced Field? X yes no
Target Formation(s): Mississippian
Nearest lease or unit boundary: 330'
Ground Surface Elevation: N/14 feet MSL
Water well within one-quarter mile: yes X no
Public water supply well within one mile: yes X no
Depth to bottom of fresh water: 100'
Depth to bottom of usable water: 180'
Surface Pipe by Alternate: X 1 2
Length of Surface Pipe Planned to be set: 200'
Length of Conductor pipe required: 0
Projected Total Depth: 4450'
Formation at Total Depth: Mississippian
Water Source for Drilling Operations:
well farm pond X other
DWR Permit #:
Will Cores Be Taken?: yes X no
If yes, proposed zone:

Well Drilled For: Well Class: Type Equipment:
X Oil ... Enh Rec X Infield X Mud Rotary
... Gas ... Storage ... Pool Ext. ... Air Rotary
... OAWD ... Disposal ... Wildcat ... Cable
... Seismic; ... # of Holes ... Other
If OAWD: old well information as follows:
Operator:
Well Name:
Comp. Date: Old Total Depth

Directional, Deviated or Horizontal wellbore? yes X no
If yes, true vertical depth:
Bottom Hole Location:

AFFIDAVIT

40 Acre Docket No. 52 323-C

The undersigned hereby affirms that the drilling, completion and eventual plugging of this well will comply with K.S.A. 55-101, et. seq.

It is agreed that the following minimum requirements will be met:

- 1. Notify the appropriate district office prior to spudding of well;
- 2. A copy of the approved notice of intent to drill shall be posted on each drilling rig;
- 3. The minimum amount of surface pipe as specified below shall be set by circulating cement to the top; in all cases surface pipe shall be set through all unconsolidated materials plus a minimum of 20 feet into the underlying formation;
- 4. If the well is dry hole, an agreement between the operator and the district office on plug length and placement is necessary prior to plugging;
- 5. The appropriate district office will be notified before well is either plugged or production casing is cemented in;
- 6. IF AN ALTERNATE II COMPLETION, PRODUCTION PIPE SHALL BE CEMENTED FROM BELOW ANY USABLE WATER TO SURFACE WITHIN 120 DAYS OF SPUD DATE. IN ALL CASES, NOTIFY DISTRICT OFFICE PRIOR TO ANY CEMENTING.

I hereby certify that the statements made herein are true and to the best of my knowledge and belief.

Date: 9-30-92 Signature of Operator or Agent: C. J. Lett, III Title: President

FOR KCC USE:
API # 15- 077-21262-0000
Conductor pipe required None feet
Minimum surface pipe required 200 feet per Alt. (3) X
Approved by: C.B. 10-8-92
This authorization expires: 4-8-93
(This authorization void if drilling not started within 6 months of effective date.)
Spud date: Agent:

REMEMBER TO:

- File Drill Pit Application (form CDP-1) with Intent to Drill;
- File Completion Form ACD-1 within 120 days of spud date;
- File acreage attribution plat according to field proration orders;
- Notify appropriate district office 48 hours prior to workover or re-entry;
- Submit plugging report (CP-4) after plugging is completed;
- Obtain written approval before disposing or injecting salt water.

Mail to: Conservation Division, 208 Colorado Derby Building, 202 W. First St., Wichita, Kansas 67202

RECEIVED
STATE CORPORATION COMMISSION
OCT 10-1-1992
CONSERVATION DIVISION
Wichita, Kansas

IN ALL CASES PLOT THE INTENDED WELL ON THE PLAT BELOW

PLAT OF ACREAGE ATTRIBUTABLE TO A WELL IN A PRORATED OR SPACED FIELD

If the intended well is in a prorated or spaced field, please fully complete this side of the form. If the intended well is in a prorated or spaced field complete the plat below showing that the well will be properly located in relationship to other wells producing from the common source of supply. Please show all the wells within 1 mile of the boundaries of the proposed acreage attribution unit for gas wells and within 1/2 mile of the boundaries of the proposed acreage attribution unit for oil wells.

API NO. 15- _____
 OPERATOR Bison Energy Corporation LOCATION OF WELL: COUNTY Harper
 LEASE Dombaugh 4950 feet from south/north line of section
 WELL NUMBER 1-21 660 feet from east/west line of section
 FIELD Spivey-Grabs SECTION 21 TWP 31S RG 8W

NUMBER OF ACRES ATTRIBUTABLE TO WELL 40 IS SECTION x REGULAR or _____ IRREGULAR
 QTR/QTR/QTR OF ACREAGE N/2 - NE - NE IF SECTION IS IRREGULAR, LOCATE WELL FROM NEAREST CORNER BOUNDARY.

Section corner used: _____ NE _____ NW _____ SE _____ SW

PLAT

(Show location of the well and shade attributable acreage for prorated or spaced wells.)
 (Show footage to the nearest lease or unit boundary line.)

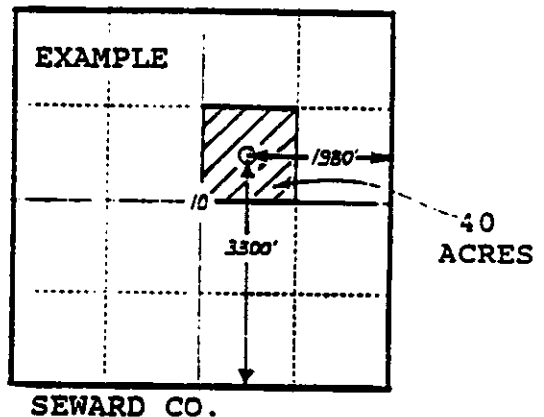
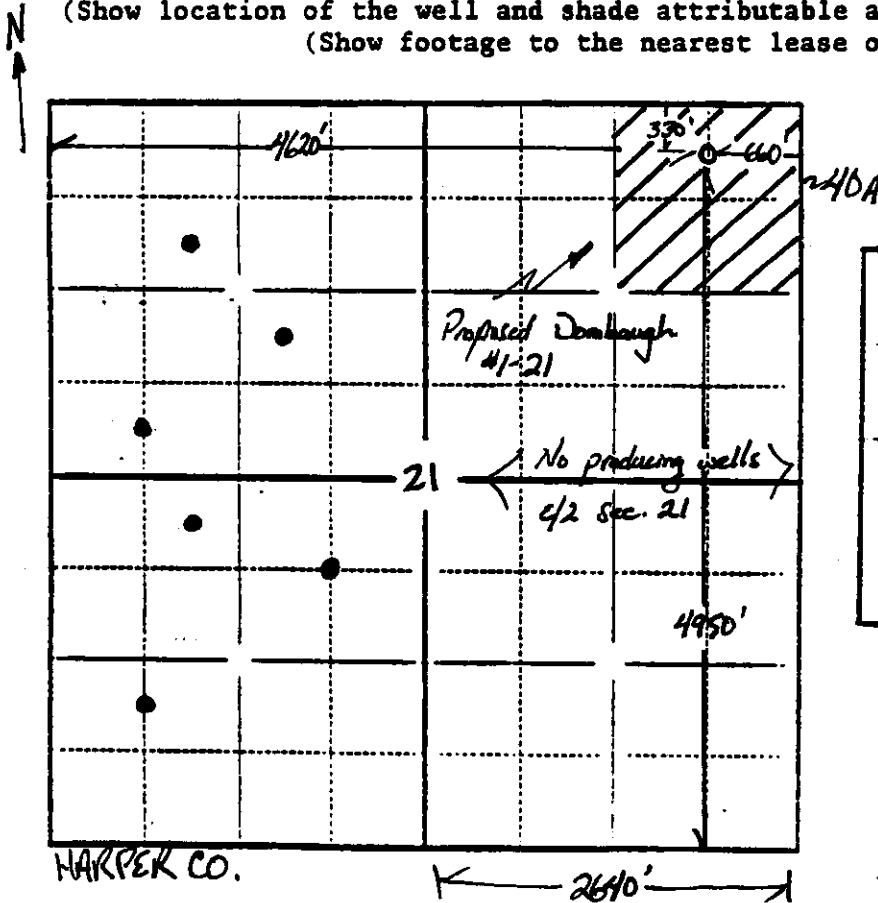

In plotting the proposed location of the well, you must show:

- 1) The manner in which you are using the depicted plat by identifying section lines, i.e. 1 section, 1 section with 8 surrounding sections, 4 sections, etc.;
- 2) the distance of the proposed drilling location from the section's south/north and east/west lines; and
- 3) the distance to the nearest lease or unit boundary line.