

ORIGINAL
SIDE ONE

STATE CORPORATION COMMISSION OF KANSAS
OIL & GAS CONSERVATION DIVISION
WELL COMPLETION FORM
ACO-1 WELL HISTORY
DESCRIPTION OF WELL AND LEASE

API NO. 15- 185-11169-0000
County Stafford
C SW NW Sec. 7 Twp. 22 Rge. 12 East West
680 1760 FNL Per T-1
Ft. North from Southeast Corner of Section
3960 607 FNL
Ft. West from Southeast Corner of Section
(NOTE: Locate well in section plat below.)

Operator: License # 5229
Name: Phillips Petroleum Company
Address Route #3, Box 20-A
City/State/Zip Great Bend, KS 67530

Lease Name Hitz Well # 2
Field Name Drach
Producing Formation Arbuckle
Elevation: Ground 1875 KB 1877
Total Depth 3669 PBSD None

Purchaser: _____
Operator Contact Person: J. W. Taylor
Phone (316) 793-8421
Contractor: Name: _____
License: _____
Wellsite Geologist: _____

Designate Type of Completion
 New Well Re-Entry Workover
 Oil SWD Temp. Abd. 1-28-91
 Gas Inj Delayed Comp. 2-8-1991
 Dry Other (Core, Water Supply, etc.)

If OWO: old well info as follows:
Operator: _____
Well Name: _____
Comp. Date _____ Old Total Depth _____

Drilling Method:
 Mud Rotary Air Rotary Cable
06-04-43 06-19-43 06-30-43
Spud Date Date Reached TD Completion Date

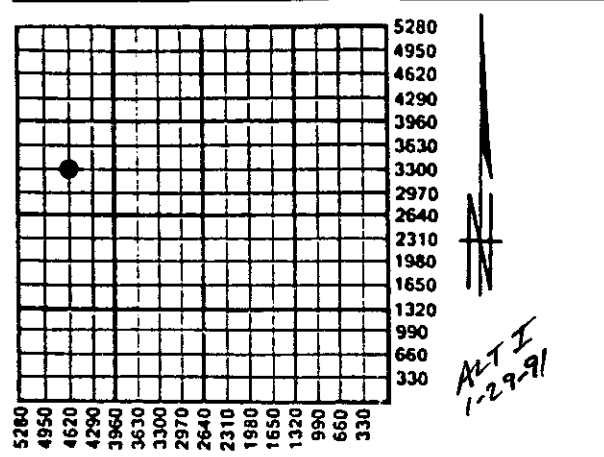

Amount of Surface Pipe Set and Cemented at 428 Feet
Multiple Stage Cementing Collar Used? Yes No
If yes, show depth set _____ Feet
If Alternate II completion, cement circulated from _____
feet depth to _____ w/ _____ sx cmt.

INSTRUCTIONS: This form shall be completed in triplicate and filed with the Kansas Corporation Commission, 200 Colorado Derby Building, Wichita, Kansas 67202, within 120 days of the spud date of any well. Rule 82-3-130, 82-3-107 and 82-3-106 apply. Information on side two of this form will be held confidential for a period of 12 months if requested in writing and submitted with the form. See rule 82-3-107 for confidentiality in excess of 12 months. One copy of all wireline logs and drillers time log shall be attached with this form. ALL CEMENTING TICKETS MUST BE ATTACHED. Submit CP-4 form with all plugged wells. Submit CP-111 form with all temporarily abandoned wells. Any recompletion, workover or conversion of a well requires filing of ACO-2 within 120 days from commencement date of such work.

All requirements of the statutes, rules and regulations promulgated to regulate the oil and gas industry have been fully complied with and the statements herein are complete and correct to the best of my knowledge.

Signature J.W. Taylor
Title District Superintendent Date 01-24-91
Subscribed and sworn to before me this 24 day of January,
19 91.
Notary Public Carla M. Yahne
Date Commission Expires 10-23-92

K.C.C. OFFICE USE ONLY
F Letter of Confidentiality Attached
C Wireline Log Received
C Drillers Timelog Received

Distribution
 KCC SWD/Rep NGPA
 KGS Plug Other
(Specify)



15-185-11169-0000

SIDE TWO

Operator Name Phillips Petroleum Company Lease Name Hitz Well # 2
 Sec. 7 Twp. 22 Rge. 12 East West
 County Stafford

INSTRUCTIONS: Show important tops and base of formations penetrated. Detail all cores. Report all drill stem tests giving interval tested, time tool open and closed, flowing and shut-in pressures, whether shut-in pressure reached static level, hydrostatic pressures, bottom hole temperature, fluid recovery, and flow rates if gas to surface during test. Attach extra sheet if more space is needed. Attach copy of log.

Drill Stem Tests Taken Yes No
 (Attach Additional Sheets.)
 Samples Sent to Geological Survey Yes No
 Cores Taken Yes No
 Electric Log Run Yes No
 (Submit Copy.)
 See Attached Formation Record

Formation Description
 Log Sample
 Name Top Bottom
 See Attached Formation Record

CASING RECORD New Used
 Report all strings set-conductor, surface, intermediate, production, etc.

Purpose of String	Size Hole Drilled	Size Casing Set (In O.D.)	Weight Lbs./Ft.	Setting Depth	Type of Cement	# Sacks Used	Type and Percent Additives
Surface	12 1/4"	8 5/8"	28#	428'		200	200# Flocele
Production	7 7/8"	5 1/2"	14#	3661'		200	200# CC 100# Flocele

Shots Per Foot	PERFORATION RECORD Specify Footage of Each Interval Perforated	Acid, Fracture, Shot, Cement Squeeze Record (Amount and Kind of Material Used)	Depth
OH	3661-69	300 gals Dowell XX acid	

TUBING RECORD Size 2 1/2" Set At 3661 Packer At _____
 Liner Run Yes No

Date of First Production 06-30-43 Producing Method Flowing Pumping Gas Lift Other (Explain)

Estimated Production Per 24 Hours	Oil Bbls.	Gas Mcf	Water Bbls.	Gas-Oil Ratio	Gravity
	162.79		0		

Disposition of Gas: Vented Sold Used on Lease (If vented, submit ACO-18.)
 METHOD OF COMPLETION: Open Hole Perforation Dually Completed Commingled
 Other (Specify) _____

DAILY REPORT DETAILED

ORIGINAL

GROUP 1875
DF 1877

15-185-11169-0000

LEASE F. Hitz

WELL NO. 2

DATE	TOTAL DEPTH	NATURE OF WORK PERFORMED
<u>May</u> 20		Location staked 660' from south line and 385' from west line of Sec. 7-22S-12W, Stafford County Kansas, by J.M.Nye and A.L.Rhodes.
21		Location change to 660' from south line and 660' from west line.
22-25 Inc.		Waiting on Rotary.
26		Moving in derrick.
27		Moving in material and build derrick.
28-29-30-31		Rigging up (One crew only).
<u>June</u> 1-2-3		Rigging up (One crew only).
4	430	Spudded 12:01 AM. Set 8 5/8" casing @ 428' in Red Bed w/200 sax cement, 200# flocele, and 200# calcium chloride. Plug pumped to 418' @ 11:00 PM. Had cement returns to cellar.
5	430	Waiting on cement.
6	1200	Drilling shale and shells.
7	1855	Drilling lime and shale.
8	2125	Drilling lime and shale.
9	2420	Drilling shale and shells.
10	2605	Drilling lime and shale.
11	2855	Drilling lime and shale.
12	3070	Drilling lime and shale.
13	3075	Drilling lime.
14	3330	Drilling lime and shale.
15	3476	Drilling lime. Top LKO 3351'.
16	3635	Drilling chert and shale. Top Viola 3557'. Top Simpson 3605'.
17	3669	Reached a total depth of 3669' - Top of Arbuckle 3661'. Started running casing @ 8:30 PM.
18	3669	Set 5 1/2" casing @ 3661' on top of Arbuckle. Cemented w/200 sax cement and 100# flocele. Pumped plug to 3616' @ 1:20 AM. Tore down rotary rig.
19	3669	Setting in cable tool front and rigging up.
20	3669	Rigging up and started bailing.
21	3669	Bailed mud and drilled cement. Drilled plug @ 9:50 PM. At 9:50 PM had 1500' OIH. At 10:00 PM had 2000' OIH. At 10:20 PM had 3300' OIH. At 11:30 PM had 3400' OIH. Started rigging up to take swab test.
22	3669	Had 3528' OIH. From 10:10 AM to 11:10 AM swabbed from top, making 64.50 BO. Swabbed 41.76 BO from 11:10 AM to 11:55 AM down to 1680' from top. SD 15 minutes w/clutch trouble, and filled 240' or 1440' from top. SD to 12:50 PM. From 12:50 PM to 1:30 PM swabbed 49.84 BO down to 1920' from top. From 1:30 PM to 2:00 PM swabbed 37.44 BO. From 2:00 PM to 2:40 hole filled to 700' from top. Down from 2:40 PM until 3:15 PM emptying swab tank. From 3:15 to 4:15 swabbed 63.36 BO, 1720' from top. 4:15 to 4:56 swabbed 30.24 BO, established fluid level @ 1520'. From 4:56 to 5:56 PM swabbed 51.12 BO, 1520' from top. Swabbed a total of 338.06 BO in 5 hrs. and 21 minutes.

1943

JAN 28 1951

DAILY REPORT DETAILED

15-185-11169-0000

ORIGINAL

LEASE.....

WELL NO.....

<u>DATE</u>	<u>TOTAL DEPTH</u>	<u>NATURE OF WORK PREFORMED</u>
23	3669	Tearing down tools.
24	3669	Taking down rig.
25	3669	Ran pumping unit block.
26-27	3669	Set pumping unit.
28	3669	Waiting to run tbg.
29	3669	Ran tubing. Acidized w/500 gallons of Dowell XX Acid. Maximum casing pressure 500#. Maximum tubing pressure 250#. Net oil used 22.4 bbls. Set pump @ 3661'. Perforations 3662' to 3666'. Started pump pretest @ 10:00 PM.
30	3669	Finished pretest @ 7:35 AM. Pumped a total of 233 BO during test. Official Draw down Potential started @ 7:35 AM. 1st. point 7:35 AM until 10:35 AM, pumped 73.03 BO @ 20-34" SPH. Pumped down 578' from top. 2nd. point 10:54 until 1:54 PM pumped 54.92 BO @ 16-34" SPH. Pumped down 497' from top. 3rd. point 2:40 PM until 5:40 PM pumped 34.84 BO @ 10 1/2-34" SPH. Pumped down 398' from top. Total of 162.79 BO pumped during 9 hour test. <u>OFFICIAL DEPTHOGRAPH DRAW DOWN POTENTIAL: 3669 BO and no water.</u> Complets 6-30-45

JAN 28 1951

ORIGINAL

Formation Record

15-185-11169-0000

Lease **F. Hitz**

Well No. 2

FROM	TO	Formation	REMARKS
------	----	-----------	---------

0	263	Sand	<u>Elevation 1877' Derrick Floor</u>
263	298	Sand and Red Bed	
298	428	Red Bed	
428	703	Red Rock	
703	1198	Shale and shells	Set 8 5/8" csg. @ 428' on top of Red Rock w/200 sax cement.
1198	1498	Shale and Red Rock	
1498	1953	Lime and shale	
1953	2053	Lime	
2053	2233	Lime and shale	
2233	2418	Shale and shells	
2418	2423	Lime	
2423	2938	Lime and shale	
2938	2993	Lime	
2993	3068	Lime and shale	
3068	3073	Lime	Top LKC 3331'
3073	3108	Shale	
3108	3203	Lime	
3203	3328	Lime and shale	
3328	3474	Lime	
3474	3553	Lime and shale	
3553	3587	Lime and chert	
3587	3653	Chert and shale	
3653	3661	Shale	
3661	3669	Lime	
			Top Viola 3557'
			Top Simpson 3603'
			Top Artuckle 3661'
			Set 5 1/2" Casing @ 3661' w/200 sax
			Official Depthograph Draw Down
			Potential of 5989 BO and no water
			after acid treatment of 300 gallons.

JAN 28 1991



15-185-11169-0000

TUBULAR RECORD

LEASE **F. Hitz**

WELL NO. **2**

CASING RECORD

Size	Weight	Threads	Cond.	Make	Grade	Amt. Set	Where Set	Date Set	Type Shoe	Size of Hole	Amt. Pulled	Shot or Ripped	Date Pulled
8 5/8"	28#	8V	B	LW		424	428'	6-4-43	Reg.	12 1/2"	None		
5 1/2"	14#	8R	A	SS	H-40	3657'	3661'	6-18-43	Baker	7 7/8"	None		

JAN 29 1955

TUBING RECORD (Initial Installation Only)

Size	Weight	Threads	Cond.	Make	Upset-Plain	Range	No. Joints	Where Set Pump	Date Run	Perforations		Amt. Pulled	Date Pulled
										From	To		
2 1/2"	6.40	10R	A	SS	Plain	2	115	3661	6-29-43	3662	3666		

LINER RECORD

Size	Weight	Threads	Cond.	Make	Type	Grade	Date Set	Amt. Set	Top	How Sealed	Bottom	Perforations		Amt. Pulled	Date Pulled
												From	To		

SCREEN RECORD

SCREEN							SCREEN PACKER								
Size	Weight	Make	Length	Gauge	Screen Set		B. P. Valve	Shoe	Date Set	Size	Make	Type	Length	Packer Set	
					From	To								From	To

CASING PACKER RECORD

Date Set	Make	Type	Rubber Lgth.	Size of Pipe	Size of Hole	Set At	Remarks
----------	------	------	--------------	--------------	--------------	--------	---------

ORIGINAL