

ORIGINAL

CONFIDENTIAL

RELEASED SIDE ONE

STATE CORPORATION COMMISSION OF KANSAS  
OIL & GAS CONSERVATION DIVISION  
WELL COMPLETION FORM  
ACO-1 WELL HISTORY  
DESCRIPTION OF WELL AND LEASE

API NO. 15- 077-21,234-6000

MAY 20 1991

County Harpur  
Approx. W/2 SE NE Sec. 29 Twp. 31 Rge. 8  East  West

FROM CONFIDENTIAL

Operator: License # 6581

3480' Ft. North from Southeast Corner of Section

Name: Bison Energy Corp.

990' Ft. West from Southeast Corner of Section  
(NOTE: Locate well in section plat below.)

Address P.O. Box 782317

Lease Name Wiley Well # 2A-29

City/State/Zip Wichita, KS 67278

Field Name Spivey-Grabs

Purchaser: Koch Oil

Producing Formation Mississippi

Operator Contact Person: C. J. Lett III

Elevation: Ground 1578 KB 1587

Phone (316) 689-8393

Total Depth 4457 PBDT

Contractor: Name: Lobo Drilling Company

License: 5864

Wellsite Geologist: Dean Pattisson

Designate Type of Completion  
 New Well  Re-Entry  Workover

Oil  SWD  Temp. Abd.  
 Gas  Inj  Delayed Comp.  
 Dry  Other (Core, Water Supply, etc.)

If OMO: old well info as follows:  
Operator: \_\_\_\_\_

Well Name: \_\_\_\_\_

Comp. Date \_\_\_\_\_ Old Total Depth \_\_\_\_\_

Drilling Method:  
 Mud Rotary  Air Rotary  Cable

1-25-91 2-1-91  
Spud Date Date Reached TD Completion Date

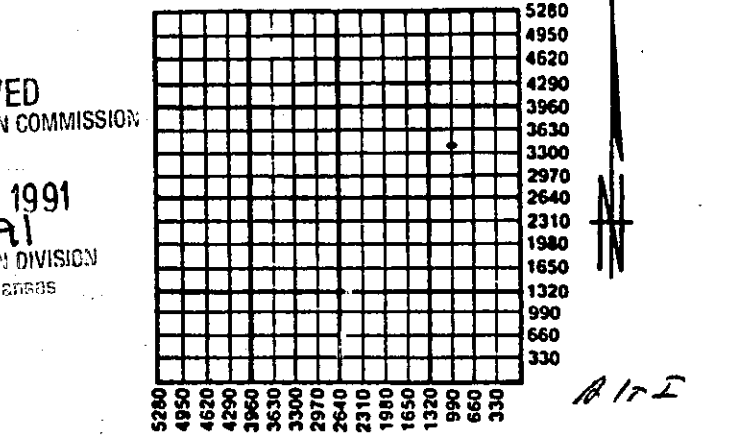

Amount of Surface Pipe Set and Cemented at 218' Feet

Multiple Stage Cementing Collar Used?  Yes  No

If yes, show depth set \_\_\_\_\_ Feet

If Alternate II completion, cement circulated from \_\_\_\_\_

feet depth to \_\_\_\_\_ w/ \_\_\_\_\_ sx cmt.

RECEIVED  
STATE CORPORATION COMMISSION

APR 02 1991  
4-2-91

CONSERVATION DIVISION  
Wichita, Kansas

**INSTRUCTIONS:** This form shall be completed in triplicate and filed with the Kansas Corporation Commission, 200 Colorado Derby Building, Wichita, Kansas 67202, within 120 days of the spud date of any well. Rule 82-3-130, 82-3-107 and 82-3-106 apply. Information on side two of this form will be held confidential for a period of 12 months if requested in writing and submitted with the form. See rule 82-3-107 for confidentiality in excess of 12 months. One copy of all wireline logs and drillers time log shall be attached with this form. ALL CEMENTING TICKETS MUST BE ATTACHED. Submit CP-4 form with all plugged wells. Submit CP-111 form with all temporarily abandoned wells. Any recompletion, workover or conversion of a well requires filing of ACO-2 within 120 days from commencement date of such work.

All requirements of the statutes, rules and regulations promulgated to regulate the oil and gas industry have been fully complied with and the statements herein are complete and correct to the best of my knowledge.

Signature \_\_\_\_\_

Title C. J. Lett, III Date 4-1-91  
President

Subscribed and sworn to before me this 1st day of April,  
19 91.

Notary Public Marilynn Evenson-Koob  
(Marilynn Evenson-Koob)

Date Commission Expires \_\_\_\_\_

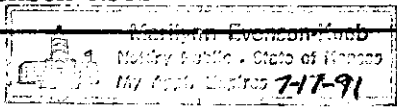

**K.C.C. OFFICE USE ONLY**  
F  Letter of Confidentiality Attached  
C  Wireline Log Received  
C  Drillers Timelog Received  
  
Distribution  
 KCC  SMD/Rep  NGPA  
 KGS  Plug  Other  
(Specify)

CONFIDENTIAL

SIDE TWO

Operator Name Bison Energy Corp. Lease Name Wiley Well # 2A-29  
Sec. 29 Twp. 31 Rge. 8  East  West  
County Harper

INSTRUCTIONS: Show important tops and base of formations penetrated. Detail all cores. Report all drill stem tests giving interval tested, time tool open and closed, flowing and shut-in pressures, whether shut-in pressure reached static level, hydrostatic pressures, bottom hole temperature, fluid recovery, and flow rates if gas to surface during test. Attach extra sheet if more space is needed. Attach copy of log.

Drill Stem Tests Taken  Yes  No  
(Attach Additional Sheets.)  
Samples Sent to Geological Survey  Yes  No  
Cores Taken  Yes  No  
Electric Log Run  Yes  No  
(Submit Copy.)

Name	Formation Description	
	Top	Bottom
Heebner Shale	3403	-1816
Toronto Limestone	3430	-1843
Douglas Group	3456	-1869
Haskell Limestone	3655	-2068
Lansing Group	3700	-2113
Kansas City Group	3924	-2337
Stark Shale	4088	-2501
Hushpuckney Shale	4120	-2533
BKC Group	4197	-2610
Altamont Limestone	4253	-2666

CASING RECORD  New  Used  
Report all strings set-conductor, surface, intermediate, production, etc.

Purpose of String	Size Hole Drilled	Size Casing Set (In O.D.)	Weight Lbs./Ft.	Setting Depth	Type of Cement	# Sacks Used	Type and Percent Additives
Surface	12 1/2"	8-5/8"	20#	218'	60/40poz	165	2% gel 3% cc.
Production	7-7/8"	5 1/2"		4462'	Surfil	125	300 gal. mud Sweep

Shots Per Foot	PERFORATION RECORD Specify Footage of Each Interval Perforated	Acid, Fracture, Shot, Cement Squeeze Record (Amount and Kind of Material Used)	Depth
4	4434'-4437'	pad, 20,000 gal. gel, 42,900# of sand	

TUBING RECORD Size 2 7/8" Set At 4320' Packer At \_\_\_\_\_  
Liner Run  Yes  No

Date of First Production 3-10-91 Producing Method  Flowing  Pumping  Gas Lift  Other (Explain)

Estimated Production Per 24 Hours	Oil Bbls.	Gas Mcf	Water Bbls.	Gas-Oil Ratio	Gravity
	30	50			

Disposition of Gas:  Vented  Sold  Used on Lease (If vented, submit ACO-18.)  
METHOD OF COMPLETION:  Open Hole  Perforation  Dually Completed  Commingled  
 Other (Specify) \_\_\_\_\_

Production Interval

Bison Energy Corp.  
 #2A-29 Wiley  
 ACO-1, Page Two

ORIGINAL

CONFIDENTIAL

KB-Log tops, cont'd

Bandera Shale	4286	-2699
Pawnee Limestone	4290	-2703
Labette Shale	4318	-2731
Cherokee Group	4331	-2744
Erosional Mississippi	4431	-2844
Mississippi Osage	4434	-2847

DST #1 (mis-run)

4425'-4437', 30-60-60-90. IHP: 2250# - FHP: 2149#. FP 36-NA - 239-NA.  
 SIP: 1209#-1209#

Recovered 3700' GIP, 30' VSOCM with good show of oil in tool.

DST #2

4429'-4447', 30-60-60-90. FP: 23-42#-67-95#. SIP: 1118#-1141#.  
 Recovery: 70' HOCWM (20% oil), 60' HOCWM (25% oil) 60' HOCW (25% oil),  
 60' SOCMW (3% oil).

RELEASED  
 MAY 20 1992  
 FROM CONFIDENTIAL

RECEIVED  
 STATE CORPORATION COMMISSION

APR 02 1991  
 4-2-91  
 CONSERVATION DIVISION  
 Wichita, Kansas

15-877-21234-0000

Date 2-9-91 District North Ticket No. 264911  
 Company RESTON ENERGY Rig 6010  
 Lease W1124 2A Well No. 1124  
 County WAGONER State KANSAS  
 Location MAG PLANT 35-18-45-415 Field \_\_\_\_\_

**ORIGINAL**

CASING DATA: PTA  Squeeze   
 Surface  Intermediate  Production  Liner   
 Size 5 1/2 Type USED Weight 14# Collar \_\_\_\_\_

Casing Depths: Top \_\_\_\_\_ Bottom \_\_\_\_\_

Drill Pipe: Size \_\_\_\_\_ Weight \_\_\_\_\_ Collars \_\_\_\_\_  
 Open Hole: Size 7 7/8 T.D. 4457 ft. P.B. to 4455 ft.  
 CAPACITY FACTORS: SET AT \_\_\_\_\_

Casing: Bbls/Lin. ft. 10244 Lin. ft./Bbl. 40.98  
 Open Holes: Bbls/Lin. ft. \_\_\_\_\_ Lin. ft./Bbl. \_\_\_\_\_  
 Drill Pipe: Bbls/Lin. ft. \_\_\_\_\_ Lin. ft./Bbl. \_\_\_\_\_  
 Annulus: Bbls/Lin. ft. 0309 Lin. ft./Bbl. 32.4055  
 Bbls/Lin. ft. \_\_\_\_\_ Lin. ft./Bbl. \_\_\_\_\_  
 Perforations: From \_\_\_\_\_ ft. to \_\_\_\_\_ ft. Amt. \_\_\_\_\_

CEMENT DATA: **CONFIDENTIAL**  
 Spacer Type: \_\_\_\_\_  
 Amt. \_\_\_\_\_ Skys Yield \_\_\_\_\_ ft<sup>3</sup>/sk Density \_\_\_\_\_ PPG  
300 GAL BS MUD SWEEP  
 LEAD: Pump Time \_\_\_\_\_ hrs. Type CLASS A  
6 1/2 A-10 - 20% GEL - 1% ATP Excess \_\_\_\_\_  
 Amt. 125 Skys Yield 1.96 ft<sup>3</sup>/sk Density 15.0 PPG  
 TAIL: Pump Time \_\_\_\_\_ hrs. Type \_\_\_\_\_  
 Excess \_\_\_\_\_  
 Amt. \_\_\_\_\_ Skys Yield \_\_\_\_\_ ft<sup>3</sup>/sk Density \_\_\_\_\_ PPG  
 WATER: Lead 6.8 gals/sk Tail \_\_\_\_\_ gals/sk Total 20.25 Bbls.  
 Pump Trucks Used BS 1492 LD  
 Bulk Equip. BSU2703-6983 CB  
 Float Equip: Manufacturer WHEATHER FORD  
 Shoe: Type REGULAR Depth 4455  
 Float: Type A FILL INSERT Depth 4415  
 Centralizers: Quantity 8 Plugs Top 1 Btm. 1  
 Stage Collars \_\_\_\_\_  
 Special Equip. \_\_\_\_\_  
 Disp. Fluid Type FRESH H<sub>2</sub>O Amt. 108 Bbls. Weight 8.3 PPG  
 Mud Type \_\_\_\_\_ Weight \_\_\_\_\_ PPG

COMPANY REPRESENTATIVE DECK FIALET CEMENTER NSA1 KUPP

TIME	PRESSURES PSI		FLUID PUMPED DATA			REMARKS
	AM/PM	DRILL PIPE CASING	ANNULUS	TOTAL FLUID	Pumped Per Time Period	
9:00						JOB SAFETY PROCEDURE RIG UP ROTATED & HEAD TO CASING - BREAK CIRCULATION - ROTATE STOP CIRCULATING - DROP BALL RESUME CIRCULATION - ROTATE RIG UP TO PUMP TRUCK DROP BOTTOM PLUG STR MUD SWEEP STR STURNEY SHUT DOWN - RELEASE TOP PLUG STR DISPLACEMENT - ROTATE CASING BOTTOM PLUG & FLUSH AT SHOE STURNEY AT SHOE - SLOW RATE PSE INC (LIFT PSE) SLOW RATE - FINAL DISP PSE BUMP PLUG BLEED PSE - CHECK INSERT - HELD JOB COMPLETE
9:25		300				
9:45						
9:50		300				
10:30		250			7	
		250		38	31	
		260				
		200			70	
		300		77	7	
		450		86	9	
		1450		106	20	
		0		108	2	
11:15						

RELEASED

MAY 20 1992

FROM CONFIDENTIAL

RECEIVED

STATE CORPORATION COMMISSION

APR 02 1991

4-2-91  
 CONSERVATION DIVISION  
 Wichita, Kansas

FINAL DISP. PRESS: 450 PSI BUMP PLUG TO 1450 PSI BLEEDBACK 1/2 BBLs.

Form No. SR 0502 (Rev. 3/90)  
 Note: Must accompany job ticket.

THANK YOU  
 NR