

STATE OF KANSAS
STATE CORPORATION COMMISSION

15101-20252-0000

WELL PLUGGING RECORD

Give All Information Completely
Make Required Affidavit
Mail or Deliver Report to
Conservation Division
State Corporation Comm.
245 North Water
Wichita, KS 67202

Lane _____ County. Sec. 36 Twp. 16S Rge. 29 E/W
Location as "NE/CNW/SW" or footage from lines _____
SW SW SW

Lease Owner Dane G. Hansen Trust

Lease Name James "A" Well No. 1

Office Address Logan, Kansas 67646

Character of Well (Completed as Oil, Gas or Dry Hole) _____

Dry Hole

Date Well completed Oct. 12 .. 1977

Application for plugging filed Oct. 12 1977

Application for plugging approved Oct. 12 1977

Plugging commenced Oct. 12 1977

Plugging completed Oct. 12 1977

Reason for abandonment of well or producing formation _____

Too low structurally

If a producing well is abandoned, date of last production _____

19 _____

Was permission obtained from the Conservation Division or its agents before plugging was commenced? Yes

Name of Conservation Agent who supervised plugging of this well Gilbert Balthazor

Producing formation _____ Depth to top _____ Bottom _____ Total Depth of Well 2800 K

Show depth and thickness of all water, oil and gas formations.

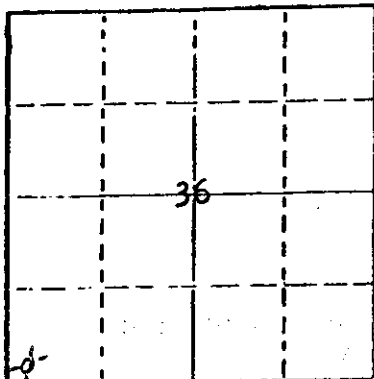

Locate well correctly on above Section Plat

OIL, GAS OR WATER RECORDS

CASING RECORD

FORMATION	CONTENT	DEPTH	TO	SIZE	PUT IN	PULLED OUT
				8 5/8"	311.30'	None

RECEIVED
STATE CORPORATION COMMISSION
NOV 10 1977

Describe in detail the manner in which the well was plugged, indicating where the mud fluid was placed and the methods used in introducing it into the hold. If cement or other plugs were used, state the character of same and depth placed, from _____ feet to _____ feet for each plug set.

Filled with heavy mud to 900'. Set plug.
Put in 70 sacks cement. Filled with heavy mud to 300'. Set plug. Put in 29 sacks cement. Filled with heavy mud up to 40'. Set plug. Filled to top with 1 sack hulls & 10 sacks cement.

(If additional description is necessary, use BACK of this sheet)

Name of Plugging Contractor C-G Drilling Co.

1107 Dougals Bldg., Wichita, Kansas 67202

STATE OF Kansas COUNTY OF Sedwick ss.

_____, (employee of owner) or (owner or operator) of the above-described well, being first duly sworn on oath, says: That I have knowledge of the facts, statements, and matters herein contained and the log of the above-described well as filed and that the same are true and correct. So help me God.

(Signature) G. F. Galloway

1107 Dougals Bldg.
(Address)

Subscribed and sworn to before me this 17th day of October, 1977

My commission expires March 3, 1980

Debra Heersche
Debra Heersche Notary Public.

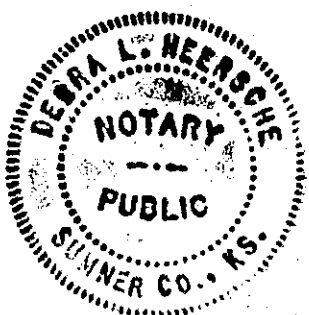

KANSAS DRILLERS LOG

S. 36 T. 16S R. 29 ^{1/2} W
 Loc. SW SW SW
 County LANE

API No. 15 — 101 — 70257-0000
County Number

Operator
Dane G. Hansen Trust

Address
Logan, Kansas 67646

Well No. 1 Lease Name James "A"

Footage Location
330 feet from ^{XX}(N) (S) line 330 feet from ^X(E) (W) line

Principal Contractor C-G Drilling Co. Geologist Jerry Jespersen

Spud Date 10/1/77 Total Depth 4607' P.B.T.D.

Date Completed 10/12/77 Oil Purchaser

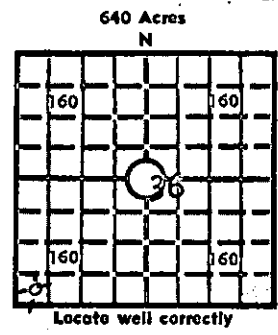

Elev.: Gr. _____
 DF _____ KB 2800

CASING RECORD

Report of all strings set— surface, intermediate, production, etc.

Purpose of string	Size hole drilled	Size casing set (in O.D.)	Weight lbs/ft.	Setting depth	Type cement	Sacks	Type and percent additives
Surface	12 1/4"	8 5/8"	28#	311.30	Common	160	2% Gel + 3% CC

LINER RECORD

PERFORATION RECORD

Top, ft.	Bottom, ft.	Sacks cement	Shots per ft.	Size & type	Depth interval

TUBING RECORD

Size	Setting depth	Packer set at

ACID, FRACTURE, SHOT, CEMENT SQUEEZE RECORD

RECEIVED
 STATE CORPORATION COMMISSION
NOV 10 1977
 CONSERVATION DIVISION
 Wichita, Kansas

Amount and kind of material used	Depth interval treated

INITIAL PRODUCTION

Date of first production		Producing method (flowing, pumping, gas lift, etc.)			
RATE OF PRODUCTION PER 24 HOURS		Oil	Gas	Water	Gas-oil ratio
		bbls.	MCF	bbls.	CFPB
Disposition of gas (vented, used on lease or sold)				Producing interval(s)	

INSTRUCTIONS: As provided in KCC Rule 82-2-125, within 90 days after completion of a well, one completed copy of this Drillers Log shall be transmitted to the State Geological Survey of Kansas, 4150 Monroe Street, Wichita, Kansas 67209. Copies of this form are available from the Conservation Division, State Corporation Commission, 3830 So. Meridian (P.O. Box 17027), Wichita, Kansas 66217. Phone AC 316-522-2206. If confidential custody is desired, please note Rule 82-2-125. Drillers Logs will be on open file in the Oil and Gas Division, State Geological Survey of Kansas, Lawrence, Kansas 66044.

DESIGN:
 DRY HOLE, SWD, ETC
 Dry Hole

Dane G. Hansen Trust

Well No.

Lease Name

1

James "A"

S36 T16 R29 W

WELL LOG

Show all important zones of porosity and contents thereof; cored intervals, and all drill-stem tests, including depth interval tested, cushion used, time tool open, flowing and shut-in pressures, and recoveries.

SHOW GEOLOGICAL MARKERS, LOGS RUN, OR OTHER DESCRIPTIVE INFORMATION.

FORMATION DESCRIPTION, CONTENTS, ETC.	TOP	BOTTOM	NAME	DEPTH
SHALE & SAND	0	1585		
SHALE	1585	1780		
SAND	1780	1980		
RED BED	1980	2010		
SHALE	2010	2038		
SHALE & RED BED	2038	2200		
ANHY	2200	2230		
SHALE	2230	2300		
SHALE & SHELLS	2300	2615		
SHALE	2615	2740		
LIME & SHALE	2740	3780		
LIME & TD	3780	4607		
DST #1 4218-4265 30-30-30-30' REC 180' MW, W FEW SP OIL. IBHP 1101#, FBHP 1067, IFP 45, FFP 114. DST #2 4320 -4345 30-30-30-30. WEAK BLOW F/ 7 MIN. REC: 20' VSOCM, IBHP 606, FBHP 595, IFP 23, FFP 46. DST #3 4360 - 4420 30-30-30-30. WEAK BLOW F/ 3 MIN. REC 15' MUD IBHP 80, FBHP 80, IFP 57, FFP 69. DST #4 4539-4566 30-30-60-30. 30' HOCM, 60' OCM, IBHP 344, FBHP 183, IFP 23, FFP 46.				
USE ADDITIONAL SHEETS, IF NECESSARY, TO COMPLETE WELL RECORD.				

Date Received

Debra Heersche

Signature

Debra Heersche

Office Manager

Title

October 6, 1977

Date