

ORIGINAL

SIDE ONE

6/30/89
RELEASED

STATE CORPORATION COMMISSION OF KANSAS
OIL & GAS CONSERVATION DIVISION
WELL COMPLETION OR RECOMPLETION FORM
ACO-1 WELL HISTORY
DESCRIPTION OF WELL AND LEASE

API NO. 15- ~~135~~ 23,231 -00-00 SEP-2-1-1988

County... Ness
C NW/4 SE/4 14 20S 26W East
..... Sec..... Twp..... Rge..... X West

FROM CONFIDENTIAL

Operator: License # 9883
Name Sharon Resources, Inc.
Address 7100 East Bellevue #201
City/State/Zip Englewood, Colorado 80111

1980 Ft North from Southeast Corner of Section
1980 Ft West from Southeast Corner of Section
(Note: Locate well in section plat below)

Lease Name Federal Land Bank Well # 14-1

Purchaser.....

Field Name.....

Operator Contact Person Robert Elder
Phone 303-694-4920

Producing Formation.....

Elevation: Ground 2495' 2500' KB.....

Contractor: License # 5302
Name Red Tiger Drilling Company

Wellsite Geologist Boh Elder
Phone (303) 694-4920

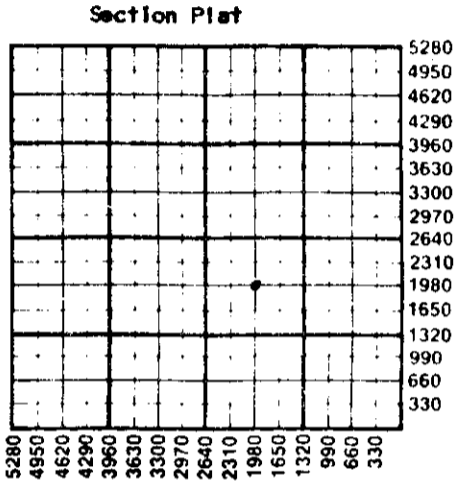

Designate Type of Completion
 New Well Re-Entry Workover
 Oil SWD Temp Abd
 Gas Inj Delayed Comp
 Dry Other (Core, Water Supply etc.)

RECEIVED
STATE CORPORATION COMMISSION
06-30-1988
10:11 30 1988

If OWNED: old well info as follows:
Operator.....
Well Name.....
Comp. Date..... Old Total Depth.....

CONSERVATION DIVISION
Wichita, Kansas

WATER SUPPLY INFORMATION

Disposition of Produced Water: Disposal
Docket # Repressuring

WELL HISTORY

Drilling Method: Mud Rotary Air Rotary Cable
3/29/88 4/6/88
Spud Date Date Reached TD Completion Date
4,545' 4,488'
Total Depth PBTD
Amount of Surface Pipe Set and Cemented at 385 feet
Multiple Stage Cementing Collar Used? Yes No
If yes, show depth set..... feet
If alternate 2 completion, cement circulated from..... feet depth to..... w/..... SX cmt
Cement Company Name.....
Invoice # PxA 2-12-91

Questions on this portion of the ACO-1 call:
Water Resources Board (913) 296-3717

Source of Water:
Division of Water Resources Permit #.....
 Groundwater..... Ft North from Southeast Corner
(Well) Ft West from Southeast Corner of
Sec Twp Rge East West
 Surface Water 3100 Ft North from Southeast Corner
(Stream, pond etc.) 800 Ft West from Southeast Corner
Sec 9 Twp 20S Rge 26 East X West
Myrtle Merryfield, Arnold, Ks. 67515
Other (explain).....
(purchased from city, R.W.D. #)

INSTRUCTIONS: This form shall be completed in triplicate and filed with the Kansas Corporation Commission, 200 Colorado Derby Building, Wichita, Kansas 67202, within 120 days of the spud date of any well. Rule 82-3-130, 82-3-107 and 82-3-106 apply. Information on side two of this form will be held confidential for a period of 12 months if requested in writing and submitted with the form. See rule 82-3-107 for confidentiality in excess of 12 months. One copy of all wireline logs and drillers time log shall be attached with this form. Submit CP-4 form with all plugged wells. Submit CP-111 form with all temporarily abandoned wells.

All requirements of the statutes, rules and regulations promulgated to regulate the oil and gas industry have been fully complied with and the statements herein are complete and correct to the best of my knowledge.

Signature Jack S. Steinhauser
Title P. Operations Date 6/28/88

Subscribed and sworn to before me this 28th day of June 1988
Notary Public Camilla L. Miller
Date Commission Expires 11/8/89

K.C.C. OFFICE USE ONLY
 Letter of Confidentiality Attached
 Wireline Log Received
 Drillers Timelog Received
Distribution
KCC SWD/Rep NGPA
KGS Plug Other
(Specify)
ET

Sec. 14 Twp. 26N Rge. 26W

Operator Name Sharon Resources, Inc. Lease Name Federal Land ~~RELEASED~~ 14-1 Well #.....

Sec. 14 Twp. 20S Rge. 26W East West County Ness SFP 2 A-11

FROM CONFIDENTIAL

WELL LOG

INSTRUCTIONS: Show important tops and base of formations penetrated. Detail all cores. Report all drill stem tests giving interval tested, time tool open and closed, flowing and shut-in pressures, whether shut-in pressure reached static level, hydrostatic pressures, bottom hole temperature, fluid recovery, and flow rates if gas to surface during test. Attach extra sheet if more space is needed. Attach copy of log.

| | |
|---|---|
| Drill Stem Tests Taken <input checked="" type="checkbox"/> Yes <input type="checkbox"/> No | Formation Description <input checked="" type="checkbox"/> Log <input type="checkbox"/> Sample |
| Samples Sent to Geological Survey <input type="checkbox"/> Yes <input checked="" type="checkbox"/> No | |
| Cores Taken <input type="checkbox"/> Yes <input checked="" type="checkbox"/> No | |

| Name | Top | Bottom |
|----------------|-------|--------|
| ANHYDRITE | 1730' | |
| TOPEKA | 3332' | |
| HEEBNER | 3820' | |
| TORONTO | 3839' | |
| LANSING | 3864' | |
| BKC | 4250' | |
| MARMATON | 4266' | |
| PAWNEE | 4340' | |
| FT. SCOTT | 4385' | |
| CHEROKEE SHALE | 4408' | |
| MISSISSIPPI | 4476' | |
| RTD 4545' | | |
| RTD 4545 | | |

DST #1 (4481 - 4490) IFP: 68-246
 INTERVAL: 20-60-60-90 FFP: 318-610
 RECOVERED 120' GAS IN PIPE. SIP: 1296-1286
 1600' OF FLUID AS FOLLOWS:
 80' FREE OIL
 300' GASSY OIL CUT MUDDY WATER
 25% OIL
 25% GAS
 40% WATER
 10% MUD
 570' GASSY OIL CUT MUDDY WATER
 20% OIL
 5% GAS
 65% WATER
 10% MUD
 650' OF WATER
 WATER ANALYSIS YIELDS CHLORIDE LEVEL OF 11,500 PPM
 SAMPLER HAD 1400 CC OF FLUID AS FOLLOWS:
 1320 CC WATER, 80 CC OIL

CASING RECORD New Used
 Report all strings set-conductor, surface, intermediate, production, etc.

| Purpose of String | Size Hole Drilled | Size Casing Set (in O.D.) | Weight Lbs/Ft. | Setting Depth | Type of Cement | #Sacks Used | Type and Percent Additives |
|-------------------|-------------------|---------------------------|----------------|---------------|----------------|-------------|----------------------------|
| Surface | 12 1/4" | 8 5/8" | 24# | 395' | Common | 200 | 2% Gel 3%CC |
| Production | 8 5/8" | 5 1/2" | 14# | 4,544' | EA | 100 | 18% Salt, 3/4 of 1% |

| Shots Per Foot | Specify Footage of Each Interval Perforated | Acid, Fracture, Shot, Cement Squeeze Record (Amount and Kind of Material Used) | Depth |
|----------------|---|--|-------|
| 4 | 4475' - 4478' | 75 SXS CEMENT (SQUEEZE) | 4484' |

TUBING RECORD Size Set At Packer at Liner Run Yes No

Date of First Production Producing Method Flowing Pumping Gas Lift Other (explain).....

| Estimated Production Per 24 Hours | Oil Bbls | Gas MCF | Water Bbls | Gas-Oil Ratio | Gravity |
|-----------------------------------|----------|---------|------------|---------------|---------|
| | | | | CFPB | |

METHOD OF COMPLETION Production Interval

Disposition of gas: Vented Open Hole Perforation
 Sold Other (Specify)
 Used on Lease Dually Completed
 Commingled

15-135-23231-00-00

ORIGINAL INVOICE INVOICE



P.O. BOX 651046 DALLAS, TX 75265

| INVOICE NO. | DATE |
|-------------|------------|
| 620147 | 04/07/1988 |

| | | | | | | |
|--|-------------------------------|-------------------------|----------------------|---|--------------------|---------------------------|
| WELL LEASE NO. FEDERAL LAND BANK 14-1 | | WELL LOCATION NESS | | STATE KS | WELL OWNER SAME | |
| SERVICE LOCATION NESS CITY | | CONTRACTOR RED TIGER | | JOB PURPOSE CEMENT PRODUCTION CASING | | TICKET DATE 04/07/1988 |
| ACCT. NO. 794194 | CUSTOMER AGENT DAVID PAULY | VENDOR NO. | CUSTOMER P.O. NUMBER | SHIPPED VIA COMPANY TRUCK | FILE NO. 56648 | |

SHARON RESOURCES, INC.
7100 E. BELLEVIEW AVE., STE 201
ENGLEWOOD, CO 80111

DIRECT CORRESPONDENCE TO:
SUITE 600
COLORADO DERBY BUILDING
WICHITA, KS 67202-0000

| PRICE REF. NO. | DESCRIPTION | QUANTITY | U/M | UNIT PRICE | AMOUNT |
|--|------------------------------|----------|-----|------------|------------|
| 000-117 | MILEAGE | 28 | MI | 2.10 | 58.80 |
| | | 1 | UNT | | |
| 001-016 | CEMENTING CASING PUMP CHARGE | RD 4549 | FT | 1,035.80 | 1,035.80 |
| | | 1 | UNT | | |
| 030-016 | TYPE 5W ALUMINUM PLUG-TOP | 5 1/2 | IN | 41.00 | 41.00 |
| | | 1 | EA | | |
| 018-317 | SUPER FLUSH | 500 | GAL | 1.50 | 750.00 |
| 040-014 | ROTATING HEAD | 1 | JOB | 155.00 | 155.00 |
| 12A | GUIDE SHOE - 5 1/2" 8RD THD. | 1 | EA | 103.00 | 103.00 |
| 825.205 | | | | | |
| 24A | INSERT FLOAT VALVE - 5 1/2" | 1 | EA | 83.00 | 83.00 |
| 815.19251 | | | | | |
| 27 | FILL-UP UNIT 5 1/2"-6 5/8" | 1 | EA | 27.50 | 27.50 |
| 815.19311 | | | | | |
| 40 | CENTRALIZER 5-1/2" MODEL S-4 | 6 | EA | 44.00 | 264.00 |
| 807.93022 | | | | | |
| 320 | CEMENT BASKET 5 1/2" | 1 | EA | 90.00 | 90.00 |
| 800.8883 | | | | | |
| 504-308 | STANDARD CEMENT | 100 | SK | 5.45 | 545.00 |
| 509-968 | SALT | 800 | LB | .073 | 58.40 |
| 508-127 | CAL SEAL | 5 | SK | 14.60 | 73.00 |
| 507-210 | FLOCELE | 25 | LB | 1.21 | 30.25 |
| 500-207 | BULK SERVICE CHARGE | 118 | CFT | .95 | 112.10 |
| 500-306 | MILEAGE | 150.15 | TMI | .70 | 105.11 |
| INVOICE SUBTOTAL | | | | | 3,531.96 |
| DISCOUNT-(BID) | | | | | 529.77- |
| INVOICE BID AMOUNT | | | | | 3,002.19 |
| *-KANSAS STATE SALES TAX | | | | | 50.11 |
| INVOICE TOTAL - PLEASE PAY THIS AMOUNT | | | | | \$3,052.30 |

Handwritten signature: AIP [unclear]

OK RECEIVED
STATE DEPARTMENT OF COMMISSION

JUL 30 1988

CONFIDENTIAL

TERMS INVOICES PAYABLE NET BY THE 20TH OF THE FOLLOWING MONTH AFTER DATE OF INVOICE UNLESS CUSTOMER'S DEFAULT IN PAYMENT OF CUSTOMER'S ACCOUNT BY THE LAST DAY OF THE MONTH FOLLOWING THE MONTH IN WHICH THE INVOICE IS DATED. CUSTOMER AGREES TO PAY INTEREST THEREON AFTER DEFAULT AT THE HIGHEST LAWFUL CONTRACT RATE APPLICABLE BUT NEVER TO EXCEED 18% PER ANNUM IN THE EVENT IT BECOMES NECESSARY TO EMPLOY AN ATTORNEY TO ENFORCE COLLECTION OF SAID ACCOUNT CUSTOMER AGREES TO PAY ALL COLLECTION COSTS AND ATTORNEY FEES IN THE AMOUNT OF 20% OF THE AMOUNT OF THE UNPAID ACCOUNT