

FOR KCC USE:

FORM C-1 7/91

FORM MUST BE TYPED

FORM MUST BE SIGNED

ALL BLANKS MUST BE FILLED

EFFECTIVE DATE: 11-22-94

State of Kansas

DISTRICT # 1

NOTICE OF INTENTION TO DRILL

SEALED Yes No

Must be approved by the K.C.C. five (5) days prior to commencing well

Expected Spud Date 11 21 1994 month day year

Spot NE NW NW Sec 2 Twp 16 S. Rg 17 East West

OPERATOR: License # 6141 Name: Coronado Oil & Gas, Inc. Address: P.O. Box 1285 City/State/Zip: Great Bend, KS 67530 Contact Person: Lee Roy A. Legleiter Phone: 316-792-6702

330 feet from South / North line of Section 990 feet from East / West line of Section IS SECTION REGULAR X IRREGULAR?

CONTRACTOR: License #: 5418 Name: Allen Drilling Co.

(NOTE: Locate well on the Section Plat on Reverse Side) County: Rush

Well Drilled For: Well Class: Type Equipment: Oil Enh Rec Infield X Mud Rotary Gas Storage Pool Ext Air Rotary OWMO Disposal X Wildcat Cable Seismic # of Holes Other

Field Name: Legleiter Well #: A-1

Is this a Prorated/Spaced Field? yes X no Target Formation(s): Arhuckle

If OWMO: old well information as follows: Operator: Well Name: Comp. Date: Old Total Depth

Nearest lease or unit boundary: 330' Ground Surface Elevation: 1912' feet MSL

Water well within one-quarter mile: yes X no Public water supply well within one mile: X yes no

Directional, Deviated or Horizontal wellbore? yes X no If yes, true vertical depth: Bottom Hole Location

Depth to bottom of fresh water: 400' Depth to bottom of usable water: 300'

Surface Pipe by Alternate: X 1 2 Length of Surface Pipe Planned to be set: (1030') 400'

Length of Conductor pipe required: No Projected Total Depth: 3550'

Formation at Total Depth: 3520' Water Source for Drilling Operations: well X farm pond other

D&R Permit #: Will Cores Be Taken? yes X no

If yes, proposed zone:

AFFIDAVIT

The undersigned hereby affirms that the drilling, completion and eventual plugging of this well will comply with K.S.A. 55-101, et. seq.

It is agreed that the following minimum requirements will be met:

- 1. Notify the appropriate district office prior to spudding of well; 2. A copy of the approved notice of intent to drill shall be posted on each drilling rig; 3. The minimum amount of surface pipe as specified below shall be set by circulating cement to the top; in all cases surface pipe shall be set through all unconsolidated materials plus a minimum of 20 feet into the underlying formation; 4. If the well is dry hole, an agreement between the operator and the district office on plug length and placement is necessary prior to plugging; 5. The appropriate district office will be notified before well is either plugged or production casing is cemented in; 6. IF AN ALTERNATE II COMPLETION, PRODUCTION PIPE SHALL BE CEMENTED FROM BELOW ANY USABLE WATER TO SURFACE WITHIN 120 DAYS OF SPUD DATE. IN ALL CASES, NOTIFY DISTRICT OFFICE PRIOR TO ANY CEMENTING.

I hereby certify that the statements made herein are true and to the best of my knowledge and belief.

Date: 11-11-94 Signature of Operator or Agent: Lee Roy A. Legleiter, title: VP of Prod.

FOR KCC USE: API # 15- 165-21673-00-00 Conductor pipe required 700 feet Minimum surface pipe required 400 feet per Alt. (X) Approved by: CB 11-17-94 This authorization expires: 5-17-95 (This authorization void if drilling not started within 6 months of effective date.) Spud date: Agent:

REMEMBER TO:

- File Drill Pit Application (form CDP-1) with Intent to Drill; - File Completion Form ACD-1 within 120 days of spud date; - File acreage attribution plat according to field prorations orders; - Notify appropriate district office 48 hours prior to workover or re-entry; - Submit plugging report (CP-4) after plugging is completed; - Obtain written approval before disposing or injecting salt water.

Mail to: Conservation Division, 200 Colorado Derby Building, 202 W. First St., Wichita, Kansas 67202-1286.

STATE OF KANSAS NOV 14 1994 11-14-1994 CONSERVATION DIVISION WICHITA, KANSAS

2 16 17

IN ALL CASES PLOT THE INTENDED WELL ON THE PLAT BELOW

PLAT OF ACREAGE ATTRIBUTABLE TO A WELL IN A PRORATED OR SPACED FIELD

If the intended well is in a prorated or spaced field, please fully complete this side of the form. If the intended well is in a prorated or spaced field complete the plat below showing that the well will be properly located in relationship to other wells producing from the common source of supply. Please show all the wells within 1 mile of the boundaries of the proposed acreage attribution unit for gas wells and within 1/2 mile of the boundaries of the proposed acreage attribution unit for oil wells.

API NO. 15- _____
 OPERATOR Coronado Oil & Gas, Inc.
 LEASE Legleiter
 WELL NUMBER A-1
 FIELD _____

LOCATION OF WELL: COUNTY Rush
 _____ feet from south/north line of section
330
 _____ feet from east/west line of section
990
 SECTION 2 TWP 16 RG 17w

NUMBER OF ACRES ATTRIBUTABLE TO WELL 10
 QTR/QTR/QTR OF ACREAGE NE - NW - NW

IS SECTION _____ REGULAR or X IRREGULAR
IF SECTION IS IRREGULAR, LOCATE WELL FROM NEAREST CORNER BOUNDARY.

Section corner used: _____ NE X NW _____ SE _____ SW
PLAT

(Show location of the well and shade attributable acreage for prorated or spaced wells.)
 (Show footage to the nearest lease or unit boundary line.)

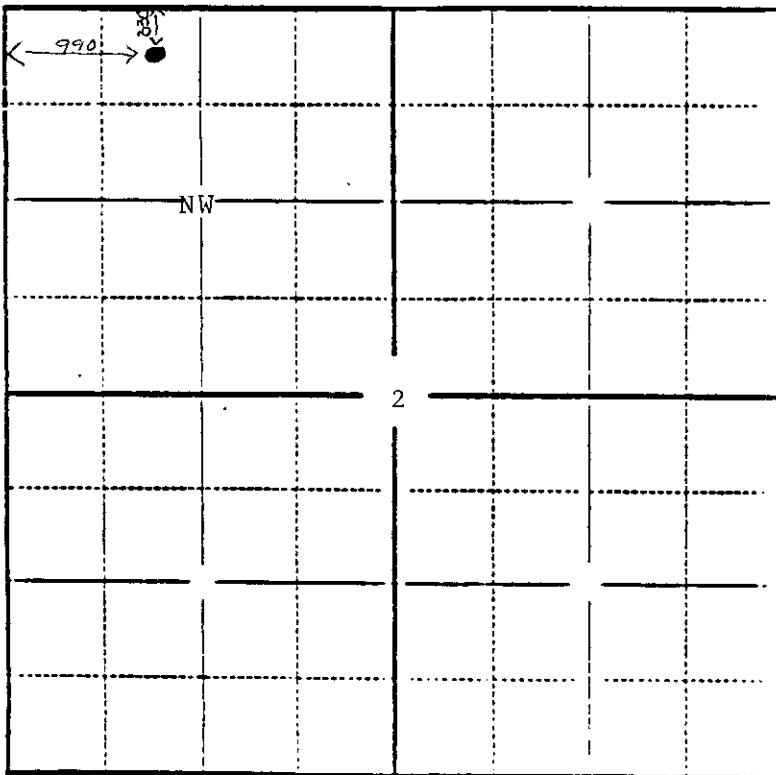

RUSH CO.

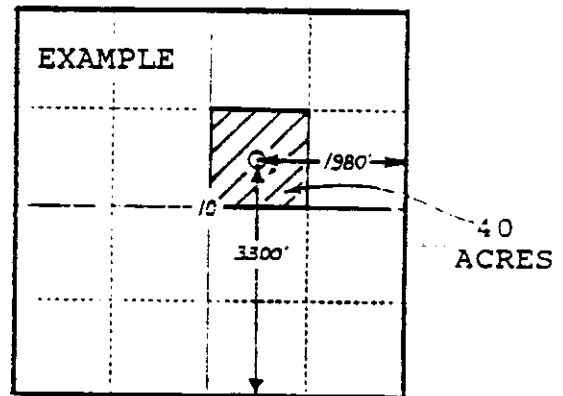

SEWARD CO.

In plotting the proposed location of the well, you must show:

- 1) The manner in which you are using the depicted plat by identifying section lines, i.e. 1 section, 1 section with 8 surrounding sections, 4 sections, etc.;
- 2) the distance of the proposed drilling location from the section's south/north and east/west lines; and
- 3) the distance to the nearest lease or unit boundary line.