

FOR KCC USE:

OWWO

FORM C-1 7/91

FORM MUST BE TYPED

FORM MUST BE SIGNED

ALL BLANKS MUST BE FILLED

EFFECTIVE DATE: 1-12-97

State of Kansas

DISTRICT # 1  
SEAT Yes No

NOTICE OF INTENTION TO DRILL

Must be approved by the K.C.C. five (5) days prior to commencing well

Expected Spud Date 1-11-97  
month day year

Spot C NE NE Sec 16 Twp 31 S Rg 11 East West

OPERATOR: License # 5046  
Name: Raymond Oil Company, Inc.  
Address: P. O. Box 48788  
City/State/Zip: Wichita, Kansas 67201-8788  
Contact Person: Pat Raymond  
Phone: 316-267-4214

660 feet from South line of Section  
660 feet from East line of Section  
IS SECTION X REGULAR IRREGULAR

(NOTE: Locate well on the Section Plat on Reverse Side)  
County: Barber

CONTRACTOR: License #: 5929  
Name: Duke Drilling Co.

Lease Name: Axline, OWWO Well #: 1  
Field Name: Wildcat

Well Drilled For:	Well Class:	Type Equipment:
Oil	Enh Rec	Infield X Mud Rotary
X Gas	Storage	Pool Ext. Air Rotary
X OWWO	Disposal	X Wildcat Cable
Seismic	# of Holes	Other
Other		

Is this a Prorated/Spaced Field? yes X no

Target Formation(s): Douglas  
Nearest lease or unit boundary: 660

Ground Surface Elevation: 1784 feet MSL  
Water well within one-quarter mile: yes X no

Public water supply well within one mile: yes X no  
Depth to bottom of fresh water: 80

Depth to bottom of usable water: 125  
Surface Pipe by Alternate: X 1 2

Length of Surface Pipe Planned to be set: 10 3/4 @ .156  
Length of Conductor pipe required: 3976

Projected Total Depth: Lansing

Formation at Total Depth:  
Water Source for Drilling Operations:

... well ... farm pond X other

DWR Permit #:  
Will Cores Be Taken? yes X no

If yes, proposed zone:

If OWWO, old well information as follows:  
Operator: Olson Oil Co.  
Well Name: #1 Axline  
Comp. Date: 12-13-42 Old Total Depth 4512

Directional, Deviated or Horizontal wellbore? yes X no  
If yes, true vertical depth:  
Bottom Hole Location:

AFFIDAVIT

The undersigned hereby affirms that the drilling, completion and eventual plugging of this well will comply with K.S.A. 55-101, et. seq.  
It is agreed that the following minimum requirements will be met:

1. Notify the appropriate district office prior to spudding of well;
2. A copy of the approved notice of intent to drill shall be posted on each drilling rig;
3. The minimum amount of surface pipe as specified below shall be set by circulating cement to the top; in all cases surface pipe shall be set through all unconsolidated materials plus a minimum of 20 feet into the underlying formation;
4. If the well is dry hole, an agreement between the operator and the district office on plug length and placement is necessary prior to plugging;
5. The appropriate district office will be notified before well is either plugged or production casing is cemented in;
6. IF AN ALTERNATE IS COMPLETION, PRODUCTION PIPE SHALL BE CEMENTED FROM BELOW ANY USABLE WATER TO SURFACE WITHIN 120 DAYS OF SPUD DATE. IN ALL CASES, NOTIFY DISTRICT OFFICE PRIOR TO ANY CEMENTING.

I hereby certify that the statements made herein are true and to the best of my knowledge and belief.

Date: 12-10-96 Signature of Operator or Agent: Pat Raymond Title: Vice President

\*SEE ATTACHED SURFACE CASING EXCEPTION.

FOR KCC USE:  
API # 15- 007-01050-00-01  
Conductor pipe required NONE feet  
Minimum surface pipe required 156 feet per Alt. ① X  
Approved by: JK 1-7-97  
This authorization expires: 7-7-97  
(This authorization void if drilling not started within 6 months of effective date.)  
Spud date: Agent:

REMEMBER TO:

- File Drill Pit Application (form CDP-1) with Intent to Drill;
- File Completion Form ACO-1 within 120 days of spud date;
- File acreage attribution plat according to field prorated orders;
- Notify appropriate district office 48 hours prior to workover or re-entry;
- Submit plugging report (CP-4) after plugging is completed;
- Obtain written approval before disposing or injecting salt water.

Mail to: Conservation Division, 200 Colorado Derby Building, 202 W. First St., Wichita, Kansas 67202-1286.

16  
31  
11/17  
12-3196

**IN ALL CASES PLOT THE INTENDED WELL ON THE PLAT BELOW**

**PLAT OF ACREAGE ATTRIBUTABLE TO A WELL IN A PRORATED OR SPACED FIELD**

If the intended well is in a prorated or spaced field, please fully complete this side of the form. If the intended well is in a prorated or spaced field complete the plat below showing that the well will be properly located in relationship to other wells producing from the common source of supply. Please show all the wells within 1 mile of the boundaries of the proposed acreage attribution unit for gas wells and within 1/2 mile of the boundaries of the proposed acreage attribution unit for oil wells.

API NO. 15- \_\_\_\_\_  
 OPERATOR Raymond Oil Company, Inc.  
 LEASE Axline OWWO  
 WELL NUMBER 1  
 FIELD Wildcat

LOCATION OF WELL: COUNTY Barber  
660 feet from ~~XXXX~~ north line of section  
660 feet from east/~~XXXX~~ line of section  
 SECTION 16 TWP 31S RC 11W

NUMBER OF ACRES ATTRIBUTABLE TO WELL 160  
 QTR/QTR/QTR OF ACREAGE NE

IS SECTION X REGULAR or IRREGULAR  
**IF SECTION IS IRREGULAR, LOCATE WELL FROM NEAREST CORNER BOUNDARY.**

Section corner used: X NE      NW      SE      SW

**PLAT**

(Show location of the well and shade attributable acreage for prorated or spaced wells.)  
 (Show footage to the nearest lease or unit boundary line.)

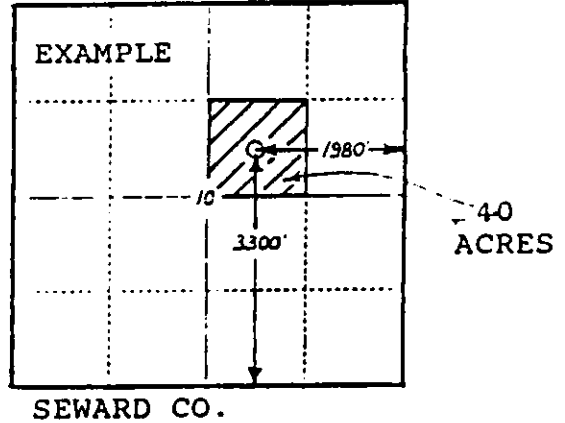
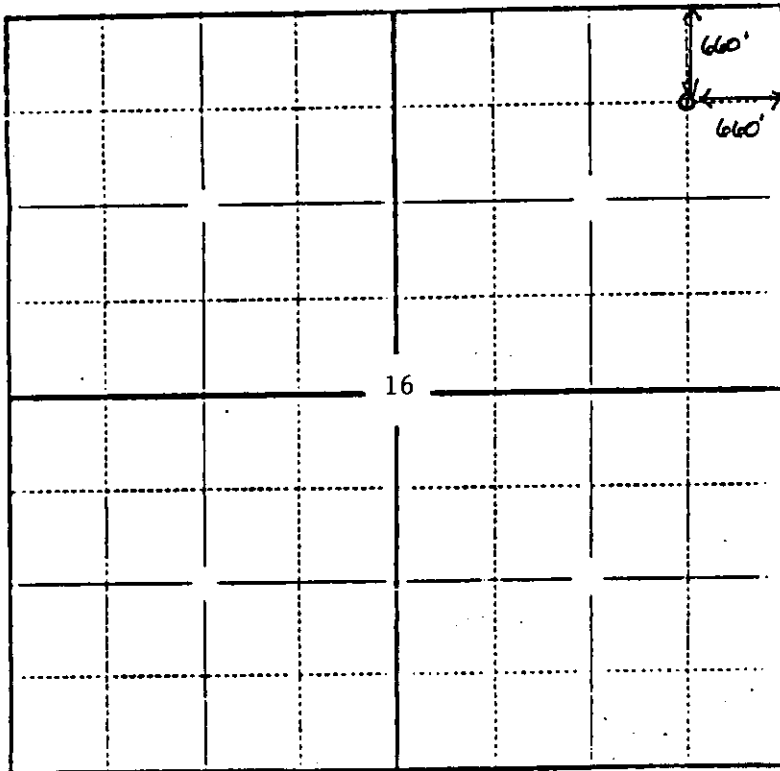

**In plotting the proposed location of the well, you must show:**

- 1) The manner in which you are using the depicted plat by identifying section lines, i.e. 1 section, 1 section with 8 surrounding sections, 4 sections, etc.;
- 2) the distance of the proposed drilling location from the section's south/north and east/west lines; and
- 3) the distance to the nearest lease or unit boundary line.

W



## Kansas Corporation Commission

Bill Graves, Governor Timothy E. McKee, Chair Susan M. Seltsam, Commissioner John Wine, Commissioner  
Judith McConnell, Executive Director David J. Heinemann, General Counsel

**DATE:** January 6, 1997

**TO:** Raymond Oil Company, Inc.  
P.O. Box 48788  
One Main Place - Suite 900  
Wichita, KS 67201  
Attn: Tim Hellman

**FROM:** M. L. Korphage

**RE:** Exception to Table 1, Minimum Surface Casing Requirements for the Axline #1  
OWWO, 660' FNL & 660' FEL, Sec 16-31S-11W, Barber County.

Dear Mr. Hellman,

Raymond Oil Company, Inc. Requests an exception to Table 1, Surface Pipe Requirements, Alternate 1 completion for the above described well. The Alternate 1 completion requirement for this location is to set a minimum of 200' of surface pipe.

The Axline #1 was drilled by Olson Oil Company in 1942, and according to the well plugging record has 156' of 10 3/4" surface pipe set.

After review of this matter by technical staff the depth to the bottom of usable water in the area was found to be at 125'. An exception to Table 1, Minimum Surface Casing Requirements is granted with the following stipulations:

1. In the event the well is dry and no production pipe has been cemented in place, plugging will be according to K.C.C. rules per K.C.C. District #1 requirements.

Very Sincerely Yours,

M. L. Korphage  
Director

cc: David P. Williams *OKDPW*  
Steve Durrant - Dist. #1 *OK*

RAYMOND OIL COMPANY, INC.

P. O. BOX 48788

ONE MAIN PLACE - SUITE 900

TELEPHONE 316-267-4214

WICHITA, KANSAS 67201

January 6, 1997

Mr. M. L. Korphage  
State of Kansas Corporation Commission  
Conservation Division  
130 S. Market  
Wichita, KS 67202

Re: Raymond Oil Company, Inc.  
Axline #1 OWWO  
C NE/4 NE/4 Section 16-31S-11W,  
Barber County, Kansas

Dear Mr. Korphage:

Pursuant to my telephone conversation with Jeff Klock, he recommended that we file an exception for surface pipe on the above referenced well which Raymond Oil Company, Inc. plans to re-enter. The Axline #1 was drilled by Olson Oil Co. in 1942, and according to records 10 3/4" surface pipe was set at 151 feet.

New Kansas Corporation Commission records of the immediate area indicate that the depth of usable water is at 120 feet in depth. A conversation with the tenant of the property indicates that there has been no contamination of the ground water that might have been caused by the Axline #1. It is, therefore, our opinion that the existing 151 feet of surface pipe is adequate to protect the ground water resources in the area.

Thank you for your consideration to this request. Should you need any other information please do not hesitate to call me at 316-267-4214, extension 108.

Yours truly,

RAYMOND OIL COMPANY, INC.



Tim Hellman,  
Geological Manager

TH/sh

RECEIVED  
KANSAS CORPORATION COMMISSION

JAN 06 1997

1-6-97

CONSERVATION DIVISION  
WICHITA, KS