

FOR KCC USE:

FORM C-1/7/91

FORM MUST BE TYPED

FORM MUST BE SIGNED

ALL BLANKS MUST BE FILLED

EFFECTIVE DATE: 12-17-97

State of Kansas

DISTRICT # 1  
SEAT Yes  No

NOTICE OF INTENTION TO DRILL

Must be approved by the K.C.C. five (5) days prior to commencing well

Expected Spud Date JANUARY 22 1998  
month day year

Spot SE SE SW Sec 33 Twp 16 S Rg 27 East West

OPERATOR: License # 31283  
Name: RHEM RESOURCES, INC.  
Address: 100 S. MAIN SUITE 505  
City/State/Zip: WICHITA, KS. 67202-3738  
Contact Person: WARREN TOMLINSON  
Phone: 316-262-5099

330 feet from South-North line of Section  
210-215 feet from East-West line of Section  
IS SECTION X REGULAR IRREGULAR?

(NOTE: Locate well on the Section Plat on Reverse Side)  
County: LANE

Lease Name: ANDERSON TRUST. Well #: 1  
Field Name: NONE PENNENNIS SW

Is this a Prorated/Spaced Field? yes X no  
Target Formation(s): KANSAS CITY - MARMATON

Nearest lease or unit boundary: 330  
Ground Surface Elevation: 2640 feet MSL

Water well within one-quarter mile: yes X no  
Public water supply well within one mile: yes X no

Depth to bottom of fresh water: 180  
Depth to bottom of usable water: 1250

Surface Pipe by Alternate: 1 X 2  
Length of Surface Pipe Planned to be set: 300'

Length of Conductor pipe required: NONE  
Projected Total Depth: 4650

Formation at Total Depth: MISSISSIPPIAN  
Water Source for Drilling Operations:

... well X farm pond ... other  
OUR Permit #: ...  
Will Cores Be Taken?: yes X no

If yes, proposed zone: ...

CONTRACTOR: License # 565 5184  
Name: Shields Drilling Co.  
(SHIELDS OIL PRODUCERS, INC.)  
Well Drilled For: Well Class: Type Equipment:  
X Oil ... Enh Rec ... Infield X Mud Rotary  
... Gas ... Storage X Pool Ext. ... Air Rotary  
... OWD ... Disposal X Wildcat ... Cable  
... Seismic; ... # of Holes ... Other

If OWD: old well information as follows:  
Operator: ...  
Well Name: ...  
Comp. Date: ... Old Total Depth ...

Directional, Deviated or Horizontal wellbore? yes X no  
If yes, true vertical depth: ...  
Bottom Hole Location: ...

AFFIDAVIT

The undersigned hereby affirms that the drilling, completion and eventual plugging of this well will comply with K.S.A. 55-101, et. seq.  
It is agreed that the following minimum requirements will be met:

- 1. Notify the appropriate district office prior to spudding of well;
- 2. A copy of the approved notice of intent to drill shall be posted on each drilling rig;
- 3. The minimum amount of surface pipe as specified below shall be set by circulating cement to the top; in all cases surface pipe shall be set through all unconsolidated materials plus a minimum of 20 feet into the underlying formation;
- 4. If the well is dry hole, an agreement between the operator and the district office on plug length and placement is necessary prior to plugging;
- 5. The appropriate district office will be notified before well is either plugged or production casing is cemented in;
- 6. IF AN ALTERNATE IS COMPLETION, PRODUCTION PIPE SHALL BE CEMENTED FROM BELOW ANY USABLE WATER TO SURFACE WITHIN 120 DAYS OF SPUD DATE. IN ALL CASES, NOTIFY DISTRICT OFFICE PRIOR TO ANY CEMENTING.

I hereby certify that the statements made herein are true and to the best of my knowledge and belief.  
Date: 12-8-97 Signature of Operator or Agent: Warren E. Tomlinson Title: Operations

FOR KCC USE:  
API # 15- 101-217550000  
Conductor pipe required NONE feet  
Minimum surface pipe required 200 feet per Alt. X(2)  
Approved by: JK 12-12-97  
This authorization expires: 6-12-98  
(This authorization void if drilling not started within 6 months of effective date.)  
Spud date: Agent:

REMEMBER TO:

- File Drill Pit Application (form GDP-1) with Intent to Drill;
- File Completion Form ACC-1 within 120 days of spud date;
- File acreage attribution plat according to field proration orders;
- Notify appropriate district office 48 hours prior to workover or re-entry;
- Submit plugging report (CP-4) after plugging is completed;
- Obtain written approval before disposing or injecting salt water.

12-12-97  
INT 12-12-97  
33  
16  
27W

**IN ALL CASES PLOT THE INTENDED WELL ON THE PLAT BELOW**

**PLAT OF ACREAGE ATTRIBUTABLE TO A WELL IN A PRORATED OR SPACED FIELD**

**If the intended well is in a prorated or spaced field, please fully complete this side of the form.** If the intended well is in a prorated or spaced field complete the plat below showing that the well will be properly located in relationship to other wells producing from the common source of supply. Please show all the wells within 1 mile of the boundaries of the proposed acreage attribution unit for gas wells and within 1/2 mile of the boundaries of the proposed acreage attribution unit for oil wells.

API NO. 15- \_\_\_\_\_  
 OPERATOR \_\_\_\_\_  
 LEASE \_\_\_\_\_  
 WELL NUMBER \_\_\_\_\_  
 FIELD \_\_\_\_\_

LOCATION OF WELL: COUNTY \_\_\_\_\_  
 \_\_\_\_\_ feet from south/north line of section  
 \_\_\_\_\_ feet from east/west line of section  
 SECTION \_\_\_\_\_ TWP \_\_\_\_\_ RG \_\_\_\_\_

NUMBER OF ACRES ATTRIBUTABLE TO WELL \_\_\_\_\_  
 QTR/QTR/QTR OF ACREAGE \_\_\_\_\_

IS SECTION \_\_\_\_\_ REGULAR or \_\_\_\_\_ IRREGULAR  
**IF SECTION IS IRREGULAR, LOCATE WELL FROM NEAREST CORNER BOUNDARY.**

Section corner used: \_\_\_\_\_ NE \_\_\_\_\_ NW \_\_\_\_\_ SE \_\_\_\_\_ SW

**PLAT**

(Show location of the well and shade attributable acreage for prorated or spaced wells.)  
 (Show footage to the nearest lease or unit boundary line.)

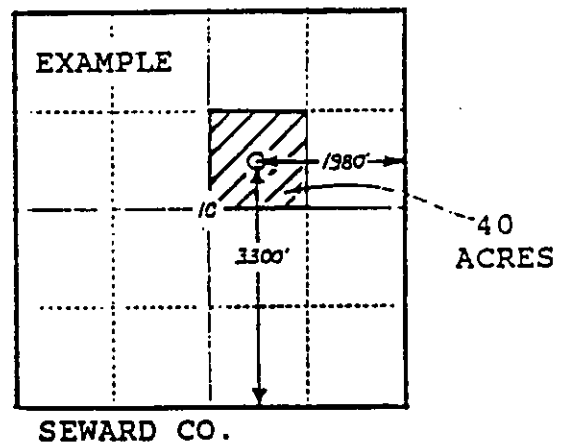
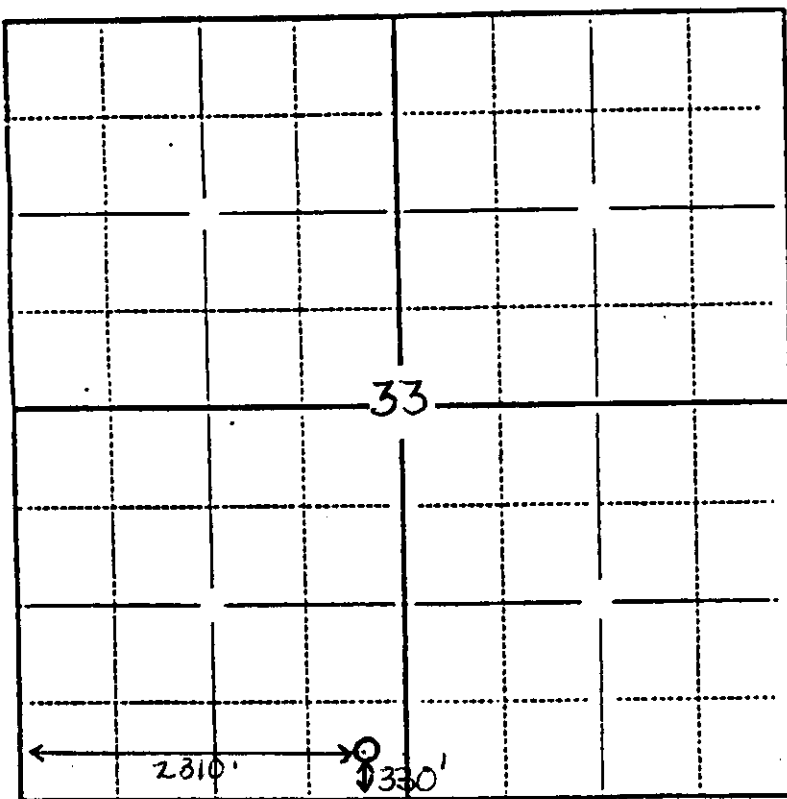

**In plotting the proposed location of the well, you must show:**

- 1) The manner in which you are using the depicted plat by identifying section lines, i.e. 1 section, 1 section with 8 surrounding sections, 4 sections, etc.;
- 2) the distance of the proposed drilling location from the section's south/north and east/west lines; and
- 3) the distance to the nearest lease or unit boundary line.