

WELL PLUGGING RECORD

15-101-20503-0000

Give All Information Completely
 Make Required Affidavit

COUNTY Lane SEC. 16 TWP. 20 RGE. 27N E/W
 Location as in quarters or footage from lines:
 C NE SW

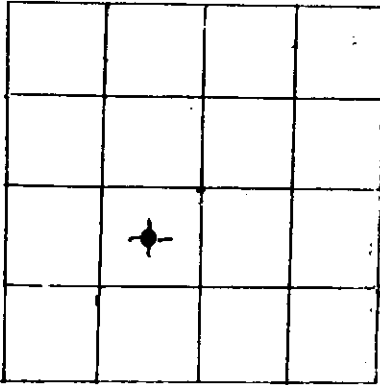

Locate Well
 correctly on above
 Section Platt.

Lease Owner Argonaut Energy Corporation
 Lease Name Hickel Well No. 1
 Office Address Box 4060 Amarillo, Texas 79116-4060
 Character of Well (Completed as Oil, Gas or Dry Hole): Dry
 Date Well Completed 2/28/81
 Application for plugging filed 9-6-83
 Plugging commenced 9-23-83
 Plugging completed 9-26-83
 Reason for abandonment of well or producing formation Dry

Was permission obtained from the Conservation Division or it's Agent's before plugging was commenced? Yes

Name of Conservation Agent who supervised plugging of this well Paul Luthi
 Producing formation _____ Depth to top _____ bottom _____ T.D. 5000

Show depth and thickness of all water, oil and gas formations.

OIL, GAS OR WATER RECORDS Casing Record

Formation	Content	From	To	Size	Put in	Pulled Out
				8 5/8	230	none
				4 1/2	4780	2012

Describe in detail the manner in which the well was plugged, indicating where the mud fluid was placed and the method or methods used in introducing it into the hold. If cement or other plugs were used, state the character of same and depth placed, from _____ feet to _____ feet for each plug set.

- Pump 20 sks. of cement & 1 sk. of hull's @ 4691 to 4450
- Pump 50 sks. of cement @ 330 to 230
- Put 10 sks. of cement @ 40 to 0
- Out off & cap 8 5/8 3' below ground level.

(If additional description is necessary, use BACK of this sheet)

Name of Plugging Contractor Sarrents Casing Pulling Service Box 506 Liberal, Kansas 67901

STATE OF Texas COUNTY OF Potter, ss.

Billy D. Johnson, ARGONAUT ENERGY CORP. (employee of owner) or (owner or operator) of the above-described well, being first duly sworn on oath, says: That I have knowledge of the facts, statements, and matters herein contained and the log of the above-described well as filed and that the same are true and correct. So help me God.

(Signature) Billy D. Johnson
 P. O. Box 4060, Amarillo, Texas,
 (Address) 79116-4060

SUBSCRIBED AND SWORN TO before me this 17th day of October, 19 83

LOIS B. YATES

Notary Public, State of Texas

My Commission Expires July 27, 1985

My Commission expires: 7/27/85

Lois B. Yates
 Notary Public.

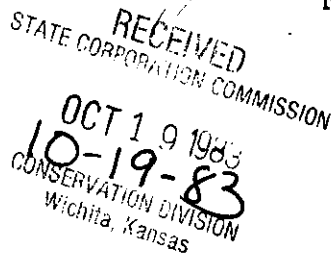

KANSAS

WELL COMPLETION REPORT AND DRILLER'S LOG

S. 16 T. 20 R. 27 ^N/_W

Loc. C NE SW

API No. 15 — 101 — 20,503 ^{State Geological Survey}
County Number WICHITA BRANCH

Operator
Argonaut Energy Corp.

Address
P. O. Box 4060 Amarillo, Texas 79106

Well No. #1 Lease Name Hickel

Footage Location
1980' feet from (N) (S) line 1980 feet from (E) (W) line

Principal Contractor
Blue Goose Drilling Company

Geologist

Spud Date 1/15/81 Date Completed 1/28/81 Total Depth 5000' P.B.T.D. 4610'

Directional Deviation Oil and/or Gas Purchaser

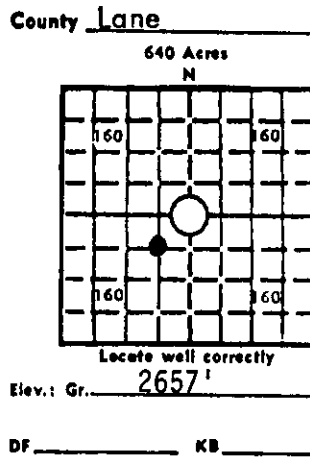

CASING RECORD

Report of all strings set — surface, intermediate, production, etc.

Purpose of string	Size hole drilled	Size casing set (in O.D.)	Weight lbs/ft.	Setting depth	Type cement	Secks	Type and percent additives
Surface	12 1/4	8 5/8"	23#	286'	Common	185	3% CaCl + 2% gel.
Production		4 1/2"	10.5#	4780'	Class A	35	
					Poz	300	10% Salt + .75 of 1% CFR-2

LINER RECORD

PERFORATION RECORD CIBP 4660'-4610'

Top, ft.	Bottom, ft.	Secks cement	Shots per ft.	Size & type	Depth interval
					4558' - 68'
					4545' - 51'

TUBING RECORD

Size	Setting depth	Pecker set at

ACID, FRACTURE, SHOT, CEMENT SQUEEZE RECORD

Amount and kind of material used	Depth interval treated
Acidize w/500 gal. 15% HF MCA	4545' - 68'

INITIAL PRODUCTION

Date of first production P & A	Producing method (flowing, pumping, gas lift, etc.)
RATE OF PRODUCTION PER 24 HOURS	Oil Gas Water Gas-oil ratio
Disposition of gas (vented, used on lease or sold)	Producing interval(s)

INSTRUCTIONS: As provided in KCC Rule 82-2-125, within 90 days after completion of a well, one completed copy of this Drillers Log shall be transmitted to the State Geological Survey of Kansas, 4150 Monroe Street, Wichita, Kansas 67209. Copies of this form are available from the Conservation Division, State Corporation Commission, 245 No. Water, Wichita, Kansas 67202. Phone AC 316-522-2206. If confidential custody is desired, please note Rule 82-2-125. Drillers Logs will be on open file in the Oil and Gas Division, State Geological Survey of Kansas, Lawrence, Kansas 66044.

C-10-1972

FROM	TO	
0	287	Shale
287	1722	Shale & Sand
1722	3570	Shale
3570	4542	Shale & Lime
4542	4557	Core Miss.
4557	4597	Lime & Shale
4597	4605	Core
4605	5000	Lime & Shale
5000		T.D.

RECEIVED
 STATE CORPORATION COMMISSION
AUG 29 1981
 CONSERVATION DIVISION
 Wichita, Kansas

Operator Argonaut Energy Corporation		DESIGNATE TYPE OF COMP. OIL, GAS, DRY HOLE, SWDW, ETC.: Dry
Well No. 1	Lease Name Hickel	
s <u>16 T 20</u> R <u>27</u> ^R / _W		

WELL LOG

Show all important zones of porosity and contents thereof; cored intervals, and all drill-stem tests, including depth interval tested, cushion used, time tool open, flowing and shut-in pressures, and recoveries.

SHOW GEOLOGICAL MARKERS, LOGS RUN, OR OTHER DESCRIPTIVE INFORMATION.

FORMATION DESCRIPTION, CONTENTS, ETC.	TOP	BOTTOM	NAME	DEPTH
K.B. 2662			Logs:	
Cimmaron	1952'		BHC Sonic 261' - 4988'	
Stotler	3449'		Compensated Density	
Topeka	3636'		Compensated Neutron Log	
Heebner	3904'		259' - 500'	
Lansing	3948'		Dual Induction Laterlog	
Base of Kansas City		4334'	286' - 500'	
Marmaton	4343'		Dipmeter	
Fort Scott Shale	4469'		2947' - 4995'	
Cherokee	4494'		DST #1	
(DST #1)			4527' - 4605'	
Mississippian	4556'		30 - 60 - 120 - 240 min.	
(DST #1)			IHP 2126 FFP 280 - 74	
Kinderhook	4630'		IFP 28 - 280 FSIP 1248	
Viola	4732'		ISIP 1258 FHP 2126	
Simpson	4868'		Rec. 3' oil, 10' oil cut mud,	
Arbuckle	4881'		186' slightly oil cut mud, 1178	
T.D.	5000'		water. Core: 4542' - 4574'	
			Core stored at Kansas Geological Survey.	

USE ADDITIONAL SHEETS, IF NECESSARY, TO COMPLETE WELL RECORD.

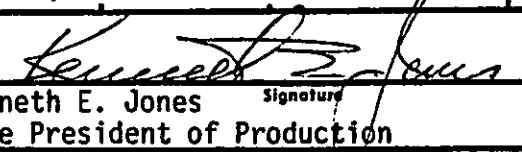
Date Received	 _____ Kenneth E. Jones Vice President of Production _____ Signature
	_____ Title
	_____ September 17, 1981 _____ Date

10/17/81
 10/17/81
 10/17/81