

API NUMBER 15-101-20,381-0000

LEASE NAME Hilgenberg

WELL NUMBER 1

1980 Ft. from S Section Line

660 Ft. from E Section Line

SEC. 36 TWP. 18 RGE. 29 (E) or (W)

COUNTY Lane

Date Well Completed 05-15-79

Plugging Commenced 12-02-94

Plugging Completed 12-02-94

TYPE OR PRINT
NOTICE: Fill out completely
and return to Cons. Div.
office within 30 days.

LEASE OPERATOR A.L. Abercrombie, Inc.

ADDRESS R.R. 1, Box 56, Great Bend, Kansas 67530

PHONE# (316) 793-8186 OPERATORS LICENSE NO. 5393

Character of Well oil

(Oil, Gas, O&A, SWD, Input, Water Supply Well)

The plugging proposal was approved on 11-04-94 (date)

by Duane Rankin (KCC District Agent's Name).

Is ACO-1 filed? Yes If not, is well log attached? N/A

Producing Formation Lansing Depth to top 4242' Bottom 4245' T.O. 4650'

Show depth and thickness of all water, oil and gas formations.

OIL, GAS OR WATER RECORDS

CASING RECORD

Formation	Content	From	To	Size	Put In	Pulled out
	Surface	0	25'	8.5/8"	25'	0
	Production	0	4372'	4 1/2"	4372'	785'

Describe in detail the manner in which the well was plugged, indicating where the mud fluid was placed and the method or methods used in introducing it into the hole; if cement or other plug were used, state the character of same and depth placed, - from foot to foot each set
Sanded to 4150' 4 sacks of cement. Allied pumped 80 sacks of cement at 1300, 40 sacks at 600'
40 sacks at 300' topped off with 10 sacks. 60/40 poz 6% gel

Name of Plugging Contractor D.S. & W. Well Servicing, Inc. License No. 6901

Address P.O. Box 231, Claflin, Kansas 67525

NAME OF PARTY RESPONSIBLE FOR PLUGGING FEES: A.L. Abercrombie, Inc.

STATE OF Kansas COUNTY OF Barton, ss.

Arthur P. Strube

(Employee of Operator or Operator) of above-described well, being first duly sworn on oath, says: That I have knowledge of the facts statements, and matters herein contained and the log of the above-described well was filed the the same are true and correct, so help me God.

(Signature) Arthur P. Strube

(Address) P.O. Box 231, Claflin, Kansas 67525

SUBSCRIBED AND SWORN TO before me this 8th day of December, 1994

Karlynn K. Beck
Notary Public

My Commission Expires: 09-28-94

USE ONLY ONE SIDE OF EACH FORM

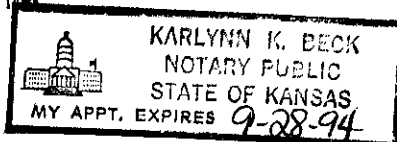

APR 16 1979

IMPORTANT
Kans. Geo. Survey request
samples on this well.

KANSAS DRILLERS LOG

S. 36 T. 18 R. 29 ^W

Loc. C SW NW

County Lane

API No. 15 — 101 — 20,381 ~~0000~~
County Number

Operator
Abercrombie Drilling, Inc., and Moble C. Hoover

Address 801 Union Center Wichita, Kansas 67202

Well No. #1 Lease Name Hilgenberg

Footage Location
1980 feet from (N) ~~(S)~~ line 660 feet from ~~(E)~~ (W) line

Principal Contractor Abercrombie Drilling, Inc Geologist Orlin Phelps

Spud Date May 15, 1979 Total Depth 4650' P.B.T.D. 4333'

Date Completed May 27, 1979 Oil Purchaser Murphy Oil Co. & Clear

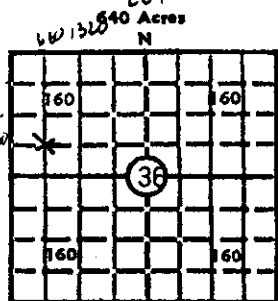

Locate well correctly
2778'

Elev.: Gr. 2778'

DF. 2781' KB 2783'

CASING RECORD Creek, Inc.

Report of all strings set — surface, intermediate, production, etc.

Purpose of string	Size hole drilled	Size casing set (in O.D.)	Weight lbs/ft.	Setting depth	Type cement	Sacks	Type and percent additives
Surface	12 1/4"	8-5/8"		257'	common	200	3% Ca.Cl. 2% gel.
Production		4 1/2"	10 1/2#	4372'	50/50 posmix common	75 125	2% gel, 12 1/2# gilsin 2% gel, salt sat.

LINER RECORD

PERFORATION RECORD

Top, ft.	Bottom, ft.	Sacks cement	Shots per ft.	Size & type	Depth interval
			4		4242' - 4245'

TUBING RECORD

Size	Setting depth	Packer set at

ACID, FRACTURE, SHOT, CEMENT SQUEEZE RECORD

Amount and kind of material used	Depth interval treated
500 gallons, 15% Non-E	4242' - 4245'

INITIAL PRODUCTION

Date of first production <u>08-03-79</u>		Producing method (flowing, pumping, gas lift, etc.) <u>Pumping</u>			
RATE OF PRODUCTION PER 24 HOURS	Oil <u>7 0</u> bbis.	Gas <u>--</u> MCF	Water <u>30%</u> bbis.	Gas-oil ratio <u>--</u>	CFPB
Disposition of gas (vented, used on lease or sold) <u>--</u>			Producing interval (s) <u>4242' - 4245'</u>		

INSTRUCTIONS: As provided in KCC Rule 82-2-125, within 90 days after completion of a well, one completed copy of this Drillers Log shall be transmitted to the State Geological Survey of Kansas, 4150 Monroe Street, Wichita, Kansas 67209. Copies of this form are available from the Conservation Division, State Corporation Commission, 3830 So. Meridian (P.O. Box 17027), Wichita, Kansas 66217. Phone AC 316-522-2206. If confidential custody is desired, please note Rule 82-2-125. Drillers Logs will be on open file in the Oil and Gas Division, State Geological Survey of Kansas, Lawrence, Kansas 66044.

Operator **Abercrombie Drilling, Inc. and Moble C. Hoover** DESIGNATE TYPE OF COMP.: OIL, GAS, DRY HOLE, SWDW, ETC.: **Oil**

Well No. **1** Lease Name **Hilgenberg**

s. 36 T18SR29W^E

WELL LOG

Show all important zones of porosity and contents thereof; cored intervals, and all drill-stem tests, including depth interval tested, cushion used, time tool open, flowing and shut-in pressures, and recoveries.

SHOW GEOLOGICAL MARKERS, LOGS RUN, OR OTHER DESCRIPTIVE INFORMATION.

FORMATION DESCRIPTION, CONTENTS, ETC.	TOP	BOTTOM	NAME	DEPTH
Clay, sand and shale	0	260	SAMPLE TOPS:	
Sand and shale	260	1682		
Sand	1682	1849	Anhydrite	2133' (+ 650)
Sand and shale	1849	2134	B/Anhydrite	2162' (+ 621)
Anhydrite	2134	2162	Heebner	3941' (-1158)
Shale	2162	4063	Toronto	3958' (-1175)
Shale and lime	4063	4248	Lansing	3985' (-1202)
Lime	4248	4650	Stark	4262' (-1505)
Rotary Total Depth		4650	Ft. Scott	4508' (-1725)
			Cherokee	4532' (-1749)
DST #1 (4196-4223') 30", 45", 60", 45" Rec. 60' gip, 165' cl oil, 155' muddy oil, 60' hocrn, trace of water, 180' soc mdy wtr IFP 43-97, IBHP 1215, FFP 129-237, FBHP 1162. Temp. 112°			ELECTRIC LOG TOPS:	
DST #2 (4231-4248') 30", 45", 60", 45" Rec. 430' gip, 670' cl gsy oil, 320' socm IFP 54-205, IBHP 1215, FFP 248-377, FBHP 1205. Temp. 112°			Anhydrite	2134' (+ 649)
DST #3 (4260-4274') 30", 45", 60", 45" Rec. 2400' socsw. IFP 108-612, IBHP 1236, FFP 676-1068, FBHP 1236. Temp. 120°			Heebner	3943' (-1160)
DST #4 (4296-4315') 30", 45", 60", 45" Rec. 10' oil, 200' vsocw. IFP 22-43, IBHP 1120, FFP 65-97, FBHP 1120			Toronto	3962' (-1179)
DST #5 (4358-4380') 30", 30", 30", 30" Rec. 2' mud. IFP 22-22, IBHP 22, FFP 22-22, FBHP 22 Temp. 110°			Lansing	3987' (-1204)
			B/KC	4362' (-1579)
			Ft. Scott	4513' (-1730)
			Miss.	4601' (-1818)
			RTD	4650'
			LTD	4655'

USE ADDITIONAL SHEETS, IF NECESSARY, TO COMPLETE WELL RECORD.

RECEIVED
STATE CORPORATION COMMISSION
11-3-94
NOV 03 1994

Date Received _____

Jack L. Partridge
Signature

Jack L. Partridge, Asst. Sec.-Treas.
Title

September 13, 1979
Date