

15.101.20524.0000

STATE OF KANSAS  
STATE CORPORATION COMMISSION

WELL PLUGGING RECORD

Give All Information Completely  
Make Required Affidavit  
Mail or Deliver Report to  
Conservation Division  
State Corporation Comm.  
245 North Water  
Wichita, KS 67202

Lane \_\_\_\_\_ County, Sec. 24 Twp. 18S Rge. 30W E/W  
Location as "NE/CNW $\frac{1}{2}$ SW $\frac{1}{4}$ " or footage from lines \_\_\_\_\_

SE SW NE  
Lease Owner Beren Corporation  
Lease Name Owen # 1 Well No. \_\_\_\_\_  
Office Address 970 Fourth Financial Center; Wichita, KS 67202  
Character of Well (Completed as Oil, Gas or Dry Hole) \_\_\_\_\_

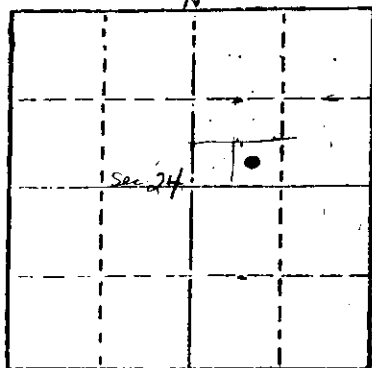

Locate well correctly on above Section Plot

DRY HOLE  
Date Well completed April 1, 1981  
Application for plugging filed 4-1-81 1981  
Application for plugging approved 4-1- 1981  
Plugging commenced 4-1- 1981  
Plugging completed 4-1-81 1981  
Reason for abandonment of well or producing formation \_\_\_\_\_

DRY HOLE  
If a producing well is abandoned, date of last production \_\_\_\_\_ 19\_\_\_\_

Was permission obtained from the Conservation Division or its agents before plugging was commenced? YES

Name of Conservation Agent who supervised plugging of this well Gilbert Balthazor  
Producing formation \_\_\_\_\_ Depth to top \_\_\_\_\_ Bottom \_\_\_\_\_ Total Depth of Well \_\_\_\_\_  
Show depth and thickness of all water, oil and gas formations.

OIL, GAS OR WATER RECORDS

CASING RECORD

FORMATION	CONTENT	FROM	TO	SIZE	PUT IN	PULLED OUT
		0	369'	8 5/8	364	0

Describe in detail the manner in which the well was plugged, indicating where the mud fluid was placed and the method or methods used in introducing it into the hold. If cement or other plugs were used, state the character of same and depth placed, from \_\_\_\_\_ feet to \_\_\_\_\_ feet for each plug set.

T.D. 466.5' 1st Plug 900' with 60 Sacks Cement 50-50 Poz 6 % Gel  
2nd Plug 380; with 30 Sacks  
Solid Bridge 40' with 10 Sacks  
Rathole 5 Sacks  
Mousehole 5 Sacks Plugged down @ 5:30 P.M. 4-1-81

(If additional description is necessary, use BACK of this sheet)

Name of Plugging Contractor Blue Goose Drilling Company, Inc.

4-7-81

STATE OF KANSAS COUNTY OF Barton, ss.  
George E. Miller, Jr. (~~engrayer~~) or (owner or operator)  
of the above-described well, being first duly sworn on oath, says: That I have knowledge of the facts, statements, and matters herein contained and the log of the above-described well as filed and that the same are true and correct. So help me God.

(Signature) George E. Miller, Jr.  
P.O. Box 1413; Great Bend, KS 67530  
(Address)

SUBSCRIBED AND SWORN TO before me this 2nd day of April, 19 81

Helen C. Standley  
Notary Public.

My commission expires 12-8-83

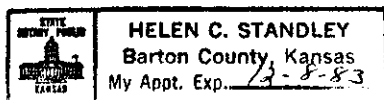

WELL LOG

OWENS #1  
SE SW NE Sec 24-18S-30W  
Lane County, KS

15-101-20524-0000

NAME OF OPERATOR: Beren Corporation  
970 Fourth Financial Center  
Wichita, KS 67202

DATE COMPLETED: April 1, 1981

FROM	TO	
0	369	Surface
369	2217	Sand and Shale
2217	2236	Anhydrite
2236	3385	Sand and Shale
3385	3795	Shale
3795	3969	Lime and Shale
3969	4055	Lime
4055	4241	Shale and Lime
4241	4285	Lime
4285	4592	Lime and Shale
4592	4630	Lime
4630	4665	Lime and Shale
4665		T.D.

STATE OF KANSAS

COUNTY OF BARTON ss

George E. Miller, Jr., President of Blue Goose Drilling Com., Inc.  
being first duly sworn on oath says: That I have knowledge of the  
facts, statements and matters herein contained and the log of the above  
described well as filed and that the same are true and correct.

4-7-81  
*George E. Miller, Jr.*  
George E. Miller, Jr.

Subscribed and sworn before me this 3rd Day of April 1981.

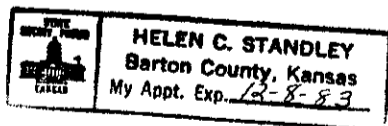

*Helen C. Standley*  
Notary Public

My Commission Expires: 12-8-83