

FOR KCC USE:

EFFECTIVE DATE: 10-23-91

DISTRICT #

SEAT Yes No

State of Kansas

NOTICE OF INTENTION TO DRILL

Must be approved by the K.C.C. five (5) days prior to commencing well

FORM C-1 7/91

FORM MUST BE TYPED

FORM MUST BE SIGNED

ALL BLANKS MUST BE FILLED

P.U.

Expected Spud Date 10 - 26 - 1991 month day year

Spot NE SW NW Sec 16 Twp 18S S, Rg 30 West East

OPERATOR: License # 5123 Name: Pickrell Drilling Company, Inc. Address: 110 N. Market, Suite 205 City/State/Zip: Wichita, Kansas 67202 Contact Person: Don Beauchamp Phone: 316-262-8427

3630 feet from South / XXXX line of Section 4290 feet from East / XXXX line of Section IS SECTION X REGULAR IRREGULAR

(NOTE: Locate well on the Section Plat on Reverse Side) County: Lane Lease Name: Burnett "D." Well #: 1 Field Name: Wildcat

CONTRACTOR: License #: 5123 Name: Company Tools

Is this a Prorated/Spaced Field? yes X no Target Formation(s): Lansing, Marmaton, Mississippi

Well Drilled For: Well Class: Type Equipment: X Oil Enh Rec Infield X Mud Rotary Gas Storage Pool Ext Air Rotary OWD Disposal X Wildcat Cable Seismic: # of Holes Other

Nearest lease or unit boundary: 990' Ground Surface Elevation: 2901 feet MSL Water well within one-quarter mile: yes X no

If OWD: old well information as follows: Operator: Well Name: Comp. Date: Old Total Depth

Public water supply well within one mile: yes X no Depth to bottom of fresh water: 118' Depth to bottom of usable water: 1040' 1150'

Directional, Deviated or Horizontal wellbore? yes X no If yes, true vertical depth: Bottom Hole Location:

Surface Pipe by Alternate: 1 X 2 Length of Surface Pipe Planned to be set: 225 Length of Conductor pipe required: None

Projected Total Depth: 4600' Formation at Total Depth: Mississippian

Water Source for Drilling Operations: well farm pond X other DWR Permit #: Will Cores Be Taken? yes X no

AFFIDAVIT

The undersigned hereby affirms that the drilling, completion and eventual plugging of this well will comply with K.S.A. 55-101, et. seq. It is agreed that the following minimum requirements will be met:

- 1. Notify the appropriate district office prior to spudding of well; 2. A copy of the approved notice of intent to drill shall be posted on each drilling rig; 3. The minimum amount of surface pipe as specified below shall be set by circulating cement to the top; in all cases surface pipe shall be set through all unconsolidated materials plus a minimum of 20 feet into the underlying formation; 4. If the well is dry hole, an agreement between the operator and the district office on plug length and placement is necessary prior to plugging; 5. The appropriate district office will be notified before well is either plugged or production casing is cemented in; 6. IF AN ALTERNATE II COMPLETION, PRODUCTION PIPE SHALL BE CEMENTED FROM BELOW ANY USABLE WATER TO SURFACE WITHIN 120 DAYS OF SPUD DATE. IN ALL CASES, NOTIFY DISTRICT OFFICE PRIOR TO ANY CEMENTING.

I hereby certify that the statements made herein are true and to the best of my knowledge and belief. Date: 10-17-91 Signature of Operator or Agent: Don Beauchamp Title: Geologist



FOR KCC USE: API # 15- 101-21604-0000 Conductor pipe required 110 feet Minimum surface pipe required 200 feet per Alt. (2) Approved by: 10-18-91 This authorization expires: 4-18-92 (This authorization void if drilling not started within 6 months of effective date.) Spud date: Agent:

RECEIVED 16 18 3000 OCT 17 1991 10-17-91 CONSERVATION DIVISION WICHITA, KS (KANSAS CORPORATION COMMISSION)

- REMEMBER TO: - File Drill Pit Application (form CDP-1) with Intent to Drill; - File Completion Form ACD-1 within 120 days of spud date; - File acreage attribution plat according to field proration orders; - Notify appropriate district office 48 hours prior to workover or re-entry; - Submit plugging report (CP-4) after plugging is completed; - Obtain written approval before disposing or injecting salt water.

Mail to: Conservation Division, 200 Colorado Derby Building, 202 W. First St., Wichita, Kansas 67202-1286.

IN ALL CASES PLOT THE INTENDED WELL ON THE PLAT BELOW

**PLAT OF ACREAGE ATTRIBUTABLE TO A WELL IN A PRORATED OR SPACED FIELD**

If the intended well is in a prorated or spaced field, please fully complete this side of the form. If the intended well is in a prorated or spaced field complete the plat below showing that the well will be properly located in relationship to other wells producing from the common source of supply. Please show all the wells within 1 mile of the boundaries of the proposed acreage attribution unit for gas wells and within 1/2 mile of the boundaries of the proposed acreage attribution unit for oil wells.

API NO. 15- \_\_\_\_\_  
OPERATOR \_\_\_\_\_  
LEASE \_\_\_\_\_  
WELL NUMBER \_\_\_\_\_  
FIELD \_\_\_\_\_

LOCATION OF WELL: COUNTY \_\_\_\_\_  
\_\_\_\_\_ feet from south/north line of section  
\_\_\_\_\_ feet from east/west line of section  
SECTION \_\_\_\_\_ TWP \_\_\_\_\_ RG \_\_\_\_\_

NUMBER OF ACRES ATTRIBUTABLE TO WELL \_\_\_\_\_  
QTR/QTR/QTR OF ACREAGE \_\_\_\_\_

IS SECTION \_\_\_\_\_ REGULAR or \_\_\_\_\_ IRREGULAR  
IF SECTION IS IRREGULAR, LOCATE WELL FROM NEAREST CORNER BOUNDARY.

Section corner used: \_\_\_\_\_ NE \_\_\_\_\_ NW \_\_\_\_\_ SE \_\_\_\_\_ SW

**PLAT**

(Show location of the well and shade attributable acreage for prorated or spaced wells.)  
(Show footage to the nearest lease or unit boundary line.)

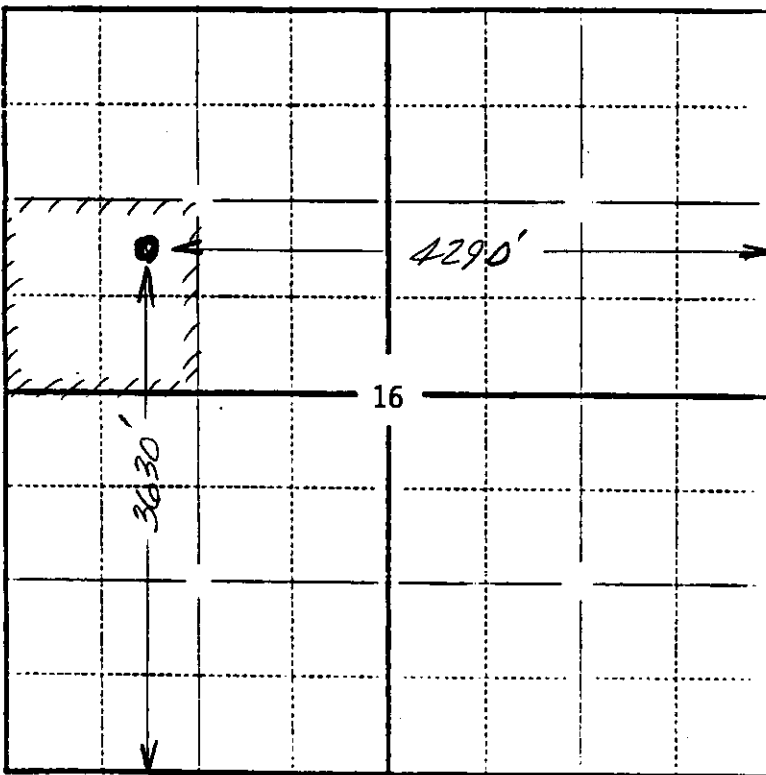

ONE SECTION

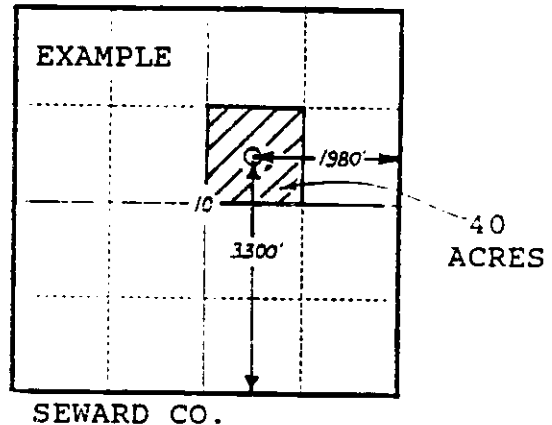

NOV 19 1961

In plotting the proposed location of the well, you must show:

- 1) The manner in which you are using the depicted plat by identifying section lines, i.e. 1 section, 1 section with 8 surrounding sections, 4 sections, etc.;
- 2) the distance of the proposed drilling location from the section's south/north and east/west lines; and
- 3) the distance to the nearest lease or unit boundary line.