

FOR KCC USE:

EFFECTIVE DATE: 5-19-92

DISTRICT # 1

SEAT Yes No

State of Kansas
NOTICE OF INTENTION TO DRILL

Must be approved by the K.C.C. five (5) days prior to commencing well

FORM MUST BE TYPED
FORM MUST BE SIGNED
ALL BLANKS MUST BE FILLED

Expected Spud Date May 21 1992
month day year

Spot C NE SW Sec 30 Twp 18 S Rg 31 East West

OPERATOR: License # 5386
Name: Production Drilling Inc
Address: P.O. Box 680
City/State/Zip: Hays, KS 67601-0680
Contact Person: Larry Patterson
Phone: (913) 625-1189

1980 feet from South/North line of Section
1980 feet from East/West line of Section
IS SECTION REGULAR IRREGULAR

CONTRACTOR: License # 30606
Name: Murfin Drilling Co

(NOTE: Locate well on the Section Plat on Reverse Side)
County: Scott Pfenninger
Lease Name: #6 Backley Well #: 1
Field Name:

Well Drilled For: Well Class: Type Equipment:
X Oil Enh Rec Infield X Mud Rotary
Gas Storage Pool Ext Air Rotary
OAWD Disposal X Wildcat Cable
Seismic # of Holes Other

Is this a Prorated/Spaced Field? yes X no
Target formation(s): LKC - MISS
Nearest lease or unit boundary: 660

If OAWD, old well information as follows:
Operator:
Well Name:
Comp. Date: Old Total Depth

Ground Surface Elevation: 2980 feet MSL
Water well within one-quarter mile: yes X no
Public water supply well within one mile: yes X no

Directional, Deviated or Horizontal wellbore? yes X no
If yes, true vertical depth:
Bottom Hole Location:

Depth to bottom of fresh water: 200
Depth to bottom of usable water: ?
Surface Pipe by Alternate: 1 X 2
Length of Surface Pipe Planned to be set: 250
Length of Conductor pipe required: 4600

Projected Total Depth:
Formation at Total Depth: Mississippi
Water Source for Drilling Operations:
well farm pond X other

AFFIDAVIT

The undersigned hereby affirms that the drilling, completion and eventual plugging of this well will comply with K.S.A. 55-101, et. seq.
It is agreed that the following minimum requirements will be --

- 1. Notify the appropriate district office prior to spudding of well;
2. A copy of the approved notice of intent to drill shall be posted on each drilling rig;
3. The minimum amount of surface pipe as specified below shall be set by circulating cement to the top; in all cases surface pipe shall be set through all unconsolidated materials plus a minimum of 20 feet into the underlying formation;
4. If the well is dry hole, an agreement between the operator and the district office on plug length and placement is necessary prior to plugging;
5. The appropriate district office will be notified before well is either plugged or production casing is cemented in;
6. IF AN ALTERNATE IS COMPLETED, PRODUCTION PIPE SHALL BE CEMENTED FROM BELOW ANY USABLE WATER TO SURFACE WITHIN 120 DAYS OF SPUD DATE. IN ALL CASES, NOTIFY DISTRICT OFFICE PRIOR TO ANY CEMENTING.

I hereby certify that the statements made herein are true and to the best of my knowledge and belief.

Date: May 12, 1992. Signature of Operator or Agent: [Signature] Title: President, Production Drilling Inc

FOR KCC USE:
API # 15-171-20445-0000
Conductor pipe required None feet
Minimum surface pipe required 200 feet per Alt. X(2)
Approved by: [Signature] 5-14-92
This authorization expires: 11-14-92
(This authorization void if drilling not started within 6 months of effective date.)
Spud date: Agent:

REMEMBER TO:

- File Drill Pit Application (form COP-1) with Intent to Drill;
File Completion Form ACO-1 within 120 days of spud date;
File acreage attribution plat according to field proration orders;
Notify appropriate district office 48 hours prior to workover or re-entry;
Submit plugging report (CP-4) after plugging is completed;
Obtain written approval before disposing or injecting salt water.

Mail to: Conservation Division, 200 Colorado Derby Building, 202 W. First St., Wichita, Kansas 67202-1286.

RECEIVED
MAY 14 1992
COMMISSION
CONSERVATION DIVISION
Wichita, Kansas

30
18
31

IN ALL CASES PLOT THE INTENDED WELL ON THE PLAT BELOW.

PLAT OF ACREAGE ATTRIBUTABLE TO A WELL IN A PRORATED OR SPACED FIELD

If the intended well is in a prorated or spaced field, please fully complete this side of the form. If the intended well is in a prorated or spaced field complete the plat below showing that the well will be properly located in relationship to other wells producing from the common source of supply. Please show all the wells within 1 mile of the boundaries of the proposed acreage attribution unit for gas wells and within 1/2 mile of the boundaries of the proposed acreage attribution unit for oil wells.

API NO. 15- _____
 OPERATOR Production Drilling Inc
 LEASE Pfenninger
 WELL NUMBER #1
 FIELD W/C

LOCATION OF WELL: COUNTY Scott
~~1650~~ 1980 feet from south/north line of section
1980 feet from east/~~west~~ line of section
 SECTION 30 TWP 18 RG 31

NUMBER OF ACRES ATTRIBUTABLE TO WELL 40
 QTR/QTR/QTR OF ACREAGE C - NE - SW

IS SECTION REGULAR or IRREGULAR
 IF SECTION IS IRREGULAR, LOCATE WELL FROM NEAREST CORNER BOUNDARY.

Section corner used: NE NW SE SW

PLAT

(Show location of the well and shade attributable acreage for prorated or spaced wells.)
 (Show footage to the nearest lease or unit boundary line.)

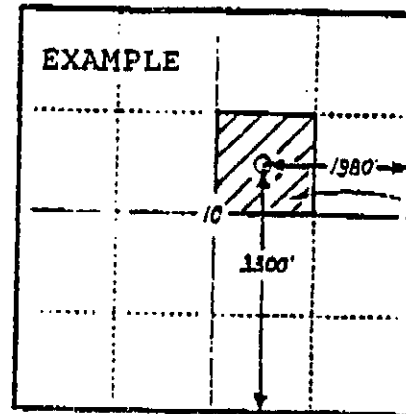
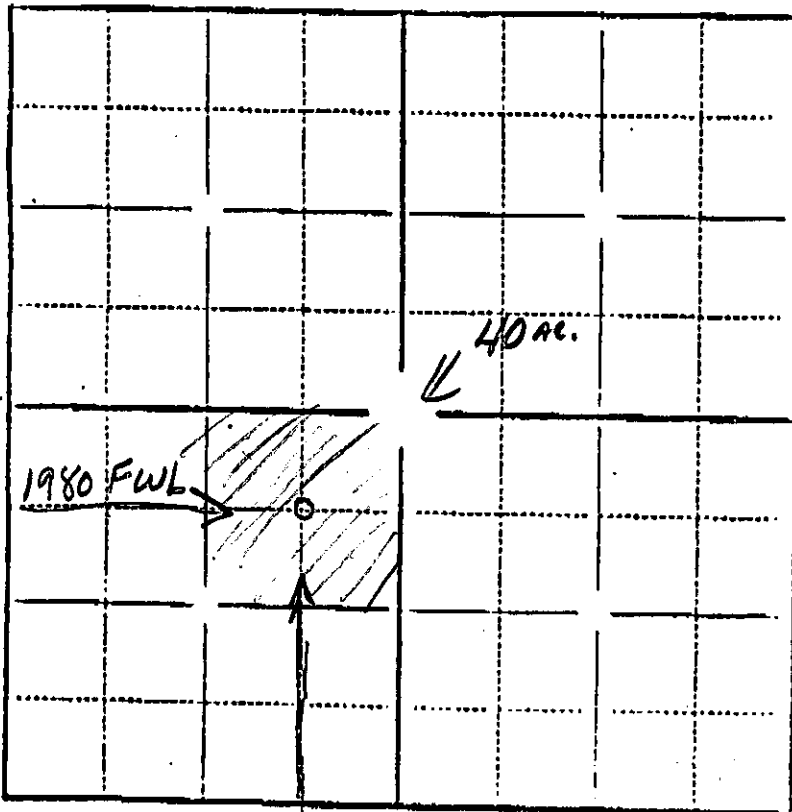

40 ACRES

In plotting the proposed location of the well, you must show:

- 1) The manner in which you are using the depicted plat by identifying section lines, 1 section, 1 section with 8 surrounding sections, 4 sections, etc.;
- 2) the distance of the proposed drilling location from the section's south and east/west lines; and
- 3) the distance to the nearest lease or unit boundary line.

RECEIVED
 STATE OF KANSAS
 COMMISSION
 MAY 14 1992
 5-14-92
 CONSERVATION DIVISION
 Wichita, Kansas