

ORIC VA

CONFIDENTIAL  
SIDE ONE

REL 9/27/90  
7/27/90  
OCT 9 8 1991

STATE CORPORATION COMMISSION OF KANSAS  
OIL & GAS CONSERVATION DIVISION  
WELL COMPLETION FORM  
ACO-1 WELL HISTORY  
DESCRIPTION OF WELL AND LEASE

Operator: License # 3988  
Name: SLAWSON EXPLORATION COMPANY, INC.  
Address 104 S. Broadway, Suite 200  
City/State/Zip Wichita, Kansas 67202-4165

Purchaser: na  
Operator Contact Person: James C. Remsberg  
Phone ( 316 ) 263-3201

Contractor: Name: L. D. Drilling, Inc.  
License: 6039  
Wellsite Geologist: Kim Shoemaker

Designate Type of Completion  
 New Well  Re-Entry  Workover  
 Oil  SWD  Temp. Abd.  
 Gas  Inj  Delayed Comp.  
 Dry  Other (Core, Water Supply, etc.)

If OWO: old well info as follows:  
Operator: \_\_\_\_\_  
Well Name: \_\_\_\_\_  
Comp. Date \_\_\_\_\_ Old Total Depth \_\_\_\_\_

Drilling Method:  
 Mud Rotary  Air Rotary  Cable KEC  
8-19-89 8-29-89 8-29-89  
Spud Date Date Reached TD Completion Date

API NO. 15- 171-20,394-0000  
County SCOTT FROM CONFIDENTIAL  
C NW Sec. 20 Twp. 18S Rge. 31  East  
3990 Ft. North from Southeast Corner of Section  
4010 Ft. West from Southeast Corner of Section  
(NOTE: Locate well in section plat below.)  
Lease Name Morrison "C" Well # 1  
Field Name unnamed  
Producing Formation ---  
Elevation: Ground 2954' KB 2959'  
Total Depth 4670 PBSD \_\_\_\_\_

OCT 12 1989

KANSAS GEOLOGICAL SURVEY  
WICHITA BRANCH

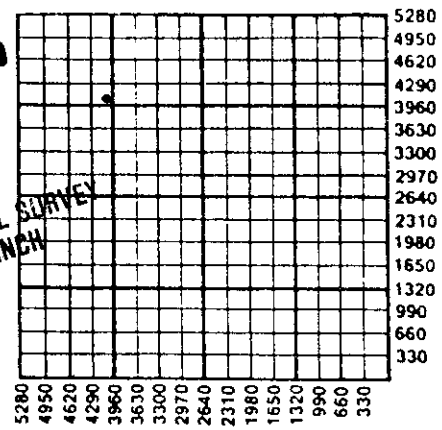

ACT II  
DIA

Amount of Surface Pipe Set and Cemented at 377' Feet  
Multiple Stage Cementing Collar Used?  Yes  No  
If yes, show depth set \_\_\_\_\_ Feet  
If Alternate II completion, cement circulated from \_\_\_\_\_  
feet depth to \_\_\_\_\_ w/ \_\_\_\_\_ sx cmt.

INSTRUCTIONS: This form shall be completed in triplicate and filed with the Kansas Corporation Commission, 200 Colorado Derby Building, Wichita, Kansas 67202, within 120 days of the spud date of any well. Rule 82-3-130, 82-3-107 and 82-3-106 apply. Information on side two of this form will be held confidential for a period of 12 months if requested in writing and submitted with the form. See rule 82-3-107 for confidentiality in excess of 12 months. One copy of all wireline logs and drillers time log shall be attached with this form. ALL CEMENTING TICKETS MUST BE ATTACHED. Submit CP-4 form with all plugged wells. Submit CP-111 form with all temporarily abandoned wells. Any recompletion, workover or conversion of a well requires filing of ACO-2 within 120 days from commencement date of such work.

All requirements of the statutes, rules and regulations promulgated to regulate the oil and gas industry have been fully complied with and the statements herein are complete and correct to the best of my knowledge.

Signature James C. Remsberg  
James C. Remsberg  
Title Operations Manager Date 09/08/89

Subscribed and sworn to before me this 8th day of September 19 89.

Notary Public Elizabeth Cochran

Date Commission Expires \_\_\_\_\_

ELIZABETH COCHRAN  
NOTARY PUBLIC  
STATE OF KANSAS  
My Appt. Exp. 7-8-90

K.C.C. OFFICE USE ONLY  
 Letter of Confidentiality Attached  
 Wireline Log Received  
 Drillers Time Log Received  
RECEIVED  
STATE CORPORATION COMMISSION  
KGS  
Distribution  
 SWD/Rep  NGPA  
 Plug  Other  
(Specify)

SEP 27 1989  
9-27-89  
OIL & GAS CONSERVATION DIVISION  
WICHITA, KANSAS

# CONFIDENTIAL

SIDE TWO

Operator Name SLAWSON EXPLORATION COMPANY, INC Lease Name MORRISON "C" Well # 1  
 Sec. 20 Twp. 18S Rge. 31  East County SCOTT  
 West

**INSTRUCTIONS:** Show important tops and base of formations penetrated. Detail all cores. Report all drill stem tests giving interval tested, time tool open and closed, flowing and shut-in pressures, whether shut-in pressure reached static level, hydrostatic pressures, bottom hole temperature, fluid recovery, and flow rates if gas to surface during test. Attach extra sheet if more space is needed. Attach copy of log.

Drill Stem Tests Taken (Attach Additional Sheets.) <input checked="" type="checkbox"/> Yes <input type="checkbox"/> No  Samples Sent to Geological Survey <input checked="" type="checkbox"/> Yes <input type="checkbox"/> No  Cores Taken <input type="checkbox"/> Yes <input checked="" type="checkbox"/> No  Electric Log Run (Submit Copy.) <input type="checkbox"/> Yes <input type="checkbox"/> No	<p style="text-align: center;"><b>Formation Description</b></p> <p style="text-align: center;"><input type="checkbox"/> Log <input type="checkbox"/> Sample</p> <p>Name <span style="float: right;">Top <span style="margin-left: 100px;">Bottom</span></span></p> <p style="text-align: center;">* * * SEE ATTACHMENT * * *</p>
--	--

CASING RECORD <input type="checkbox"/> New <input type="checkbox"/> Used							
Report all strings set-conductor, surface, intermediate, production, etc.							
Purpose of String	Size Hole Drilled	Size Casing Set (In O.D.)	Weight Lbs./Ft.	Setting Depth	Type of Cement	# Sacks Used	Type and Percent Additives
surface	12 1/4"	8 5/8"	20 & 24#	377'	60/40 Poz	200	2% Ge1, 3% CC
PERFORATION RECORD				Acid, Fracture, Shot, Cement Squeeze Record			
Shots Per Foot	Specify Footage of Each Interval Perforated			Amount and Kind of Material Used			Depth
TUBING RECORD				Liner Run <input type="checkbox"/> Yes <input type="checkbox"/> No			
Size	Set At	Packer At					
Date of First Production		Producing Method <input type="checkbox"/> Flowing <input type="checkbox"/> Pumping <input type="checkbox"/> Gas Lift <input type="checkbox"/> Other (Explain)					
Estimated Production Per 24 Hours	Oil Bbls.	Gas Mcf	Water Bbls.	Gas-Oil Ratio	Gravity		

Disposition of Gas:  Vented  Sold  Used on Lease (If vented, submit ACO-18.)

**METHOD OF COMPLETION**

Open Hole  Perforation  Dually Completed  Commingled

Other (Specify) \_\_\_\_\_

Production Interval \_\_\_\_\_

ORIC VAL

CONFIDENTIAL

RELEASED

OCT 9 8 1981

CONFIDENTIAL

FROM CONFIDENTIAL

SLAWSON EXPLORATION COMPANY, INC.  
Morrison "C" #1  
C NW Sec. 20-18S-31W  
Scott County, Kansas

ELEVATION: 2954 GR 2959 KB

DST #1 3945-3970' L-KC 30' 30-20-20-20. Wk to no bl. Rec: 12' drlg mud. IFP 24-24, FFP 28-28, ISIP 868, FSIP 767, FHP 1930, 120°.

DST #2 4008-4030' L-KC 70' 30-20-20-20. Wk bl. Rec: 15' drlg mud. IFP 30-32, FFP 36-36, ISIP 884, FSIP 801, FHP 2062, 123°.

DST #3 4282-4310' Pleasanton 30-20-20-20. Wk to no bl. Rec: 5' OS mud. IFP 40-40, FFP 43-43, ISIP 919, FSIP 823, FHP 2110, 124°.

DST #4 4283-4375' Marmaton 30-45-45-60. SBOB. Rec: 220' OCWM (10%O, 5%W, 85%M), 250' SOCWM (5%O, 65%M, 30%W), 186' VSOCW (2%O, 98%sulf wtr), IFP 91-180, FFP 225-338, ISIP 1124, FSIP 1074, FHP 2226, 136°.

DST #5 4472-4560' JZ 30-20-20-20 Wk bl. Rec: 30' OSM. IFP 60-64, FFP 72-74, ISIP 797, FSIP 718, FHP 2222, 132°.

DST #6 4602-4635' Miss 30-60-45-75 SBOB. Rec: 80' SOCWM, 120' MW, 450' sulf wtr. IFP 80-122, FFP 200-296, ISIP 1171, FSIP 1169, FHP 2304, 138°.

FORMATION DATA: (sample)

Anhy	2281 (+678)
Base Anhy	2297 (+662)
Heeb	3877 (-918)
Tor	3897 (-938)
Lans.	3921 (-962)
Mun Cr.	4099 (-1140)
Stark	4202 (-1243)
B K/C	4285 (-1326)
Plea	4291 (-1332)
Alta "B"	4360 (-1401)
FS	4452 (-1401)
FS	4452 (-1493)
L/Cher	4474 (-1515)
Johnson	4513 (-1554)
Cherokee Sand	4545 (-1586)
Miss	4560 (-1601)
Dolo	4612 (-1653)
RTD	4670

RECEIVED  
STANDARD OPERATING PROCEDURE

9-27-89

9/4/90

SEP 8 1989

OF

FROM CONFIDENTIAL

DRILLER'S WELL LOG

CONFIDENTIAL

0----380 Shale  
 380---2470 Shale & Clay  
 2470---2770 Shale & Lime  
 2770---3005 Lime & Shale  
 3005---3245 Shale & Lime  
 3245---3630 Lime & Shale  
 3630---3795 Lime & Shale Streaks  
 3795---4670 Lime & Shale

SLAWSON EXPLORATION COMPANY, INC.  
 Morrison "C" #1  
 C NW Sec. 20-18S-31W  
 Scott County, Kansas

ELEVATION: 2954 GR 2959 KB

FORMATION DATA: (sample)

Anhy	2281 (+678)
Base Anhy	2297 (+662)
Heeb	3877 (-918)
Tor	3897 (-938)
Lans.	3921 (-962)
Mun Cr.	4099 (-1140)
Stark	4202 (-1243)
B K/C	4285 (-1326)
Plea	4291 (-1332)
Alta "B"	4360 (-1401)
FS	4452 (-1401)
FS	4452 (-1493)
L/Cher	4474 (-1515)
Johnson	4513 (-1554)
Cherokee Sand	4545 (-1586)
Miss	4560 (-1601)
Dolo	4612 (-1653)
RTD	4670

SURFACE CASING:  
 8 5/8" set @ 377' W/200 sx.  
 60/40 Pozmix, 2% Gel, 3% CC

SEP 07 1989  
 KANSAS Geological Survey  
 WICHITA BRANCH

A F F I D A V I T

STATE OF KANSAS )  
 COUNTY OF BARTON) SS

GREG DAVIDSON of lawful age, does swear and state that the facts and statements herein are true and correct to the best of his knowledge.

Greg Davidson  
 Greg Davidson

Subscribed and sworn to before me this 31st day of August 1989.



Bessie M. DeWerff  
 Notary Public: Bessie M. DeWerff

My Commission expires: 5-20-93

RECEIVED  
 STATE CORPORATION COMMISSION  
 SEP - 4 1989  
 9-4-89  
 CONSERVATION DIVISION  
 Wichita, Kansas

RECEIVED  
 STATE CORPORATION COMMISSION  
 SEP 4 1989  
 CONSERVATION DIVISION  
 Wichita, Kansas