

STATE OF KANSAS
STATE CORPORATION COMMISSION

15.101.20392.0006

WELL PLUGGING RECORD

Give All Information Completely
Make Required Affidavit
Mail or Deliver Report to
Conservation Division
State Corporation Comm.
245 North Water
Wichita, KS 67202

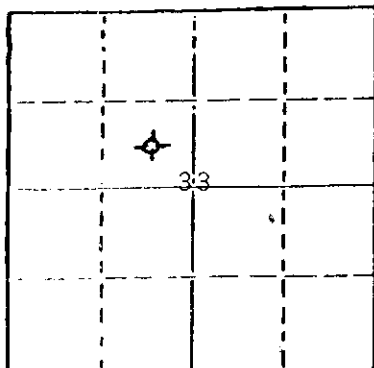

Locate well correctly on above
Section Plat

Lane County. Sec. 33 Twp. 18 Rge. 30 ~~XX~~W
Location as "NE/CNW $\frac{1}{4}$ SW $\frac{1}{4}$ " or footage from lines
SE NW

Lease Owner DANE G HANSEN TRUST
Lease Name MESSENGER Well No. 2

Office Address P O Box 187, Logan, KS 67646

Character of Well (Completed as Oil, Gas or Dry Hole)

Dry Hole

Date Well completed 8/4/79 19

Application for plugging filed 8/4/79 19

Application for plugging approved 8/4/79 19

Plugging commenced 8/4/79 19

Plugging completed 8/4/79 19

Reason for abandonment of well or producing formation

Too low structurally

If a producing well is abandoned, date of last production

19

Was permission obtained from the Conservation Division or
its agents before plugging was commenced? Yes

Name of Conservation Agent who supervised plugging of this well Gilbert Balthazor

Producing formation Depth to top Bottom Total Depth of Well 4520'

Show depth and thickness of all water, oil and gas formations.

OIL, GAS OR WATER RECORDS

CASING RECORD

FORMATION	CONTENT	FROM	TO	SIZE	PUT IN	PULLED OUT
				8 5/8"	302.76'	None

Describe in detail the manner in which the well was plugged, indicating where the mud fluid was placed and the method or methods used in introducing it into the hold. If cement or other plugs were used, state the character of same and depth placed, from feet to feet for each plug set.

(If additional description is necessary, use BACK of this sheet)

Name of Plugging Contractor

STATE OF Kansas COUNTY OF Sedgwick, ss.
G F Galloway (employee of owner) or (owner or operator)
of the above-described well, being first duly sworn on oath, says: That I have knowledge of the facts, statements, and matters herein contained and the log of the above-described well as filed and that the same are true and correct. So help me God.

(Signature)

1107 Douglas Bldg, Wichita, KS 67202

(Address)

SUBSCRIBED AND SWORN TO before me this 9th day of August, 19 79

Debra L Heersche
Debra L Heersche Notary Public.

My commission expires March 3, 1980

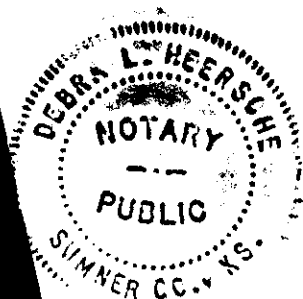

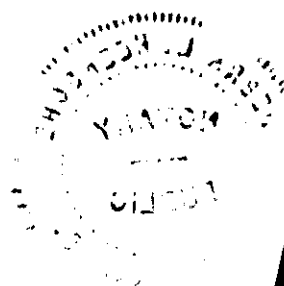

KANSAS DRILLERS LOG

API No. 15 — 101 — 20397-0000
County Number

S. 33 T. 18 R. 30 ^{XX}_W

Loc. SE NW

County Lane

Operator

Dane G Hansen Trust

Address

P O Box 187, Logan, KS 67646

Well No.

2

Lease Name

Messenger

Footage Location

1980 feet from (N) ^(X) line 1980 feet from (XX) (W) line

Principal Contractor

C-G Drilling Co., Inc.

Geologist

Jerry Jespersen

Spud Date

7/26/79

Total Depth

4520'

P.B.T.D.

Date Completed

8/4/79

Oil Purchaser

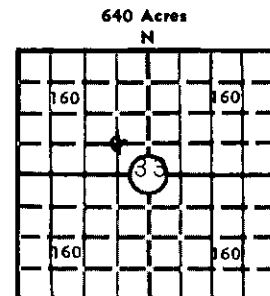

Locate well correctly

Elev.: Gr.

DF 2887' KB

CASING RECORD

Report of all strings set — surface, intermediate, production, etc.

Purpose of string	Size hole drilled	Size casing set (in O.D.)	Weight lbs/ft.	Setting depth	Type cement	Sacks	Type and percent additives
Surface	12 1/4"	8 5/8"	24#	306'	Common	200	2% Gel 3% CC

LINER RECORD

Top, ft.	Bottom, ft.	Sacks cement
----------	-------------	--------------

PERFORATION RECORD

Shots per ft.	Size & type	Depth interval
---------------	-------------	----------------

TUBING RECORD

Size	Setting depth	Packer set at
------	---------------	---------------

ACID, FRACTURE, SHOT, CEMENT SQUEEZE RECORD

Amount and kind of material used	Depth interval treated

INITIAL PRODUCTION

Date of first production	Producing method (flowing, pumping, gas lift, etc.)				
RATE OF PRODUCTION PER 24 HOURS	Oil	Gas	Water	Gas-oil ratio	CFPB
	bbls.	MCF	bbls.		
Disposition of gas (vented, used on lease or sold)			Producing interval(s)		

INSTRUCTIONS: As provided in KCC Rule 82-2-125, within 90 days after completion of a well, one completed copy of this Drillers Log shall be transmitted to the State Geological Survey of Kansas, 4150 Monroe Street, Wichita, Kansas 67209. Copies of this form are available from the Conservation Division, State Corporation Commission, 3830 So. Meridian (P.O. Box 17027), Wichita, Kansas 66217. Phone AC 316-522-2206. If confidential custody is desired, please note Rule 82-2-125. Drillers Logs will be on open file in the Oil and Gas Division, State Geological Survey of Kansas, Lawrence, Kansas 66044.

Operator Dane G Hansen Trust		DESIGNATE TYPE OF COMP.: OIL, GAS, DRY HOLE, SWDW, ETC.: Dry Hole	
Well No. 2	Lease Name Messenger		
S <u>33</u> T <u>18</u> R <u>30</u> X W			
WELL LOG		SHOW GEOLOGICAL MARKERS, LOGS RUN, OR OTHER DESCRIPTIVE INFORMATION.	
Show all important zones of porosity and contents thereof; cored intervals, and all drill-stem tests, including depth interval tested, cushion used, time tool open, flowing and shut-in pressures, and recoveries.			
FORMATION DESCRIPTION, CONTENTS, ETC.	TOP	BOTTOM	NAME
DST #1: 4190-4224' 30-60-45-90 REC 10' HOCM, 1130' MUDDY S/WTR, IBHP 1187#, FBHP 1207#, IFP 102# FFP 549# DST #2: 4348-4370' 15-30-30-30 REC 10' MUD IBHP 20#, FBHP 20# IFP 40#, FFP 20#.			
USE ADDITIONAL SHEETS, IF NECESSARY, TO COMPLETE WELL RECORD.			
Date Received	<div style="text-align: right;"> <u>Debra Heersche</u> Signature Debra Heersche, Office Mgr Title 8/14/79 Date </div>		